

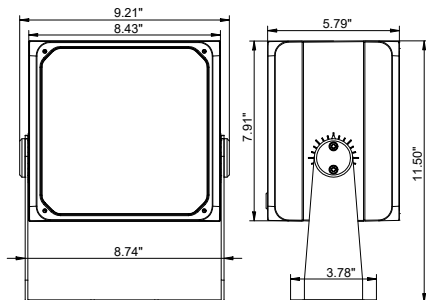

DART MAXI DAL-

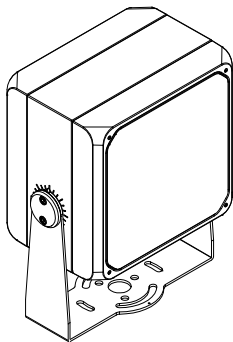

120-277
VAC

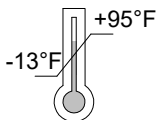

K 5 FB-B;

To ensure a maximum efficient use of the product, read the instructions before proceeding installment.



This fixture must be installed by a licensed and qualified electrician. The installer must comply with NEC and local building codes when installing the fixture



Electrical current can cause painful shock, serious injury, or even death. Make sure you turn off the power supply, ground fixture(s), and make sure all electrical connections are correct and secured



IP66

For use in IP66 installations.



Keep the label of the original packaging if any eventual future claims are needed

Table of Contents

Packaging Contents	Pg.2
Fixture Power Connection	Pg.3
Mounting Position	Pg.3
Mounting Installation	Pg.4
Accessories Installation	Pg.5-8
Maintenance	Pg.9
Support Page	Pg.10

Packaging contents

DART MAXI
fixture

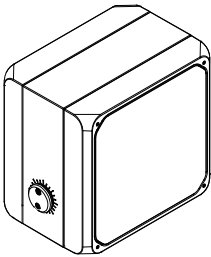

Mounting
bracket

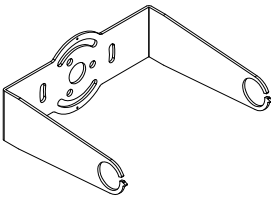

4 pin: Power cable
5 pin: 1 - 10V
dimming

2 FOOT IP 68 CONNECTOR
POWER CORD (attached on
fixture)

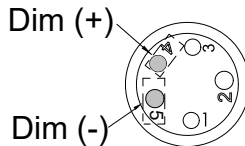
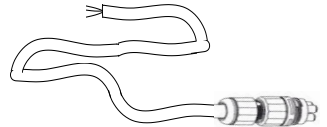
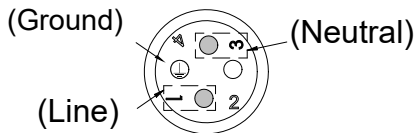

Fixture Power Connection

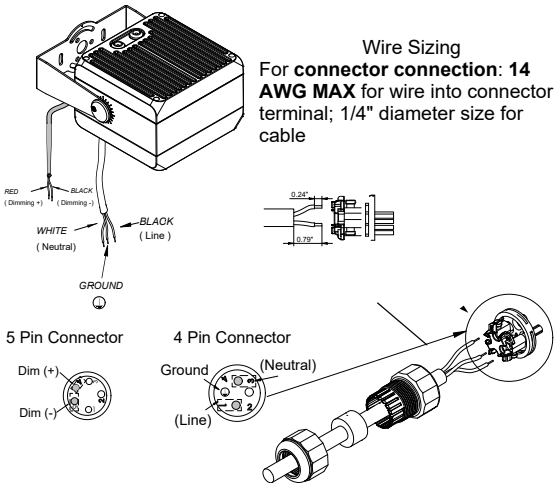

Connect the fixture's wiring with correct wire gauge into the correct terminals shown on the diagram. **Be sure once you connect the wires to the connector that you tightly close and secure the connector to ensure a water tight seal.**

Mounting Positioning

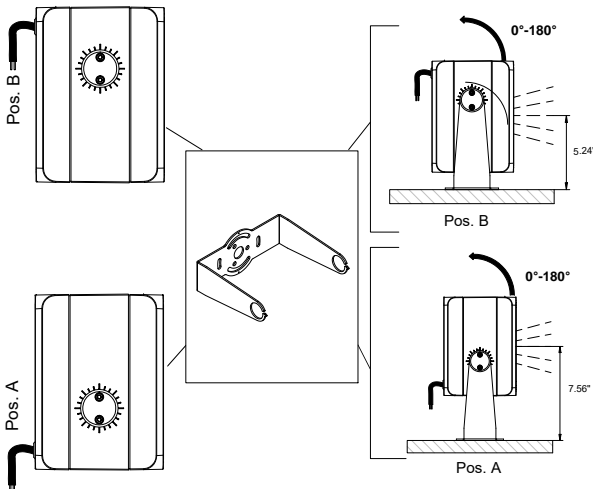

Dart fixture has a 180 degree rotation for beam angling when mounting. This allows the fixture to be mounted in two position.

Based on the position of the fixture will determine the distance from the middle beam to the mounting surface. As shown left, position A mounted position has a closer distance from the mounting surface than position B.

Mounting Installation

- A) Bracket will be leveled installed on the mounting surface with a gap between the two brackets based on the size of the fixture. Once the gap between the brackets have been properly measured and leveled, use the appropriate fasteners or anchors to mount the bracket onto mounting surface.
- B) Loosen the screw using an Allen key to open the gap between the pivot wheel and the body of the fixture. The screw must be loosened up to a minimum gap of at least 0.08" spacing for the mounting bracket to fit between the gap to properly hold the fixture in place.
- C) With the mounted bracket installed, whether installing the fixture in position A or position B, line up the gap of the mounted bracket ring with the screws of the pivot wheel. Be sure you have a clear viewing angle of the gap of the mounted bracket ring with the screws you are slipping the rings into.
- D) Once the mounted bracket rings slip through the pivot wheel screws and are in the correct position, using the Allen key, lock the screws in to secure the pivot wheel with the mounting bracket rings together.

A

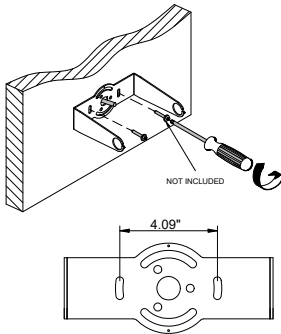

B

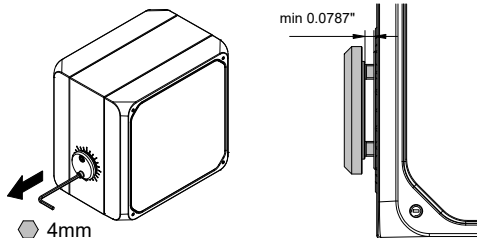

C

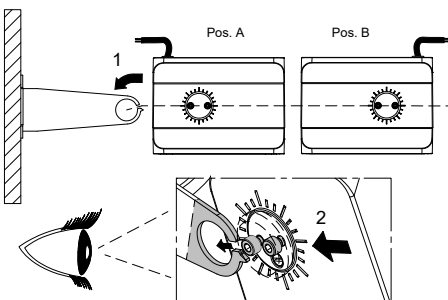

D

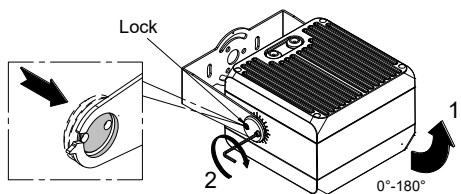

Accessories Installation

PLATE FOR FITTING ROTATION

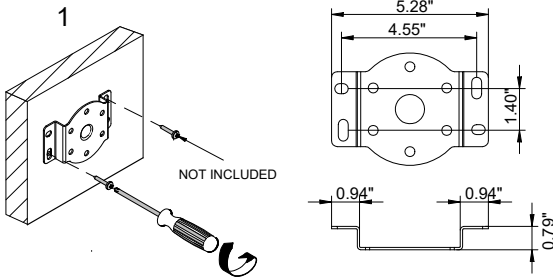

Rotation bracket will be leveled, and installed on the mounting surface. Use the appropriate fasteners or anchors to mount the bracket onto mounting surface.

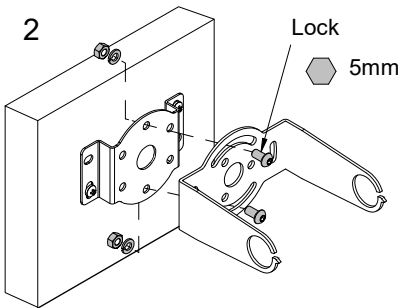

Once the rotation bracket is mounted onto the surface, place the two hex screws through and place the the body of the fixture on top of the mounted bracket. Adjust the fixture to the desire lighting position before locking the two hex screws on top of the mounting bracket.

ADJUSTMENT

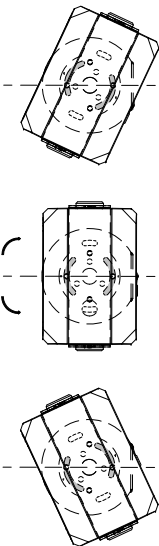

The rotation bracket allows the fixture to rotate horizontally and addition ± 45 degrees lighting angling capability. This allows the fixture to have a flexible adjusting angle for the user desired positioning of lighting a certain area.

Accessories Installation

EARTHSPIKE INSTALLATION

1

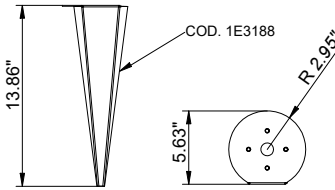
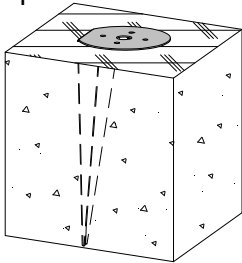

Earthspike will be leveled installed on the mounting ground and will be stable and sturdy before mounting fixture. Use the appropriate fasteners or anchors to mount the bracket onto mounting surface.

2 ↓

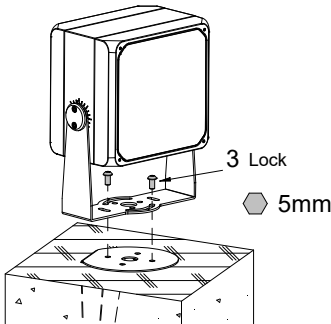

Once the earthspike is mounted onto the surface, place the two hex screws through and place the body of the fixture on top of the mounted bracket. Adjust the fixture to the desire lighting position before locking the two hex screws on top of the mounting bracket.

ADJUSTMENT

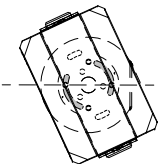
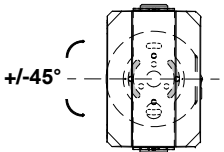
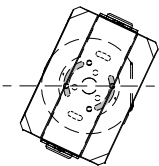

The earthspike, like the rotation bracket, allows the fixture to rotate horizontally and addition +/- 45 degrees lighting angling capability. This allows the fixture to have a flexible adjusting angle for the user desired positioning of lighting a certain area.

Accessories Installation

ASYMMETRIC SCREEN

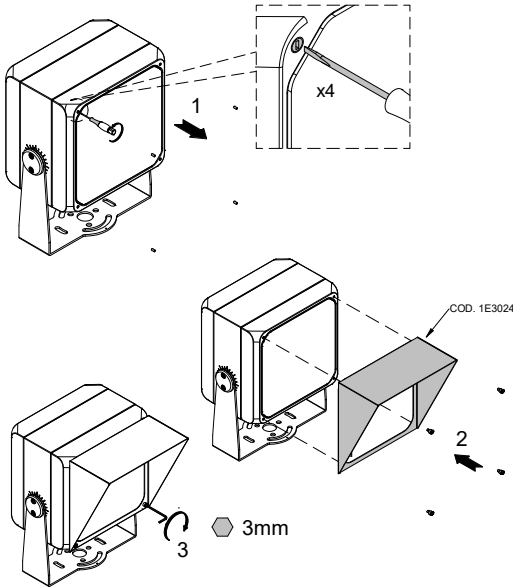

In order to add accessories onto this fixture, you must remove the four screw caps off the glass screen before attaching any accessories on the fixture.

For the asymmetric screen, use the four hex screws and the Allen wrench to secure the screen on with the fixture's lens. Be sure to tighten the screws to prevent any moisture going into the fixture.

HONEYCOMB ANTI-GLARE LOUVRE

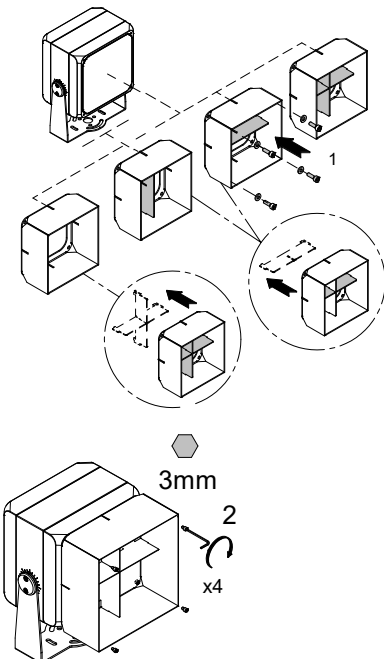

This louvre has the adaptability to provide either a half shade (horizontal or vertical position) or honeycomb screen. Insert the anti-glare louvre of the desired setting of the screen to prepare the attachment of the louvre to the fixture. Just slide the panels provided with the screen flat either horizontal, vertical, or both and secure the panels with the provided hex screws. These screws will hold the louvre into place until it is secured onto the fixture together.

Once the anti-glare louvre screen has been prepared for attaching, use the four hex screws and the Allen wrench to secure the screen on with the fixture's lens. Be sure to tighten the screws to prevent any moisture going into the fixture.

Accessories Installation

HOLDER RING FOR FILTERS

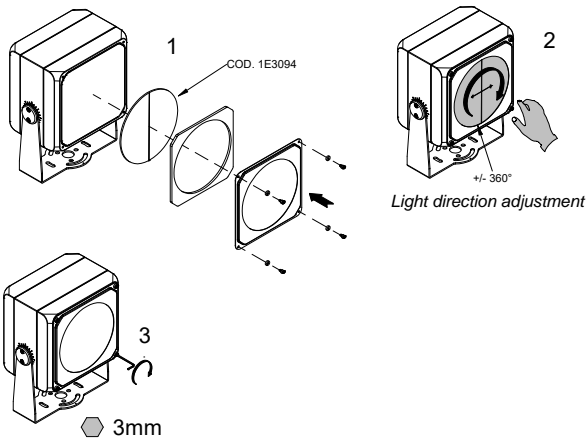

Insert the desired filter in the correct order as shown in the diagram. For the blade of light filter, pick the desired position you want to add the blade of light and attach the filter in the same order as any other filter.

Once the filter, window screen and top glass cover are attached together onto the fixture, use the four hex screws and the Allen wrench to secure the fixture filter together with the body of the fixture. Be sure to tighten the screws to prevent any moisture going into the fixture.

LASER POINTING SYSTEM

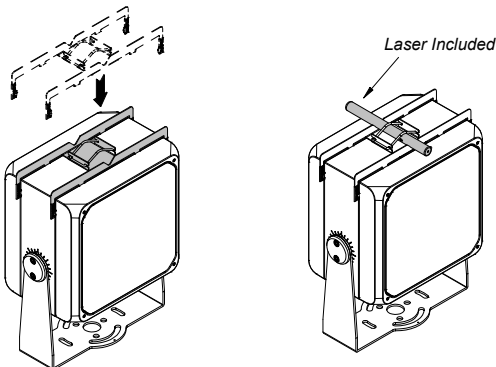

This fixture has the capability of attaching a laser pointing system to efficiently and accurately direct the beam of light to the designated target. Find the laser pointer holder and with the clear band holder side facing up, slide the laser holder down until it lays flat on top of the fixture.

Once the holder is attached on top, you may add the laser pointer on top of the fixture by lifting the band and adding the laser pointing between the groove and the bands as shown by the diagram.

Maintenance

This fixture was designed and manufactured for a durable, long lasting use with minimum care. To ensure the maximum lifespan of this product, we encourage our customer to provide a quality visual inspection of the fixture periodically.

If there are any irregular visible sign of issues (i.e moisture or dust) regarding the fixture please contact us as we will assist the situation at hand. ~~Å~~

Support

Any questions, problems, or comments you have please feel free to contact our Customer Service department during our business hours Monday-Friday 8am-5pm via:

Email: usaorders@targetti.com

Phone: (714) 513-1991

Visit our website: <http://www.targetti.us>