



KEPLERO

Keplero Gimbal (GMB)

Keplero Zoom (ZM)

Keplero Wall Wash (WW)

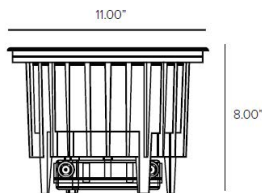
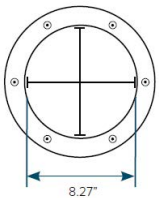
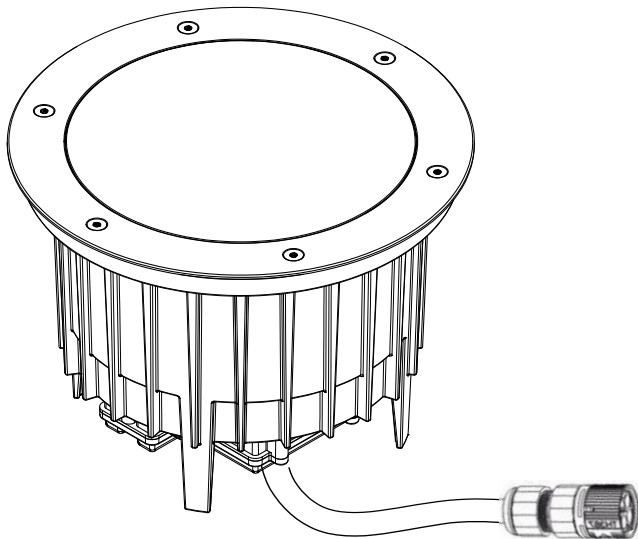

K 5 FB-B;

To ensure a maximum efficient use of the product, read the instructions before proceeding installment.

***Please make sure the fixture is sealed correctly and the trim ring is properly tightened (see trim installation page 7 for details)*.**



This fixture must be installed by a licensed and qualified electrician. The installer must comply with NEC and local building codes when installing the fixture.



Electrical current can cause painful shock, serious injury, or even death. Make sure you turn off the power supply, ground fixture(s), and make sure all electrical connections are correct and secured.



This fixture must not be installed during rain, fog, or high humidity.



Please allow the fixtures to run for 45 min before installing trim ring (see trim installation section for more details).



For use in IP67 installations.



Keep the label of the original packaging if any eventual future claims are needed.

Table of Contents

Packaging Contents	Pg.2
Installation Instructions	Pg.3-4
Range of Motion	Pg.5
Accessories Installation	Pg.6
Trim Installation	Pg.7
Maintenance	Pg.7
Support Page	Pg.8

Packaging contents

Keplero fixture
with trim ring
installed

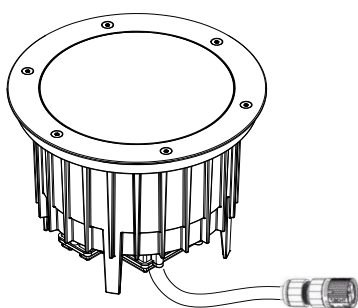

4 pin: Power cable
5 pin: 1 - 10V
dimming

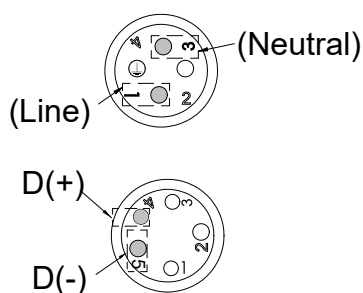

1DU2394-
Installation Sleeve

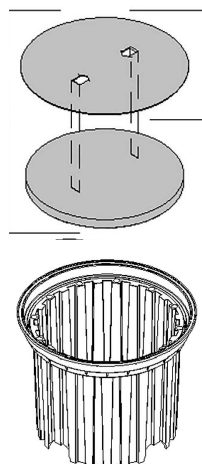

1DU4343- Raised
Metal Installation
Pipe

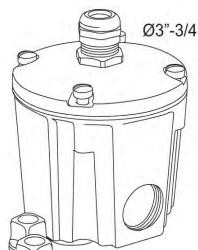
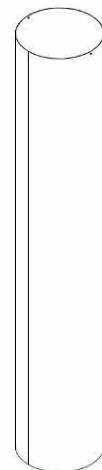

1DU2530 JUNCTION
BOX

6 FOOT IP 68 CONNECTOR
POWER CORD

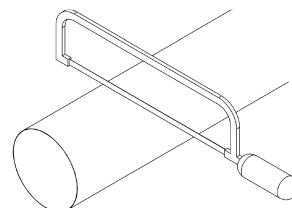
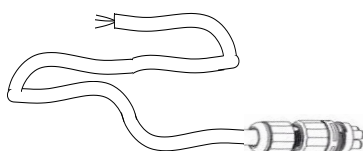

**ATTENTION! CUT THE
OPPOSITE SIDE WHIT THE HOLES**

Installation Instructions

- Installers will dig out trenches to prep the PVC tube
 - Put gravel in the trenches for the J-Box
 - Requirement by UL for adequate drainage
 - Safety net covers below the J-Box and the conduit pipe to warn diggers what is below
- Position of the J-Box must be an accessible depth of 12" max required for maintenance
- Insert the PVC pipe with the installation sleeve
 - The gap between the end of the PVC pipe and the middle of the J-Box should have enough room to fix the power cord to be installed with enough slack to remove the fixture while connected
 - Tube is field cut adjustable for accessibility
- If installation requires semi-flushed installation
 - Break off outer ring of installation sleeve for 0.15" raise
 - Fixture will rest above the sleeve for a covered look
- For low voltage dimming feature
 - Provide a separate PVC conduit through the gravel to provide a run for all fixtures with dimming for parallel circuiting installation
- For Raised Installation
 - Installers will dig out trenches to prep the PVC tube
 - Minimum 12.75" from bottom of raised installation sleeve to ground level Installers will dig out trenches to prep the PVC Insert the PVC pipe with the installation sleeve
 - PVC pipe for raised installation is 36" total This allows the extension PVC tube to be field cut to create an elevated installation with a range of 1" to 23"

In Grade Installation Sleeve (With Extension Sleeve 1DU2394)

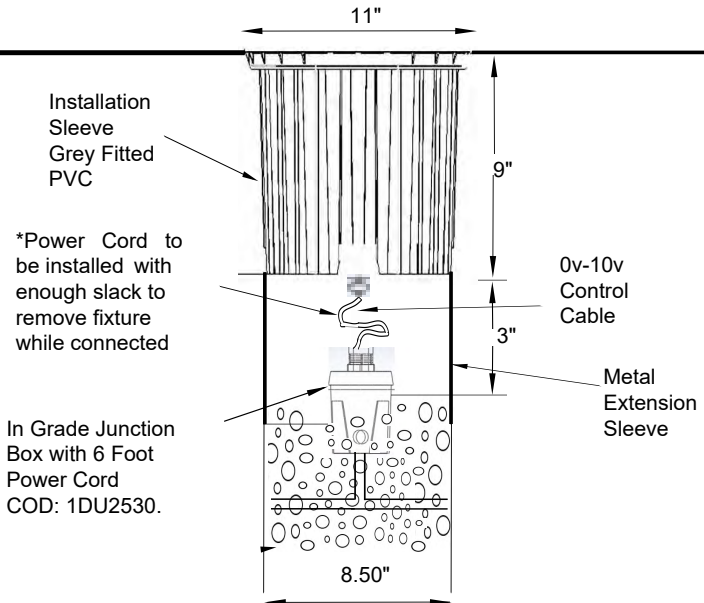

Raised Installation Sleeve 1DU4343

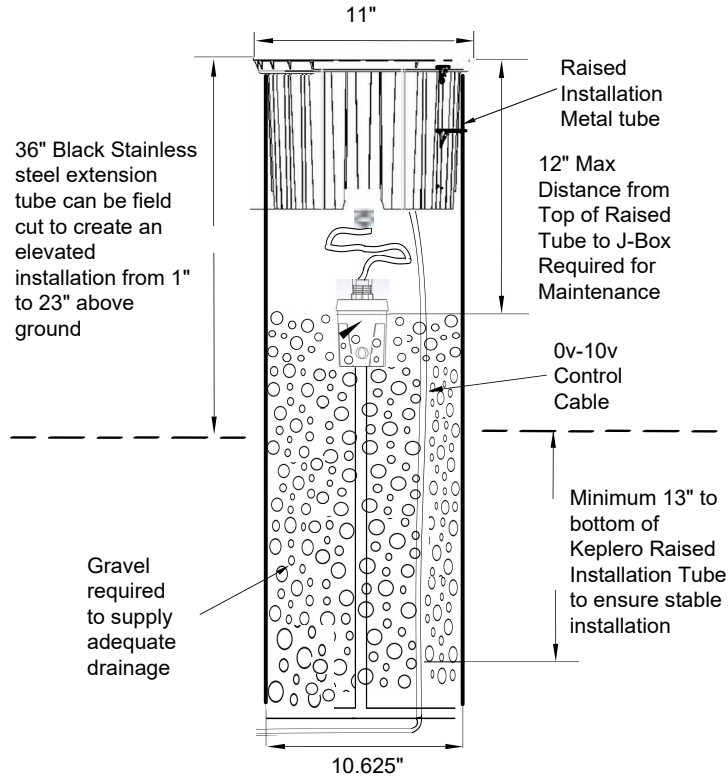

Installation Instructions cont.

Connecting the power cord to the fixture

- Locate the power cord connected to the J-box with the 4-pin female connector
- Connect the female connector with the 4-pin male connector port. The male connector is located on the bottom of the Keplero fixture attached to the box which contains the fixture's driver (Warning: tampering or opening the box will void the warranty of the fixture).
 - If fixture has dimming, 5-pin connectors will also be connected onto the driver box
- To ensure a secure connection between the two connectors, turn the **open/close** dial counter-clockwise until tight. Check with a quick tug on the connectors if connection between the two connectors are secured
- To unlock the connectors, turn the dial clockwise until the connection between the two connectors are able to be separated

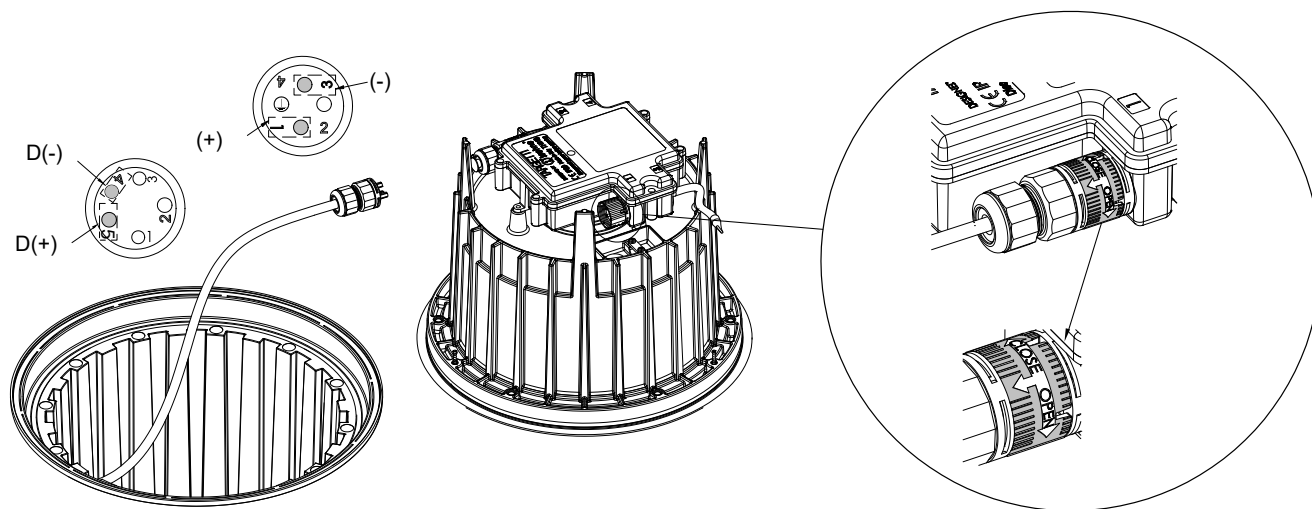

Inserting fixture into sleeve

- Fixture will slide into grooves of the installation with ease
- To provide a safe and efficient installation of fixture to the sleeve, use metal handle (optional/not included accessory) to safely insert the fixture into the installation sleeve
- Secure the fixture to sleeve with the three screws provided with installation sleeve

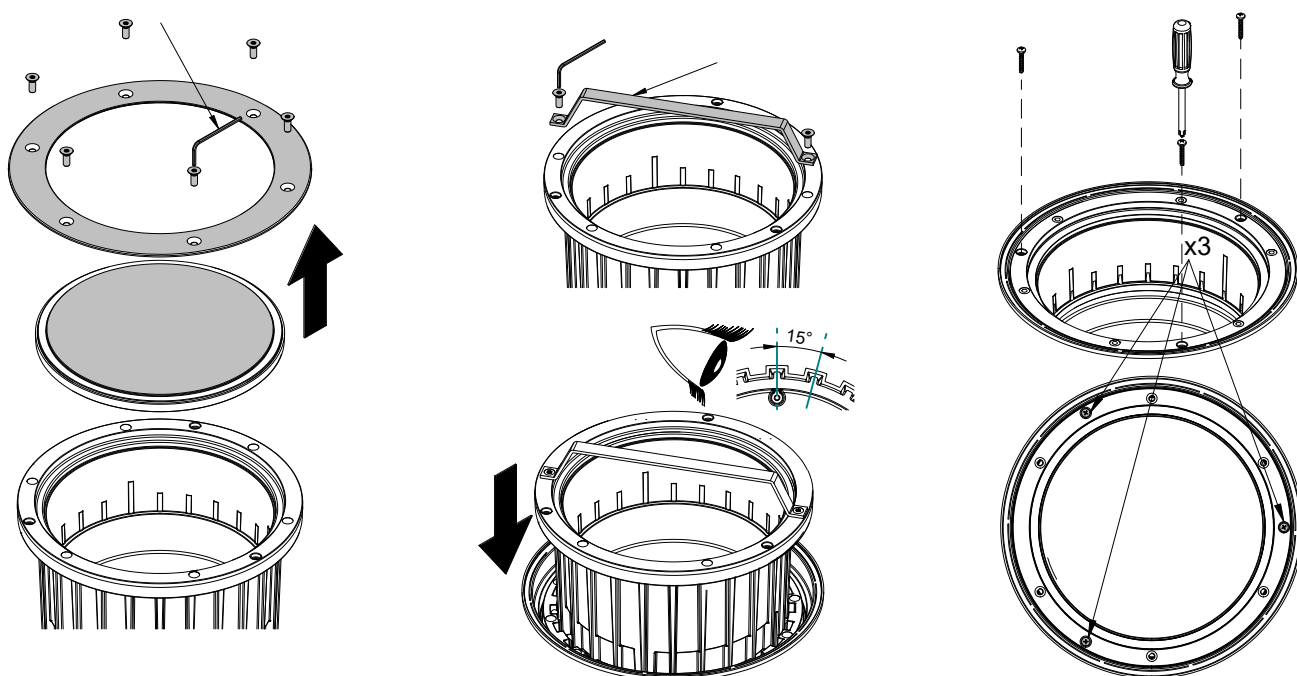

Range of Motion

- Fixture's optics has two range of motion
 - Horizontal Axis: All Keplero fixtures' optics rotate on the horizontal plane with a range from 0 - 359°
 - Vertical Axis: For Keplero Gimbal optics, tilts on the vertical axis with a range from 0° centered to +40° or -40° tilt accessibility. For Keplero Zoom optics, optics slides on vertical axis from 0 to 0.79in to project a tilt from 0 to +200. (Keplero Wall Wash has only a horizontal range of motion).

GIMBAL OPTIC

Horizontal Adjustment

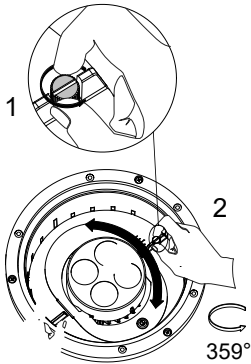

Vertical Adjustment

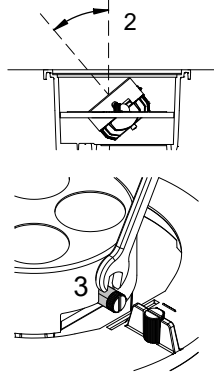
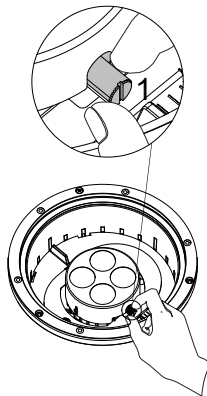

3 TO TIGHTEN KNOB TO LOCK THE AIMING

ZOOM OPTIC

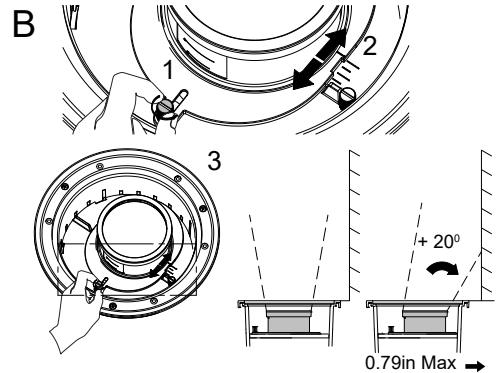
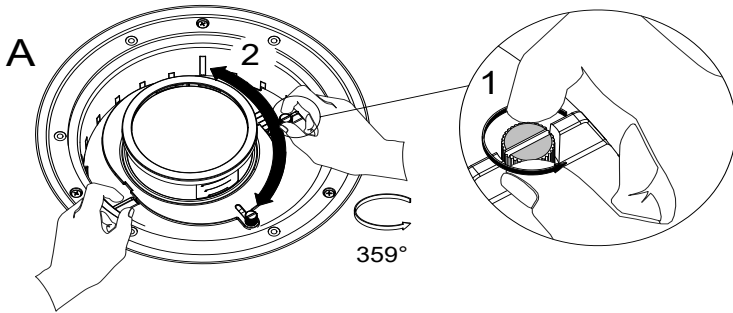

WALL WASHER OPTIC

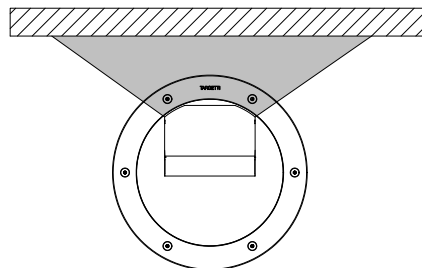
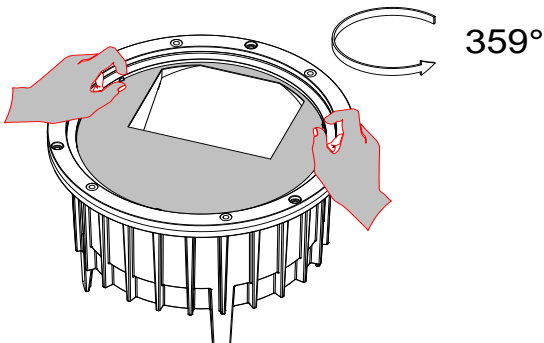

Accessories Installation

- Types of accessories
 - Chromatic Filters
 - Corrective Filters
 - Refractive Filters
 - Anti-glare Filters
- Guide for installing accessories
 - For Gimbal optic: Take off the lens cap from optics holder using an Allen wrench to loosen the lock nut holding lens cap. Insert up to two filters max in the lens cap before inserting the lens cap back on the optics holder with the added filters and securing the lock nut back onto the cap.
 - For Zoom optic: Pull the optics up to its highest position before securing it in place. Unscrew the lens cap from optics holder and insert up to two filters max in the lens cap before screwing the lens cap back on the optics holder with the added filters

GIMBAL OPTIC

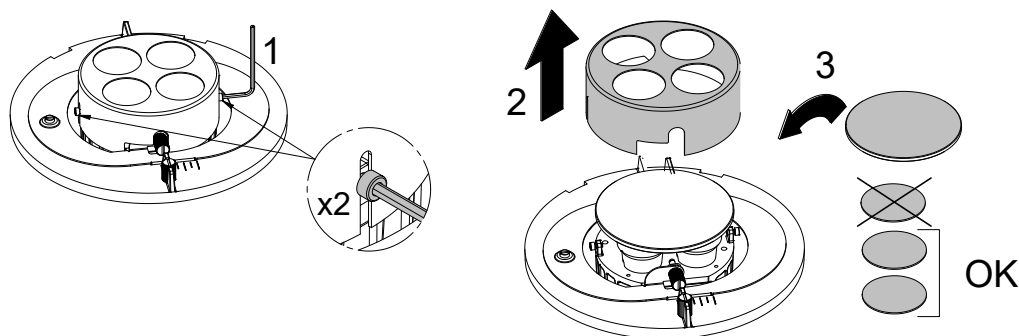

ZOOM OPTIC

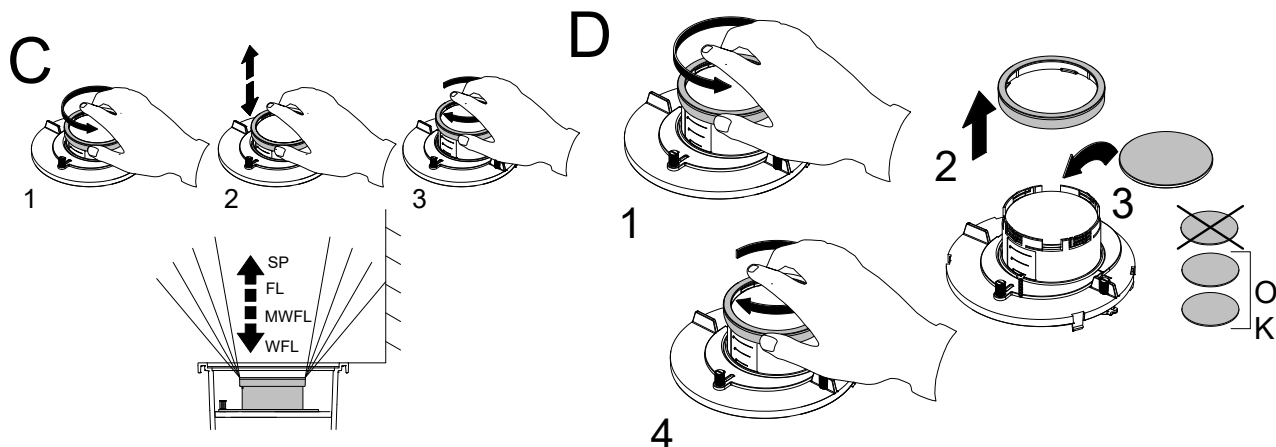

Trim Installation

Fixture comes installed with trim ring. If trim ring is opened for optics adjustment:

- Use a tamper-proof torx key (sold separately/optional but recommended) to remove the trim ring, the glass ring, and access the optics holder for beam spread angling
- Once you set position of the optics to the desired lighting angle, **power on fixture and cover with black installation sleeve lid and let the fixture operate for 45 minutes before attaching glass and trim ring**
- When securing the tamper-proof torx screws
 - Apply only 2.95ft-lbs (4Nm) of torque to efficiently secure the fixture
 - Torque screws in star formation to provide a tight, even, and secure holding for the trim ring

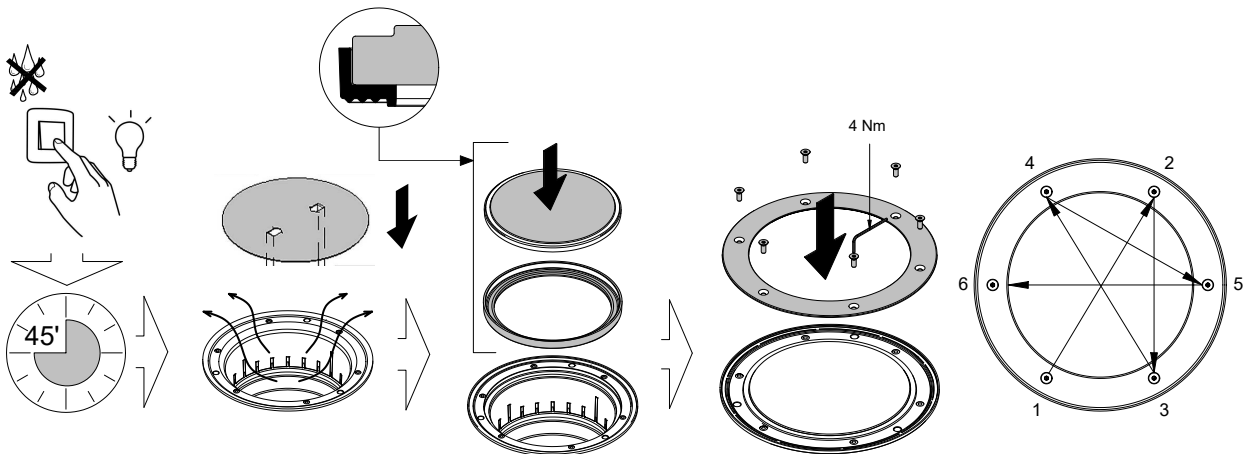

Maintenance

- This fixture was designed and manufactured for a durable, long lasting use with minimum care. To ensure the maximum lifespan of this product, we encourage our customer to provide a quality visual inspection of dirt, abnormalities, or signs of moisture inside or around the fixture every six months.
- If there are any visible sign of issues during the inspection, please open the fixture, wipe off any moisture inside the fixture and clean any of the dirt off the fixture with a soft cloth with cleaning solution around the trim ring and the ring of the fixture.
 - **D@5 G9 8 -G7 CBB97 H'H<9': ±HI F9'69: CF9'7 @5 B-B;**
 - **8 C'BCH'GDF5 M5 BM7 @5 B-B; 'GC@ H-CB'8 -F97 H@MCB' H<9'CDH7 G**
- Once finished with fixture maintenance, be sure to install back the trim ring according to trim installation directions above. ~~XXXXXX~~

Support

Any questions, problems, or comments you have please feel free to contact our Customer Service department during our business hours Monday-Friday 8am-5pm via:

Email: usaorders@targett.com

Phone: (714) 513-1991

Visit our website: <http://www.targetti.us>

TARGETTI™