

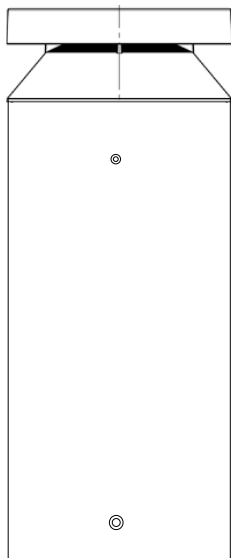

## MR. BO Bollard

CODE: MBB

14W / 19W / 27W Led source Fixture  
MR BO Radial Emission LED Bollard



If in doubt about the symbols please  
refer to catalog or website

Available options  
Refer to Spec sheet Pg. 1

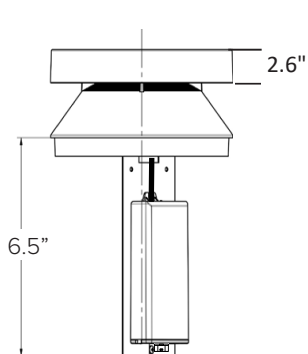

Flat Head Fixture

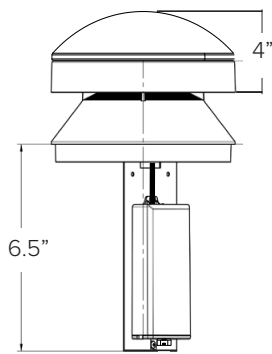

Domed Head Fixture

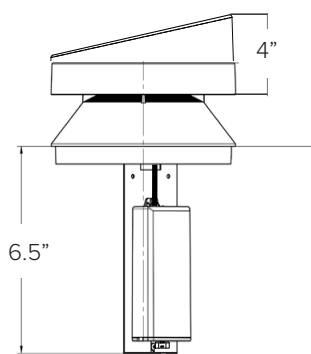

Angled Head Fixture

\*FIXTURE HEADS ROTATE 360°

### WARNING

**To ensure a maximum efficient use  
of the product, read the instructions  
before proceeding installment.**



This fixture must be installed by a licensed and qualified electrician. The installer must comply with NEC and local building codes when installing the fixture



Electrical current can cause painful shock, serious injury, or even death. Make sure you turn off the power supply, ground fixture(s), and make sure all electrical connections are correct and secured tightly



For use in IP66 installations.



Keep the label of the original packaging if any eventual future claims are needed

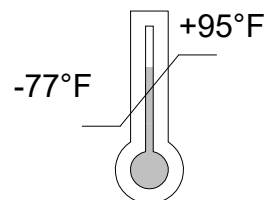

120/277V IP66  
50/60Hz IK10

## Table of Contents

Packaging Contents / Dimensions  
Mounting Base Options  
Drainage / J-Box / Base Installation  
Bollard / Fixture Head Assembly  
Maintenance / Support

Pg.2  
Pg.3  
Pg.4/5/6/7/8  
Pg.9  
Pg.10

Pg.1

## Packaging Contents / Dimensions

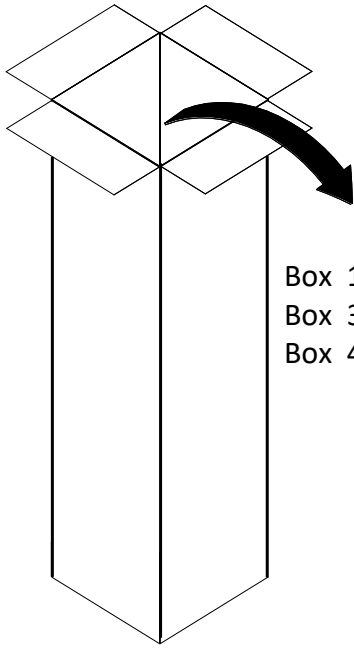

Box 18"x11"x8"  
Box 36"x11"x8"  
Box 44"x11"x8"

\*LED fixture head is shipped  
installed on Bollard



13.14" / 28.89" / 36.77"

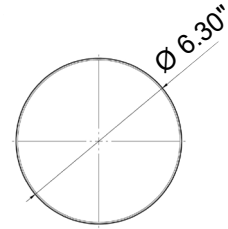

Top View



**TOOL03**  
Tool Torx TX20 Anti Theft  
1 ea.



**1E2495**  
Tool Torx TX30 Anti Theft  
1 ea.

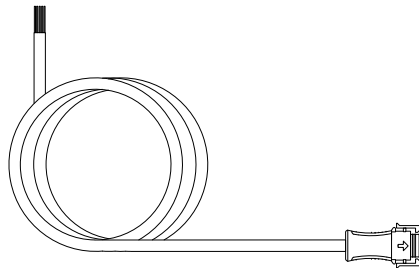

### Standard 4ft Lead Cable 1 ea.

Cabled with Belden 16-6 600V cable and female  
IP68 anti-wicking quick disconnect 4ft lead cable.

### Conductor Callout

IP68 DSM&T anti-wicking  
quick disconnect

Black = line voltage

White = neutral

Green = ground

Red = Do Not Use

Purple = positive 0-10V

Pink = negative 0-10V 600V rated.

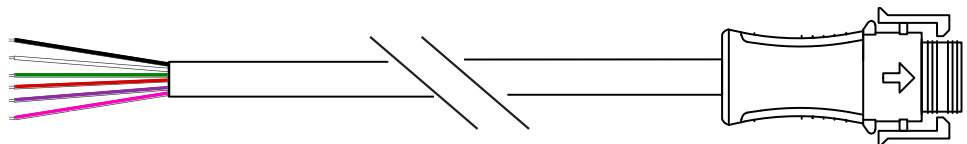

# 1. Confirm Specified Mounting Base

## Mounting base (sold separately)

**A**

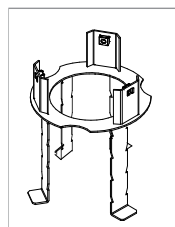

**1US3448**

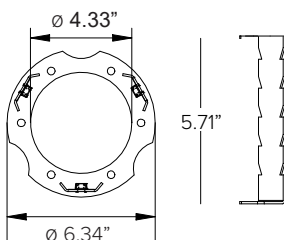

- Base bolts 3 ea.
- Lock Washers 3 ea.
- Nuts 3 ea.

- Shim Washers  
3/8"x3/4" flat  
6 ea.  
(for leveling)

\*Assembled with  
base

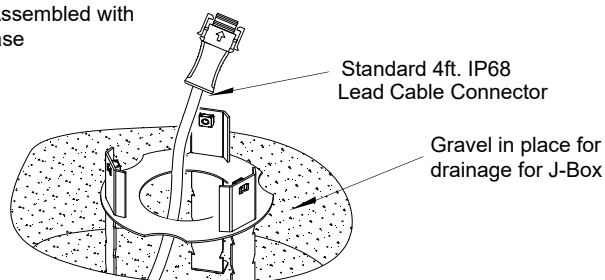

Standard 4ft. IP68  
Lead Cable Connector

Gravel in place for  
drainage for J-Box

Stainless Steel base with rods for concrete pouring

\*Refer to mounting base installations instructions

**B**

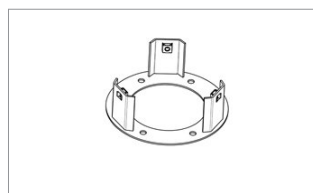

**1US3449**

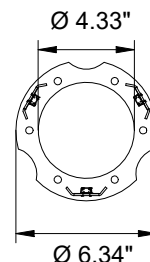

- Shim Washers  
3/8"x3/4" flat  
6 ea.  
(for leveling)

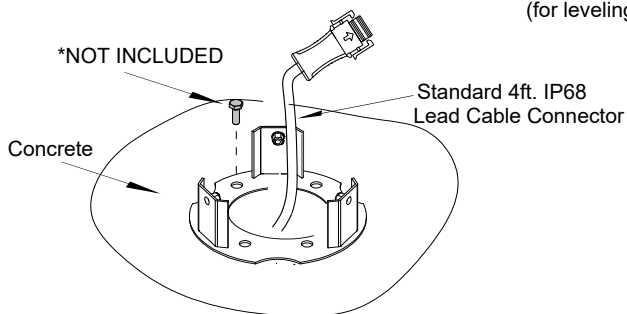

\*NOT INCLUDED

Standard 4ft. IP68  
Lead Cable Connector

Concrete

Stainless Steel base with holes for anchor bolts  
installation on a solid concrete surface

\*Refer to mounting base installations instructions

**C**

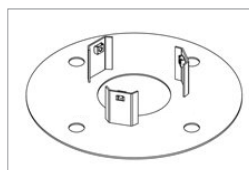

**1US3510**

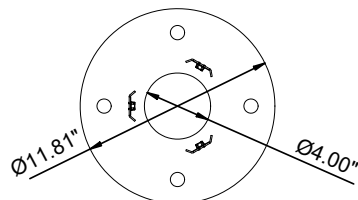

\*NOT INCLUDED

Standard 4ft. IP68  
Lead Cable Connector

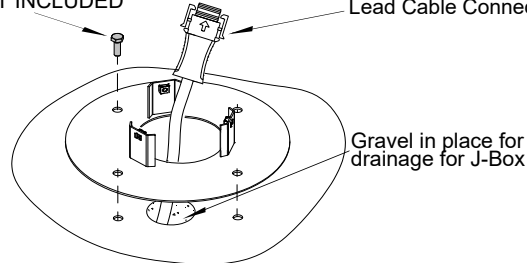

Gravel in place for  
drainage for J-Box

Stainless Steel base with holes for anchor bolts  
installation on a solid concrete surface

\*Refer to mounting base installations instructions

## \*Important\*

If optional proximity sensors are used with Bollard,  
the sensor will align with screw mounting direction.

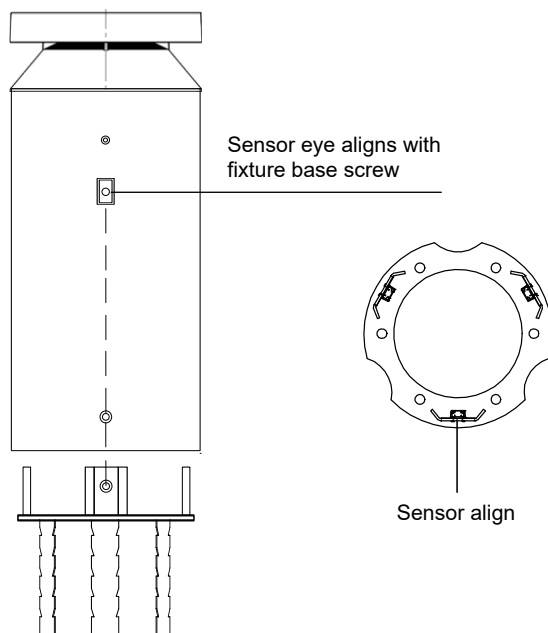

Sensor eye aligns with  
fixture base screw

Sensor align

# 1US3448 Mounting Base Installation

**A**

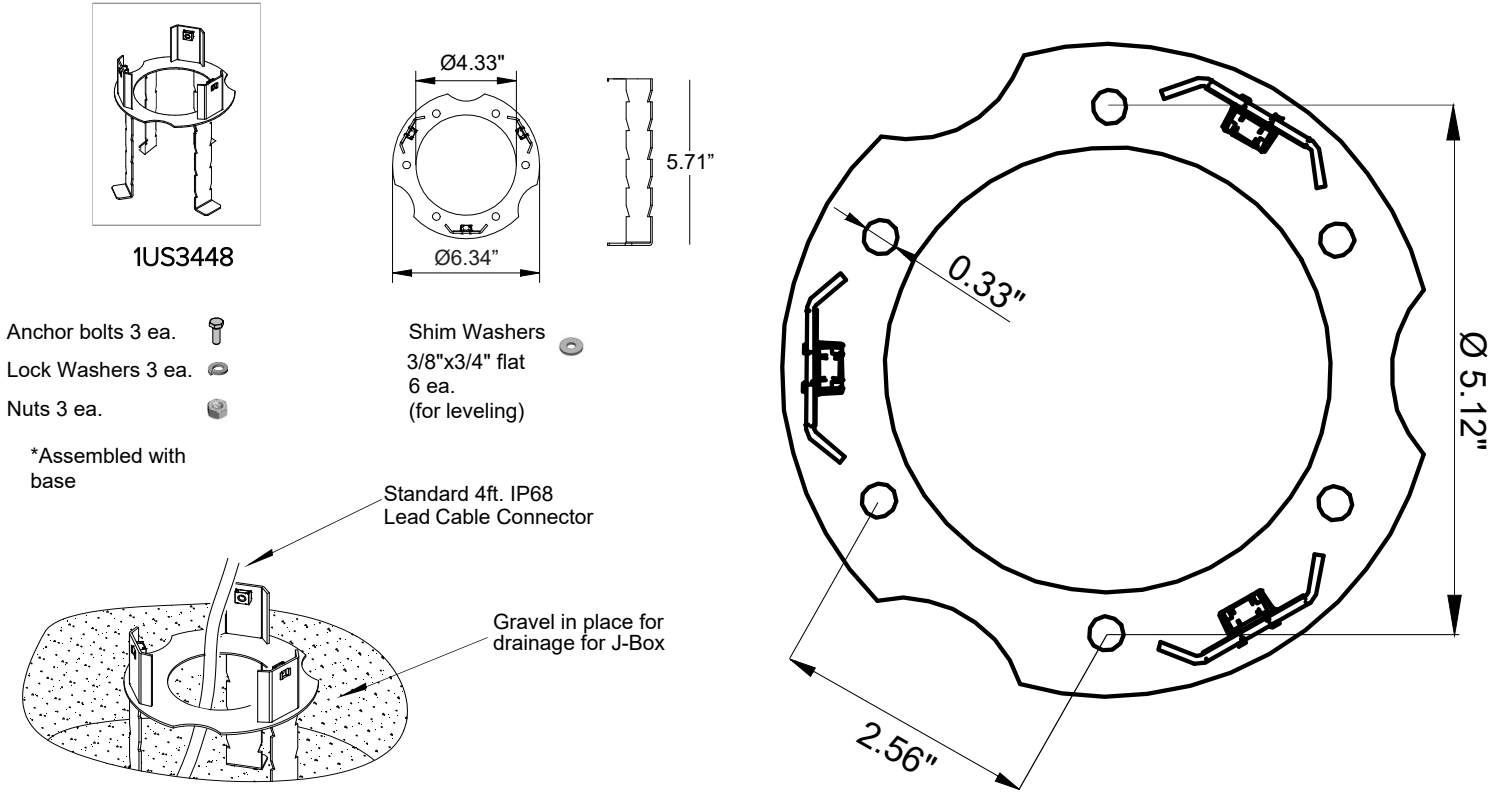

Stainless Steel base with rods on aggregated / compacted base for concrete pouring

## Drainage / J-Box Installation

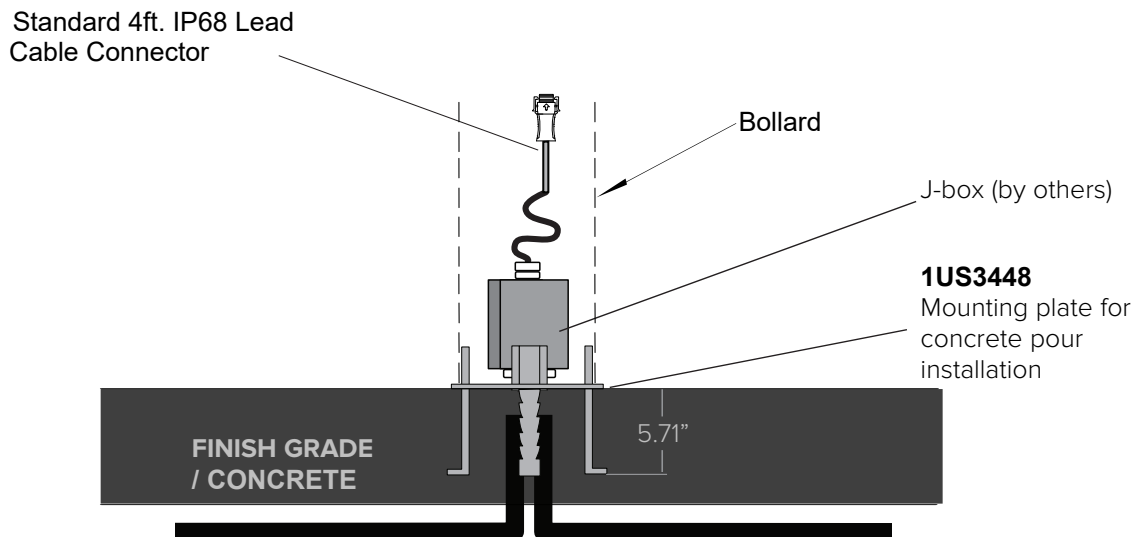

**NOTE:** Install according to local and NEC building codes. UL listed j-box supplied by others.

# 1US3449 Mounting Base Installation

**B**

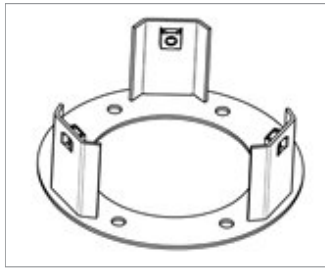

1US3449

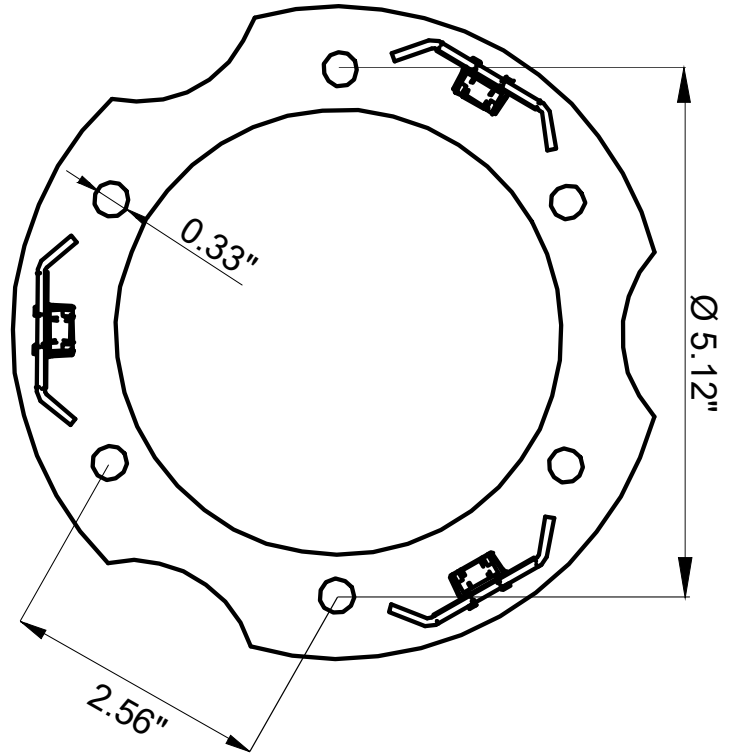
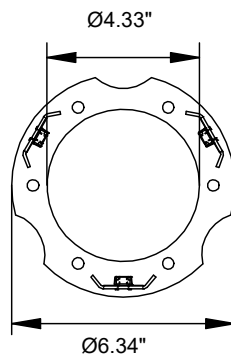

Once power cord has been connected  
install base onto position by drilling holes on  
the concrete and using anchor bolts

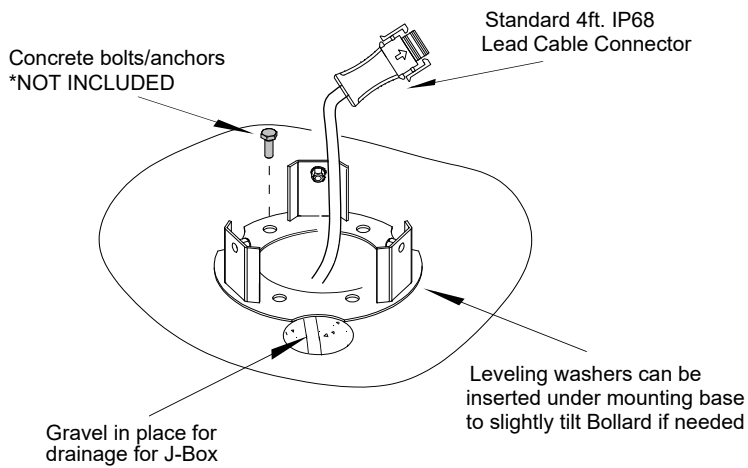

Use proper size  
drill bit to drill holes  
(minimum of 3 holes  
required)

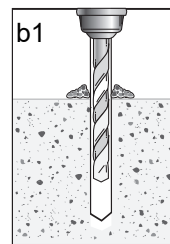

Clean holes using  
air nozzle (remove  
all debris)

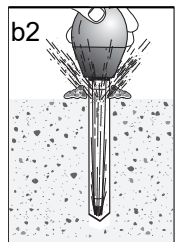

Place mounting base in position  
then drive anchor bolts using  
impact hammer until fully  
seated. Use leveling washers if  
needed to slightly tilt Bollard

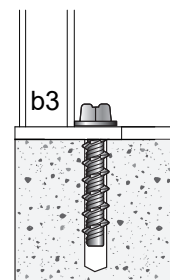

## Drainage / J-Box Installation

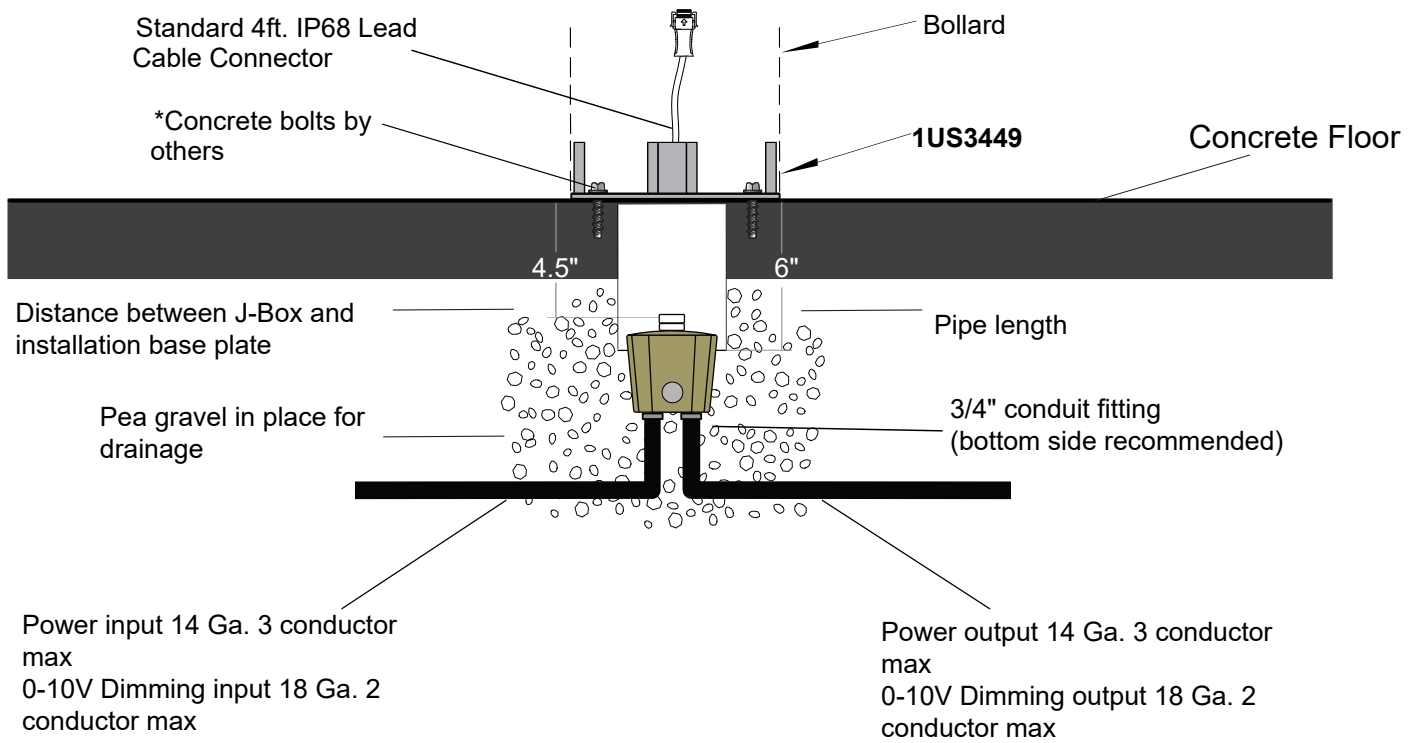

# 1US3510 Mounting Base Installation

C

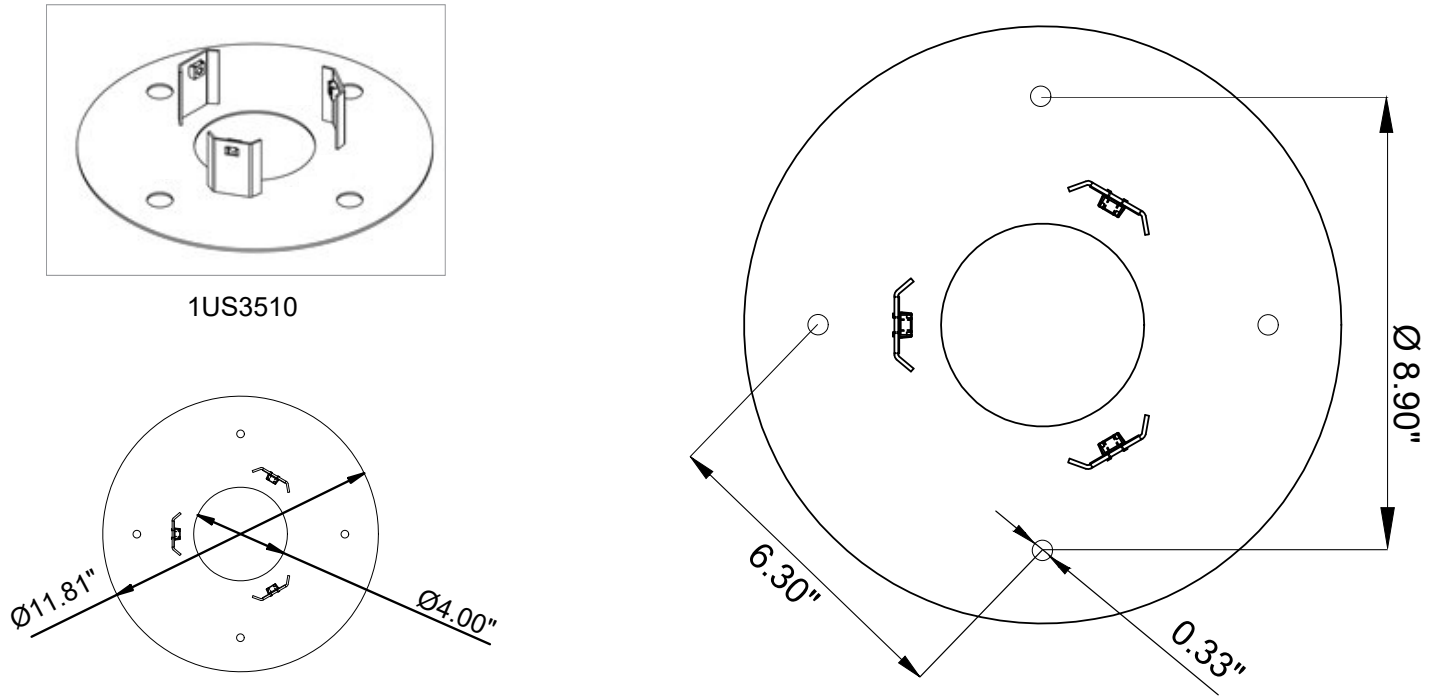

Once power cord has been connected  
install base onto position by drilling holes on  
the concrete and using anchor bolts

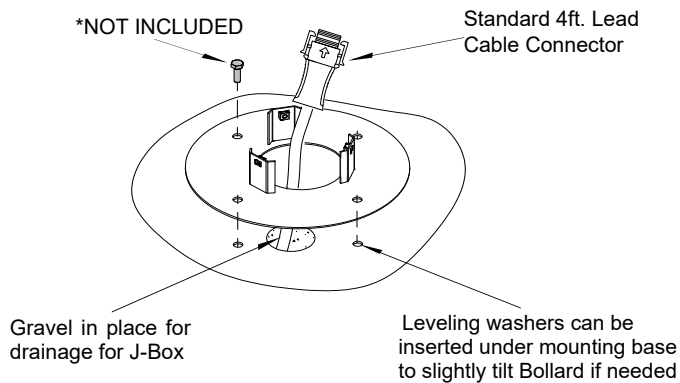

Use proper size drill  
bit for and drill holes  
(minimum of 3 holes  
required)

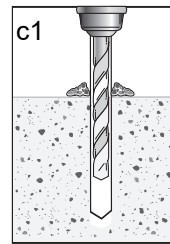

Clean holes using  
air nozzle  
(remove all debris)

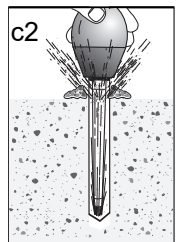

Place mounting base in position  
then drive anchor bolts using  
impact hammer drill until fully  
seated. Use leveling washers if  
needed to slightly tilt Bollard

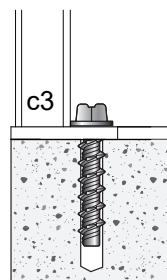

## Drainage / J-Box Installation

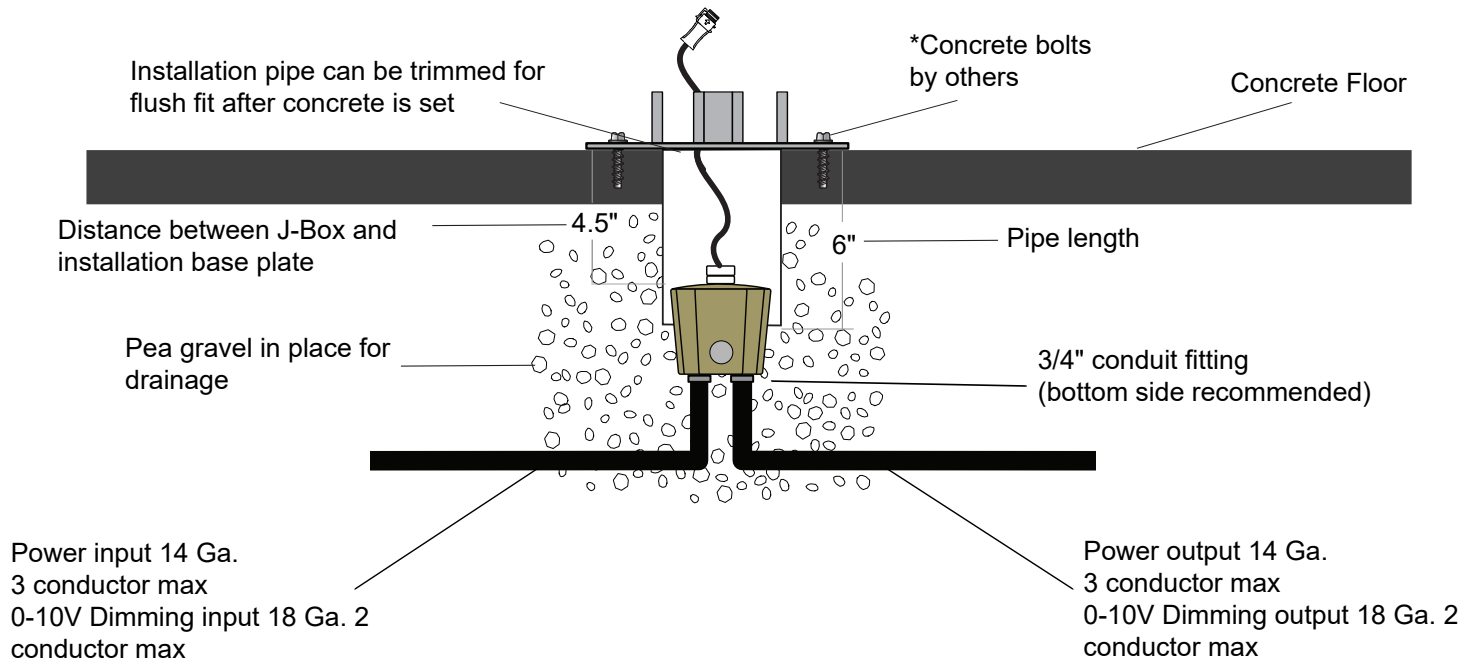



# Bollard / LED Fixture Head Assembly

## Step 1.

Insert the DSMT IP68 connector end of lead cable towards the surface and through Bollard

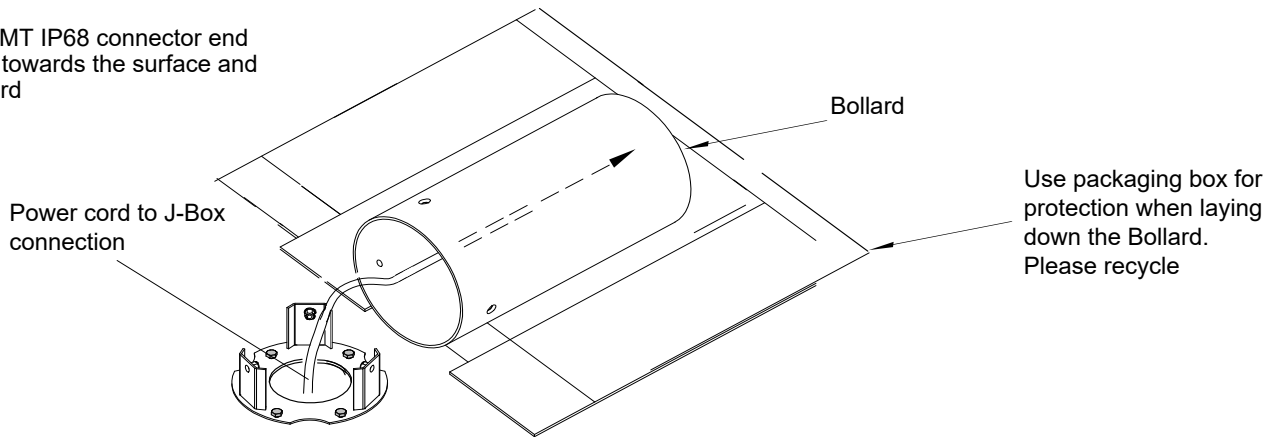

## Step 2.

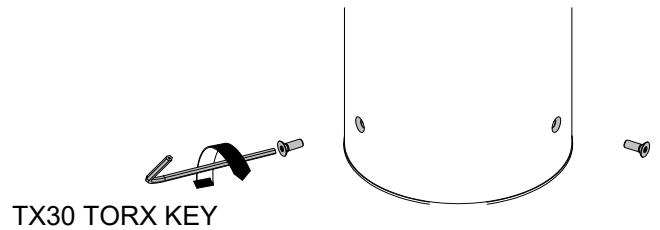

## Step 3.

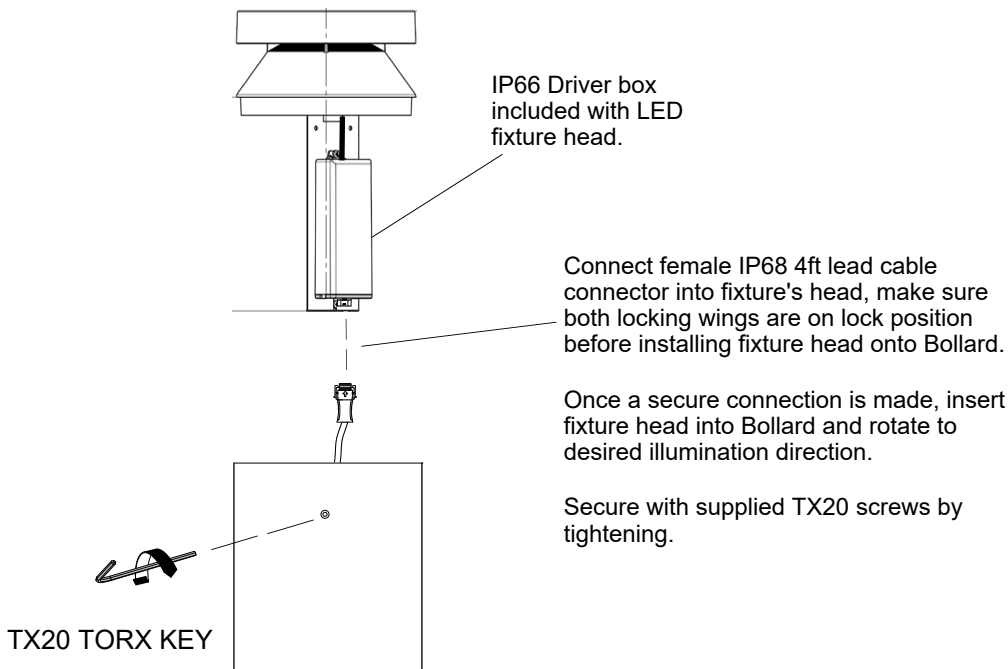

---

## **Maintenance**

This fixture was designed and manufactured for a durable, long lasting use with minimum care. To ensure the maximum lifespan of this product, we encourage our customers to provide a quality visual inspection of the fixture and installation accessories every six months. If there are any visible signs of issues (i.e moisture or dust) during the inspection, please clean any of the dust or moisture with a soft cloth and check to make sure that any of the fixtures are still operating normally. If there are any issues regarding the fixture please contact us as we will assist the situation at hand.

---

## **Support**

Any questions, problems, or comments you have please feel free to contact our Customer Service department during our business hours Monday-Friday 8am-5pm via: Email: [usaorders@targetti.com](mailto:usaorders@targetti.com)  
Phone: (714) 513-1991

Visit our website: <http://www.targettiusa.com>