

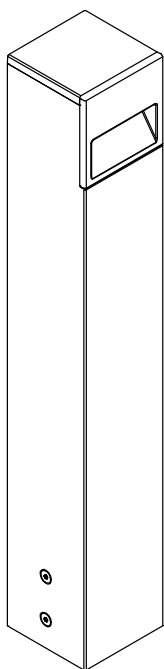

## ZEDGE MINI BOLLARD

ZESB41FW

SMALL SCALE PROFESSIONAL LED BOLLARD



If in doubt about the symbols  
please refer to catalog or website

### WARNING

**To ensure a maximum efficient use of the product, read the instructions before proceeding installment.**



This fixture must be installed by a licensed and qualified electrician. The installer must comply with NEC and local building codes when installing the fixture



Electrical current can cause painful shock, serious injury, or even death. Make sure you turn off the power supply, ground fixture(s), and make sure all electrical connections are correct and secured tightly



For use in IP66 installations.



Keep the label of the original packaging if any eventual future claims are needed

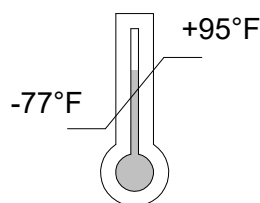
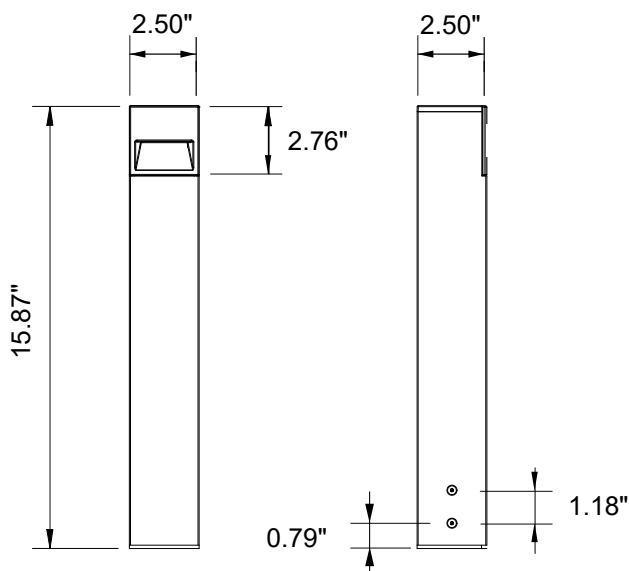

120/277V IP66  
50/60Hz IK10



### Table of Contents

Packaging Contents / Mounting Base  
Mounting Base Installation 1E3741  
Mounting Base Installation 1E3740  
Bollard Installation  
Wiring Diagram / Distribution of Light  
Maintenance / Support

Pg.2  
Pg.3/4  
Pg.5/6  
Pg.7  
Pg.8  
Pg.9

Pg.1

## Packaging Contents

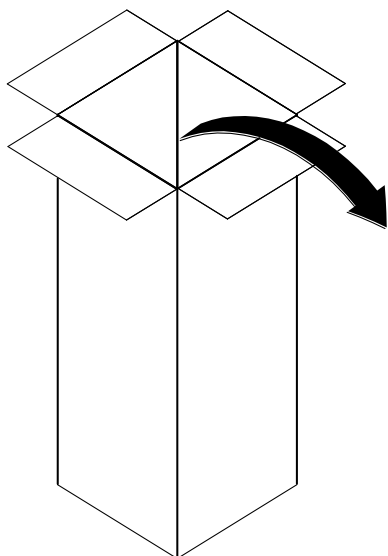

Box 5"x5"x22" @ 2.20lbs.

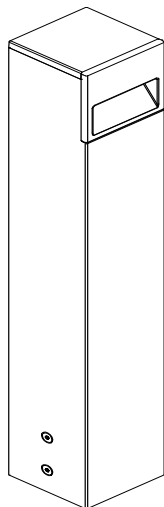

**ZESB41FW**  
LED Fixture Bollard 1 ea.

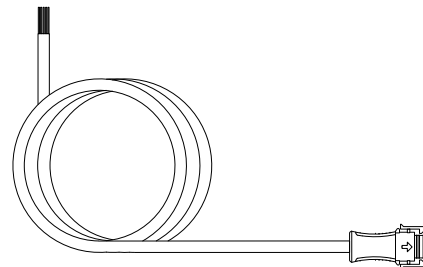

**Standard 4ft. Lead Cable** 1 ea.  
Cabled with Belden 16-6 600V cable  
and female IP68 anti-wicking quick  
disconnect 4ft. lead cable.

### Conductor Callout

Black = line voltage

White = neutral

Green = ground

Red = Do Not Use

Purple = positive 0-10V

Pink = negative 0-10V 600V rated.

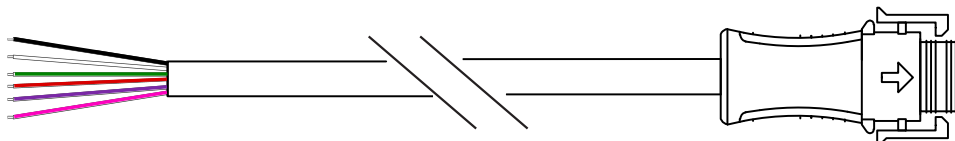

## Mounting Base (Sold Separately)

\*Each fixture is supplied with  
either one of the 2 mounting  
bases listed above depending  
on application.



**TOOL03**  
Tool Torx TX20 Anti-Theft 1 ea.

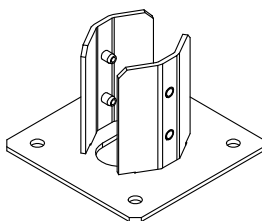

**1E3741**  
Surface Mount Base 1 ea.

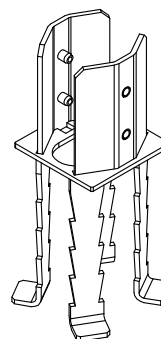

**1E3740**  
Concrete Anchor Base 1ea.

# Mounting Base Installation

## 1E3741

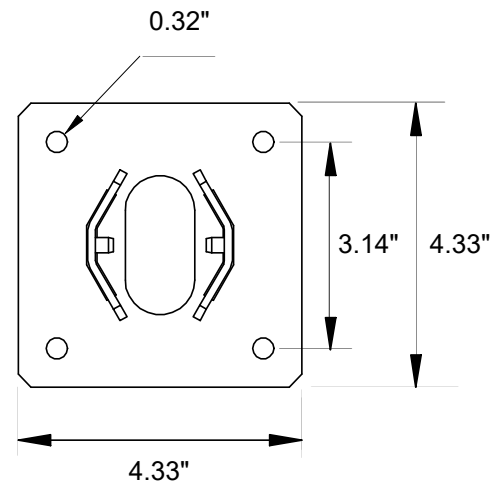
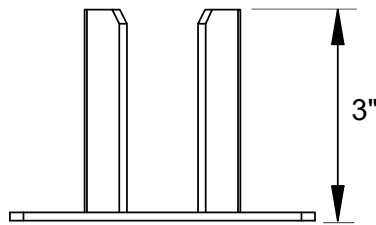
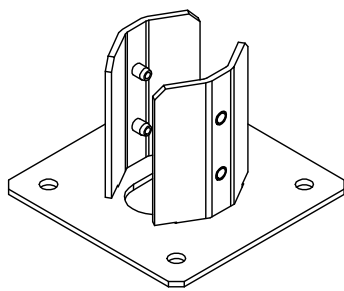

Surface mount base requires 4 concrete screws/anchor bolts (provided by others) to secure the base onto solid surface.

Concrete screws/anchor bolts  
1/4" x 2-1/2" - 4" recommended

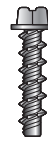

\*Center hole allows space for 2 each 3/4" conduit.

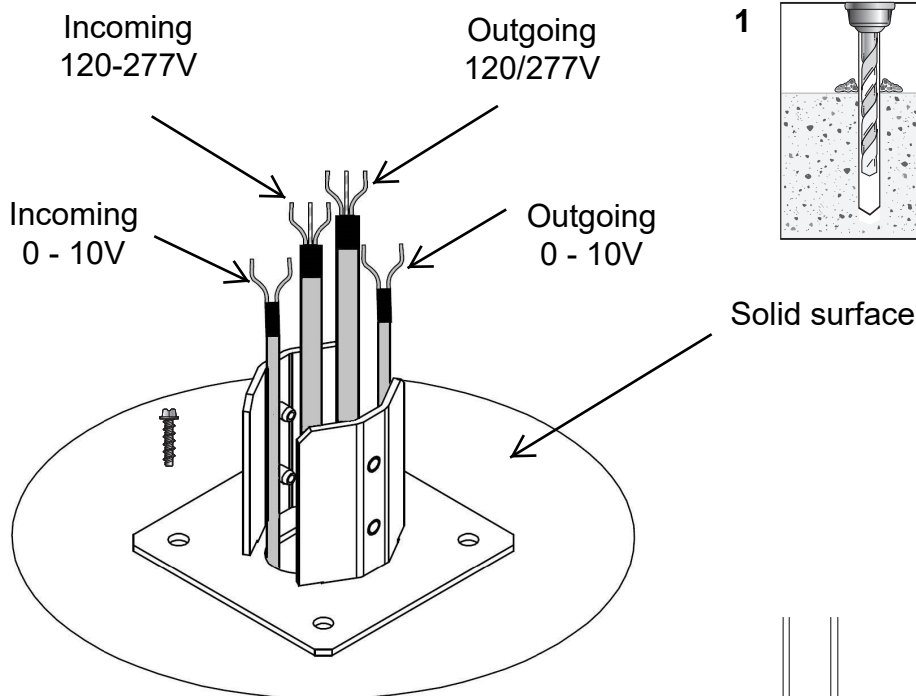

Concrete bolt/anchors  
**\*Not included**

Leveling (by others) washers can be inserted under mounting base to slightly tilt bollard if needed

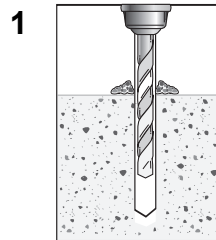

1 Use proper size drill bit to drill holes (4 holes required)

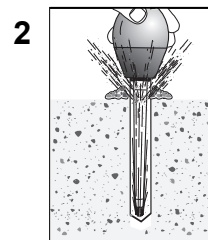

2 Clean holes using air nozzle (remove all debris)

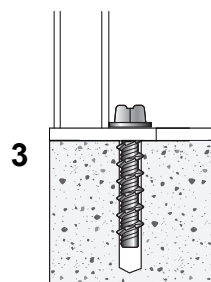

3 Place mounting base in position then drive anchor bolts using impact hammer and drill until fully seated. Use leveling washers if needed to slightly tilt bollard

# Installation Diagram

## 1E3741

### Surface Installation

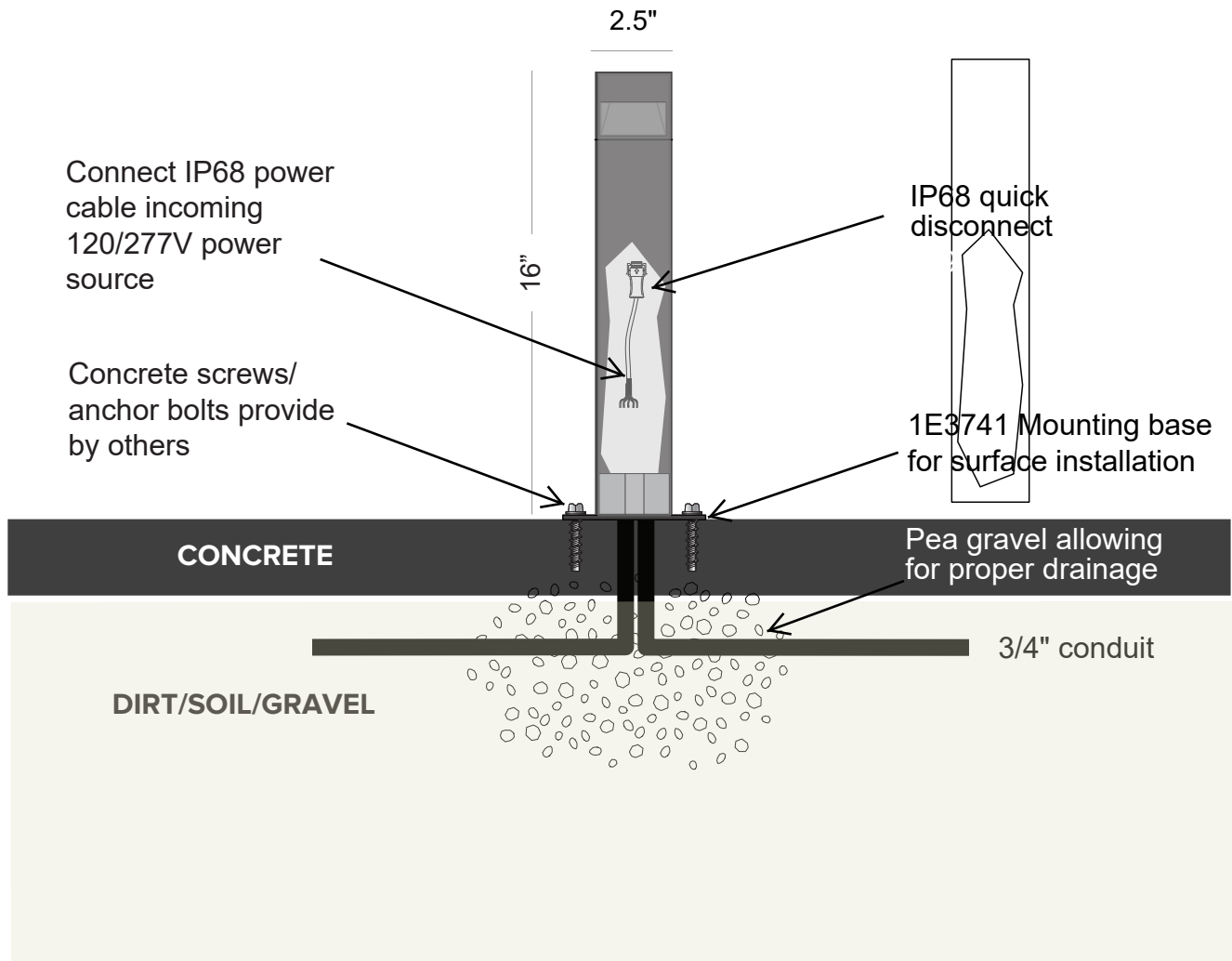

# Concrete Anchor Base Installation 1E3740

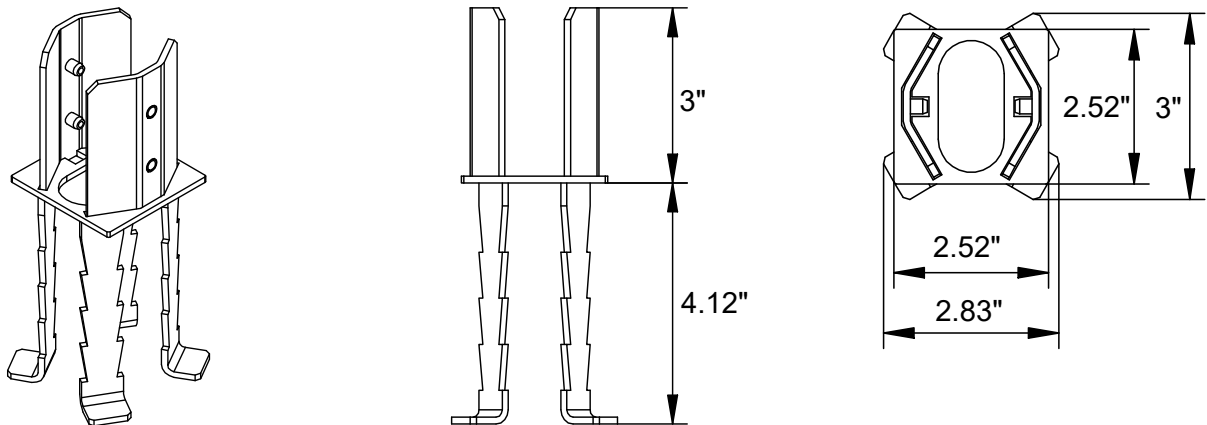

Concrete Anchor base for concrete pouring.

Concrete surface to be set  
under the mounting base

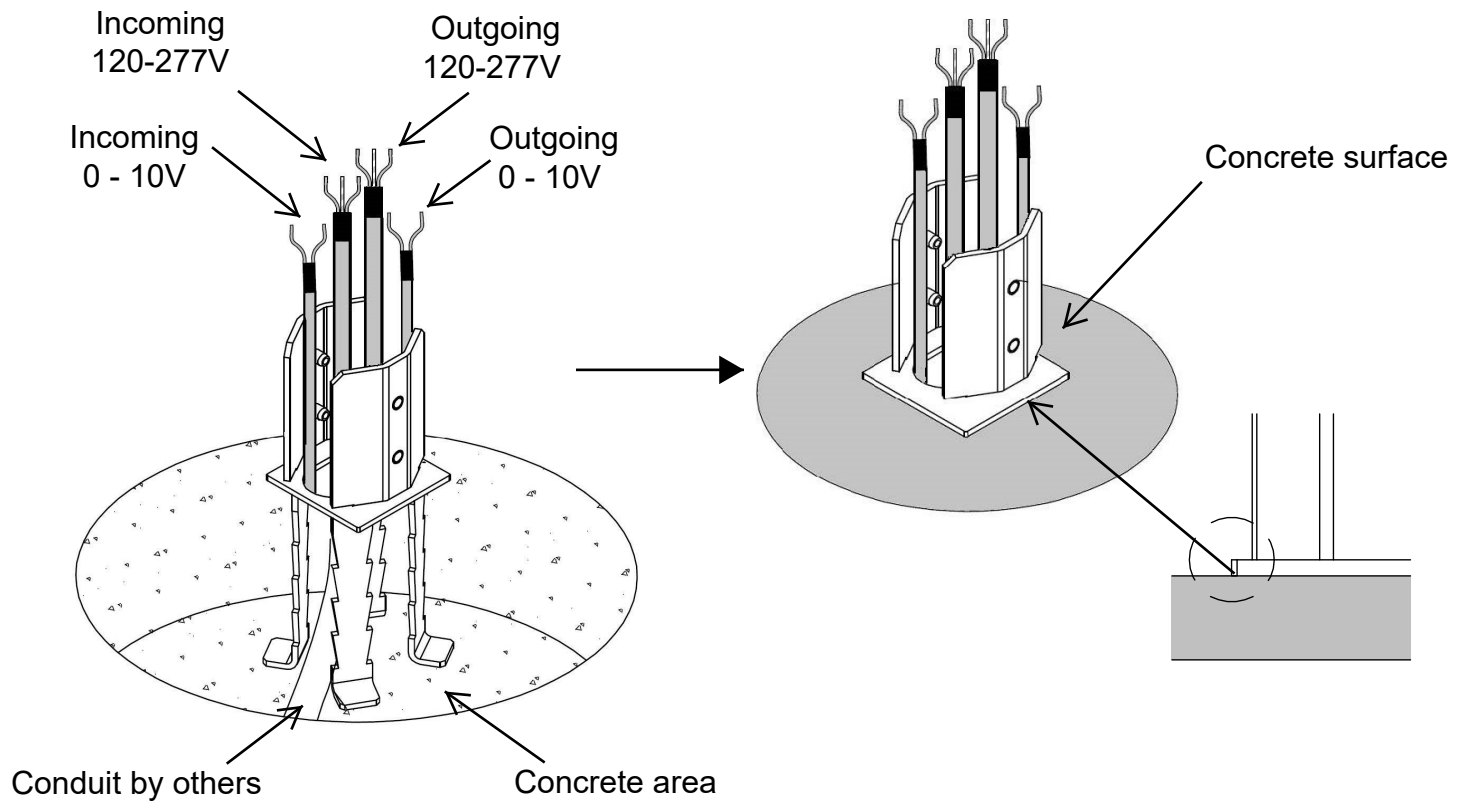

# Installation Diagram 1E3740

## Concrete Pour Installation

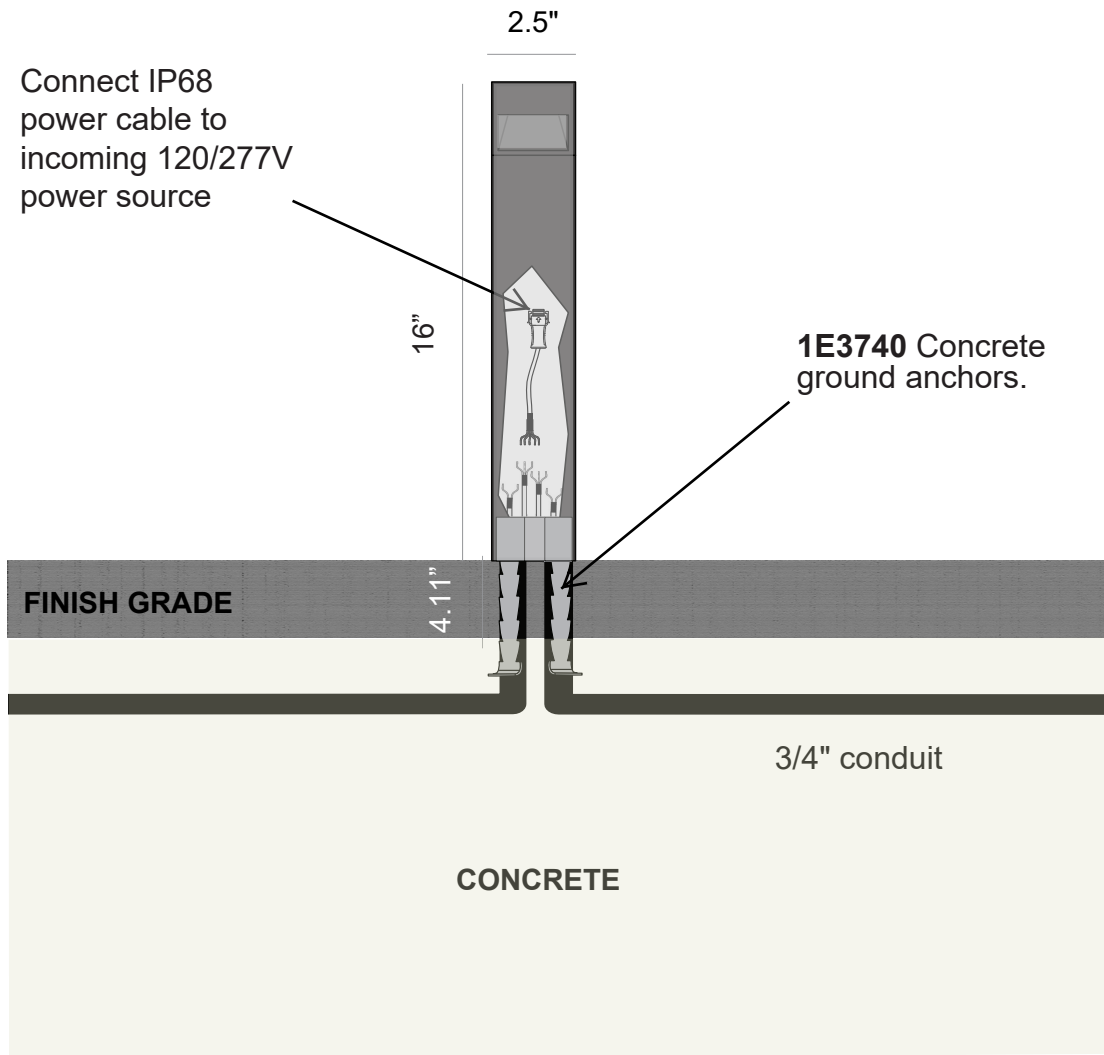

# Bollard Installation

Start by unboxing the bollard from its original package, then put the bollard/base mounting screws aside. Rest the bollard on the cardboard for protection and proceed to make wire connections inside J-Box.

- After the mounting base has been installed and power cord connections have been made inside the J-Box, proceed to install the bollard onto the base.
- Simply insert the bollard into position, then remove the screws from the bag and drive them in holding the bollard onto the base as shown on images bellow.
- Be sure to use all 4 screws 2 on each side and tighten.
- Please recycle all recyclable materials.

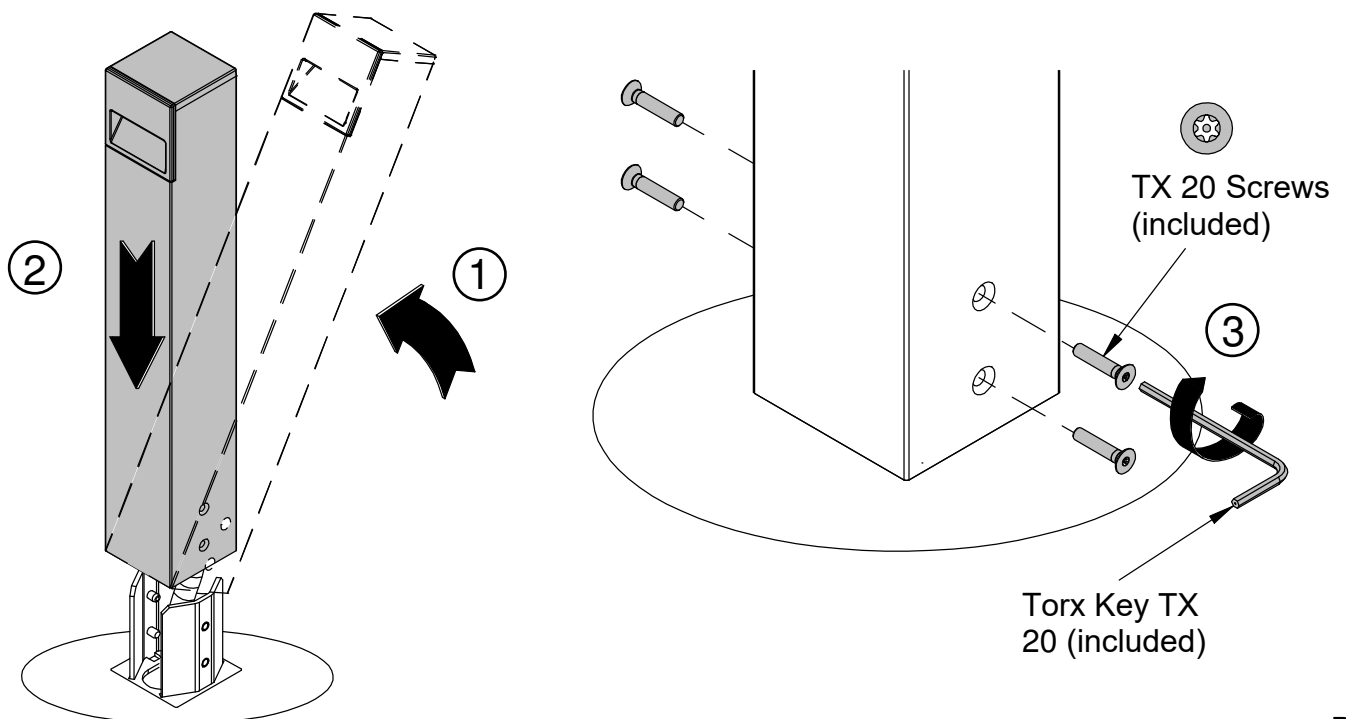
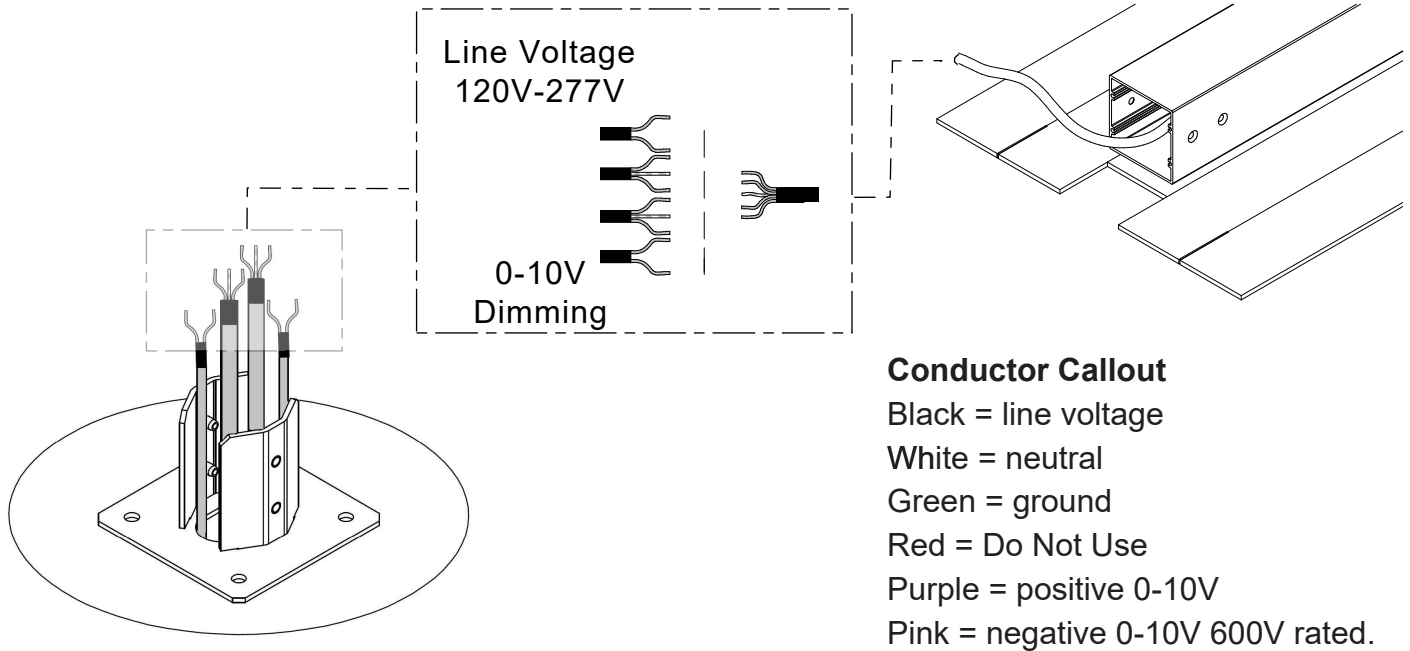

# Wiring Diagram

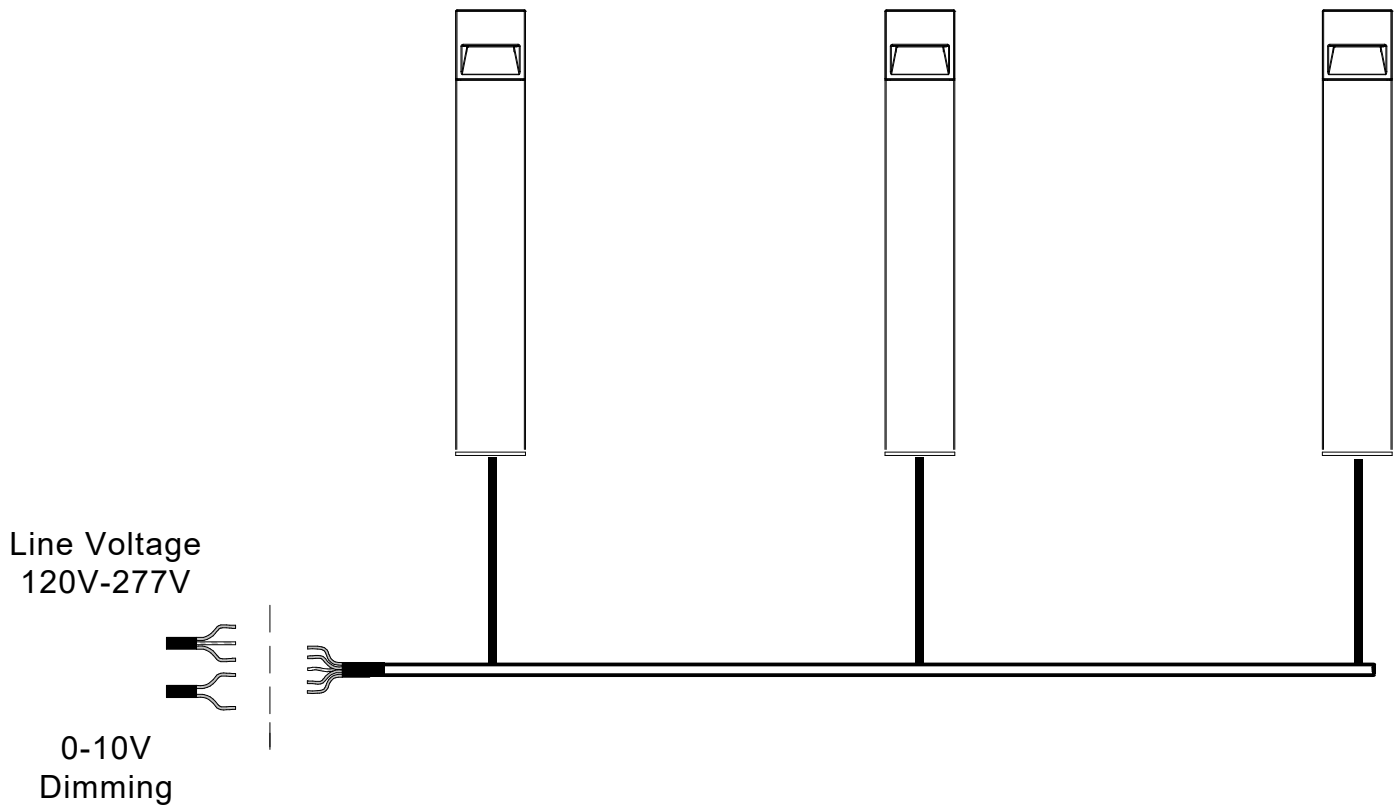

## Distribution of Light

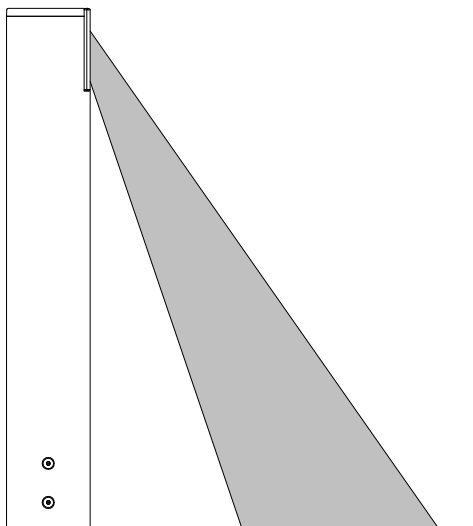

FLOOR WASHER

---

## Maintenance

This fixture was designed and manufactured for a durable, long lasting use with minimum care. To ensure the maximum lifespan of this product, we encourage our customers to provide a quality visual inspection of the fixture and installation accessories every six months. If there are any visible signs of issues (i.e moisture or dust) during the inspection, please clean any of the dust or moisture with a soft cloth and check to make sure that any of the fixtures are still operating normally. If there are any issues regarding the fixture please contact us as we will assist the situation at hand.

---

## Support

Any questions, problems, or comments you have please feel free to contact our Customer Service department during our business hours Monday-Friday 8am-5pm via: Email: [usaorders@targetti.com](mailto:usaorders@targetti.com)

Phone: (714) 513-1991

Visit our website: <http://www.targettiusa.com>