

ZENO APPLIQUE MEDIUM

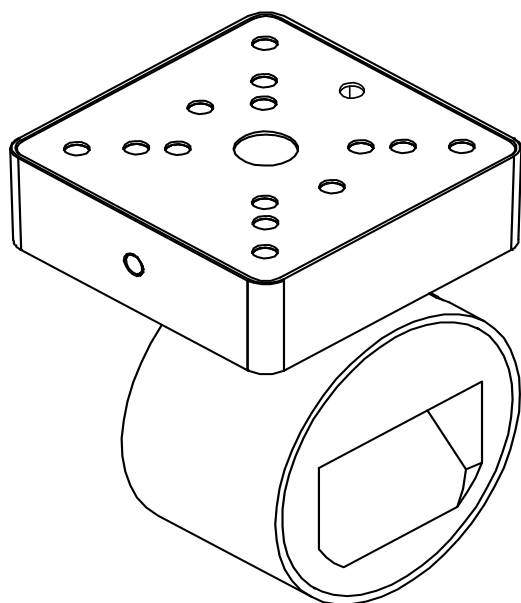

**Product Code: ZEA41PW
ZEA41DB**



UNIVERSAL 120/277V AC 50/60Hz

ZENO Medium Applique
28W Led source
28W Fixture
Color Temp 2700K / 3000K / 3500K / 4000K
CRI: +97Ra



If in doubt about the symbols refer
to catalog or website.

**- DO NOT ELECTRIFY THE TRACK SYSTEM DURING THE
INSTALLATION.**

**THE INTEGRATED ELECTRONIC BALLASTS COULD CAUSE IN RUSH
CURRENT THAT COULD DAMAGE THE SAFETY OF THE ELECTRICAL
POWER SYSTEM**

WARNING

**To ensure a maximum efficient use
of the product, read the instructions
before proceeding installment.**

This fixture must be installed by a licensed and qualified electrician. The installer must comply with NEC and local building codes when installing the fixture

Electrical current can cause painful shock, serious injury, or even death. Make sure you turn off the power supply, ground fixture(s), and make sure all electrical connections are correct and secured

Keep the label of the original packaging if any eventual future claims are needed

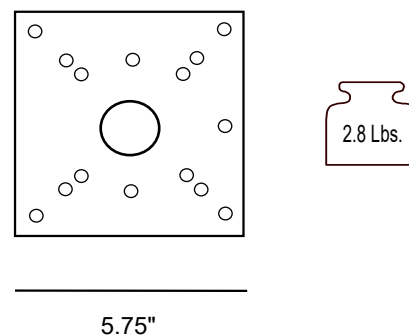
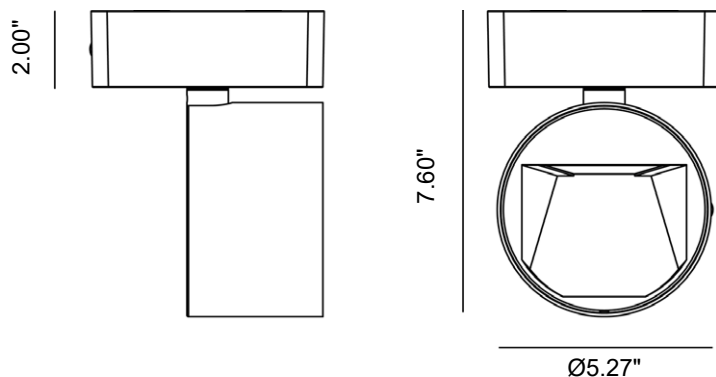
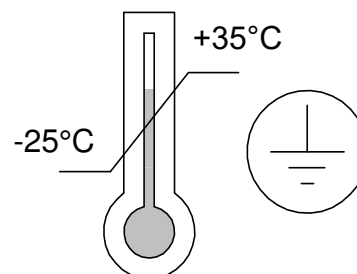
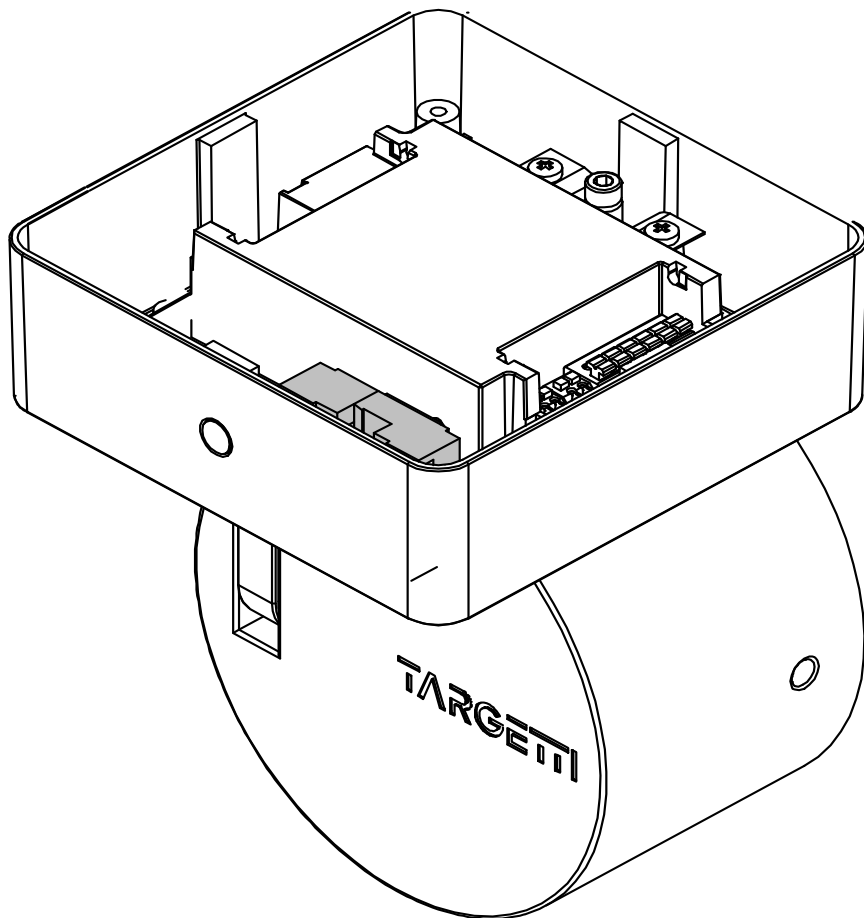

Table of Contents

Packaging Contents	Pg.3
Wiring / Conduit Feed Point Mounting	Pg.4
Wiring / Recessed J-Box Mounting	Pg.5
Installation	Pg.6
Beam Aiming / Disassembly	Pg.7/8
Maintenance / Support Page	Pg.9

Each Zeno Applique Surface Mount fixture comes with a pre-assembled fixture with connector



All surface mount installation must be correctly secured by the correct mounting fasteners based on mounting surface. Mounting of fixture must also comply with NEC and local building code.

Packaging Contents

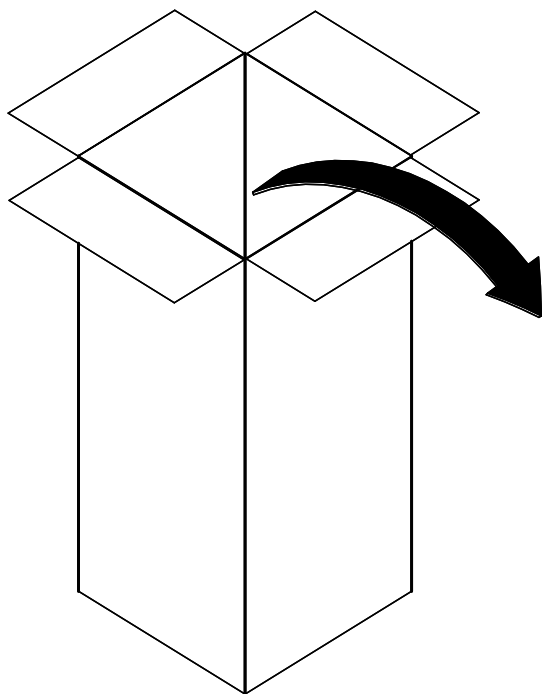

Box 13"X8"X8"

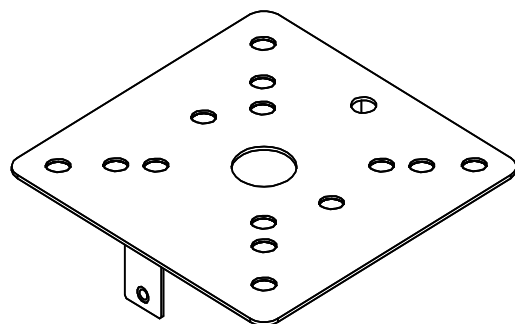

*Universal J-Box Mounting
Plate*



Cover Plug



Locking screw

5 Pin connector

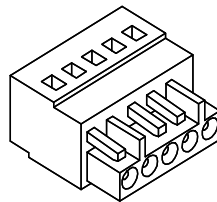

Connector tool

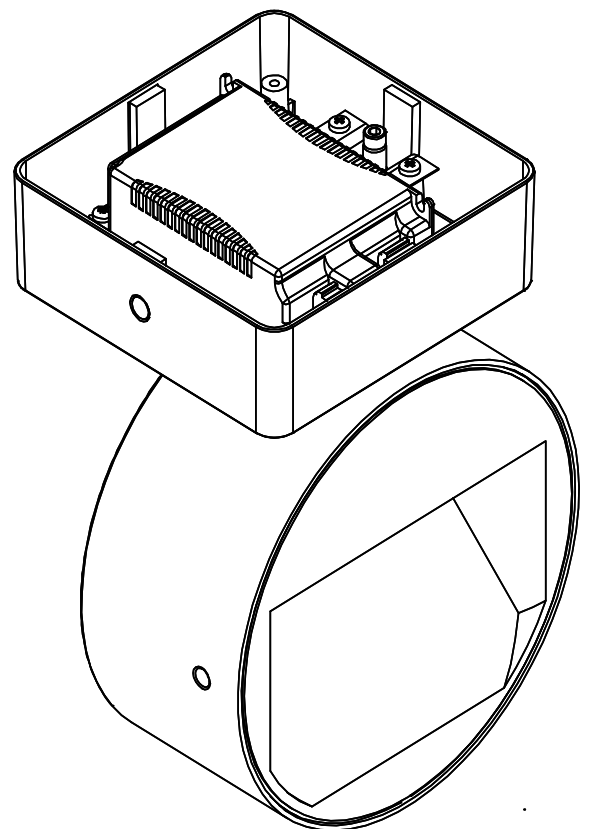
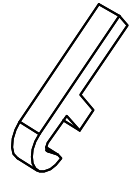

Zeno Applique Fixture

Conduit Feed Point Mounting Instructions

Wiring Diagram

****Diagram not drawn to scale****

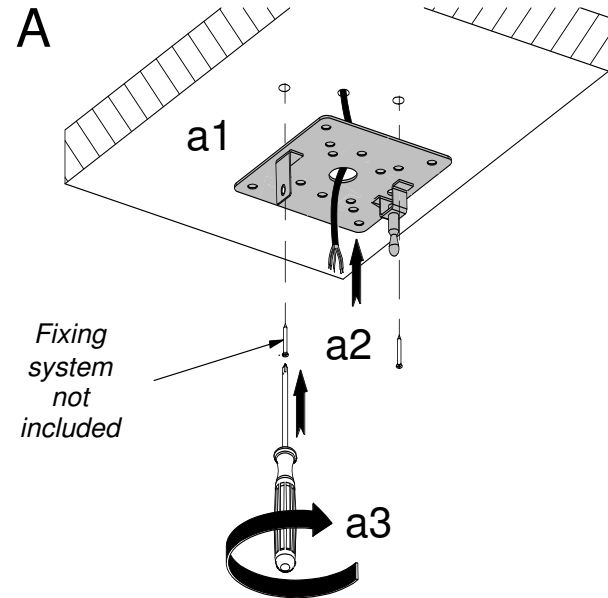
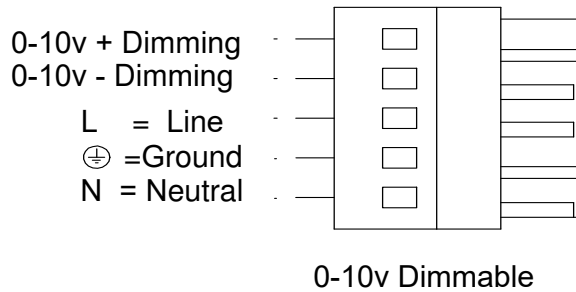

B

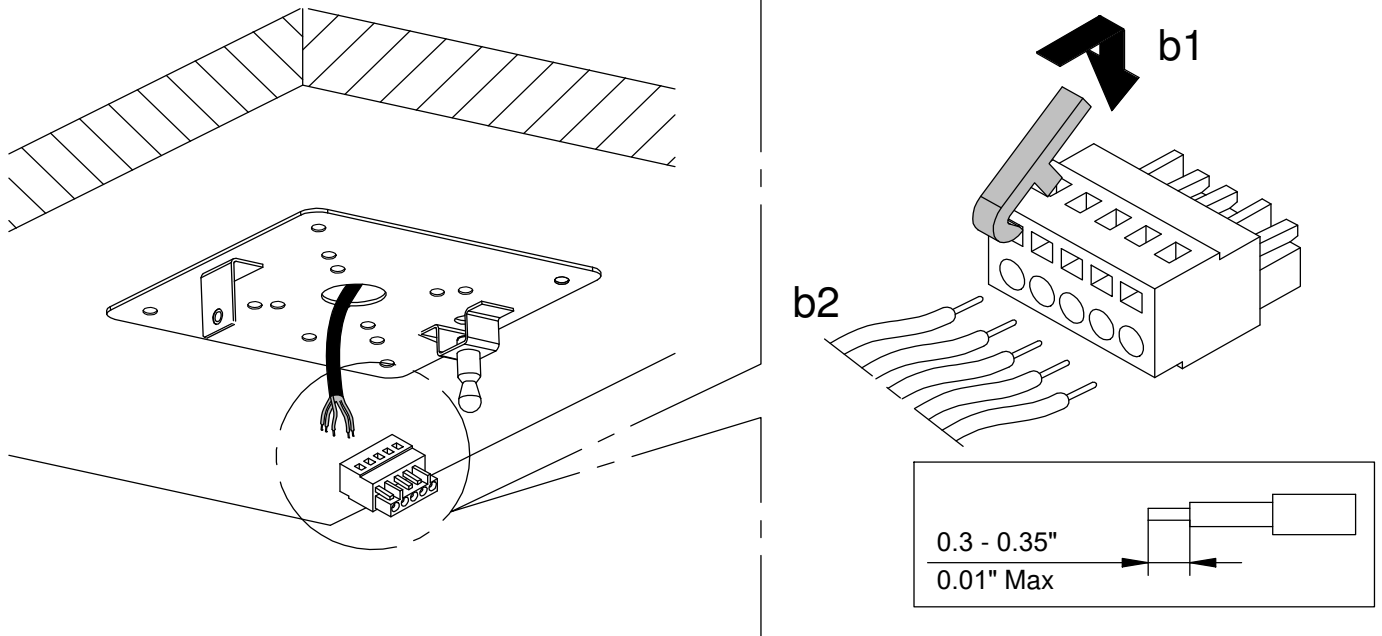

Recessed J-Box Mounting Instructions

Wiring Diagram

Diagram not drawn to scale

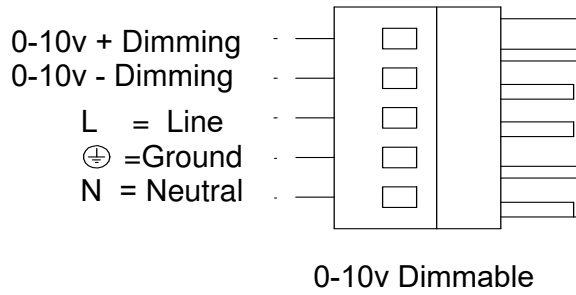

A

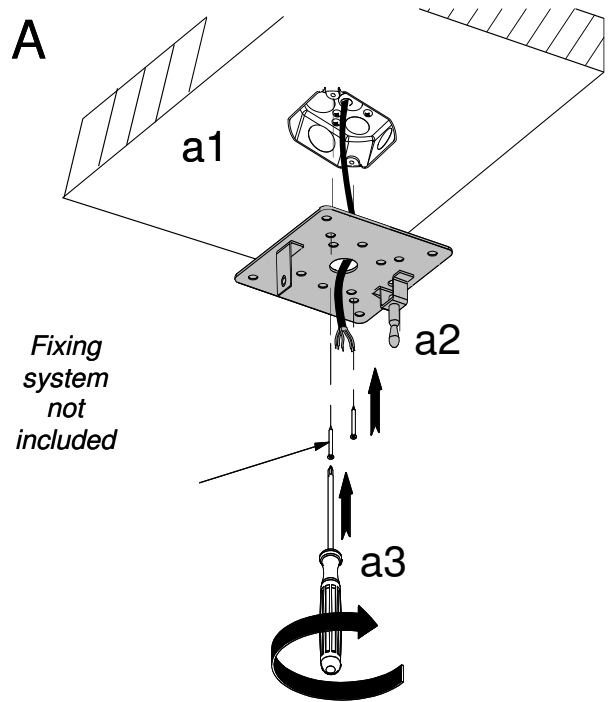

B

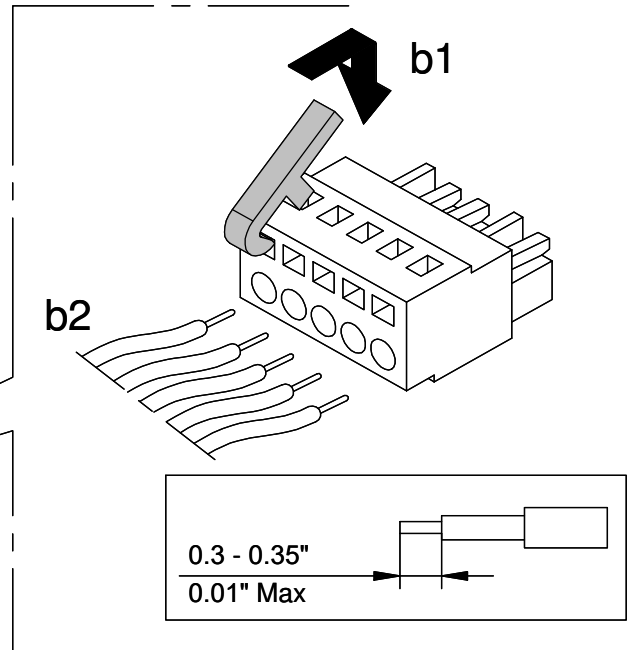
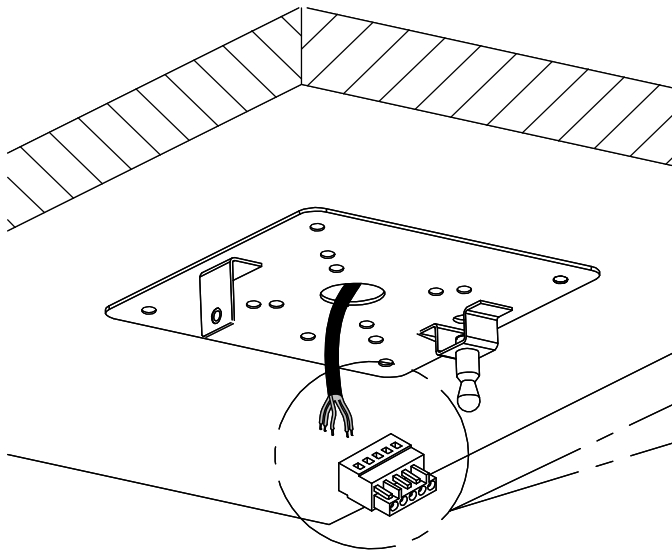

C Mounting Diagram

Diagram not drawn to scale

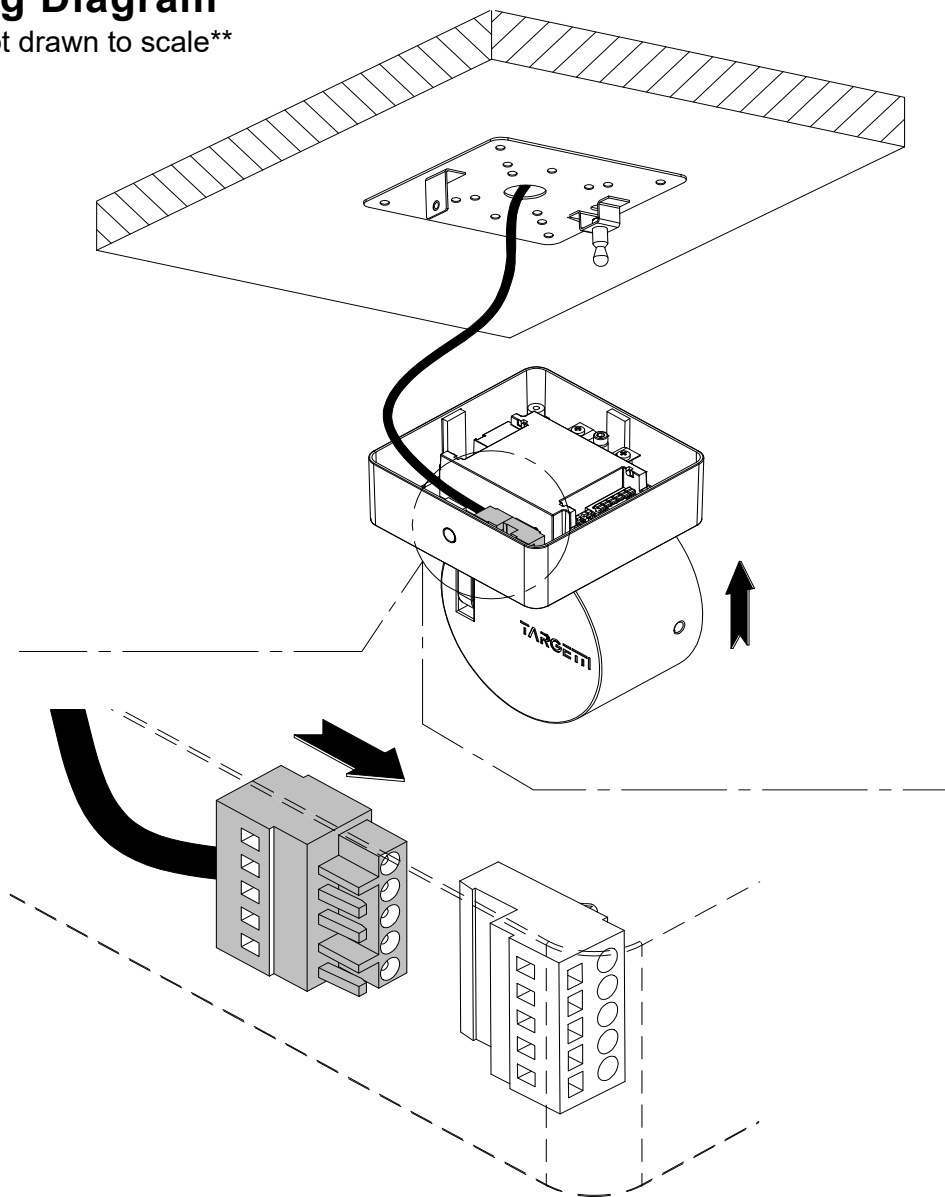

MOUNTING RECOMMENDED FOR UNIFORMITY OF LIGHT

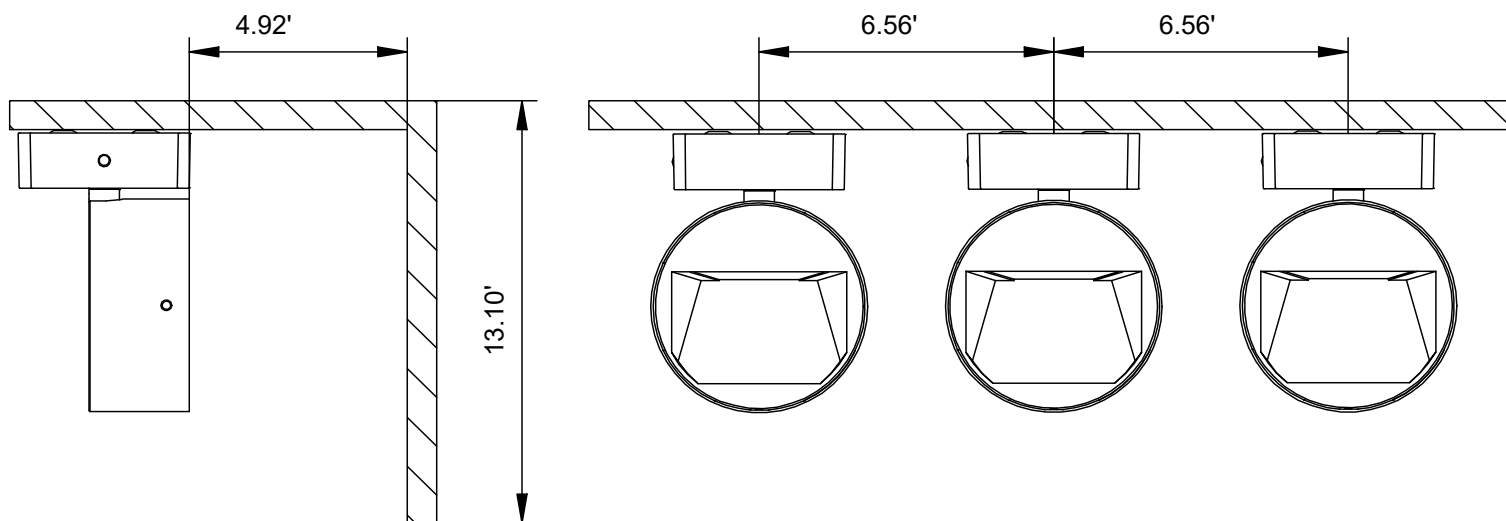

All surface mount installation must be correctly secured by the correct mounting fasteners based on mounting surface. Mounting of fixture must also comply with NEC and local building code.

D Mounting Diagram

****Diagram not drawn to scale****

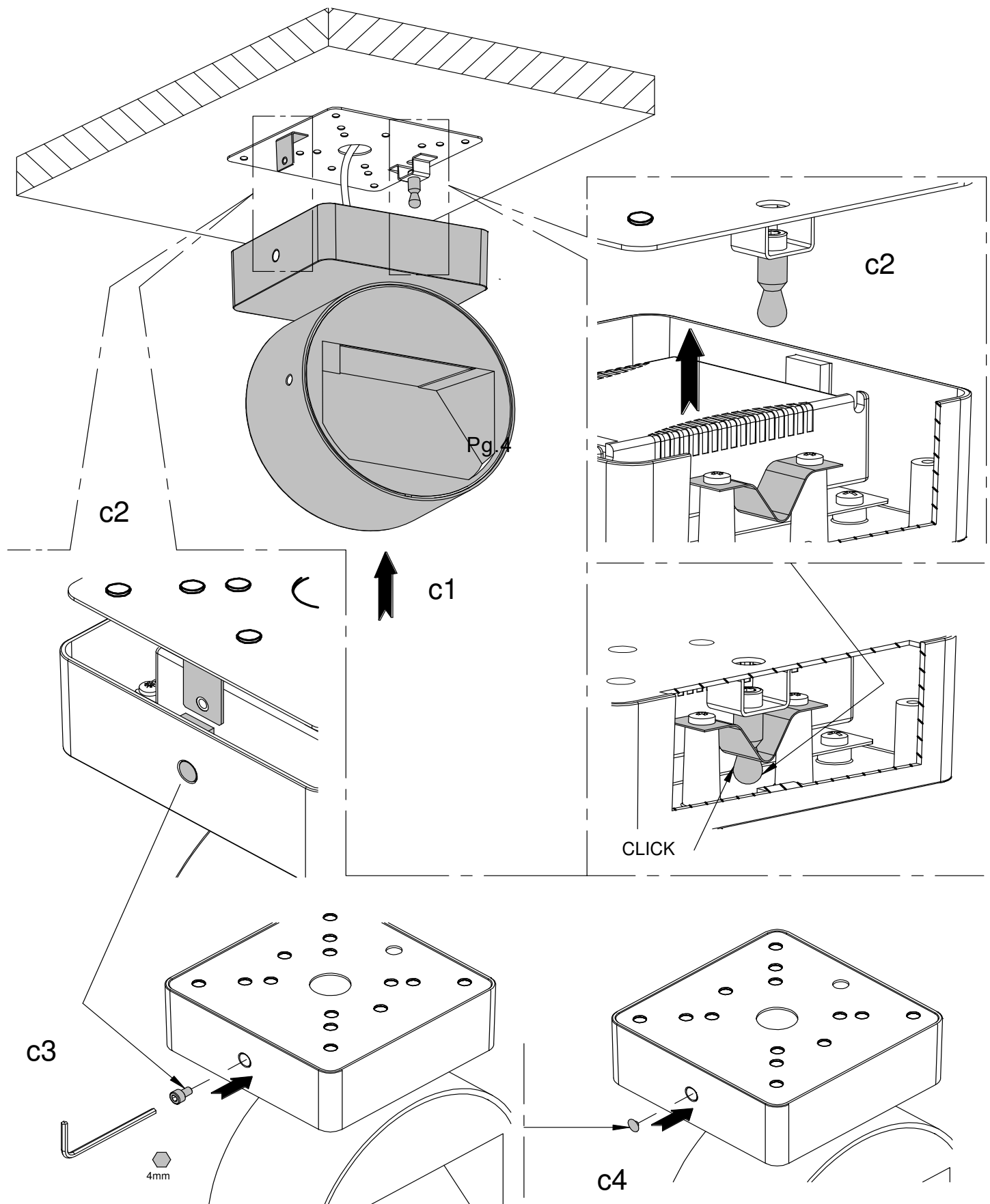

E

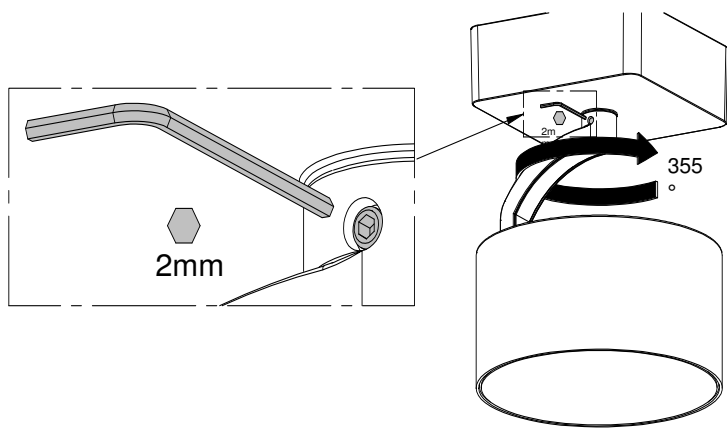

F

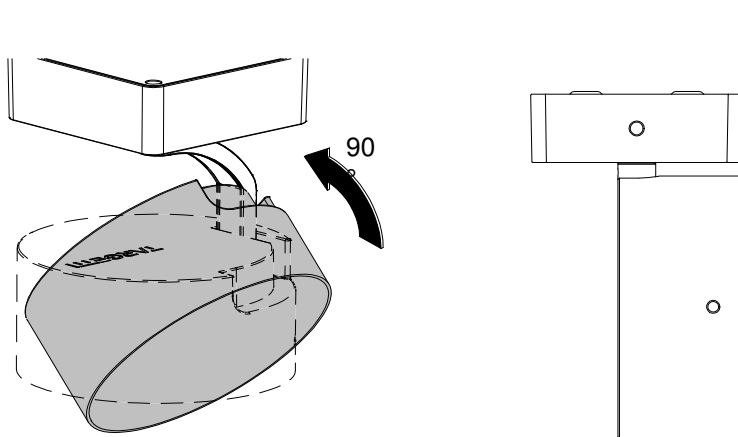

ONLY FOR DISASSEMBLY

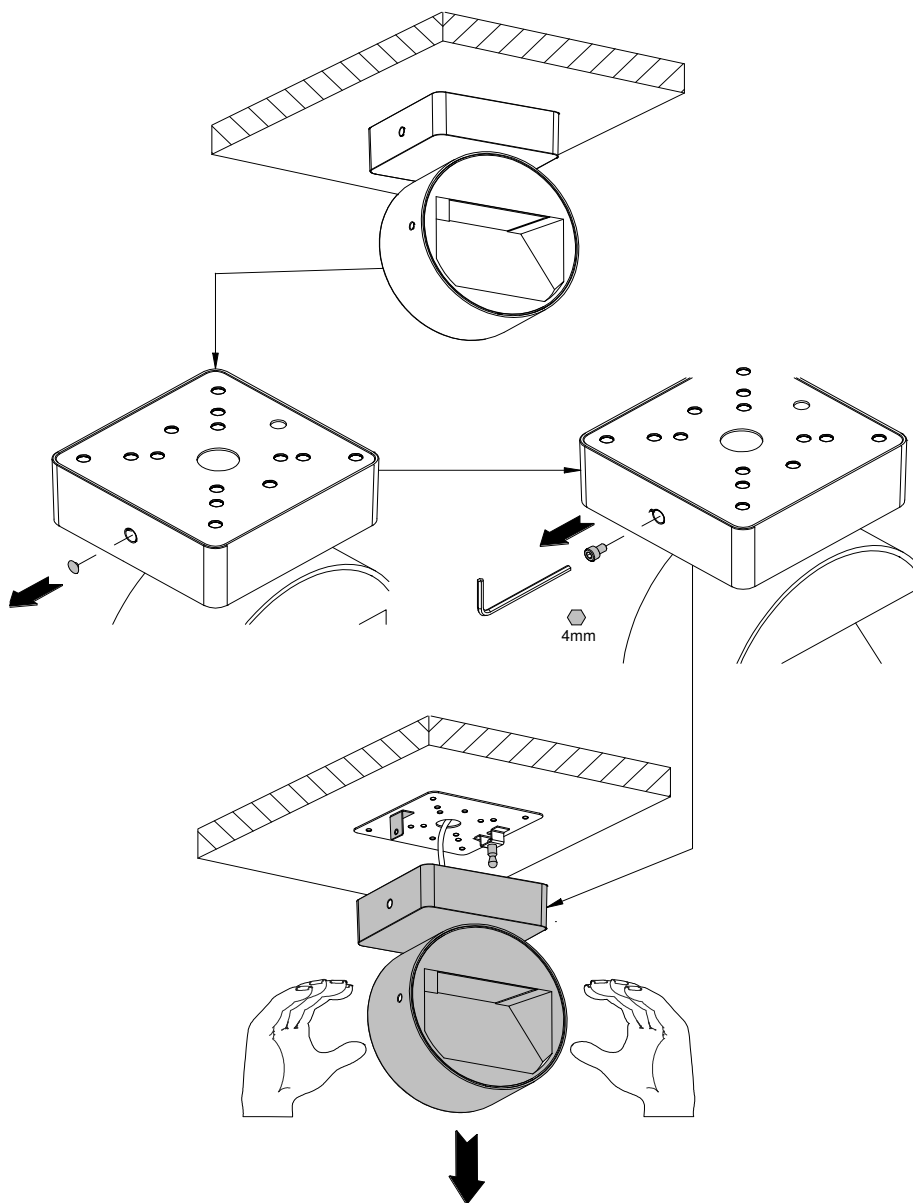

Maintenance

This fixture was designed and manufactured for a durable, long lasting use with minimum care. To ensure the maximum lifespan of this product, we encourage our customer to provide a quality visual inspection of the fixture every six months.

If there are any visible sign of issues (i.e moisture or dust) during the inspection, please clean any of the dust or moisture with a soft cloth and check to make sure that any of the fixtures are still operating normally. If there are any issues regarding the fixture please contact us as we will assist the situation at hand.

Support

Any questions, problems, or comments you have please feel free to contact our Customer Service department during our business hours Monday-Friday 8am-5pm via:

Email: usaorders@targetti.com

Phone: (714) 513-1991

Visit our website: <http://www.targetti.us>