

DART SMALL EVENT POLE

Multi-headed Event Pole with Professional Adjustable Floodlight Projector

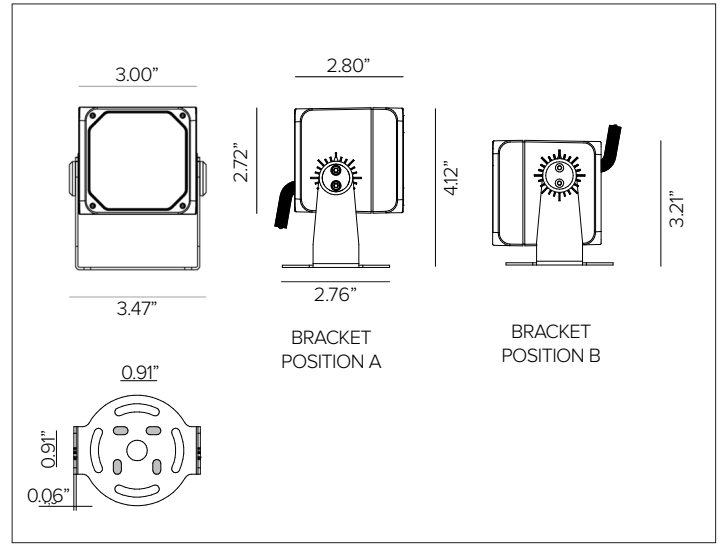

Event Pole with DART SMALL shown in Ferrite Dark Grey finish.



CONCEPT

Event pole with extremely small footprint adjustable LED floodlight projector.

FIXTURE MECHANICAL CHARACTERISTICS

Housing	3.00" W x 2.80"D
Materials	Die-cast aluminum powder coated body and joints for maximum heat dissipation.
Finish	Textured finish. ● Ferrite Dark Grey
Power Connection	Pre-cabled with 25' Belden direct burial 18ga 2 conductor cable for connection to remote power supply.
Functionality	Fixture can be installed directly to mounting surface or used with optional mounting installation accessories.
Weight	1.5lbs
Protection	IP66
Resistance	IK10

POLE MECHANICAL CHARACTERISTICS

Materials	Steel pole: Hot-galvanized EN ISO 1461. Integral hatch door for utility power.
Finish	Textured finish. ● Ferrite Dark Grey
Foundation	(13' / 16') 31.5" x 31.5" x 31.5" H / (19') 39.4" x 39.4" x 39.4"H
Anchor Bolts	(4pcs) 3/4" x 24" x 3" J-Bolts included
Horizontal Displacement	CL1
Thickness	0.12"
MPH	140mph
EPA	Individual fixture: 0.130 sqft 4 fixtures max: 0.518 sqft 8 fixtures max: 1.037 sqft

CERTIFICATIONS

cULus Wet Location Listed.
Tested in accordance with LM-79-08.
Compliant for California installations.
IEC 62471
RoHS3 EU 215/863

WARRANTY

5 year limited warranty
^Consult factory for use in marine grade environments.

ELECTRICAL CHARACTERISTICS

Power Supply	Remote Class 2 120V-277V AC power supply required, ordered separately.
Wattage	3W (NSP) / 15W nominal (SP / FL / MWFL)
Voltage	24V DC

SOURCE

NSP optic uses high efficiency LED Emitter. SP / FL / MWFL optics use high efficiency LED Chip on Board.

TM30	CCT (Nominal)	CRI	Rf	Rg	MR	SDCM
	2700K	81	80	97	2	2
	3000K	82	82	97	2	2
	3500K	82	81	97	2	2
	4000K	82	81	97	2	2

Ro90 available upon request.

OPTIC

Optical system is dependent on beam angle. NSP, SP and FL versions comprised with methacrylate lenses. MWFL version comprised of precision optics with convex reflective anodized aluminum facets.

Beam	NSP 9°	SP 17°	FL 32°	MWFL 46°
Delivered Lumens	3000K 147Lm 4000K 156Lm	1347Lm 1424Lm	1450Lm 1462Lm	1691Lm 1705Lm
<i>For 2700K lumen values use multiplier of 0.96 from 3000K. For 3500K lumen values use multiplier of 1.02 from 3000K.</i>				
Efficacy	25Lm/W max. Refer to photometric graphs for specific values.			
Lifetime	NSP: L80/B10 60,000hrs at max TA +25°C SP/FL: L80/B10 80,000hrs at max TA +25°C MWFL: L80/B10 100,000hrs at max TA +25°C			
Photobiological Classification	Low risk safety RG1			

CERTIFICATIONS

cULus Class 2 Wet Location Listed E479873.
Tested in accordance with LM-79-08.
Compliant for California installations.
IEC 62471

DART SMALL EVENT POLE

SPECIFICATION INFORMATION



Ex: DASRPFE1NS2724PM / DELV30124D / 1USP01FE13S / 1USP02BKTFS

1 - PRODUCT CODE	2 - DRIVER	3 - FINISH	4 - WATTAGE	5 - OPTICS	6 - KELVIN	7 - VOLTAGE	8 - POWER SUPPLY
DAS — DART SMALL	RP — Remote Power	FE — Ferrite Dark Grey	L1 — 3W L2 — 15W	NS ^a — NSP 9° SP — SP 17° FL — FL 32° MF — MWFL 46°	27 — 2700K 30 — 3000K 35 — 3500K 40 — 4000K	24 — 24V DC	Standalone Driver See section for details
9 - EVENT POLE	10 - MOUNTING BRACKET	11 - POLE ACCESSORIES	12 - OPTICAL ACCESSORIES				
13ft Pole See section for details 16ft Pole See section for details 19ft Pole See section for details	1 Fixture Bracket See section for details 2 Fixture Bracket See section for details 3 Fixture Bracket See section for details 4 Fixture Bracket See section for details	Decorative Base Cover See section for details	Filter Holder Ring See section for details Blade of Light Linear Spread Lens See section for details Anti-Glare Louver See section for details Asymmetric Snoot See section for details Lumishape Optical Accessories See section for details				

^a NS option not available in 2700K or 3500K

^b 25ft lead wire included with quick disconnect to be used with pole mounting option.

8 - POWER SUPPLY (REQUIRED)

STANDALONE								
Part No.	Wattage	Control	Dim Range	Rating	In / Out Voltage	Certification	Dimensions (Standalone)	Description
DELV30124D	30W	0-10V	1%	IP65	120-277V / 24V	UR Class 2	7.5" X 2.4" X 1.4"	Magnitude SOLIDrive electronic standalone driver. UL listed enclosure provided by others.
DELV60124D	60W	0-10V	1%	IP65	120-277V / 24V	UR Class 2	7.5" X 2.4" X 1.4"	Magnitude SOLIDrive electronic standalone driver. UL listed enclosure provided by others.
DELV96124D	96W	0-10V	1%	IP65	120-277V / 24V	UR Class 2	7.5" X 2.4" X 1.4"	Magnitude SOLIDrive electronic standalone driver. UL listed enclosure provided by others.

MAX FIXTURES PER DRIVER

Fixture Wattage	Driver Wattage				
	30W	60W	96W	2X96W	3X96W
3W	8	16	25	25+25	25+25+25
15W	1	3	5	5+5	5+5+5

DART SMALL EVENT POLE

9 - EVENT POLE (REQUIRED)

13ft round powder coated steel pole. Hot-galvanized EN ISO 1461 with integral hatch door for utility power. Maximum of 1 bracket (4 fixtures).

Level Single

Finish ● Ferrite Dark Grey

Part No. **1USP01FE13S**

16ft round powder coated steel pole. Hot-galvanized EN ISO 1461 with integral hatch door for utility power. Maximum of 1 bracket (4 fixtures).

Level Single

Finish ● Ferrite Dark Grey

Part No. **1USP01FE16S**

Level Single Dual

Part No. **1USP01FE19S 1USP01FE19D**

19ft round powder coated steel pole. Hot-galvanized EN ISO 1461 with integral hatch door for utility power. Maximum of 2 brackets (8 fixtures max).

Level Single

Finish ● Ferrite Dark Grey

Part No. **1USP01FE16S**

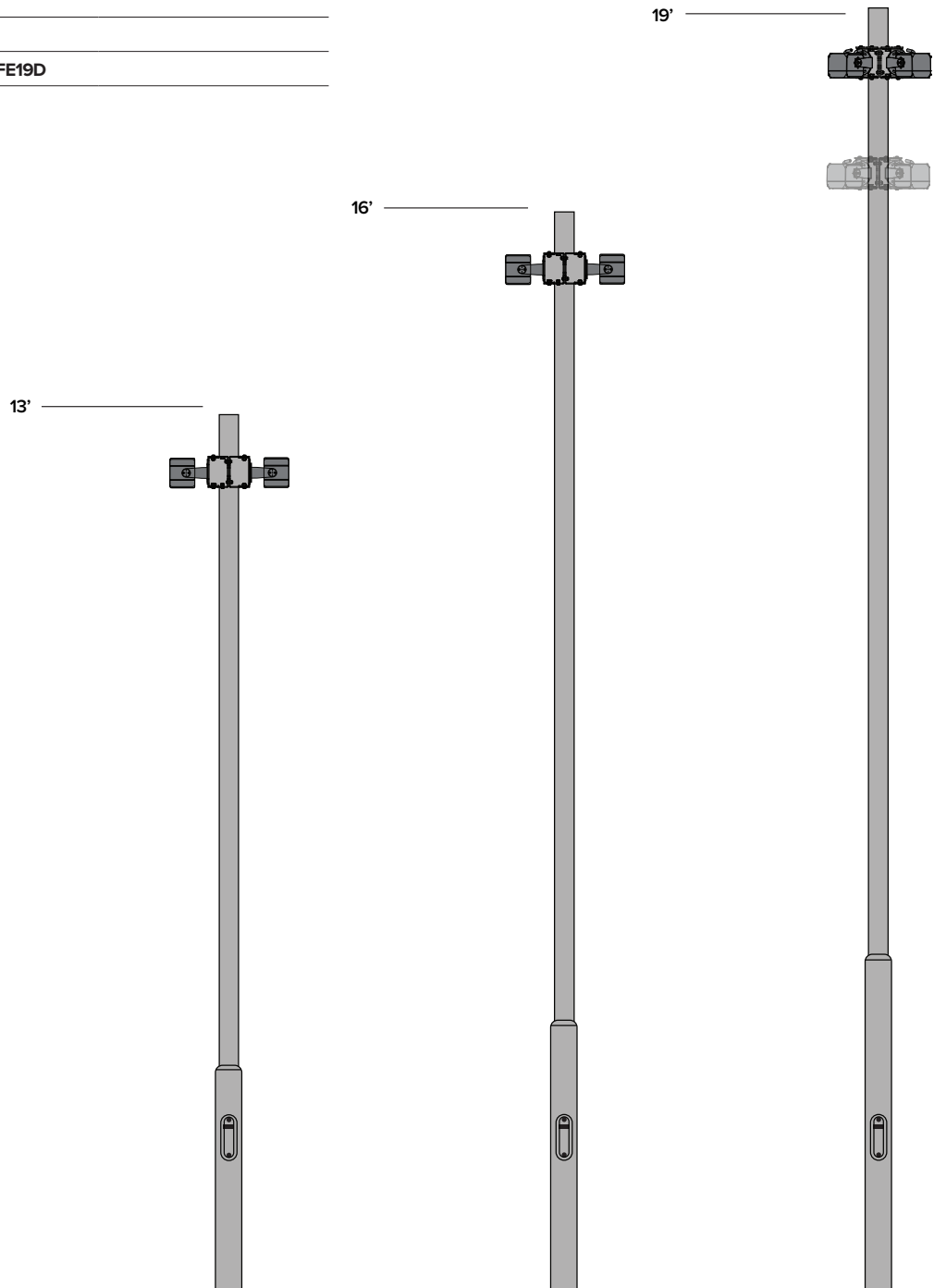

DART SMALL EVENT POLE

10 - MOUNTING BRACKET (REQUIRED)

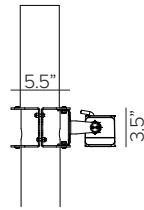
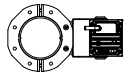

Mounting bracket, 1 fixture max.

Finish ● Ferrite Dark Grey

Part No. **1USP01BKTFES**

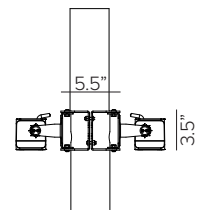
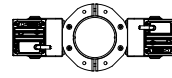

Mounting bracket, 2 fixtures max.

Finish ● Ferrite Dark Grey

Part No. **1USP01BKTFED**

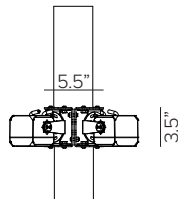
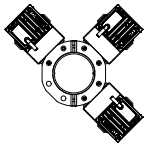

Mounting bracket, 3 fixtures max.

Finish ● Ferrite Dark Grey

Part No. **1USP01BKTFET**

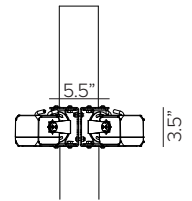
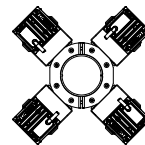

Mounting bracket, 4 fixtures max.

Finish ● Ferrite Dark Grey

Part No. **1USP01BKTFEQ**

11 – POLE ACCESSORY (OPTIONAL)

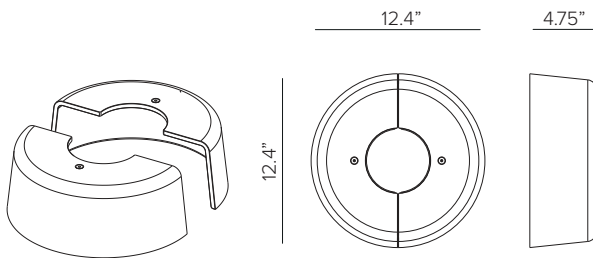

Aluminum decorative pole base cover.

Finish ● Ferrite Dark Grey

Part No. **1USP01CVR02FE**

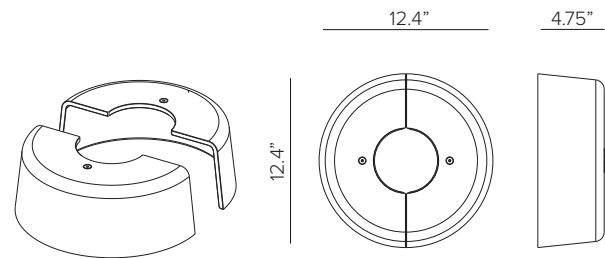

Iron decorative pole base cover. To be used in environments that may have impact.

Finish ● Ferrite Dark Grey

Part No. **1USP02CVR01FE**

DART SMALL EVENT POLE

13 – OPTICAL ACCESSORIES (OPTIONAL)

MAXIMUM OF TWO ACCESSORIES PER FIXTURE.

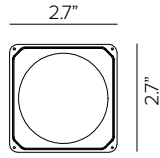

Filter holder ring. CNC machined anodized and powder coated aluminum. **Required for use of all filters.**

Part No. **1E3011** (*)



'Blade of Light' linear spread lens. PMMA holographic filter. **To be completed with 1E3011 dedicated holder ring. Does not apply toward maximum accessory count.**

Part No. **1E3012**

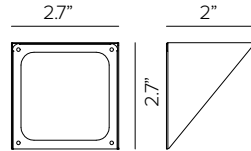

Asymmetric snoot. Powder coated stainless steel. Cutoff 30.4°. **Not compatible with 1E3014.**

Part No. **1E3013** (*)

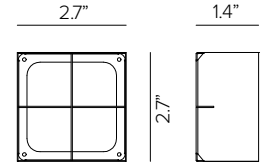

Anti glare louver with removable baffles in deep black finish for different levels of glare control. Extrusion powder coat stainless steel. Cutoff 43.4°. **Not compatible with 1E3013.**

Part No. **1E3014** (*)



Water jet cut stainless steel round pinhole LUMISHAPE light shield. **Performs best with NSP or SP optic.**

Finish ● Deep Black

Part No. **LS05701**



Water jet cut stainless steel round circular LUMISHAPE light shield. **Performs best with SP or FL optic.**

Finish ● Deep Black

Part No. **LS05702**



Water jet cut stainless steel square pinhole LUMISHAPE light shield. **Performs best with NSP or SP optic.**

Finish ● Deep Black

Part No. **LS05703**



Water jet cut stainless steel square LUMISHAPE light shield. **Performs best with SP or FL optic.**

Finish ● Deep Black

Part No. **LS05704**

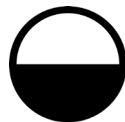

Water jet cut stainless steel half LUMISHAPE light shield. **Stackable up to 4pcs per fixture; 4pcs accounts to 1 accessory toward maximum accessory count. Performs best with FL or MWFL optic**

Finish ● Deep Black

Part No. **LS05705**

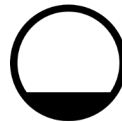

Water jet cut stainless steel quarter LUMISHAPE light shield. **Stackable up to 4pcs per fixture; 4pcs accounts to 1 accessory toward maximum accessory count. Performs best with FL or MWFL optic**

Finish ● Deep Black

Part No. **LS05706**

DART SMALL EVENT POLE

INSTALLATION DETAILS

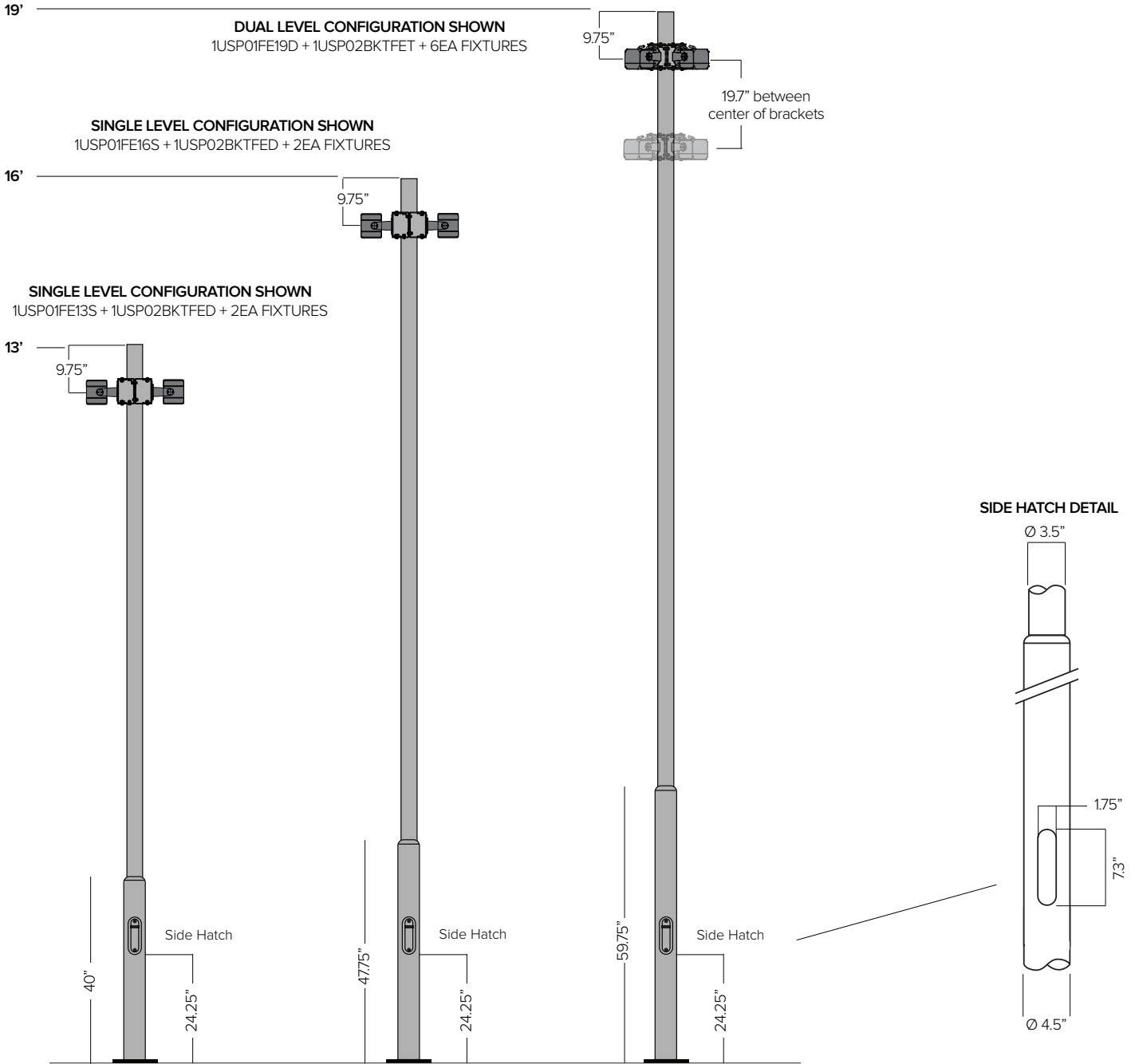

POLE BASE DETAIL

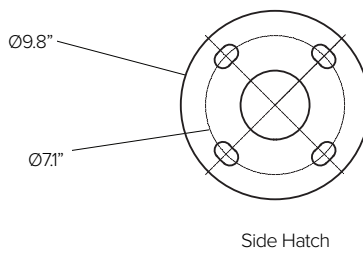

ANCHOR BOLT DETAIL

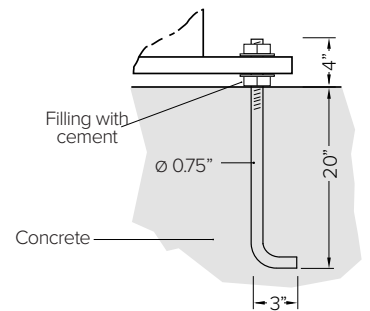

DART SMALL EVENT POLE

PHOTOMETRY

IES FILES WATTAGE AND EFFICIENCY CALCULATIONS BASED WITH SUPPLIED DRIVER

NARROW SPOT

3000K		H(m)	D(m)	Emax(lx)		
Ra80			9°			
Fixture Power	3W	1	0.15	4041		
Source Flux	200lm	2	0.30	1010		
Fixture Flux	147lm	3	0.46	449		
Efficacy	54lm/W	4	0.61	253		
TS937	Imax=20203cd/klm	Imax	4041cd	5	0.76	162

4000K		H(m)	D(m)	Emax(lx)		
Ra80			9°			
Fixture Power	3W	1	0.15	4283		
Source Flux	212lm	2	0.30	1071		
Fixture Flux	156lm	3	0.46	476		
Efficacy	58lm/W	4	0.61	268		
TS937	Imax=20203cd/klm	Imax	4283cd	5	0.76	171

SPOT

3000K		H(m)	D(m)	Emax(lx)		
Ra80			17°			
Fixture Power	15W	1	0.30	11214		
Source Flux	1913lm	2	0.61	2804		
Fixture Flux	1347lm	3	0.91	1246		
Efficacy	90lm/W	4	1.21	701		
TS1506	Imax=5862cd/klm	Imax	11214cd	5	1.52	449

4000K		H(m)	D(m)	Emax(lx)		
Ra80			17°			
Fixture Power	15W	1	0.30	11853		
Source Flux	2022lm	2	0.61	2963		
Fixture Flux	1424lm	3	0.91	1317		
Efficacy	95lm/W	4	1.21	741		
TS1506	Imax=5862cd/klm	Imax	11853cd	5	1.52	474

FLOOD

3000K		H(m)	D(m)	Emax(lx)		
Ra80			32°			
Fixture Power	14W	1	0.58	4295		
Source Flux	2146lm	2	1.15	1074		
Fixture Flux	1450lm	3	1.73	477		
Efficacy	107lm/W	4	2.31	268		
TS1507	Imax=2002cd/klm	Imax	4295cd	5	2.88	172

4000K		H(m)	D(m)	Emax(lx)		
Ra80			32°			
Fixture Power	14W	1	0.58	4331		
Source Flux	2164lm	2	1.15	1083		
Fixture Flux	1462lm	3	1.73	481		
Efficacy	108lm/W	4	2.31	271		
TS1507	Imax=2002cd/klm	Imax	4331cd	5	2.88	173

MEDIUM WIDE FLOOD

3000K		H(m)	D(m)	Emax(lx)		
Ra80			46°			
Fixture Power	14W	1	0.85	3048		
Source Flux	2146lm	2	1.70	762		
Fixture Flux	1691lm	3	2.54	339		
Efficacy	124lm/W	4	3.39	190		
TS1508	Imax=1421cd/klm	Imax	3050cd	5	4.24	122

4000K		H(m)	D(m)	Emax(lx)		
Ra80			46°			
Fixture Power	14W	1	0.85	3073		
Source Flux	2164lm	2	1.70	768		
Fixture Flux	1705lm	3	2.54	341		
Efficacy	125lm/W	4	3.39	192		
TS1508	Imax=1421cd/klm	Imax	3075cd	5	4.24	123