

BULLETTO LINE EVENT POLE

Multi-headed Event Pole with Professional Adjustable Floodlight Projector

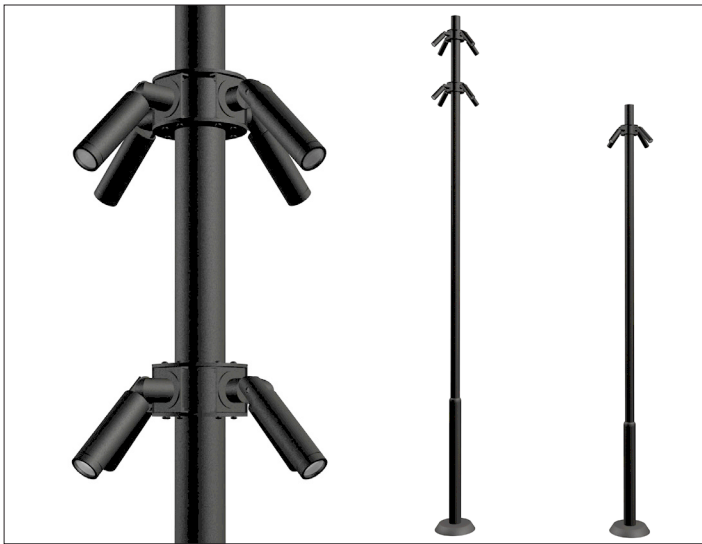

Event Pole with BULLETTO LINE shown in Ferrite Dark Grey finish.

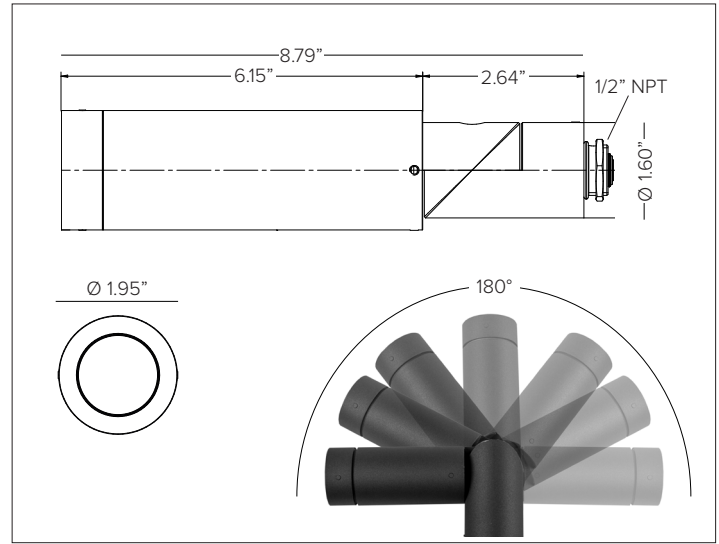

CONCEPT

Event pole with compact adjustable LED floodlight projector.

FIXTURE MECHANICAL CHARACTERISTICS

Housing	1.95" W x 8.79"D
Materials	Aluminum body and joints for maximum heat dissipation.
Finish	Textured finish. ● Ferrite Dark Grey
Power Connection	Pre-cabled with 10' Belden direct burial 18-6 cable, optional 25ft length for pole mounting.
Functionality	Modular body for toolless maintenance. IP66 protection rated optical chamber with removable front cap for simple toolless field interchangeability of optics and accessories.
Weight	2lbs
Protection	IP66
Resistance	IK08

POLE MECHANICAL CHARACTERISTICS

Materials	Steel pole: Hot-galvanized EN ISO 1461. Integral hatch door for utility power.
Finish	Textured finish. ● Ferrite Dark Grey
Foundation	31.5" x 31.5" x 31.5" H
Anchor Bolts	(4pcs) 3/4" x 24" x 3" J-Bolts included
Horizontal Displacement	CL1
Thickness	0.12"
MPH	140mph
EPA	Individual fixture: 0.054 sqft 4 fixtures max: 0.215 sqft 8 fixtures max: 0.432 sqft

CERTIFICATIONS

cULus Wet Location Listed.
Tested in accordance with LM-79-08.
Compliant for California installations.
IEC 62471
RoHS3 EU 215/863

WARRANTY

5 year limited warranty
^AConsult factory for use in marine grade environments.

ELECTRICAL CHARACTERISTICS

Power Supply	Integral 4/1 smart driver (Non-Dimmable / 0-10V / Reverse Phase / Forward Phase).
Wattage	9W (NSP) / 17W (SP/FL/MWFL/WFL)
Voltage	Universal Voltage 120-277V AC 50/60Hz

SOURCE

High efficiency LED Emitter

TM30	CCT (Nominal)	CRI	Rf	Rg	SDCM
	2700K	90	88	95	2
	3000K	90	91	98	2
	3500K	90	89	96	2
	4000K	90	88	94	2

OPTIC

Optical system is dependent on beam angle. NSP version PMMA lens and fixed holographic filter. SP / FL / MWFL / WFL versions equipped with PMMA lens and interchangeable optical holographic lens, factory preset per specified optic with other beams included in packaging.

Beam	NSP 9°	SP 16°	FL 25°	MWFL 31°	WFL 42°
Delivered Lumens	2700K 407Lm	1394Lm	979Lm	930Lm	764Lm
	3000K 430Lm	1085Lm	1054Lm	1001Lm	823Lm
	3500K 445Lm	119Lm	1088Lm	1033Lm	849Lm
	4000K 460Lm	1153Lm	1120Lm	1063Lm	874Lm
Efficacy	70Lm/W max. Refer to photometric graphs for specific values.				
Lifetime	L96/B10 30,000hrs at max TA +25°C L95/B10 50,000hrs at max TA +25°C L94/B10 80,000hrs at max TA +25°C L93/B10 100,000hrs at max TA +25°C				
Photobiological Classification	Low risk safety RG1				

BULLETTO LINE EVENT POLE

SPECIFICATION INFORMATION

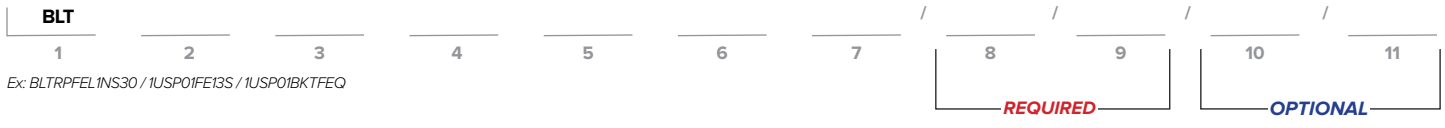

1 - PRODUCT CODE	2 - DRIVER	3 - FINISH	4 - WATTAGE	5 - OPTIC	6 - KELVIN	7 - CABLE
BLL — BULLETTO LINE	41 — 4/1 Smart Dimming (Non-Dimming / 0-10V / Reverse Phase / Forward Phase)	FE — Ferrite Dark Grey	L1 — 7W L2 — 17W	NS — NSP 9° SP — SP 16° FL — FL 25° MF — MWFL 31° WF — WF 42°	27 — 2700K 30 — 3000K 35 — 3500K 40 — 4000K	PM — 25ft Cable
8 - EVENT POLE	9 - MOUNTING BRACKET	10 - POLE ACCESSORIES	11 - OPTICAL ACCESSORIES			
13ft Pole See section for details 16ft Pole See section for details	1 Fixture Bracket See section for details 2 Fixture Bracket See section for details 3 Fixture Bracket See section for details 4 Fixture Bracket See section for details	Decorative Base Cover See section for details	Blade of Light Linear Spread Lens See section for details Anti-glare Louver See section for details Asymmetric Screen See section for details Lumishape Optical Accessories See section for details			

OPTIC DETAILS

Fixed Optic (NSP)



Interchangeable Multi Optic (SP / FL / MWFL / WFL)
Factory preset per specified optic with other beams included in packaging.



BULLETTO LINE EVENT POLE

8 - EVENT POLE (REQUIRED)

13ft round powder coated steel pole. Hot-galvanized EN ISO 1461 with integral hatch door for utility power. Maximum of 1 bracket (4 fixtures).

Level	Single
Finish	● Ferrite Dark Grey
Part No.	1USP01FE13S

16ft round powder coated steel pole. Hot-galvanized EN ISO 1461 with integral hatch door for utility power. Maximum of 1 bracket (4 fixtures).

Level	Single	Dual
Finish	● Ferrite Dark Grey	
Part No.	1USP01FE16S	1USP01FE16D

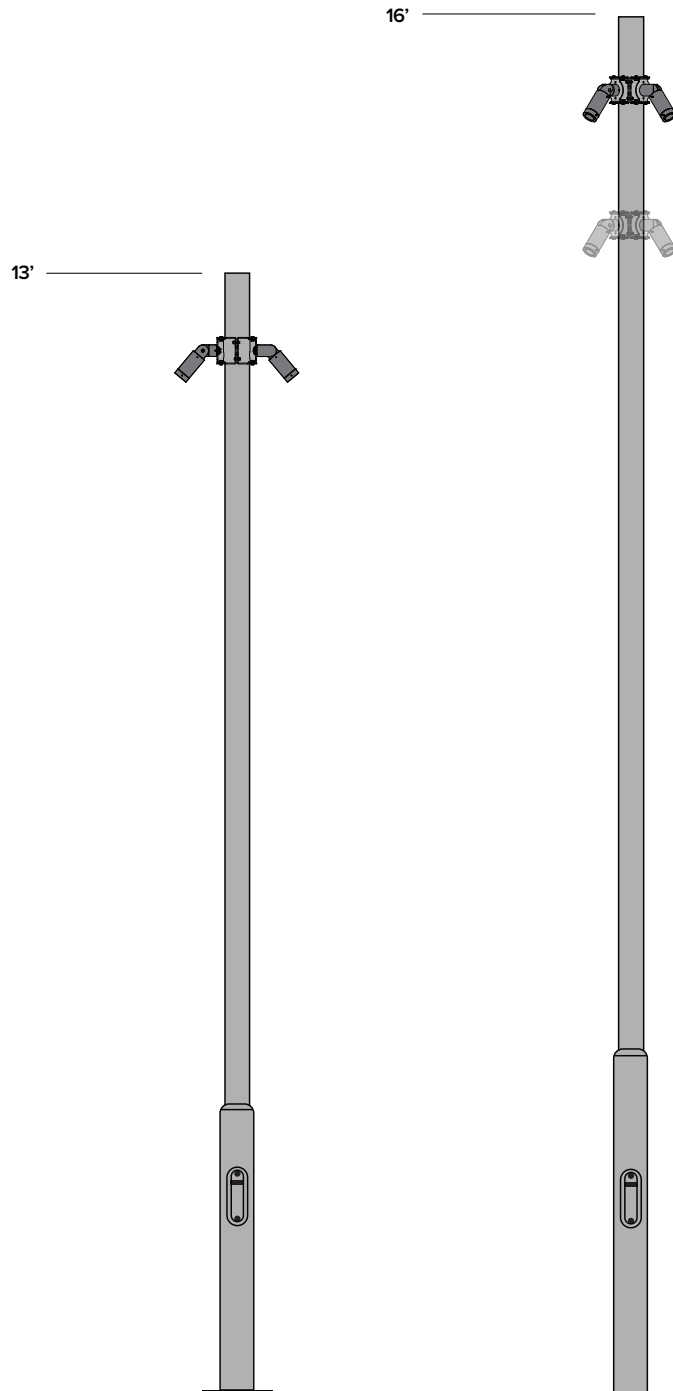

BULLETTO LINE EVENT POLE

9 - MOUNTING BRACKET (REQUIRED)

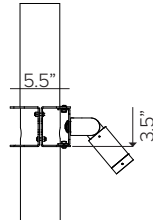
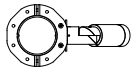

Mounting bracket, 1 fixture max.

Finish ● Ferrite Dark Grey

Part No. **1USP01BKTFES**

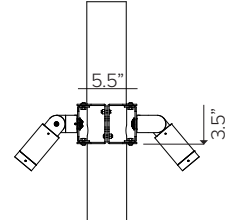
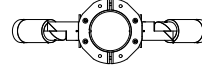

Mounting bracket, 2 fixtures max.

Finish ● Ferrite Dark Grey

Part No. **1USP01BKTFED**

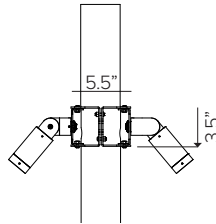
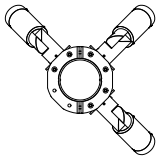

Mounting bracket, 3 fixtures max.

Finish ● Ferrite Dark Grey

Part No. **1USP01BKTFET**

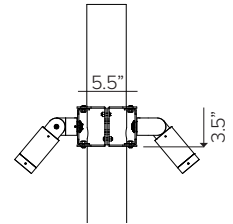
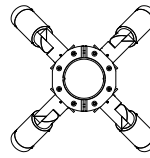

Mounting bracket, 4 fixtures max.

Finish ● Ferrite Dark Grey

Part No. **1USP01BKTFEQ**

10 – POLE ACCESSORY (OPTIONAL)

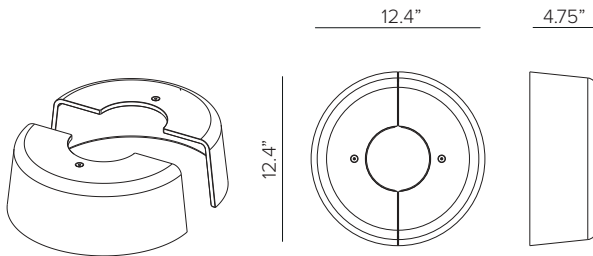

Aluminum decorative pole base cover.

Finish ● Ferrite Dark Grey

Part No. **1USP01CVR02FE**

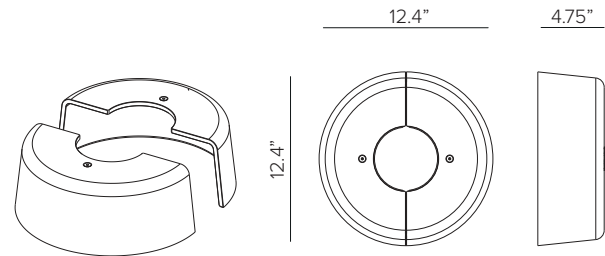

Iron decorative pole base cover. To be used in environments that may have impact.

Finish ● Ferrite Dark Grey

Part No. **1USP02CVR01FE**

BULLETTO LINE EVENT POLE

11 – OPTICAL ACCESSORIES (OPTIONAL)



Integral 'Blade of Light' linear spread lens PMMA holographic filter.

Part No. **1E3790**

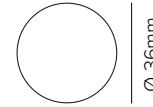

Integral honeycomb anti-glare louver.

Finish ● Deep Black

Part No. **1E3792**

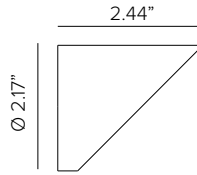
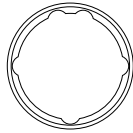
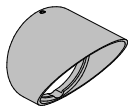

External asymmetric snoot. Powder coated stainless steel. Cutoff 20°.

Finish ● Ferrite Dark Grey

Part No. **1E3788**



Water jet cut stainless steel round pinhole LUMISHAPE light shield. **Performs best with SP optic.**

Finish ● Deep Black

Part No. **LSO3601**

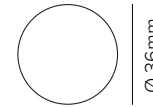

Water jet cut stainless steel round circular LUMISHAPE light shield. **Performs best with SP or FL optic.**

Finish ● Deep Black

Part No. **LSO3602**



Water jet cut stainless steel square pinhole LUMISHAPE light shield. **Performs best with SP optic.**

Finish ● Deep Black

Part No. **LSO3603**

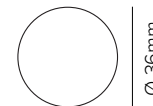

Water jet cut stainless steel regular square LUMISHAPE light shield. **Performs best with SP or FL optic.**

Finish ● Deep Black

Part No. **LSO3604**



Water jet cut stainless steel half LUMISHAPE light shield. **Stackable up to 4pcs per fixture; 4pcs accounts to 1 accessory toward maximum accessory count. Performs best with FL or MWFL optic.**

Finish ● Deep Black

Part No. **LSO3605**

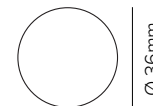

Water jet cut stainless steel quarter LUMISHAPE light shield. **Stackable up to 4pcs per fixture; 4pcs accounts to 1 accessory toward maximum accessory count. Performs best with FL or MWFL optic.**

Finish ● Deep Black

Part No. **LSO3606**

BULLETTO LINE EVENT POLE

INSTALLATION DETAILS

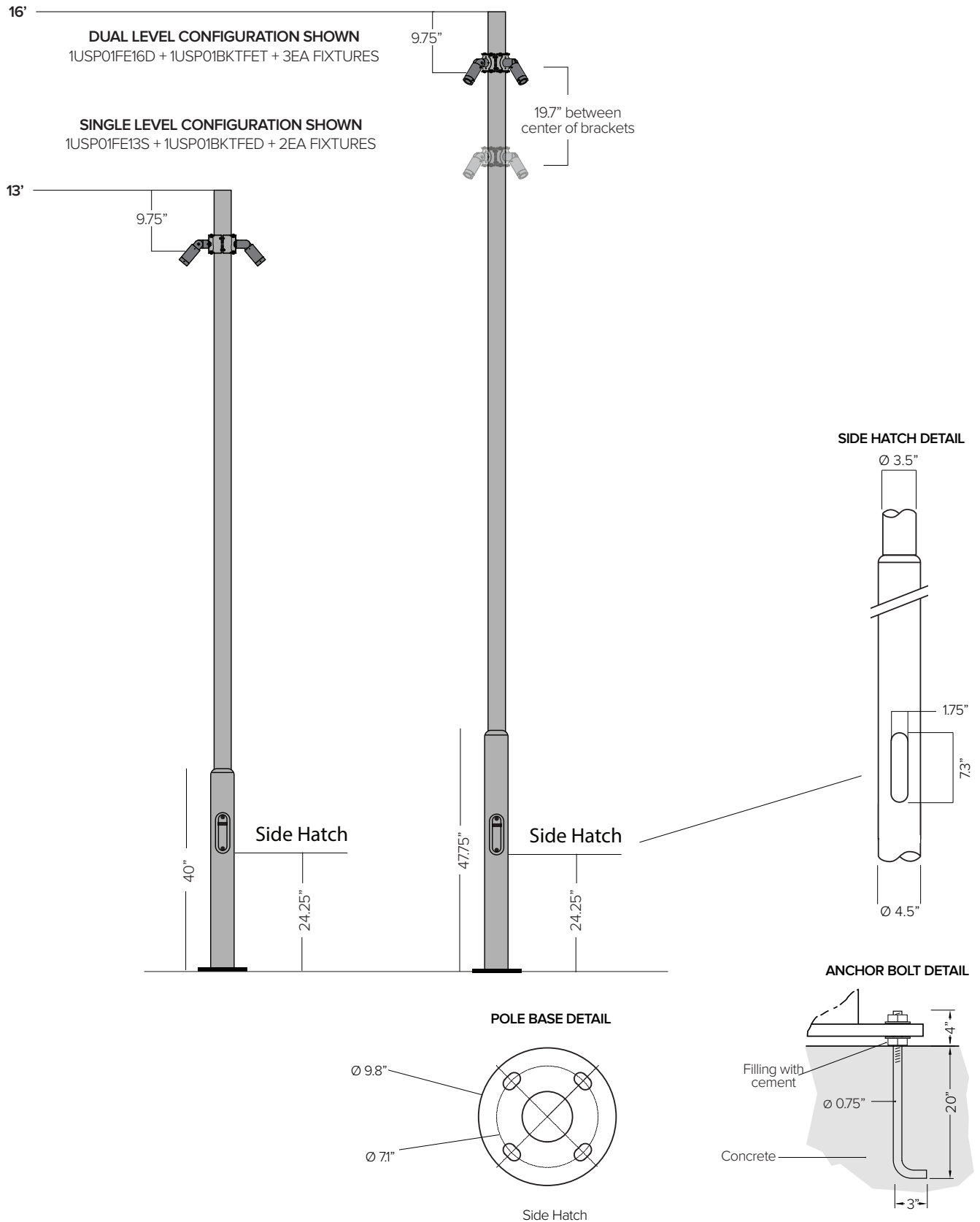

BULLETO LINE EVENT POLE

PHOTOMETRY

NARROW SPOT

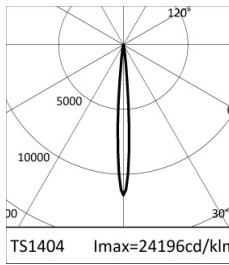

2700K		H(m)	D(m)	Emax(lx)	
-			8°		
Fixture Power	9W	1	0.15	11580	
Source Flux	479lm	2	0.30	2895	
Fixture Flux	362lm	3	0.44	1287	
Efficacy	40lm/W	4	0.59	724	
TS1404	Imax=24196cd/klm	Imax	11580cd	5	0.74 463

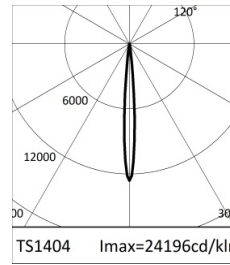

3000K		H(m)	D(m)	Emax(lx)	
-			8°		
Fixture Power	9W	1	0.15	12587	
Source Flux	520lm	2	0.30	3147	
Fixture Flux	394lm	3	0.44	1399	
Efficacy	44lm/W	4	0.59	787	
TS1404	Imax=24196cd/klm	Imax	12587cd	5	0.74 503

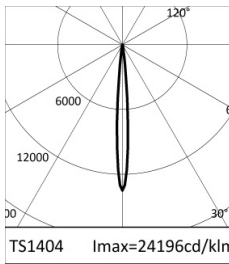

3500K		H(m)	D(m)	Emax(lx)	
-			8°		
Fixture Power	9W	1	0.15	13470	
Source Flux	557lm	2	0.30	3367	
Fixture Flux	421lm	3	0.44	1497	
Efficacy	47lm/W	4	0.59	842	
TS1404	Imax=24196cd/klm	Imax	13470cd	5	0.74 539

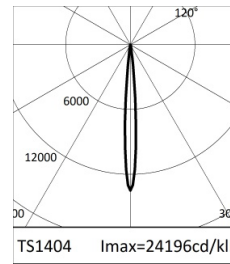

4000K		H(m)	D(m)	Emax(lx)	
-			8°		
Fixture Power	9W	1	0.15	13470	
Source Flux	557lm	2	0.30	3367	
Fixture Flux	421lm	3	0.44	1497	
Efficacy	47lm/W	4	0.59	842	
TS1404	Imax=24196cd/klm	Imax	13470cd	5	0.74 539

SPOT

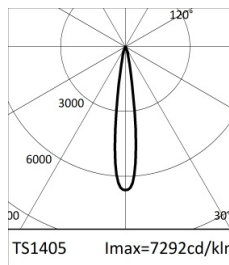

2700K		H(m)	D(m)	Emax(lx)	
-			15°		
Fixture Power	17W	1	0.27	6624	
Source Flux	908lm	2	0.54	1656	
Fixture Flux	679lm	3	0.81	736	
Efficacy	40lm/W	4	1.08	414	
TS1405	Imax=7292cd/klm	Imax	6624cd	5	1.35 265

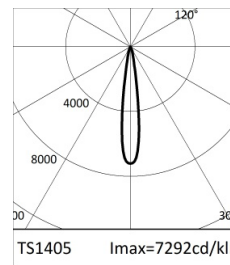

3000K		H(m)	D(m)	Emax(lx)	
-			15°		
Fixture Power	17W	1	0.27	7200	
Source Flux	987lm	2	0.54	1800	
Fixture Flux	738lm	3	0.81	800	
Efficacy	43lm/W	4	1.08	450	
TS1405	Imax=7292cd/klm	Imax	7200cd	5	1.35 288

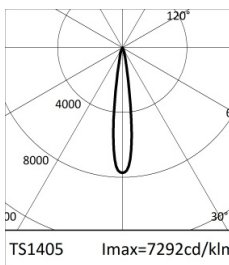

3500K		H(m)	D(m)	Emax(lx)	
-			15°		
Fixture Power	17W	1	0.27	7701	
Source Flux	1056lm	2	0.54	1925	
Fixture Flux	790lm	3	0.81	856	
Efficacy	46lm/W	4	1.08	481	
TS1405	Imax=7292cd/klm	Imax	7701cd	5	1.35 308

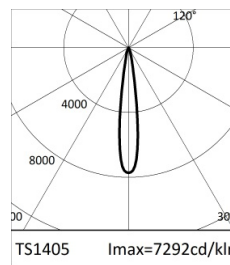

4000K		H(m)	D(m)	Emax(lx)	
-			15°		
Fixture Power	17W	1	0.27	7701	
Source Flux	1056lm	2	0.54	1925	
Fixture Flux	790lm	3	0.81	856	
Efficacy	46lm/W	4	1.08	481	
TS1405	Imax=7292cd/klm	Imax	7701cd	5	1.35 308

FLOOD

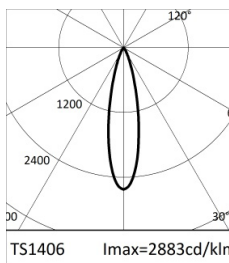

2700K		H(m)	D(m)	Emax(lx)	
-			24°		
Fixture Power	17W	1	0.43	2618	
Source Flux	908lm	2	0.85	655	
Fixture Flux	642lm	3	1.28	291	
Efficacy	38lm/W	4	1.71	164	
TS1406	Imax=2883cd/klm	Imax	2618cd	5	2.14 105

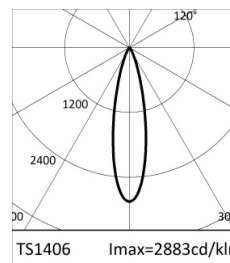

3000K		H(m)	D(m)	Emax(lx)	
-			24°		
Fixture Power	17W	1	0.43	2846	
Source Flux	987lm	2	0.85	712	
Fixture Flux	698lm	3	1.28	316	
Efficacy	41lm/W	4	1.71	178	
TS1406	Imax=2883cd/klm	Imax	2846cd	5	2.14 114

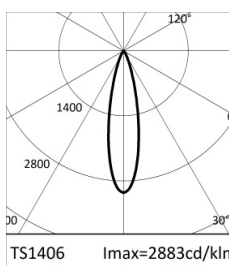

3500K		H(m)	D(m)	Emax(lx)	
-			24°		
Fixture Power	17W	1	0.43	3044	
Source Flux	1056lm	2	0.85	761	
Fixture Flux	747lm	3	1.28	338	
Efficacy	44lm/W	4	1.71	190	
TS1406	Imax=2883cd/klm	Imax	3044cd	5	2.14 122

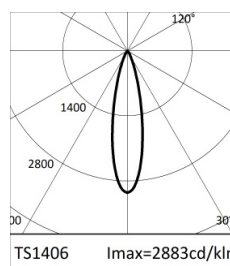

4000K		H(m)	D(m)	Emax(lx)	
-			24°		
Fixture Power	17W	1	0.43	3044	
Source Flux	1056lm	2	0.85	761	
Fixture Flux	747lm	3	1.28	338	
Efficacy	44lm/W	4	1.71	190	
TS1406	Imax=2883cd/klm	Imax	3044cd	5	2.14 122

BULLETO LINE EVENT POLE

PHOTOMETRY

MEDIUM WIDE FLOOD

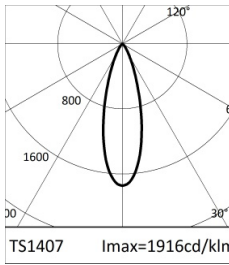
	2700K	H(m)	D(m)	Emax(lx)		
	-			31°		
	Fixture Power	17W	1	0.55	1741	
	Source Flux	908lm	2	1.09	435	
	Fixture Flux	648lm	3	1.64	193	
	Efficacy	38lm/W	4	2.18	109	
TS1407	Imax=1916cd/klm	Imax	1741cd	5	2.73	70

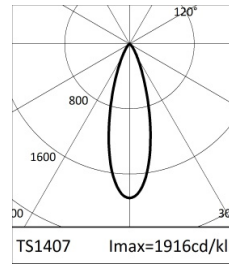
	3000K	H(m)	D(m)	Emax(lx)		
	-			31°		
	Fixture Power	17W	1	0.55	1892	
	Source Flux	987lm	2	1.09	473	
	Fixture Flux	704lm	3	1.64	210	
	Efficacy	41lm/W	4	2.18	118	
TS1407	Imax=1916cd/klm	Imax	1892cd	5	2.73	76

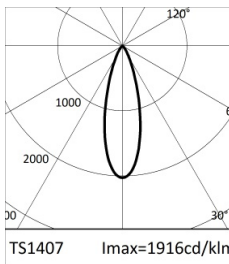
	3500K	H(m)	D(m)	Emax(lx)		
	-			31°		
	Fixture Power	17W	1	0.55	2024	
	Source Flux	1056lm	2	1.09	506	
	Fixture Flux	753lm	3	1.64	225	
	Efficacy	44lm/W	4	2.18	126	
TS1407	Imax=1916cd/klm	Imax	2024cd	5	2.73	81

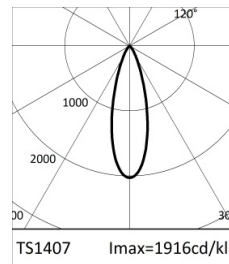
	4000K	H(m)	D(m)	Emax(lx)		
	-			31°		
	Fixture Power	17W	1	0.55	2024	
	Source Flux	1056lm	2	1.09	506	
	Fixture Flux	753lm	3	1.64	225	
	Efficacy	44lm/W	4	2.18	126	
TS1407	Imax=1916cd/klm	Imax	2024cd	5	2.73	81

WIDE FLOOD

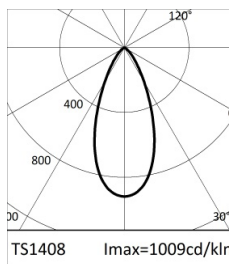
	2700K	H(m)	D(m)	Emax(lx)		
	-			44°		
	Fixture Power	17W	1	0.82	916	
	Source Flux	908lm	2	1.63	229	
	Fixture Flux	634lm	3	2.45	102	
	Efficacy	37lm/W	4	3.27	57	
TS1408	Imax=1009cd/klm	Imax	916cd	5	4.08	37

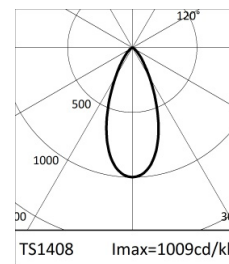
	3000K	H(m)	D(m)	Emax(lx)		
	-			44°		
	Fixture Power	17W	1	0.82	996	
	Source Flux	987lm	2	1.63	249	
	Fixture Flux	689lm	3	2.45	111	
	Efficacy	41lm/W	4	3.27	62	
TS1408	Imax=1009cd/klm	Imax	996cd	5	4.08	40

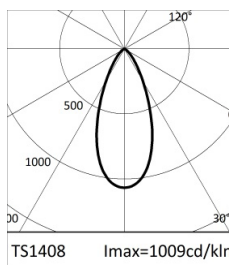
	3500K	H(m)	D(m)	Emax(lx)		
	-			44°		
	Fixture Power	17W	1	0.82	1065	
	Source Flux	1056lm	2	1.63	266	
	Fixture Flux	737lm	3	2.45	118	
	Efficacy	43lm/W	4	3.27	67	
TS1408	Imax=1009cd/klm	Imax	1065cd	5	4.08	43

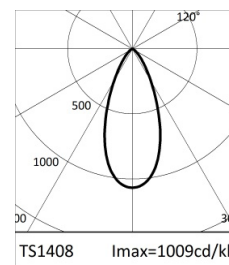
	4000K	H(m)	D(m)	Emax(lx)		
	-			44°		
	Fixture Power	17W	1	0.82	1065	
	Source Flux	1056lm	2	1.63	266	
	Fixture Flux	737lm	3	2.45	118	
	Efficacy	43lm/W	4	3.27	67	
TS1408	Imax=1009cd/klm	Imax	1065cd	5	4.08	43