

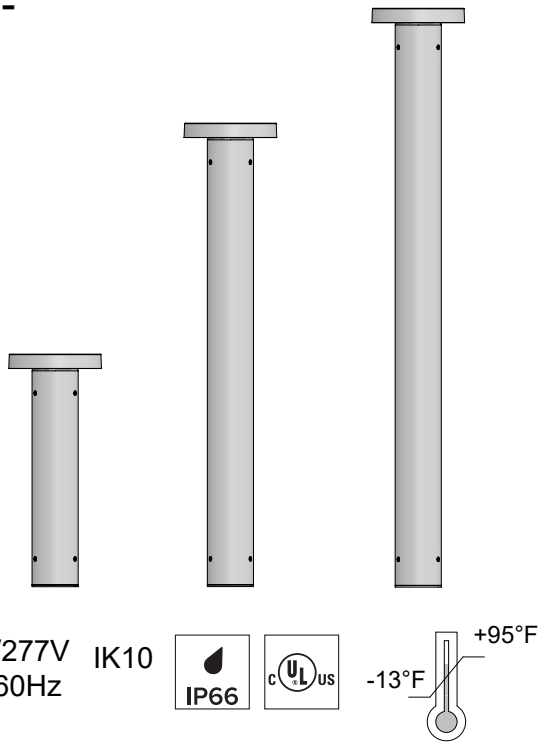

CHIOBO

CBB41-

RADIAL EMISSION LED BOLLARD



If in doubt about the symbols
please refer to catalog or website

WARNING

**To ensure a maximum efficient use
of the product, read the instructions
before proceeding installment.**



This fixture must be installed by a licensed and qualified electrician. The installer must comply with NEC and local building codes when installing the fixture



Electrical current can cause painful shock, serious injury, or even death. Make sure you turn off the power supply, ground fixture(s), and make sure all electrical connections are correct and secured tightly



For use in IP66 installations.



Keep the label of the original packaging if any eventual future claims are needed

*FIXTURE HEAD ROTATES 360°

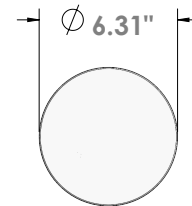
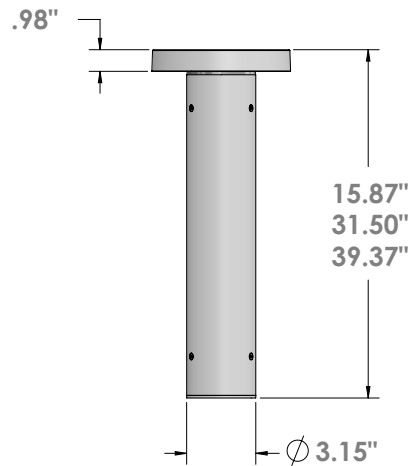

Table of Contents

Packaging Contents / Dimensions
Mounting Base Options
Mounting Base Options Assembly
Bollard / LED Fixture Head Assembly
Maintenance / Support

Pg.2
Pg.3
Pg.4-9
Pg.10
Pg.11

Packaging Contents / Dimensions

CHIOBO
CBB41(16)-



BOX 18" x 11" x 8" @ 3.50lbs

CHIOBO
CBB41(32)-



BOX 36" x 11" x 8" @ 3.50lbs

CHIOBO
CBB41(40)-



BOX 44" x 11" x 18" @ 3.50lbs

*LED fixture head is shipped installed on Bollard



TOOL03
Tool Torx TX20 Anti
Theft 1 ea.



1E2495
Tool Torx TX30 Anti
Theft 1 ea.

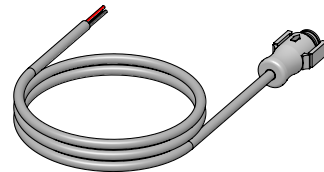

Standard 4ft Lead Cable 1 ea.
Cabled with Belden 16-6 600V
cable and female IP68 anti-wicking
quick disconnect 4ft lead cable.

Mounting Base (Sold Separately)

1US4033

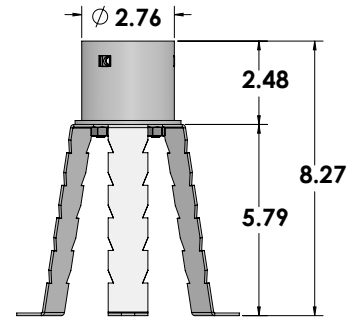
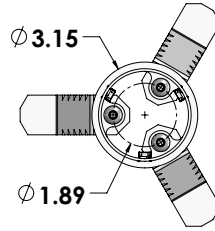
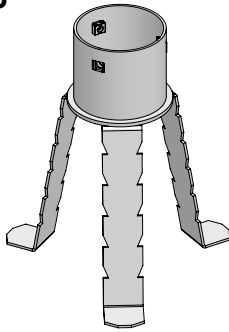

Trimless mounting base with ground anchor fixing rods for installation in concrete. AISI 316 stainless steel. Mounting bolts included. **Junction box provided by others.**

1US40352

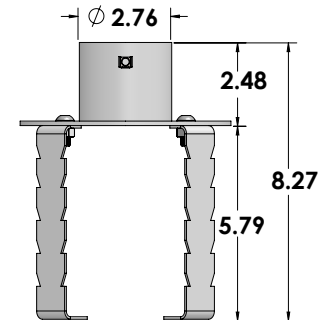
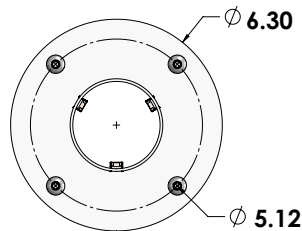
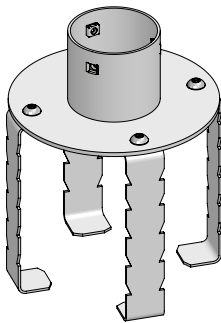

Powder coated mounting base with ground anchor fixing rods for installation in concrete. AISI 316 stainless steel. Mounting bolts included. **Required for use with 1US2530 by NEC.**

1US40351

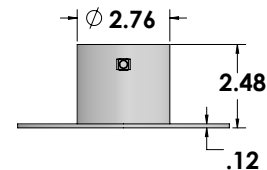
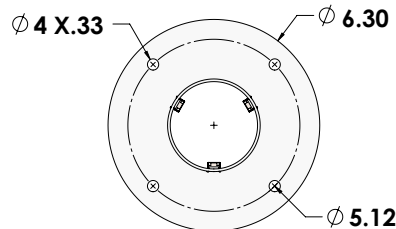
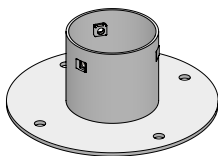

Powder coated mounting plate for surface installation outside the post. AISI 316 stainless steel compatible with dowels to be inserted into 4 holes, Ø 0.34" Dia. for use with 5/16" bolts maximum. Anchor bolts not included. **Required for use with 1US2530 by NEC.**

In Grade J - Box Required for 1US40351 and 1US40352

1US2530

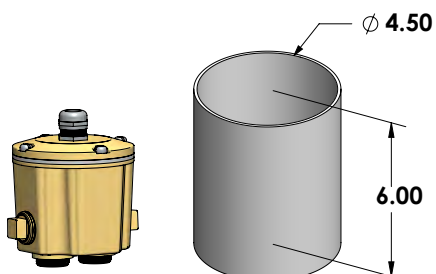

Direct burial brass ingrade j-box with PVC sleeve. Features stainless steel cover screws and strain relief for power cord, (2) 3/4" NPT bottom holes and (2) 3/4" NPT side holes. Includes (4) 3/4" to 1/2" adapters and (2) 1/2" NPT plugs. **(REQUIRED by NEC).**

1US4033 Mounting Base Installation

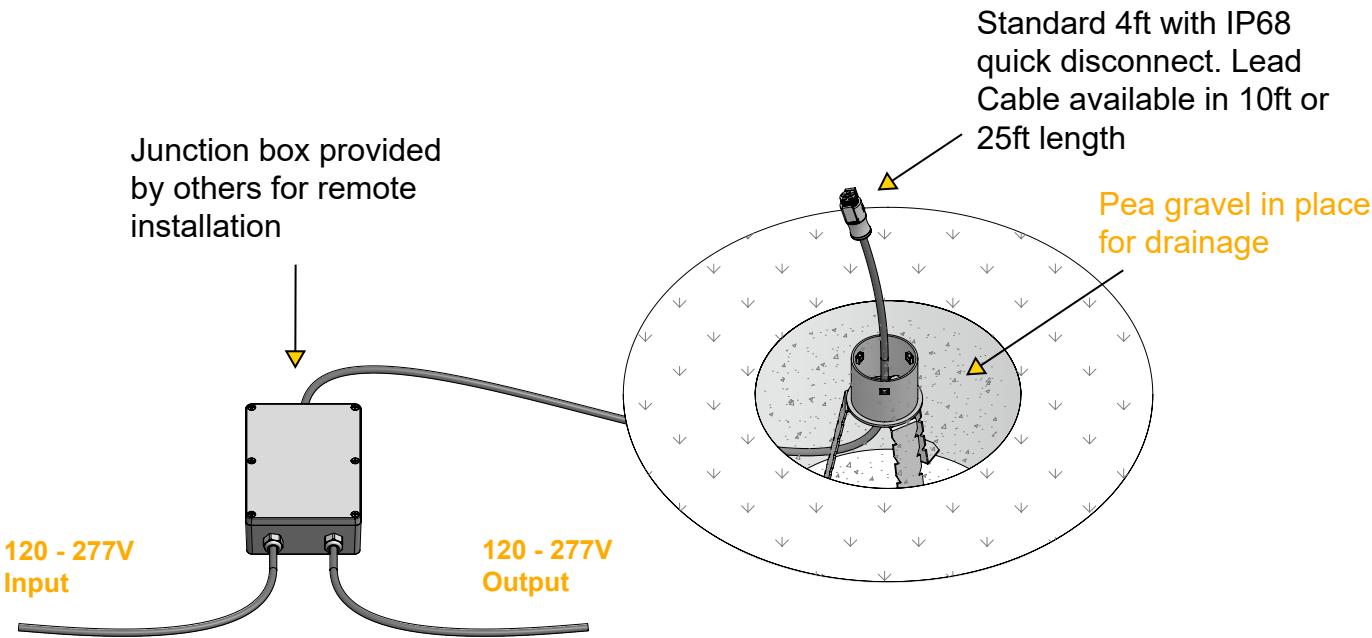
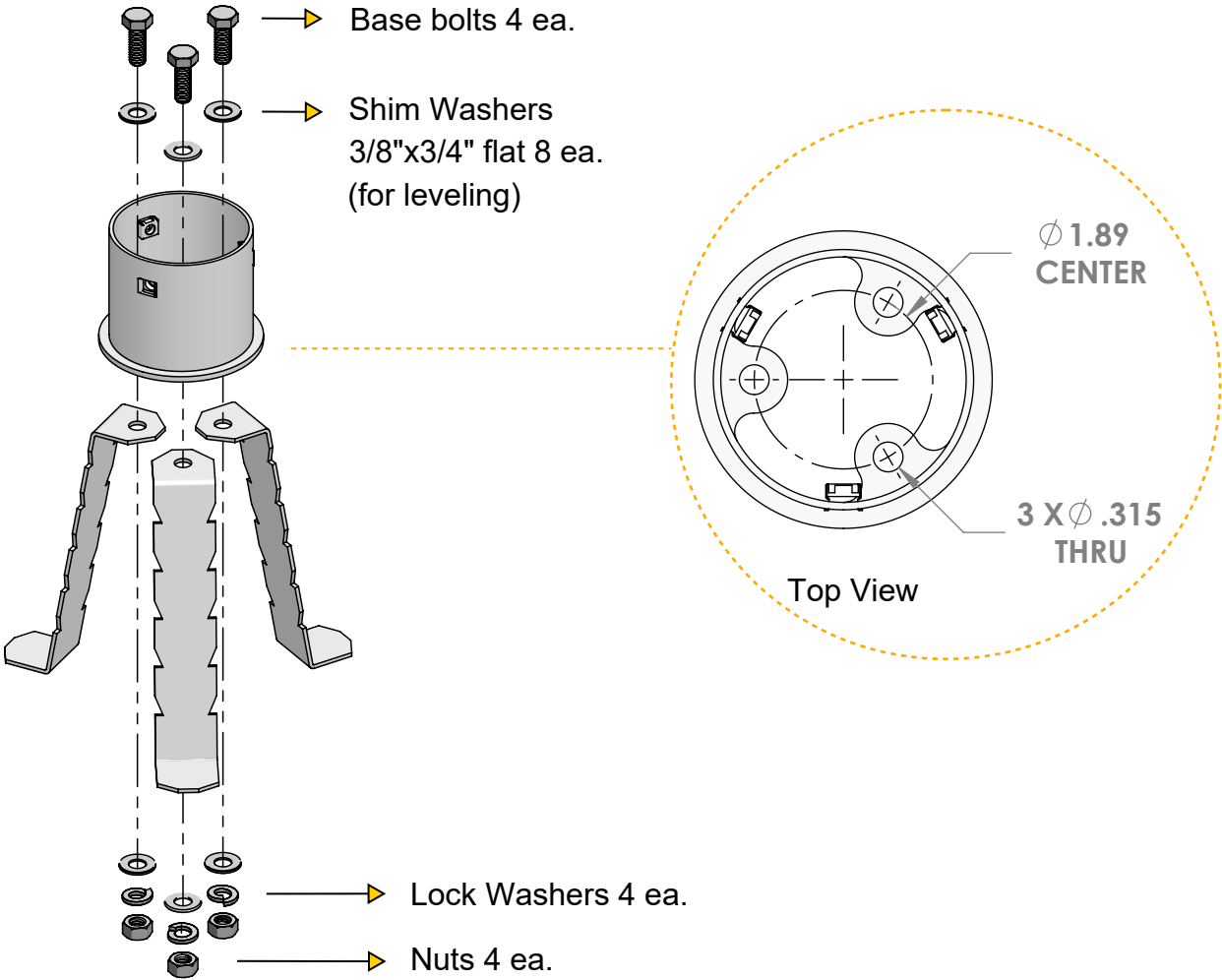

Stainless Steel base with rods on aggregated / compacted base for concrete pouring

1US4033 Mounting Base Installation

Drainage / J-Box Installation

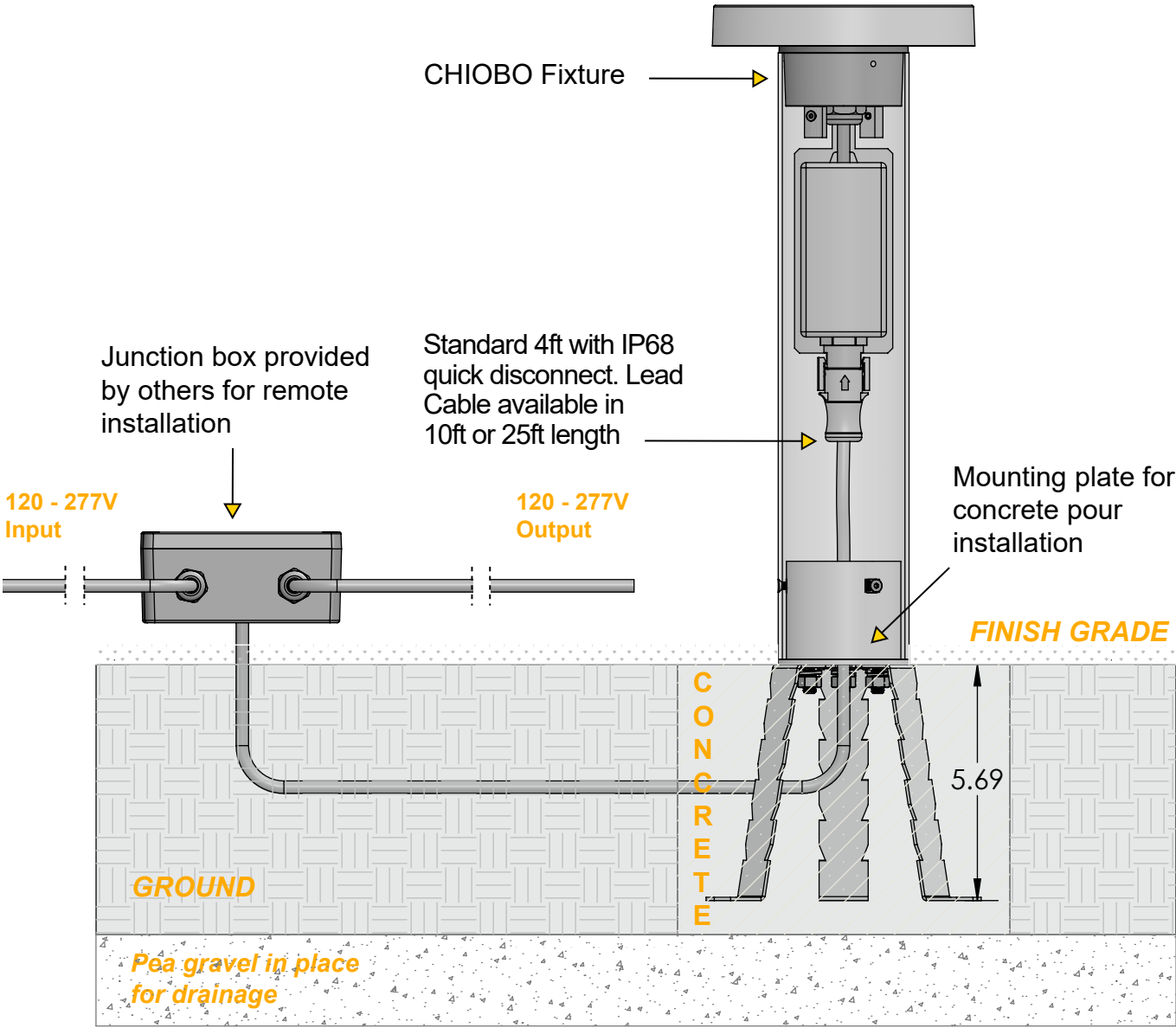

1US40352 Mounting Base Installation

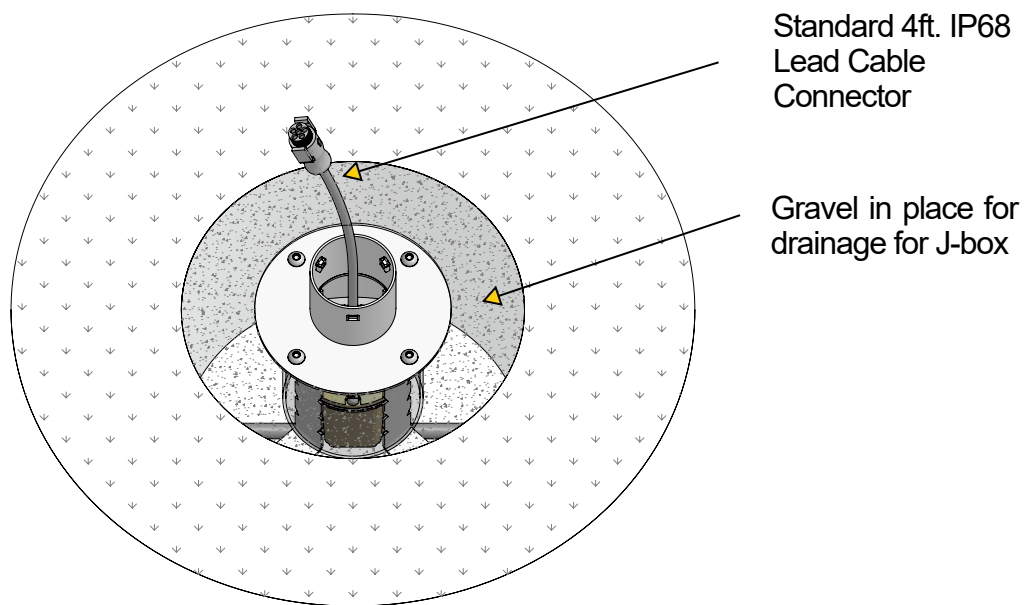
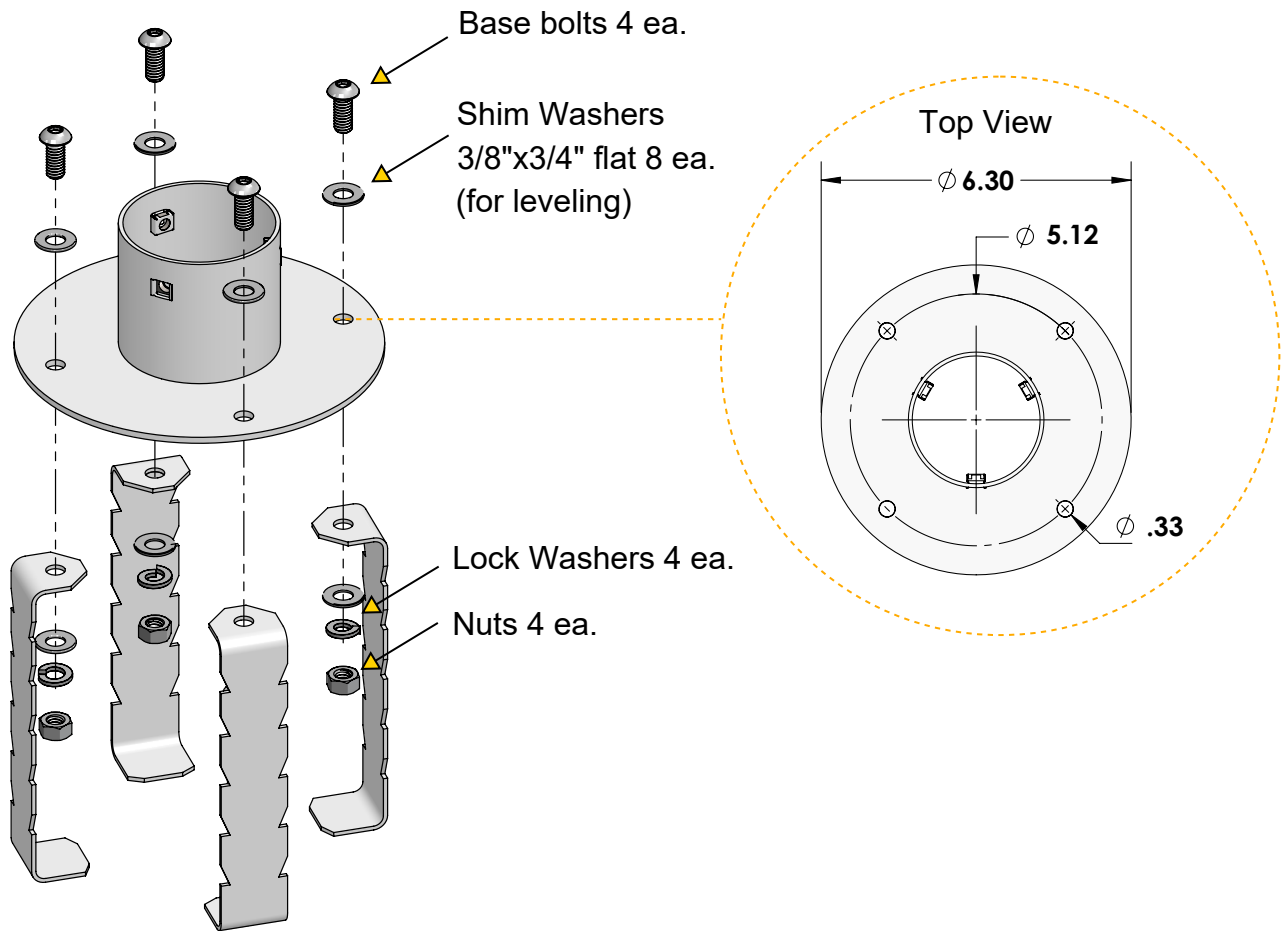

Stainless Steel base with rods on aggregated / compacted base for concrete pouring

Drainage / J-Box Installation

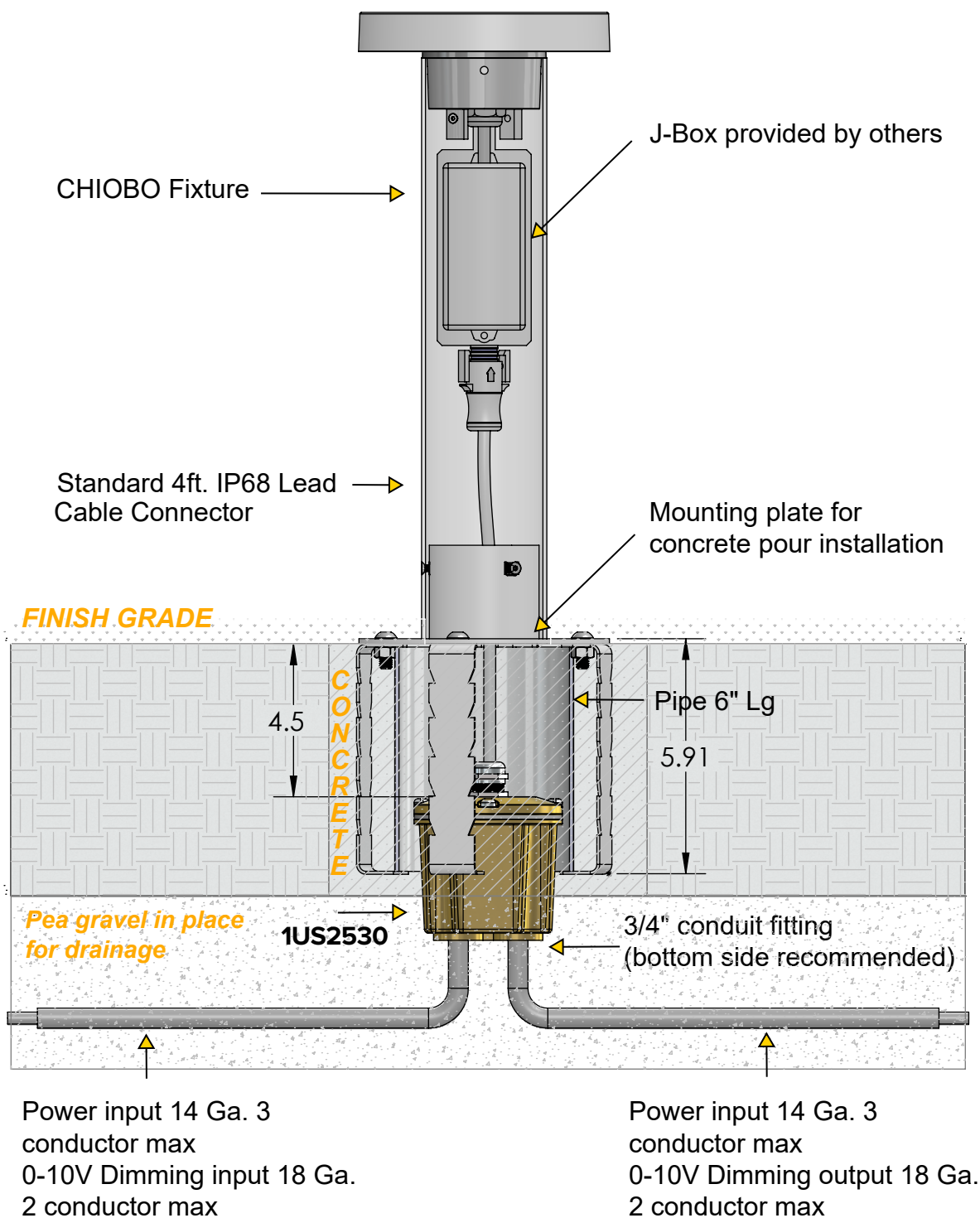

NOTE: Install according to local and NEC building codes. UL listed j-box supplied by others.

1US40351 Mounting Base Installation

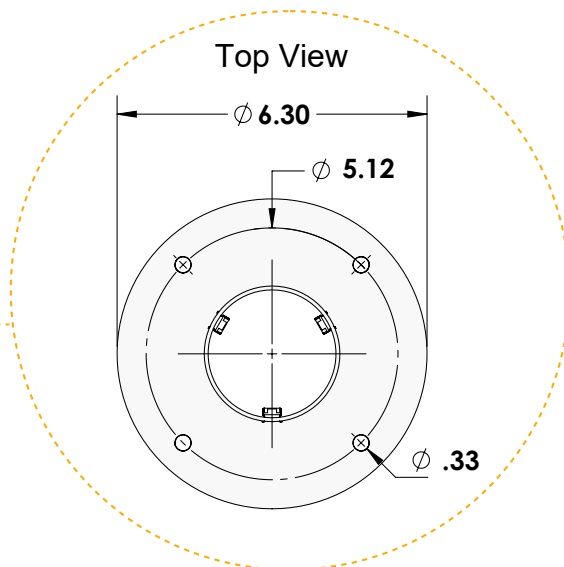
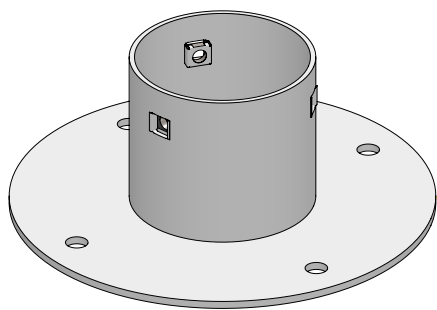

1

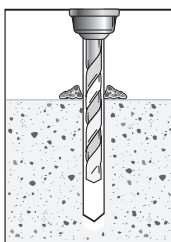

Use proper size drill bit and drill holes (minimum of 4 holes required)

2

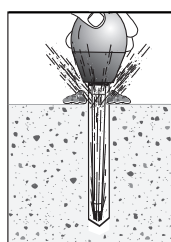

Clean holes using air nozzle (remove all debris)

3

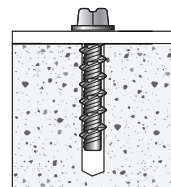

Place mounting base in position then drive anchor bolts using impact hammer and drill until fully seated. Use leveling washers if needed to slightly tilt Bollard

Once power cord has been connected install base onto position by drilling holes on the concrete and using anchor bolts

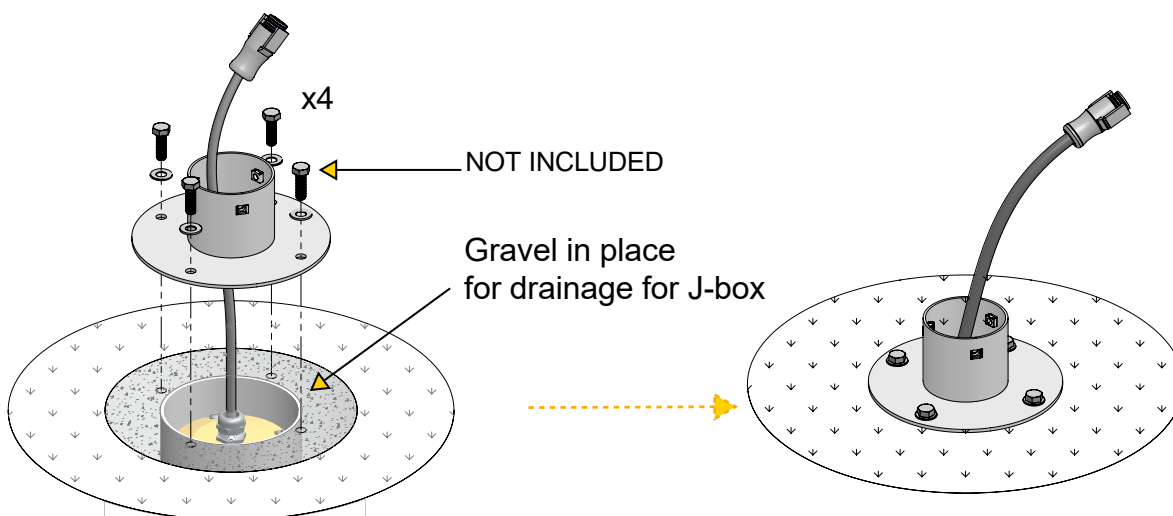

1US40351 Mounting Base Installation

Drainage / J-Box Installation

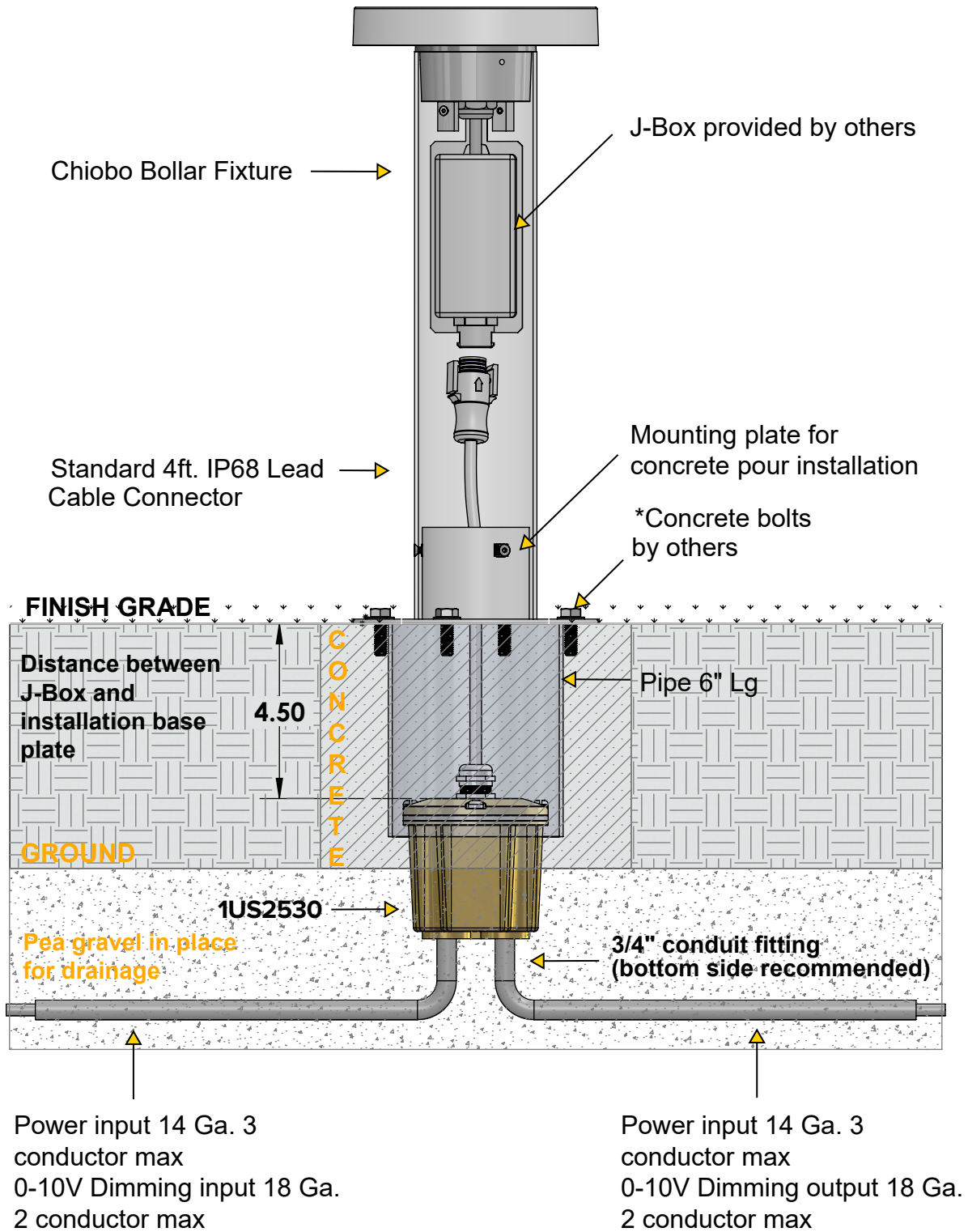

NOTE: Install according to local and NEC building codes. UL listed j-box supplied by others.

Bollard / LED Fixture Head Assembly

Step 1.

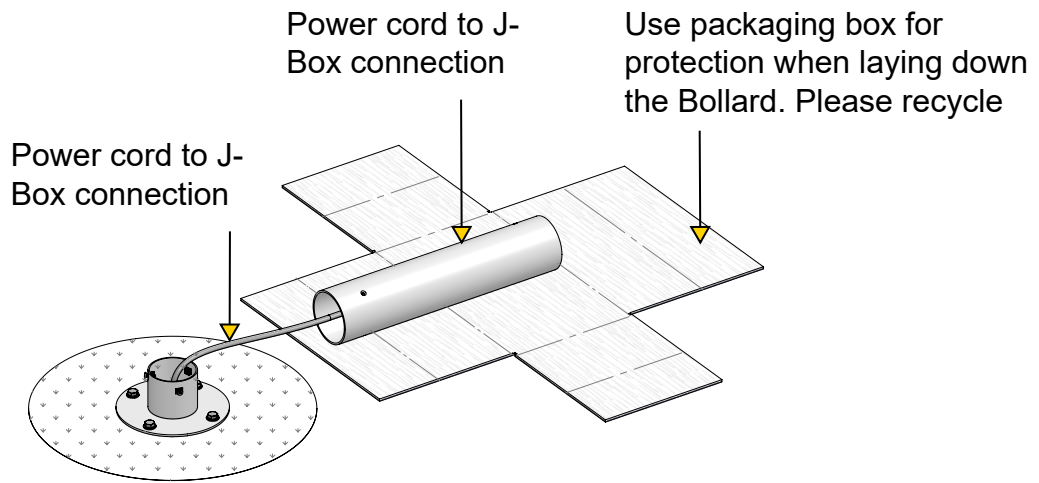

Step 2.

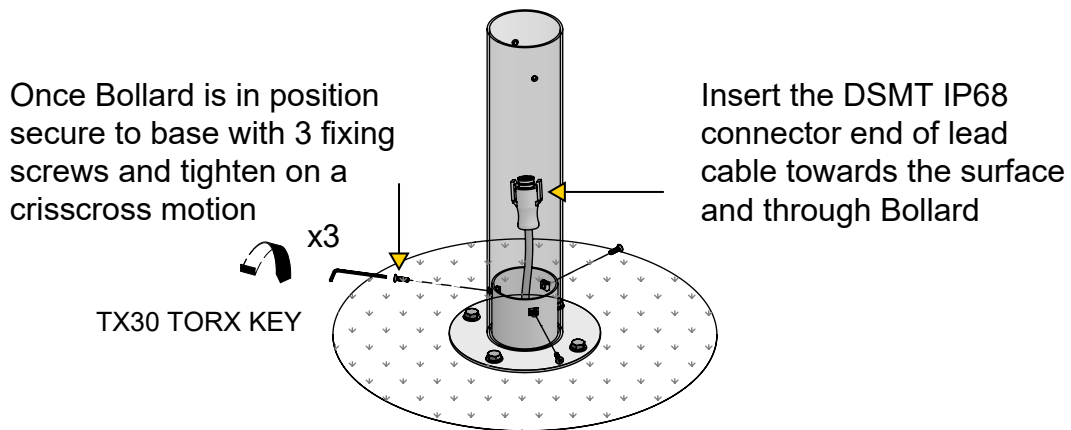

Step 3. Connect female IP68 4ft lead cable connector into fixture's head, make sure both locking wings are on lock position before installing fixture head onto Bollard.
Once a secure connection has been made, insert fixture head into Bollard and rotate to desired illumination direction.

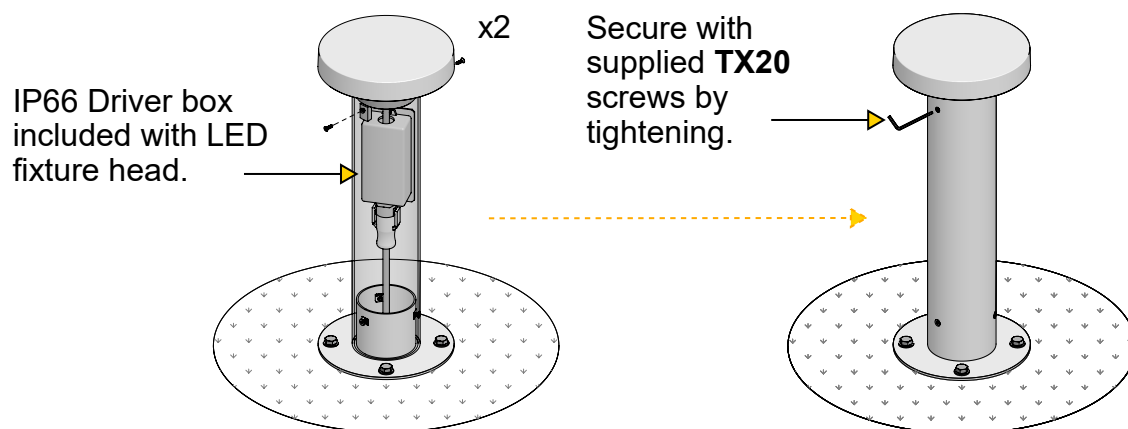

Maintenance

This fixture was designed and manufactured for a durable, long lasting use with minimum care. To ensure the maximum lifespan of this product, we encourage our customers to provide a quality visual inspection of the fixture and accessories every six months.

If there are any visible signs of issues (i.e moisture or dust) during the inspection, please clean any of the dust or moisture with a soft cloth to make sure that all fixtures are still operating normally. If there are any issues regarding the fixture please contact us as we will assist the situation at hand.

Support

Any questions, problems, or comments you have please feel free to contact our Customer Service department during our business hours Monday-Friday 8am-5pm via: Email: usaorders@targetti.com
Phone: (714) 513-1991

Visit our website: <http://www.targettiusa.com>