

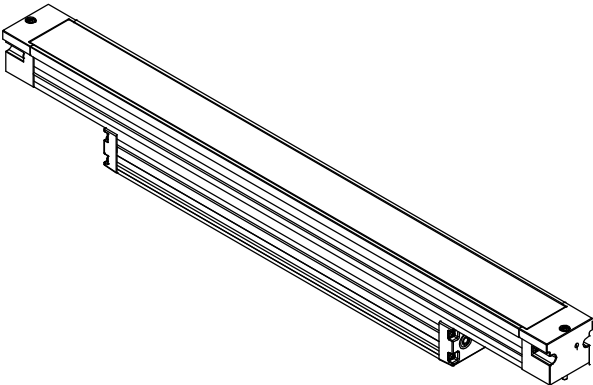

JEDI COMPACT RECESSED INTEGRAL

JCOR10-(WW), (WG), (FL), (SP), (DV)

JEDI COMPACT RECESSED 0-10V (WALL WASH),
(WALL GRAZER), (FLOOD), (SPOT), (DIRECT VIEW)



If in doubt about the symbols, please refer to catalog or website

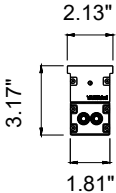
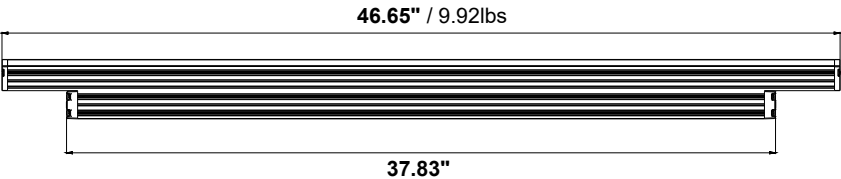
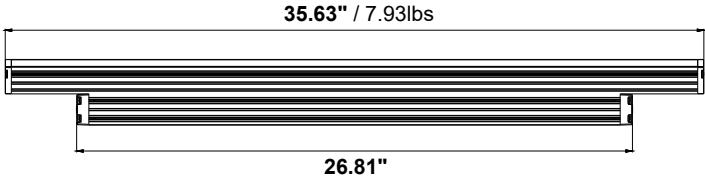
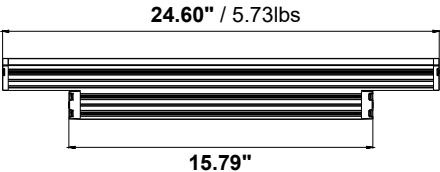
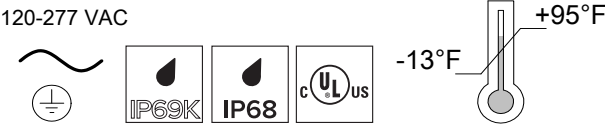

K 5 F B-B;

Hc` Ybgi fY` U` a U` ja i a` YZ`WYbh` i gY`cZ`
H` Y`dfcXi` WZ`fYUX`H` Y`]bghfi` W]cbg`VYZ`fY`
dfcWYX]b[`]bghU`a` Ybh`



This fixture must be installed by a licensed and qualified electrician. The installer must comply with NEC and local building codes when installing the fixture.



Electrical current can cause painful shock, serious injury, or even death. Make sure you turn off the power supply, ground fixture(s), and make sure all electrical connections are correct and secured.



For use in IP68, and IP69K installations.

* Temporary immersion up to 24 hours at a max depth of 2 meters. Installation of fixture requires proper drainage to prevent any standing water. Should not be used for permanent submersion.



Keep the label of the original packaging if any eventual future claims are needed.

HUV`Y`cZ7` cbhYbHg

- Packaging Contents
- JEDI Compact Recessed Cabling Types
- Fixture(s) Layout Instructions
- Electrical Roughin
- Aluminum Sleeve Installation
- Power Connection Instructions
- Mounting Instructions
- Maintenance / Support

- Pg.2/3/4
- Pg.5
- Pg.6
- Pg.7
- Pg.8
- Pg.9
- Pg.10
- Pg.11

Packaging Contents

24" Fixture in 26"x6"x5" Box @6.0 lbs
36" Fixture in 38"x6"x5" Box @8.2lbs
48" Fixture in 50"x6"x5" Box @10.2 lbs

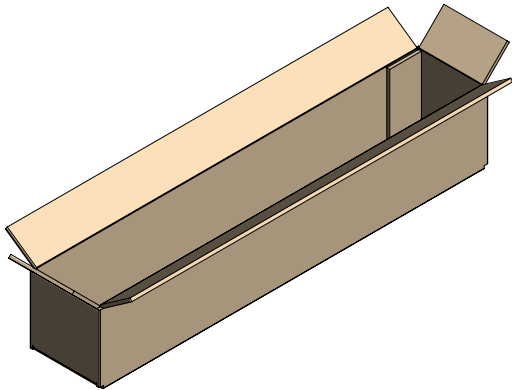

CONNECTOR KIT
2 ea. Lead / Center Fixture
1 ea. Solo / End fixture



P68 FIELD CONNECTOR



HEAT-SHRINK WATERPROOF
CONECTOR



4" HEAT-SHRINK TUBE

LEAD / CENTER FIXTURE 1 ea.

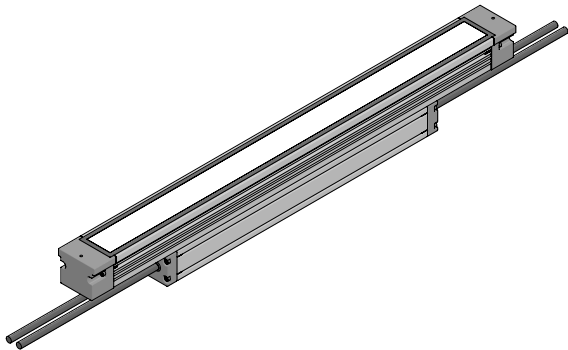

SOLO / END FIXTURE 1 ea.

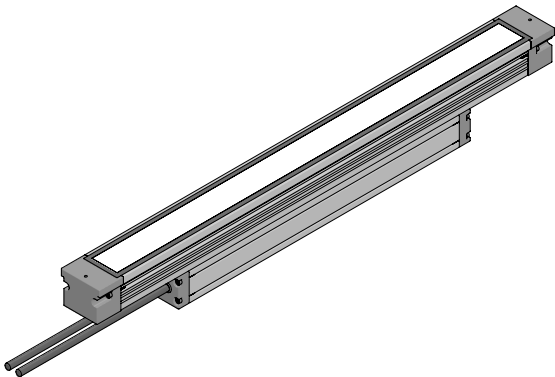

REQUIRED SLEEVE SOLD SEPARATELY

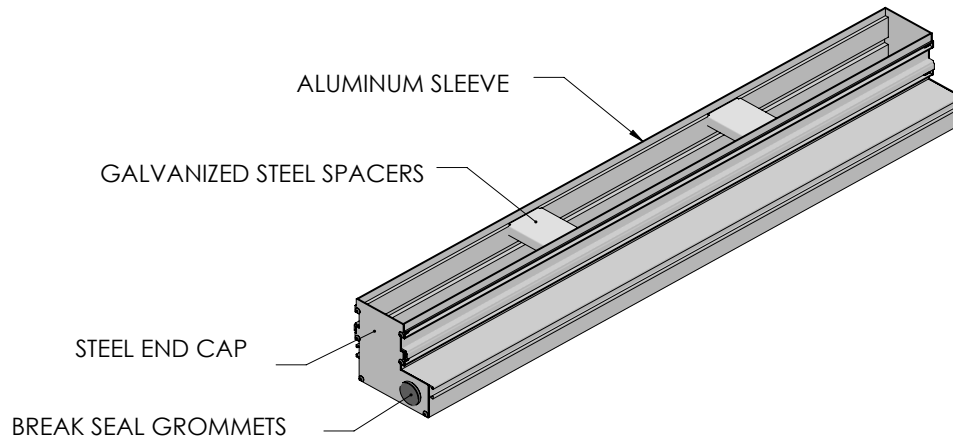

JEDI COMPACT extruded aluminum low profile installation sleeve for feed through wiring.

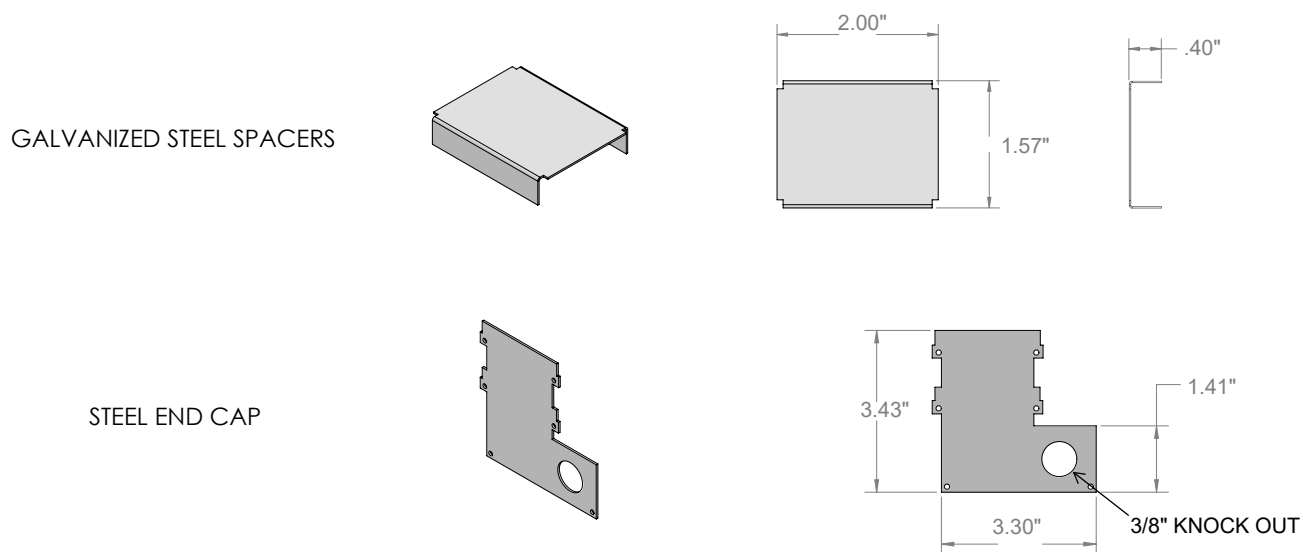

1E3733 Fixture in 28"x6"x5" Box @2.76 lbs
1E3734 Fixture in 40"x7"x6" Box @4.00lbs
1E3735 Fixture in 50"x7"x6" Box @5.22 lbs

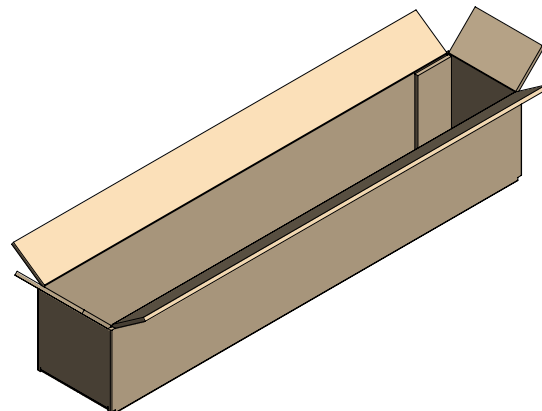

REQUIRED SLEEVE SOLD SEPARATELY

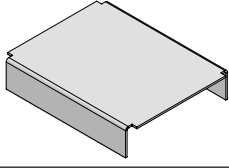
24.72"	35.71"	46.73"
2 ea.	3 ea.	4 ea.
		

Galvanized Steel Spacers

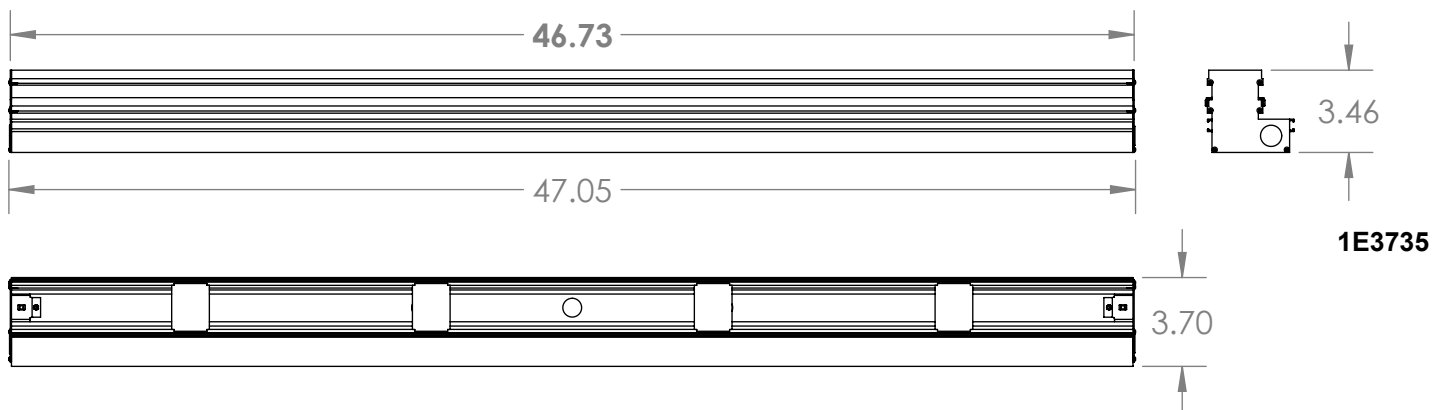
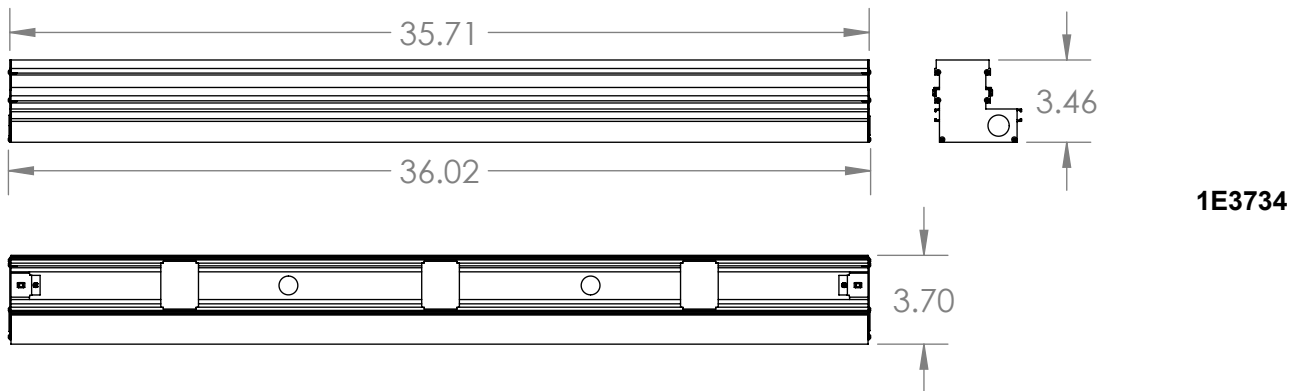
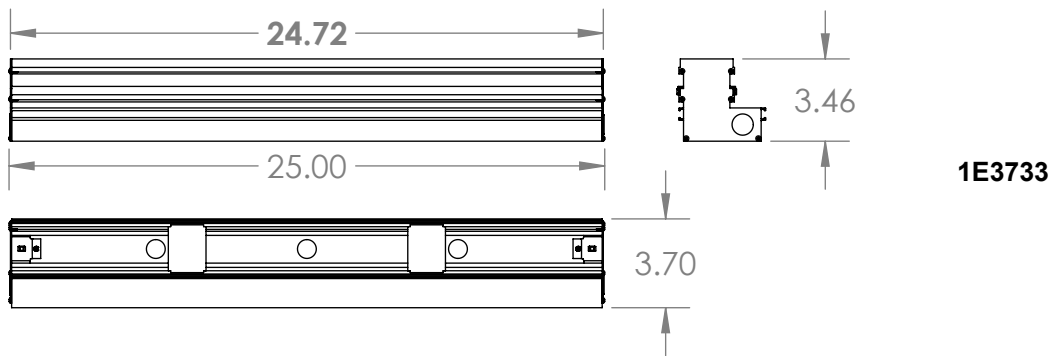

JEDI Compact Recessed Cabling Types

Incoming SJOOW power cord and incoming dimming cable to be supplied by contractor for attaching to fixture's power and dimming connectors (Typ All Fixtures)

Jumper SJOOW power cord and dimming jumper to be supplied by contractor for attaching to fixture's power and dimming connectors (Typ Lead/Center Fixtures)

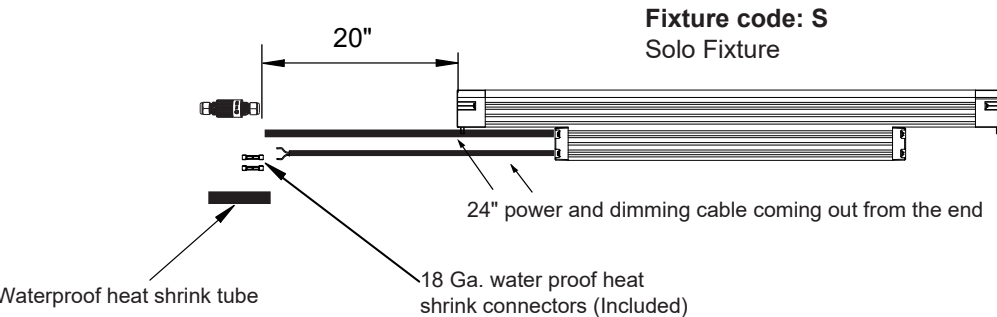
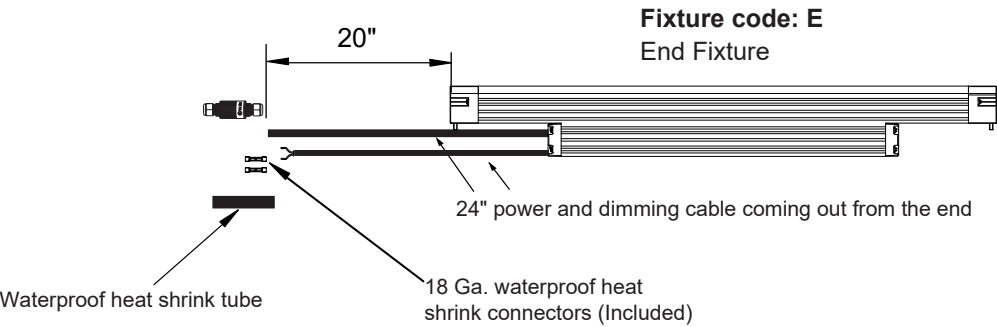
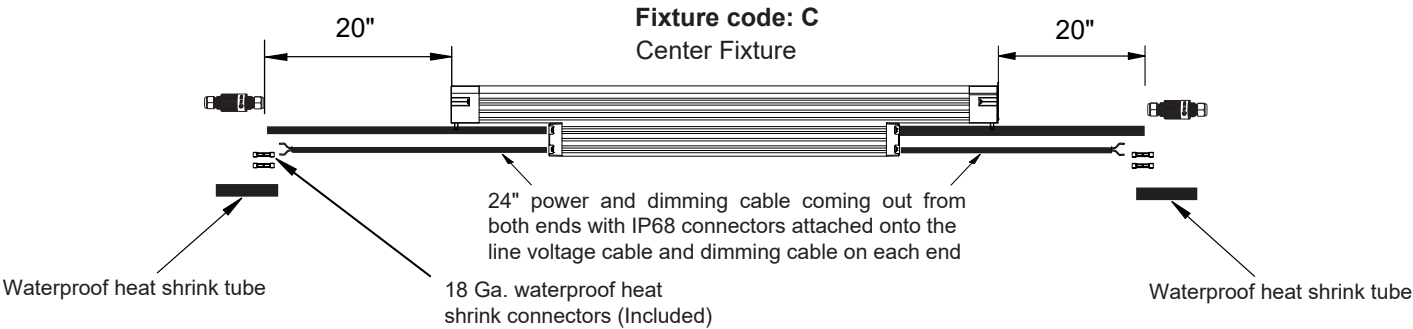
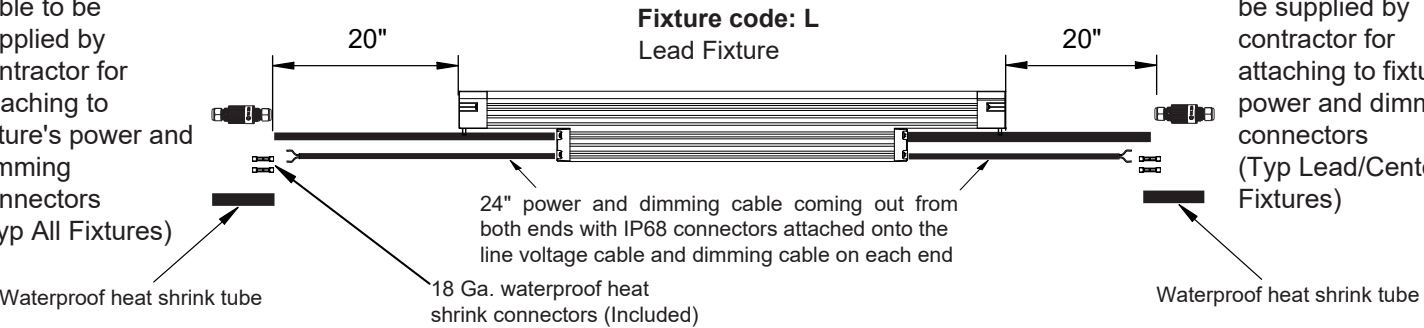

Fixture(s) Layout Instructions

- When installing multiple fixtures in one circuit, installer will need to layout lead cable and jumper cables for the full circuit connection. Installer must use the same rules applied with providing the line voltage lead cable, 0-10V dimming cable, and supply the jumper cables for both the line voltage and dimming. Targetti supplies waterproof connectors for both Line and Low voltage connections.
- Using the wiring diagram below as reference, installer must layout the fixtures in the correct order. The first fixture in the circuit is the lead fixture, followed by the center fixture(s), and ending the circuit with the end fixture.
- **Maximum power consumption of multiple fixtures on one line is 10A.**

Wiring Diagram for Single or Multiple Fixtures in One Circuit

SOLO FIXTURE INSTALLATION

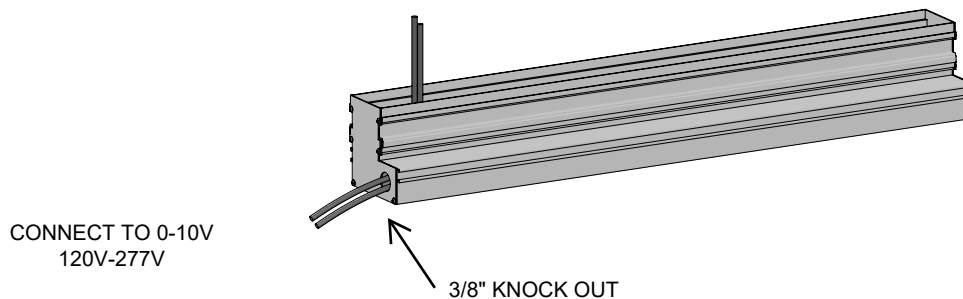

INTER CONNECTED FIXTURE RUN INSTALLATION

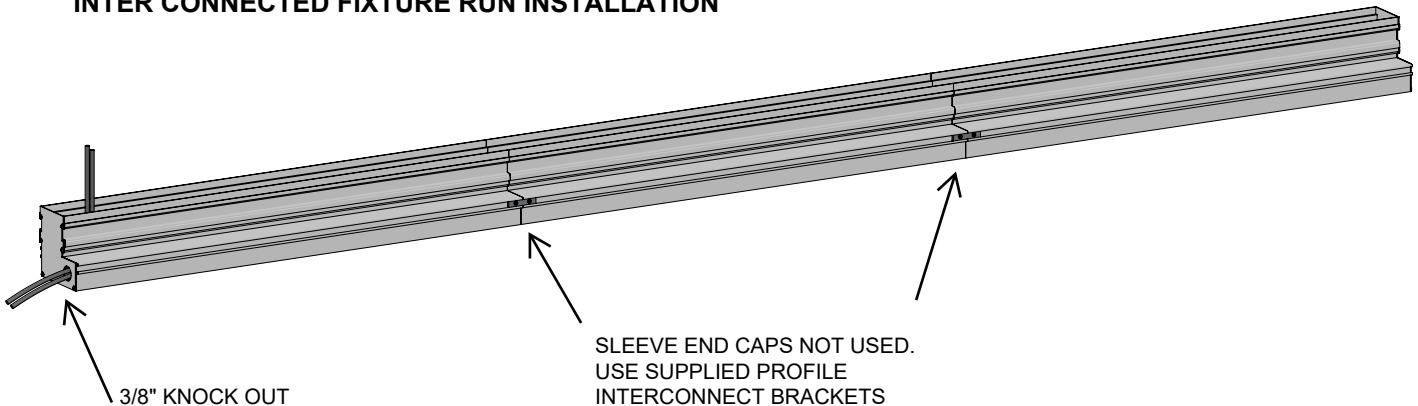

SEPERATED CONNECTED FIXTURE RUN INSTALLATION

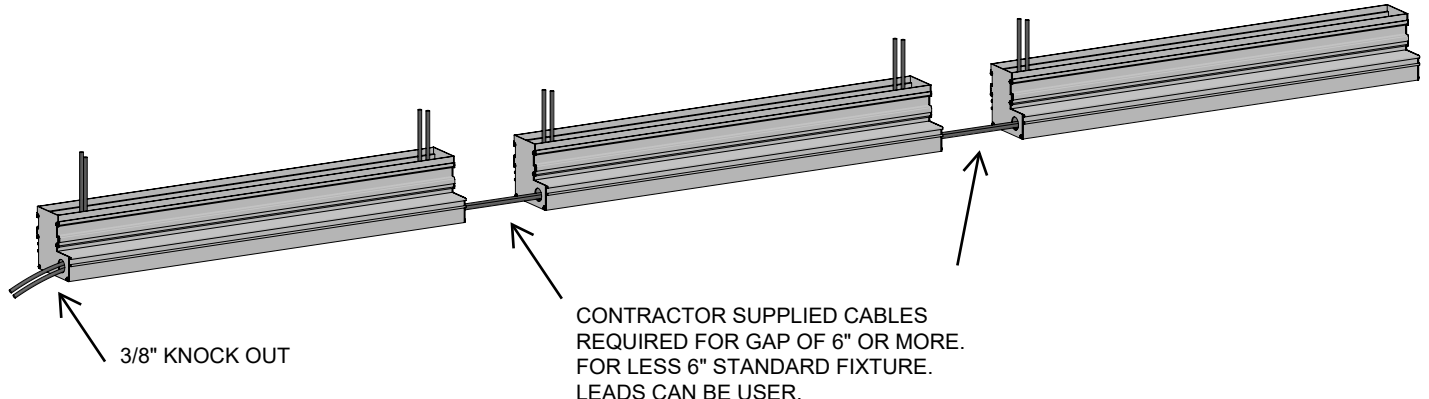

Electrical Roughin

- For each individual run we recommend that the electrical J-Box is positioned within 10ft. away from lead fixture. Each Lead and Solo fixtures are supplied with a 24" lead for 120-277V Input and a 24" lead for 0-10V Dimming.
- If the source is 120V, max of 14 each 4-foot fixtures (50 feet of fixture illumination) on a single home run allowed.
- If the source is 277V, max of 35 each 4-foot fixtures (140 feet of fixture illumination) on a single home run allowed.
- Please see chart below for detailed information on max run lengths per circuit.

Voltage Drop Table

Voltage drop calculations are based on 10% max drop to last fixture in run for load and distances below

Length in Fixtures	Load	Power
Up to 88ft.	1166W	120V
Up to 208ft.	2756W	277V

Max lengths include lengths of lead and jumper cables.

Example: 3 each 2ft. fixtures and 3 each 3ft. fixtures = 15ft. of fixture illumination.

Consider the following for every individual run:

28W for every 24" / 40W for every 36" / 53W for every 48"

RECOMMENDED

Lead and Jumper Line voltage cable must be Outdoor waterproof cable with gauge size between 18 AWG 3 conductor minimum and 14 AWG maximum to work with IP68 connector

Lead and Jumper 0-10V dimming, we recommend 18 AWG 2 conductor direct burial cable

Aluminum Sleeve Installation

24.72" / 35.71" / 46.73"

TOP VIEW

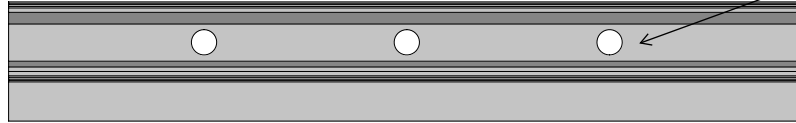

Holes in sleeve for draining

SIDE VIEW

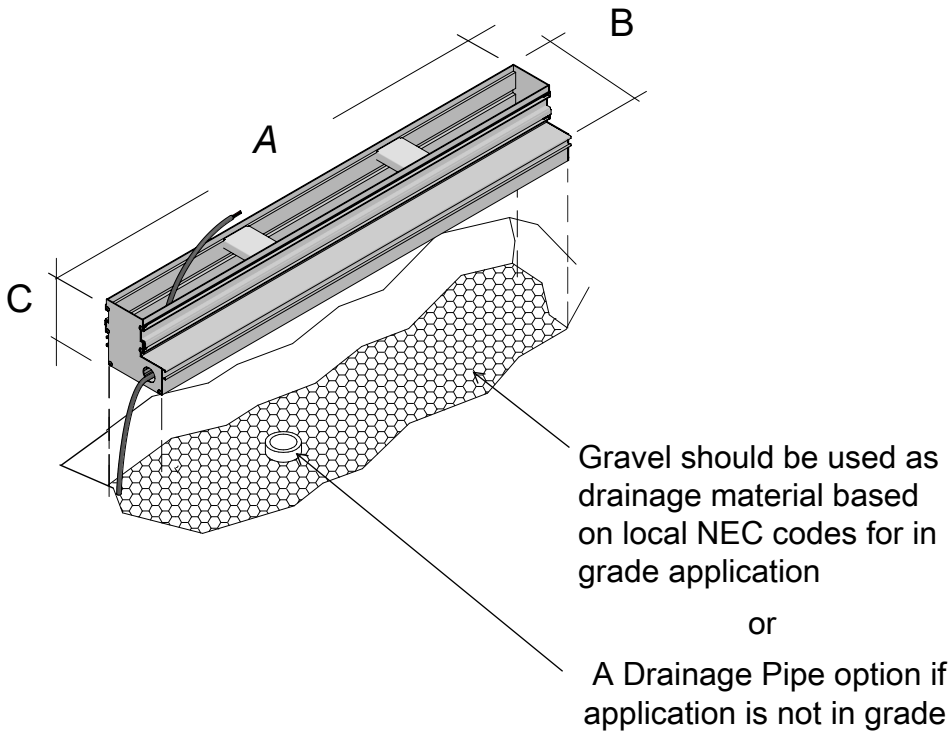

SLEEVE DIMENSIONS

CODE ALUM	A in	B in	C in
1E3733	24.72"	3.70"	3.46"
1E3734	35.71"	3.70"	3.46"
1E3735	46.73"	3.70"	3.46"

- In order to check the efficiency of the drainage, the quantity of water equivalent to the volume of the sleeve must completely drain in 45 minutes
- Drainage testing should be performed prior to installation of the sleeve

TEST DRAINAGE

WARNING

Failure to provide adequate draining installation will void warranty

*Install insertion sleeve on the desired area where light fixture will be illuminating. Make sure the sleeve is mounted on a compressed base and leveled. Metal cover plates must be placed into position before pouring concrete.

Aluminum Sleeve

Concrete or fill substrate

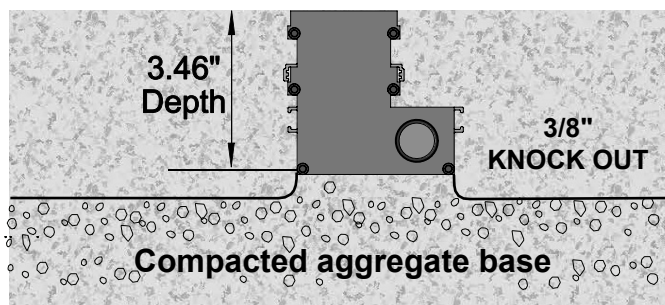

Important:

Make sure Sleeve is level by adjusting mounting surface.

A sloped surface will affect the light distribution of a fixture. Ground level is optimal for a tilt setting for your application.

Power Connection Instructions

- **JEDI Compact Recessed Integral** fixtures will have a line voltage cable and a 0-10V dimming cable attached on the fixture 24" in length. Installer must connect the correct lead line voltage to power output and low voltage cable to controller and secure the connections with the compliant connectors. Manufacturer will supply UL listed IP68 line voltage connectors and waterproof low voltage heat shrink connectors, but contractor must supply both line voltage power and low voltage dimming lead cables.
 - Line voltage cable must be Outdoor rated waterproof cable with gauge size between 18 AWG minimum and 14 AWG maximum to work with IP68 connector (check load and distance to determine correct gauge size).
 - 0-10V lead cable must be direct burial weatherproof cable.
 - Use supplied heat-shrink connectors for low voltage connections and then use waterproof heat-shrink tubing, also supplied, to complete the connection.

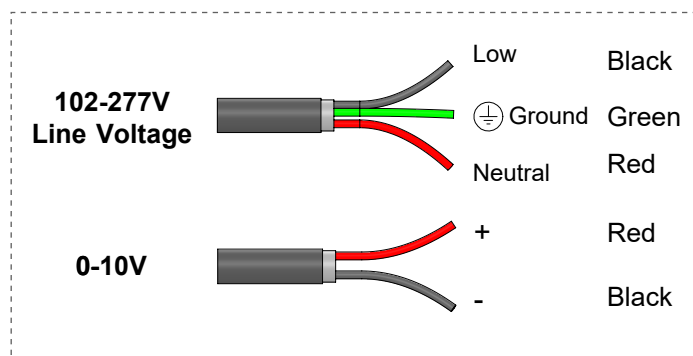

Waterproof 18 AWG heat shrink connector supplied with fixture for field

4" Heat-shrink Tubing

0-10V lead cable connected to UL listed Belden shielded direct burial cable. (not supplied)

Line Voltage lead wire connect to IP68 Line Voltage connector. Outdoor grade waterproof cable with wires that range from 18 AWG to 14 AWG. (not supplied)

IP68 UL Listed Line Voltage connector supplied, (connector assembly guide on separate document provided with fixture)

Mounting Instructions

- Once all the cables are connected correctly and secured on the fixture per the wiring diagram, it is time to insert the JEDI fixture into the installation sleeve.
- Installer must first locate all the connectors that are attached on the fixture and place them in the cable cavity. The cable cavity is adjacent to the fixing bracket. **DO NOT** place the connectors directly under the same cavity as the fixing bracket. This will not allow the fixture to sit flush when installed and could damage the connectors while installing the fixture.

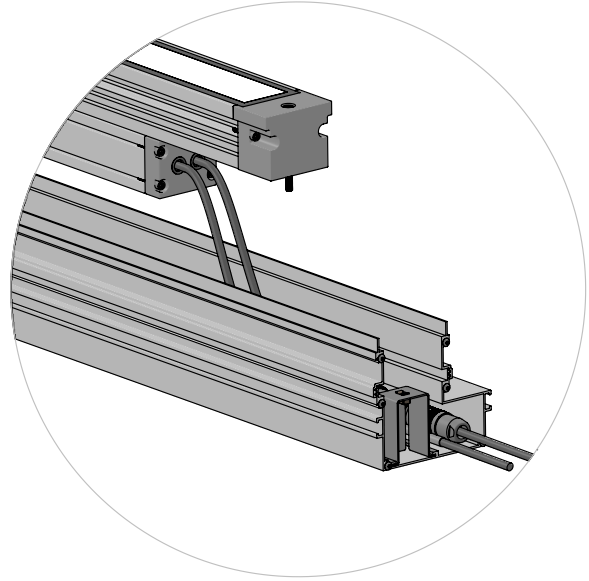

- Once the connectors and cables are in the correct cavity, insert the fixture into the sleeve and be sure that the fixture is even when setting it in.
- Once set, use a 3mm Allen hex key, (not included) to screw both sides of the fixture down onto the sleeve until the fixture is locked and leveled.
- The fixture is installed correctly when sets flush with the installation sleeve.

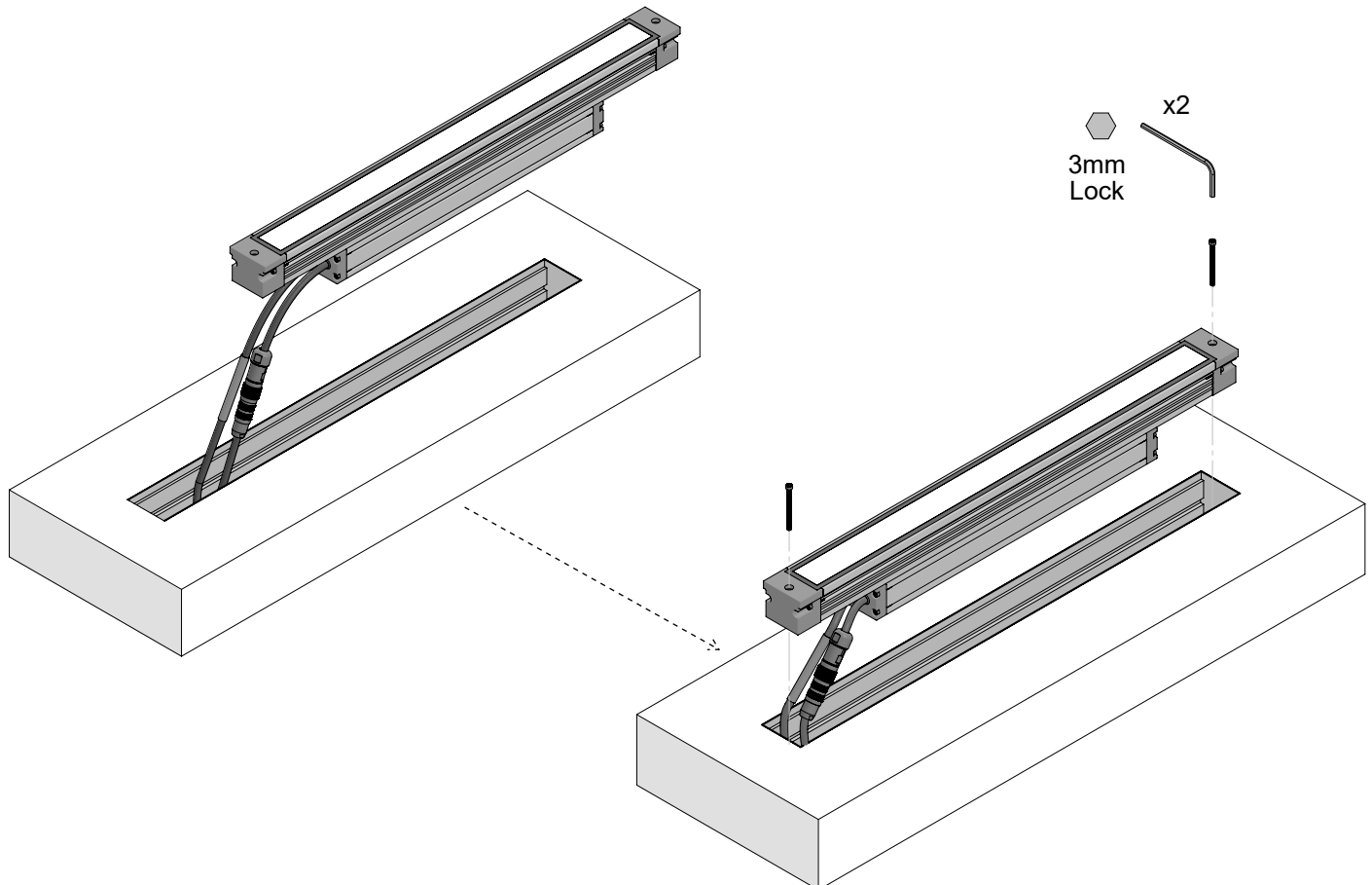

Maintenance

This fixture was designed and manufactured for a durable, long lasting use with minimum care. To ensure the maximum lifespan of this product, we encourage our customer to provide a quality visual inspection of the fixture and installation accessories every six months. If there are any visible signs of issues (i.e moisture or dust) during the inspection, please clean any of the dust or moisture with a soft cloth and check to make sure that any of the fixtures are still operating normally. If there are any issues regarding the fixture please contact us as we will assist the situation at hand.

Support

Any questions, problems, or comments you have please feel free to contact our Customer Service department during our business hours Monday-Friday 8am-5pm via: Email: usaorders@targetti.com
Phone: (714) 513-1991

Visit our website: <http://www.targettiusa.com>