

# PRAP-U PROFILE

## Aluminum Surface Mount Universal Profile

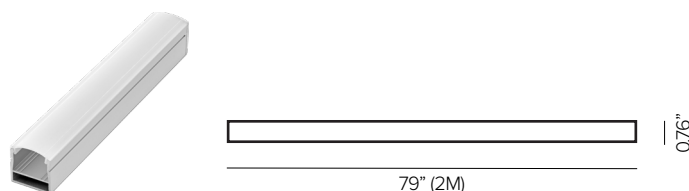

Shown with PRAP-U profile and KTRAP-UEC end cap.

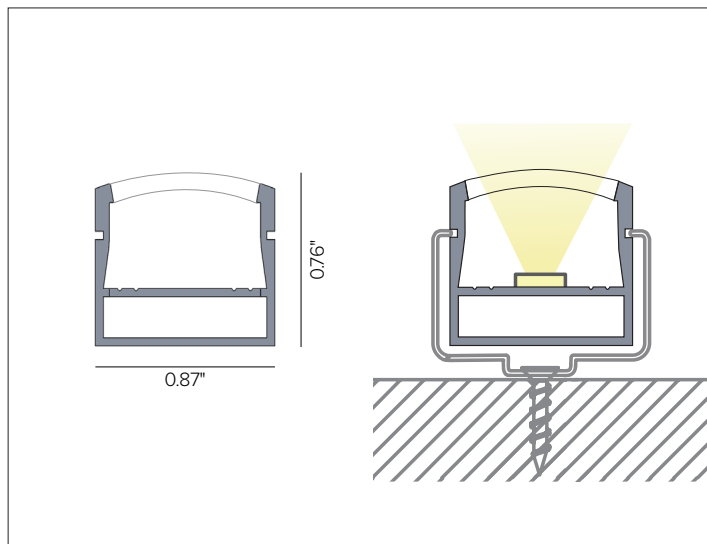

Universal surface mount anodized aluminum rigid profile complete with lens.

Universal profile replacement lens, 5pcs. **(OPTIONAL)**

Lens	Opal Diffused	Asymmetric	Graze	Flood
Optic	120°	89° x 92°	24°x94°	38° x 103°
Part No.	<b>PRAP-U</b>	<b>PRAP-UASYM</b>	<b>PRAP-U30</b>	<b>PRAP-U60</b>

Lens	Opal Diffused	Asymmetric	Graze	Flood
Optic	120°	89° x 92°	24°x94°	38° x 103°
Part No.	<b>PRU-LENS</b>	<b>PRULENSASYM</b>	<b>PRULENS30</b>	<b>PRULENS60</b>

### ACCESSORIES



**Description** Stainless steel mounting clips, 10pcs. Recommended to use 4pcs for per each 2M profile.

**Part No.** **KTRU-CL**



**Description** PRAP-U end cap kit, silver finish. 5pcs without hole and 5pcs with hole for connection cable.

**Part No.** **KTRAP-UEC**

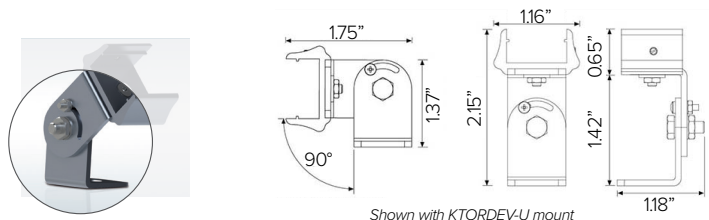

Shown with KTORDEV-U mount

**Description** Adjustable steel support bracket, 2pcs. To be completed with KTORDEV-U.

**Part No.** **OR-DEV**

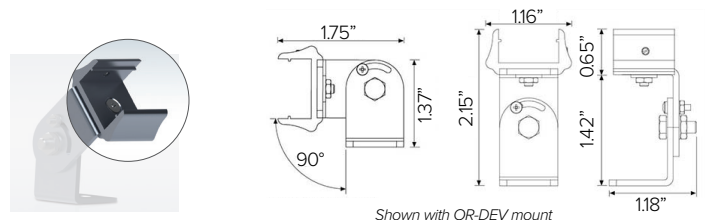

Shown with OR-DEV mount

**Description** Aluminum mount for PRAP-U profile, 2pcs. To be completed with OR-DEV. Suggested to use every 12"-18" O.C.

**Part No.** **KTORDEV-U**