

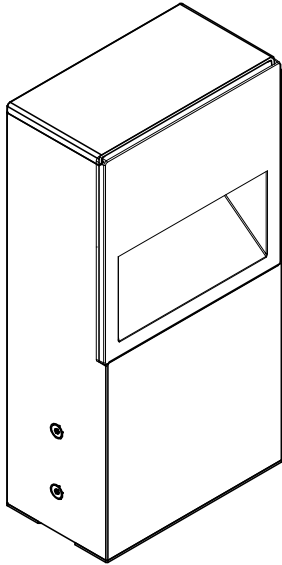

ZEDGE PRO BOLLARD

ZPB41-(16), (32), (40)

ADJUSTABLE ILLUMINATION PROFESSIONAL
LED BOLLARD



If in doubt about the symbols please
refer to catalog or website

WARNING

**To ensure a maximum efficient use
of the product, read the instructions
before proceeding installment.**



This fixture must be installed by a licensed
and qualified electrician. The installer must
comply with NEC and local building codes
when installing the fixture



Electrical current can cause painful shock,
serious injury, or even death. Make sure you
turn off the power supply, ground fixture(s),
and make sure all electrical connections are
correct and secured tightly



For use in IP66 installations.



Keep the label of the original packaging if any
eventual future claims are needed

For available options refer to spec sheet pg. 1

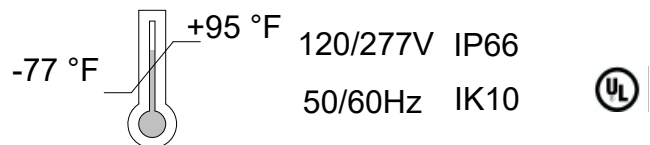
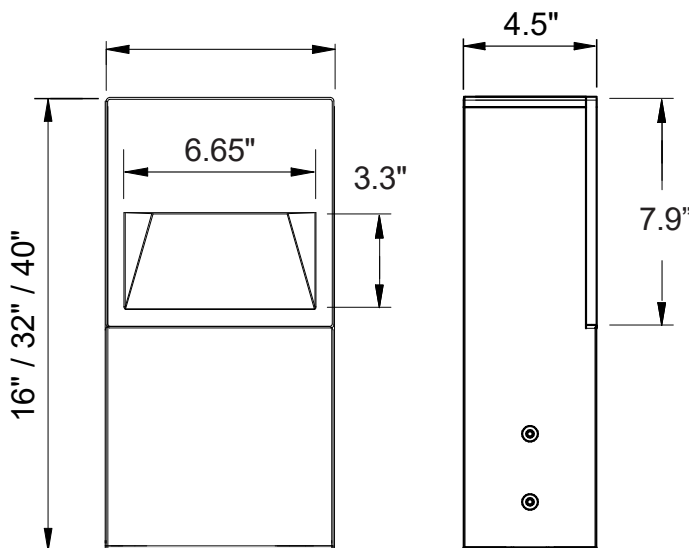

16" Bollard

32" Bollard

40" Bollard

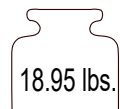

Table of Contents

Packaging Contents /Mounting Base

Mounting Base Installation / Drainage / J-Box Installation 1US34501

Mounting Base Installation / Drainage / J-Box Installation 1US34502

Wiring Diagram

Bollard Installation

Maintenance / Support

Pg.2/3

Pg.4/5

Pg.6/7

Pg.8

Pg.9

Pg.10

Pg.1

Packaging Contents

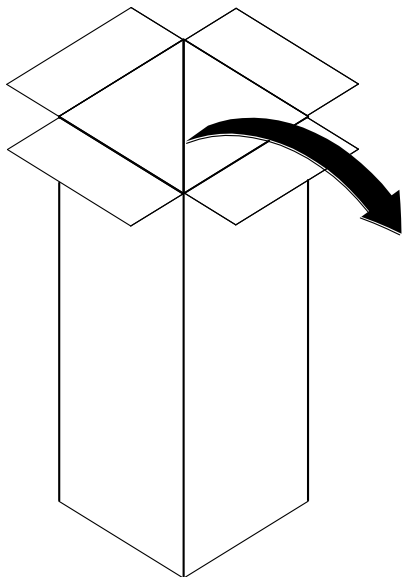

Box 9"x12"x22" @11.10lbs.
Box 9"x12"x38" @16.32lbs.
Box 9"x12"x46" @18.95lbs.

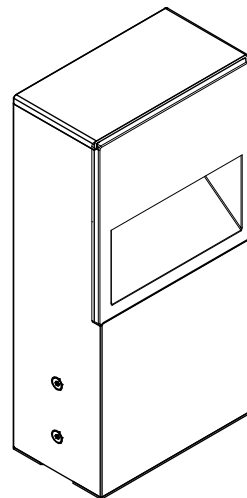

Bollard 16" / 32" / 40" 1 ea.

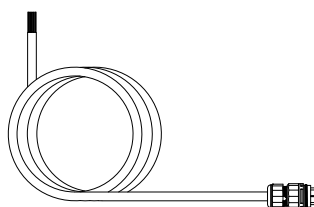

Standard 4ft Lead Cable 1 ea.
Cabled with Belden 16-6 600V cable
and Female 5 pole IP68 anti-wicking
quick disconnect 4ft lead cable.

Zedge Pro Bollard Connector Pin Callouts

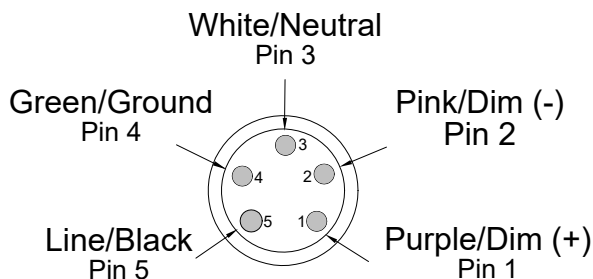

Conductor Callout

Black = line voltage

White = neutral

Green = ground

Red = Do Not Use

Purple = positive 0-10V

Pink = negative 0-10V

All conductors are 600V rated.

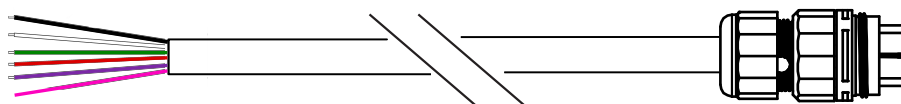

Mounting Base Options / (Sold Separately, Must Use 1 Option)

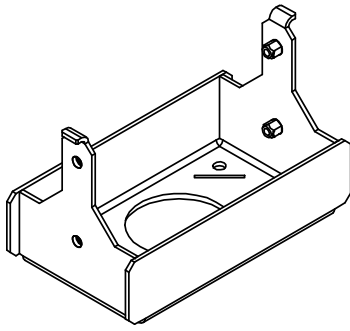

1US34501

Surface mount Bollard base 1 ea.

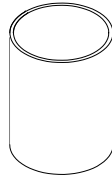

6" PVC Sleeve 1ea.



Tool Torx 30 Anti Theft 1 ea.



Concrete screws/anchor bolts by others 1/4" x 2-1/2 - 4" (recommended) , 4ea.

Trimless mounting base with ground anchor fixing rods for installation in concrete. AISI 316 stainless steel. Mounting bolts Ø 8.5mm (1/4") included, 4pcs. **Required for use with 1US2530 by NEC.**

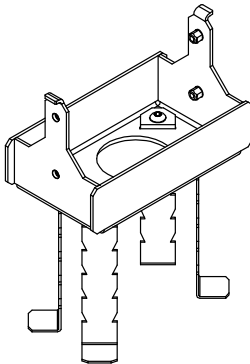

1US34502

Concrete Anchor Bollard base 1 ea.

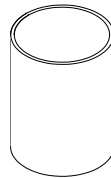

6" PVC Sleeve 1ea.



Tool Torx 30 Anti Theft 1 ea.



Shim Washers 3/8"x3/4" flat 6 ea. (for leveling)

Trimless mounting base with ground anchor fixing rods for installation in concrete. AISI 316 stainless steel. Mounting bolts Ø 8.5mm (1/4") included, 4pcs. **Required for use with 1US2530 by NEC.**

Each fixture must be used supplied with either one of the 2 mounting bases above depending on application. 1each 1US2530 Brass J-Box must also be purchased separately.

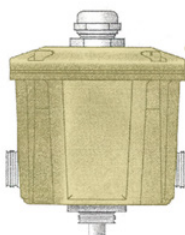

1US2530

Direct Burial Brass Ingrade J-Box 1ea.

Direct burial brass ingrade j-box with PVC sleeve. Features stainless steel cover screws and strain relief for power cord, (2) 3/4" NPT bottom holes and (2) 3/4" NPT side holes. Includes (4) 3/4" to 1/2" adapters and (2) 1/2" NPT plugs.

1US34501 Surface Mount Base Installation

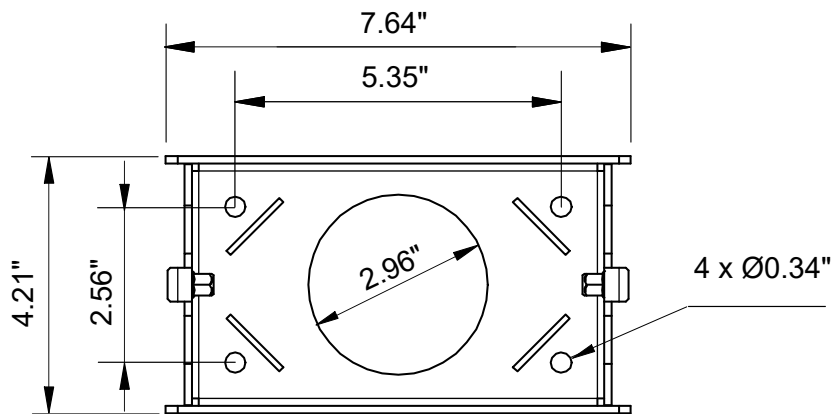
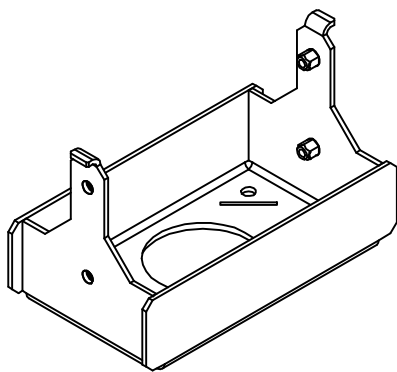

*Surface Mount Base

requires 4 concrete screws/anchor bolts (provided by others) to secure the base onto the surface.



Concrete screws/anchor bolts by others
1/4" x 2-1/2 - 4" (recommended)

Once power cord has been connected, install the base onto position by drilling holes on the concrete and using concrete screws/anchor bolts.

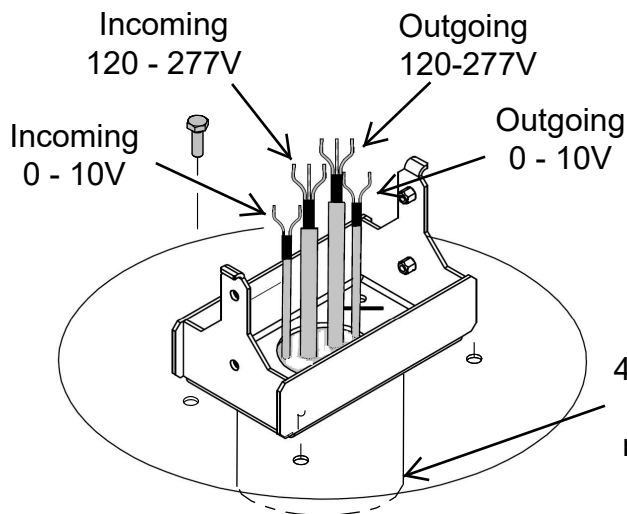

Leveling washers can be inserted under mounting base to slightly tilt Bollard if needed.

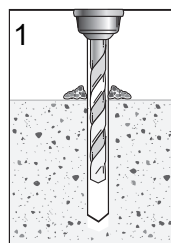

1 Use proper size drill bit to drill holes (4 holes required)

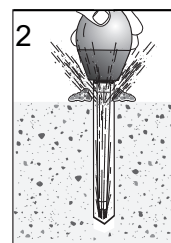

2 Clean holes using air nozzle (remove all debris)

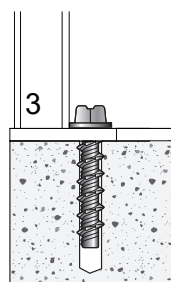

3 Place mounting base in position then drive anchor bolts using impact hammer and drill until fully seated. Use leveling washers if needed to slightly tilt Bollard

Drainage / J-Box Installation

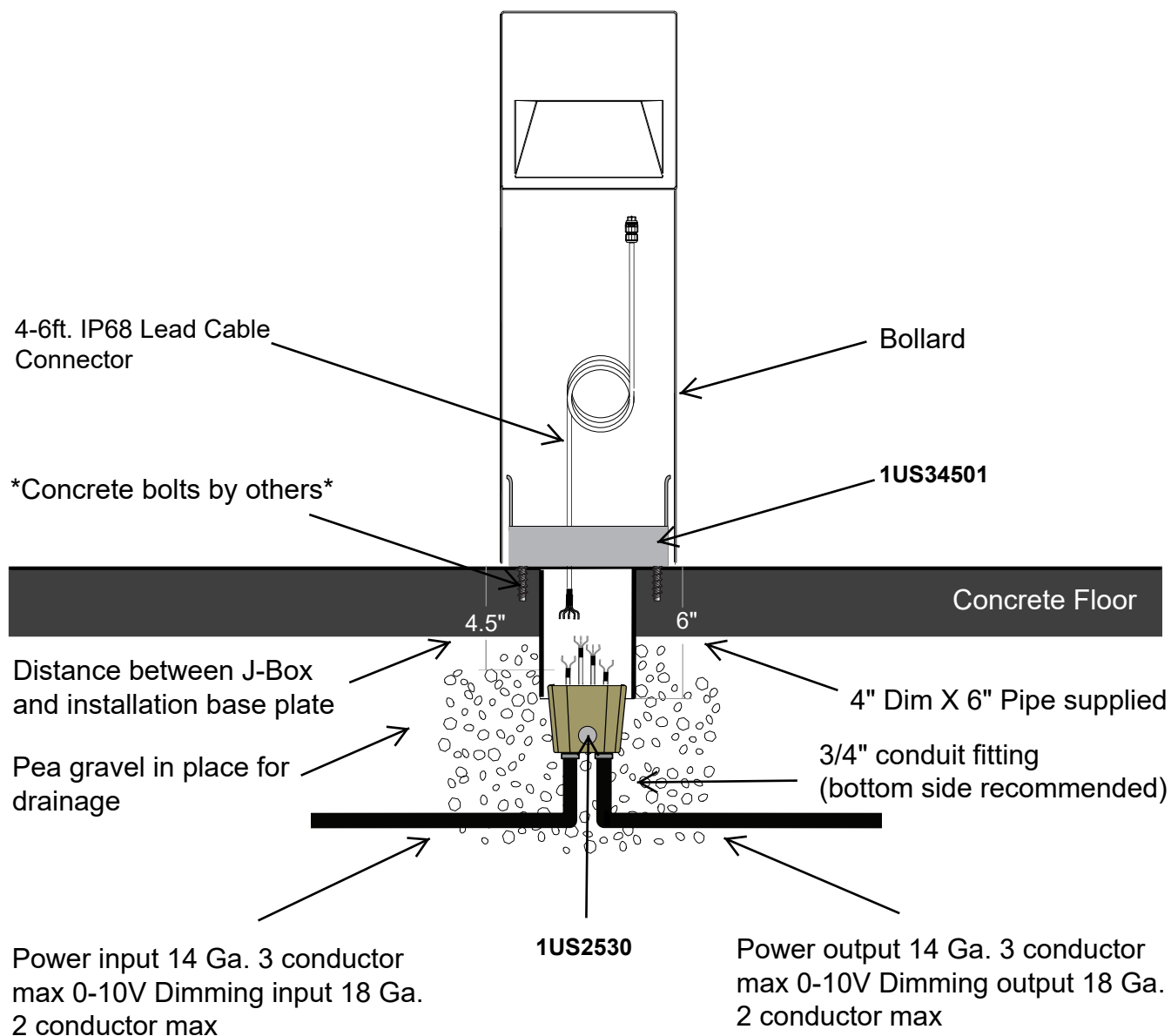

1US3502 Mounting Base Installation

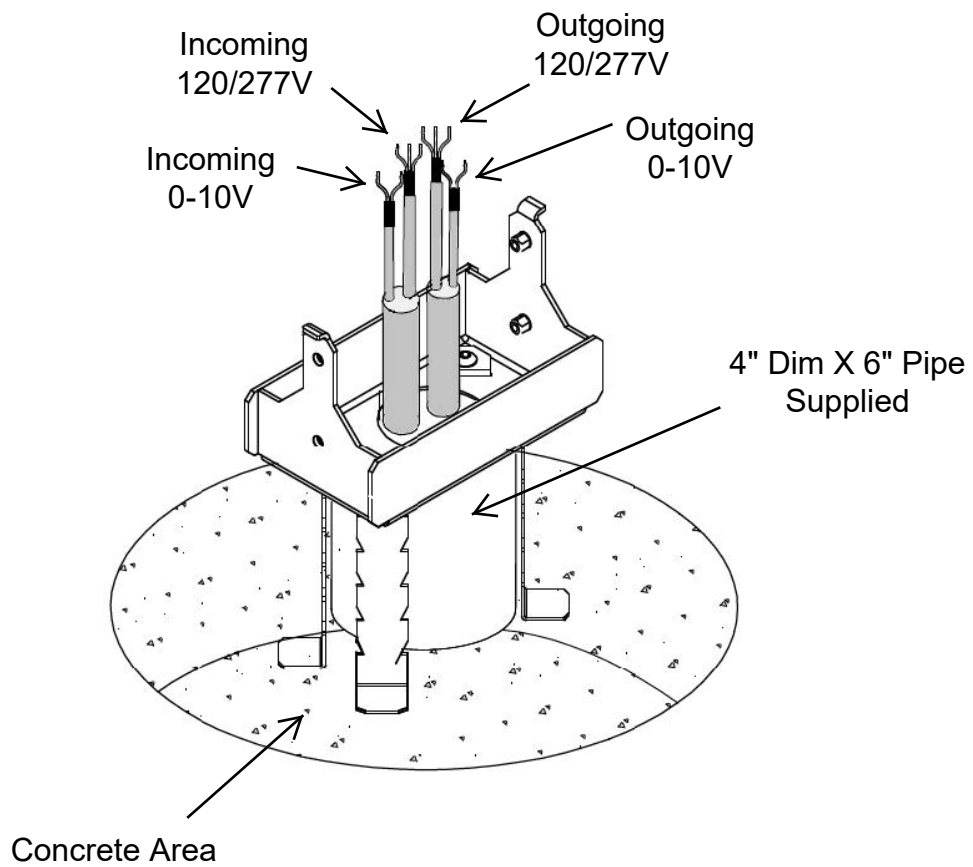
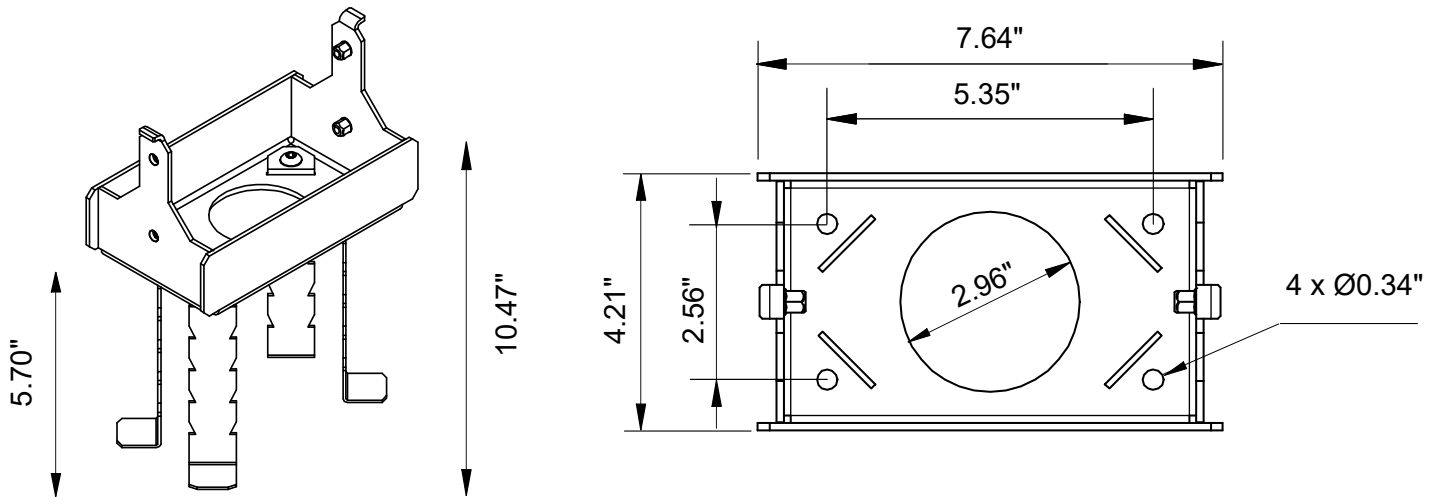

Drainage / J-Box Installation

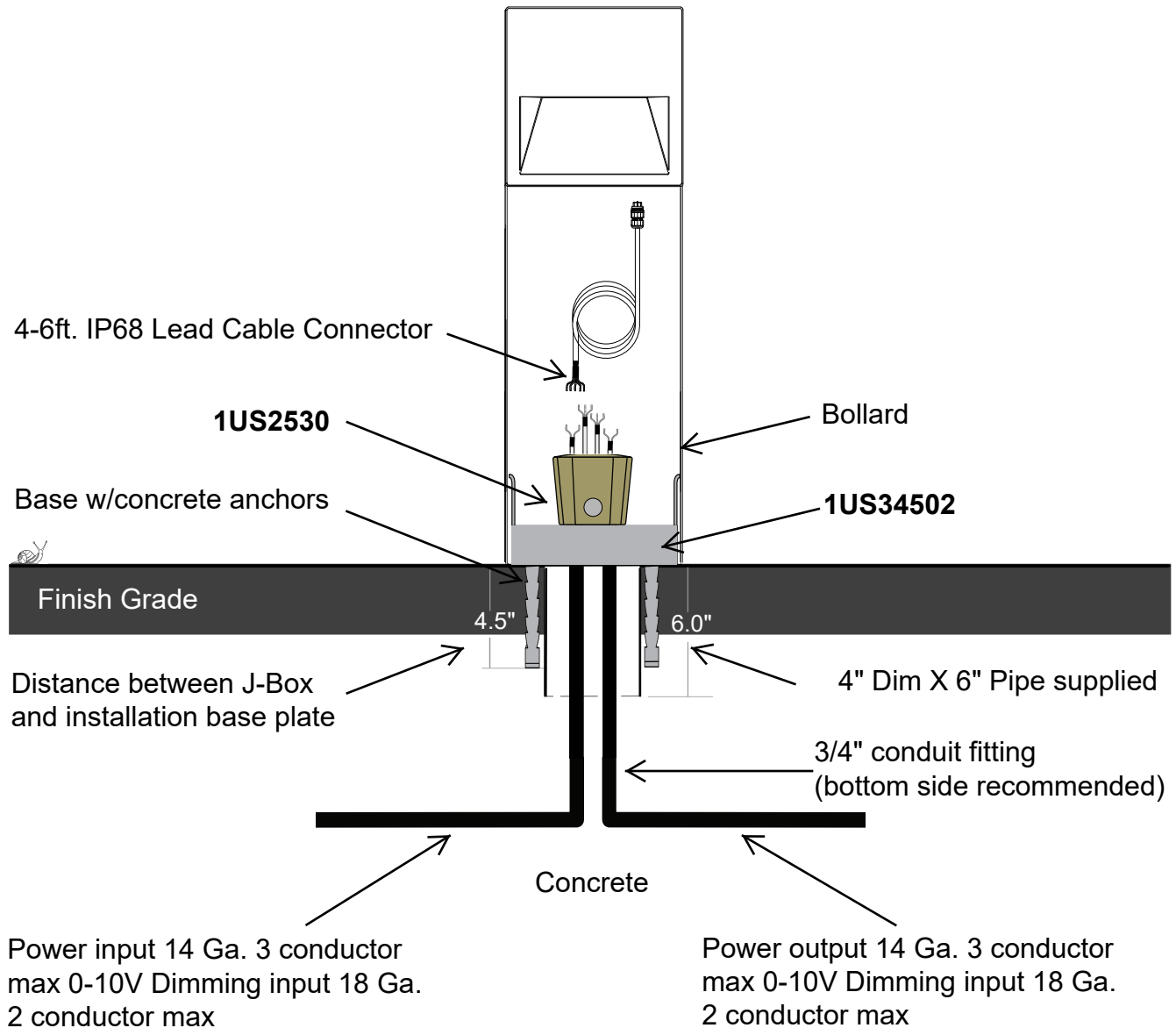

Wiring Diagram

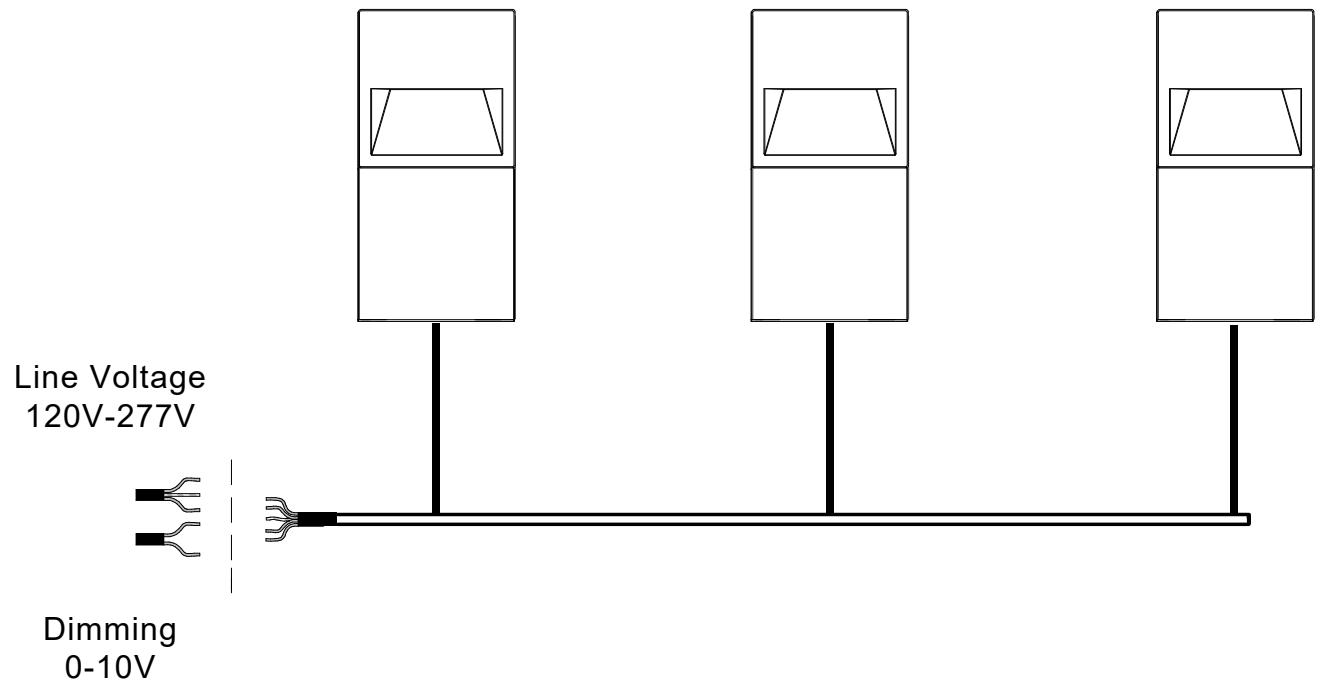

Distribution of Light

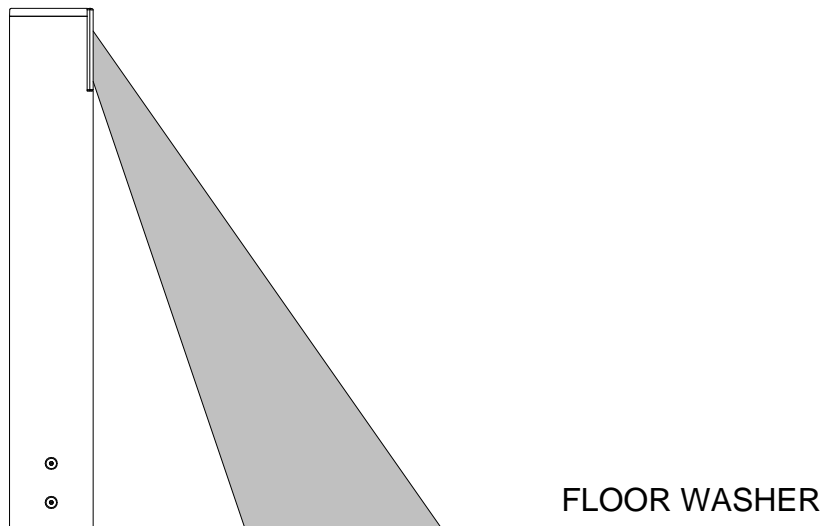

Bollard Installation

After the mounting base has been installed and power cord connections have been made, proceed to install the Bollard into the base.

- Simply remove the screws from the base and insert the Bollard into position, then insert the screws in holding the Bollard onto the base as shown on image bellow.
- Be sure to use all 4 screws 2 on each side and tighten.

Torx 30 Included

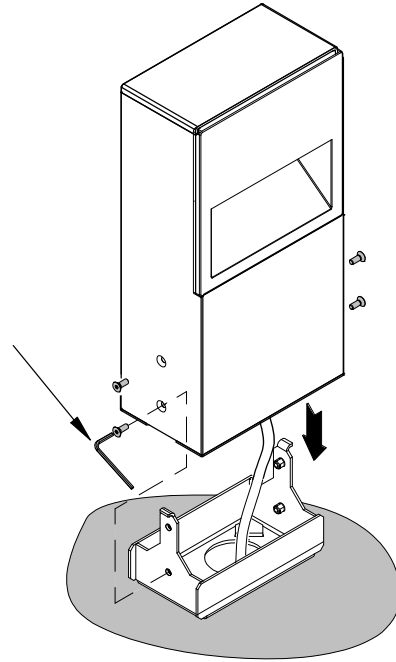

*Bollard, Fixture Head, and Face Plate are shipped assembled with Power cord connected to the fixture.

If power cord needs to be disconnected from fixture, remove the faceplate following these simple steps.

1. Loosen the screws inside the faceplate using a 2.5mm Allen wrench.
2. Carefully pull the face plate towards you.
3. Access the power cord inside the bollard and disconnect. Repeat these 3 steps in reverse to complete installation.

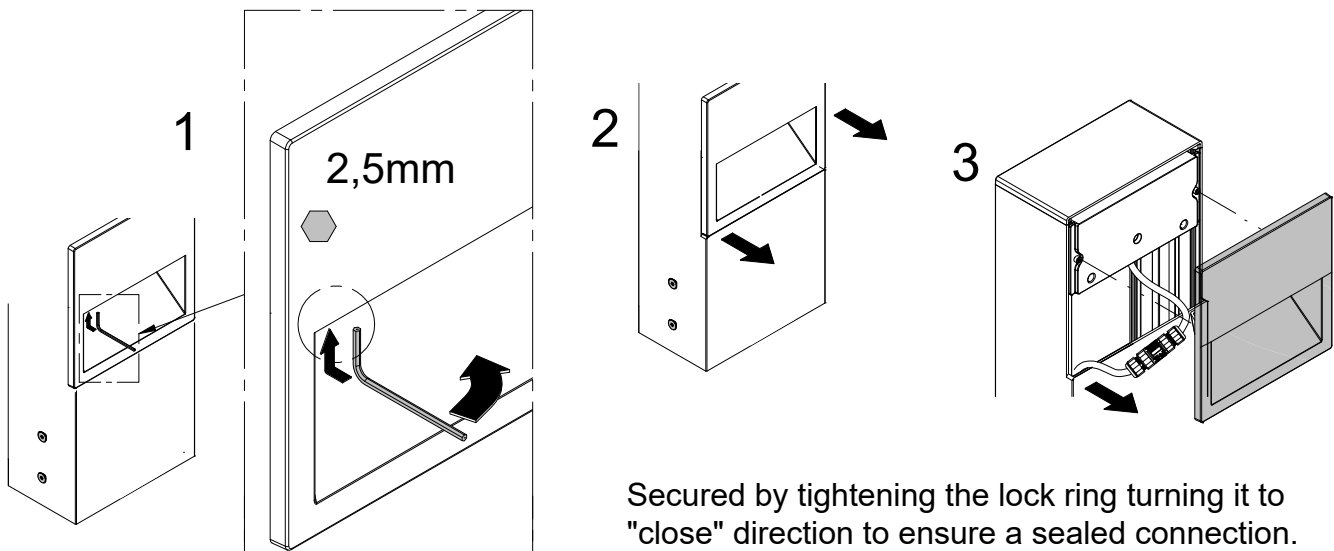

Secured by tightening the lock ring turning it to "close" direction to ensure a sealed connection.

Maintenance

This fixture was designed and manufactured for a durable, long lasting use with minimum care. To ensure the maximum lifespan of this product, we encourage our customers to provide a quality visual inspection of the fixture and installation accessories every six months.

If there are any visible signs of issues (i.e moisture or dust) during the inspection, please clean any of the dust or moisture with a soft cloth and check to make sure that any of the fixtures are still operating normally. If there are any issues regarding the fixture please contact us as we will assist the situation at hand.

Support

Any questions, problems, or comments you have please feel free to contact our Customer Service department during our business hours Monday-

Friday 8am-5pm via: Email:
usaorders@targetti.com Phone: (714) 513-1991

Visit our website: <http://www.targettiusa.com>