

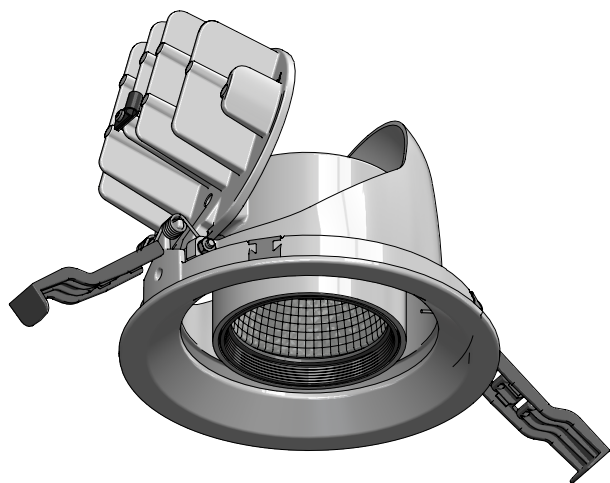

EVO EXTRACTABLE 162

CEE162-

EXTRACTABLE 6" LED
DOWNLIGHT PROJECTOR



120/277V
50/60Hz

IP20

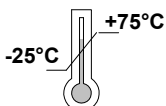

If in doubt about the symbols please
refer to catalog or website

WARNING

**To ensure a maximum efficient use
of the product, read the instructions
before proceeding installment.**



This fixture must be installed by a
licensed and qualified electrician. The
installer must comply with NEC and
local building codes when installing the
fixture



Electrical current can cause painful
shock, serious injury, or even death.
Make sure you turn off the power
supply, ground fixture(s), and make
sure all electrical connections are
correct and secured tightly



For use in IP20 installations.

Keep the label of the original
packaging if any eventual future claims
are needed

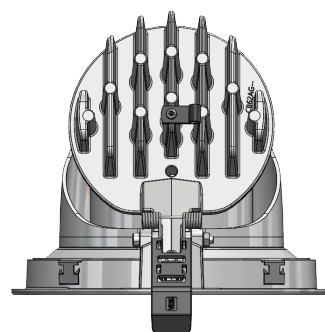
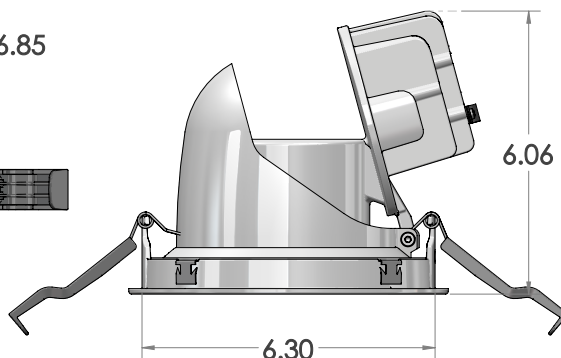
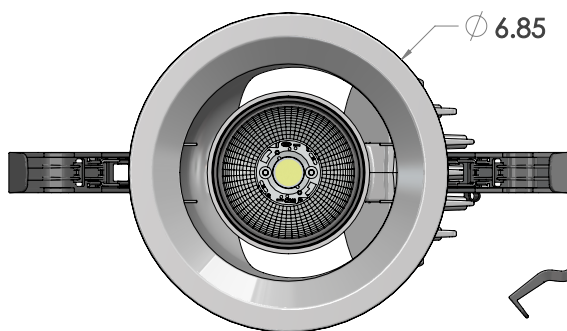
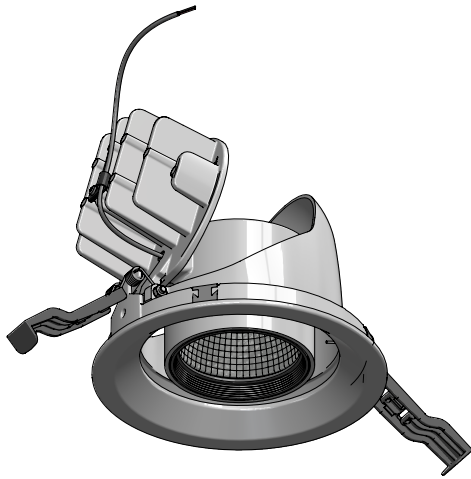

Table of Contents

Packaging Contents / Dimensions
Surface Installation
Installation Accessories
Diagram
Maintenance / Support

Pg.2
Pg.3/5
Pg.6/10
Pg.11
Pg.12

Packaging Contents / Dimensions



CEE162 - Fixture 1ea.

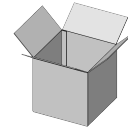

Finish

- Plaster White
- Deep Black

Box 8"x 8"x 9" @2.54lbs

SPECIFICATION INFORMATION

1 - PRODUCT CODE	2 - TYPE	3 - OPTICS	4 - WATTAGE	5 - KELVIN	6 - FIXTURE FINISH
CEE — EVO Extractable	162 — 6" Dia.	SP — SP 17° FL — FL 32° MF — MWFL 48° WF — WFL 57°	L1 — 27W L2 — 40W	27 — 2700K 30 — 3000K 35 — 3500K 40 — 4000K	PW — Plaster White DB — Deep Black
7 - INSTALLATION	8 - OPTICAL ACCESSORIES				
Non-IC Housing See section for details	Accessory Holder See section for details				
IC Housing See section for details	Softening Lens See section for details				
	Linear Spread Lens See section for details				
	Honeycomb Louver See section for details				
	Cut-Off Tube See section for details				

OPTICAL

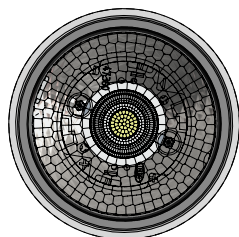

SP



FL



MF

Installation Accessories

INSTALLATION (REQUIRED)

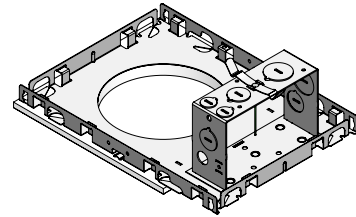
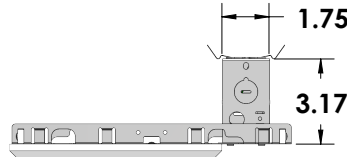
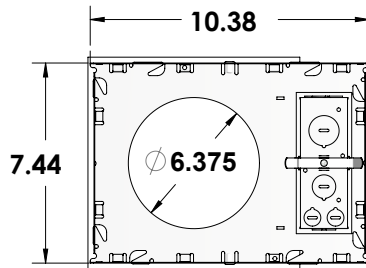

Non-IC plaster frame with pre-installed 5/8" fiber board with cut out for ease of installation in drywall.

<i>Wattage</i>	L1(20W)	L2 (20W)
<i>Voltage</i>	120V	120V
<i>Part No.</i>	CCE162NCL112041	CCE162NCL212041
<i>Voltage</i>	277V	277V
<i>Part No.</i>	CCE162NCL127710	CCE162NCL227710

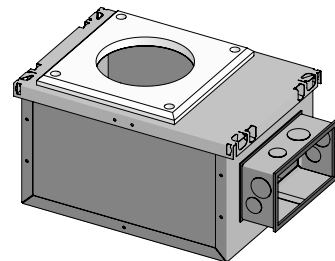
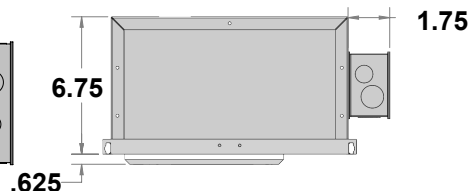
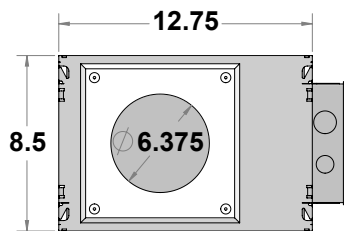
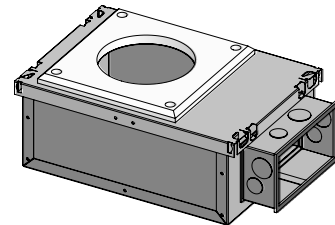
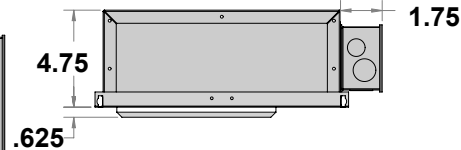
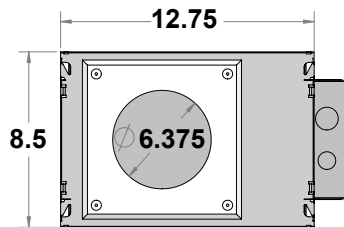

IC/Air tight housing with pre-installed 5/8" fiber board with cut out for ease of installation in drywall. Suitable for Chicago Plenum rated installation.

<i>Wattage</i>	L1(20W)	L2 (20W)
<i>Voltage</i>	120V	120V
<i>Part No.</i>	CCE162ICL112041	CCE162ICL212041
<i>Voltage</i>	277V	277V
<i>Part No.</i>	CCE162ICL127710	CCE162ICL227710

Installation Accessories

OPTICAL ACCESSORIES (OPTIONAL)

1T1708



'Blade of Light' linear spread lens. Flat glass, grooved refractive filter. **To be completed with 1T3727.**

1T1711



Anti-glare louver. Lacquered metal honeycomb structure. **To be completed with 1T3727.**

1T1709

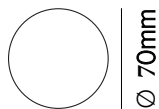

Softening lens. Flat glass micro prismatic refractive diffusive filter. **To be completed with 1T3727.**

1T3727

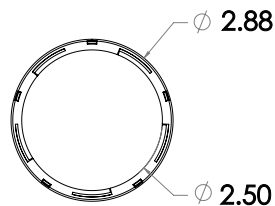
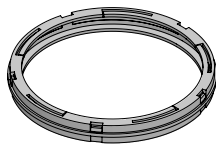

Polycarbonate accessory holder. Required for use of all filters and honeycomb louver.

1T3142



Cut-off tube. Allows for the beam to be focused while removing the 'fall-off' light.

Installation Instructions

Key Features

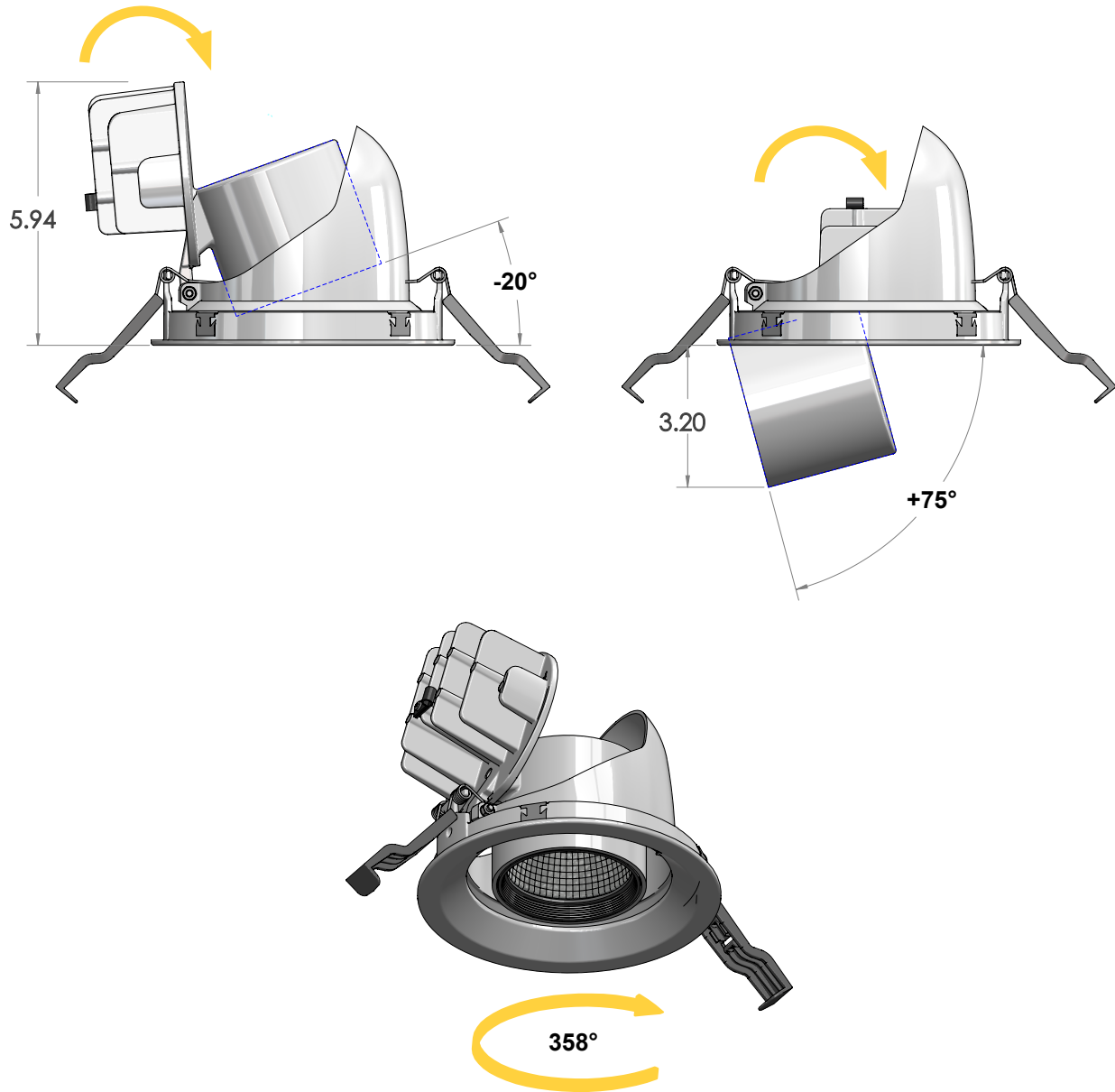

Friction rotation system with adjustability of the fixture from $-20^{\circ}/+75^{\circ}$ on a vertical plane and can be manually aimed to 358° on a horizontal plane.

Installation Instructions

Non-IC plaster frame with pre-installed 5/8"

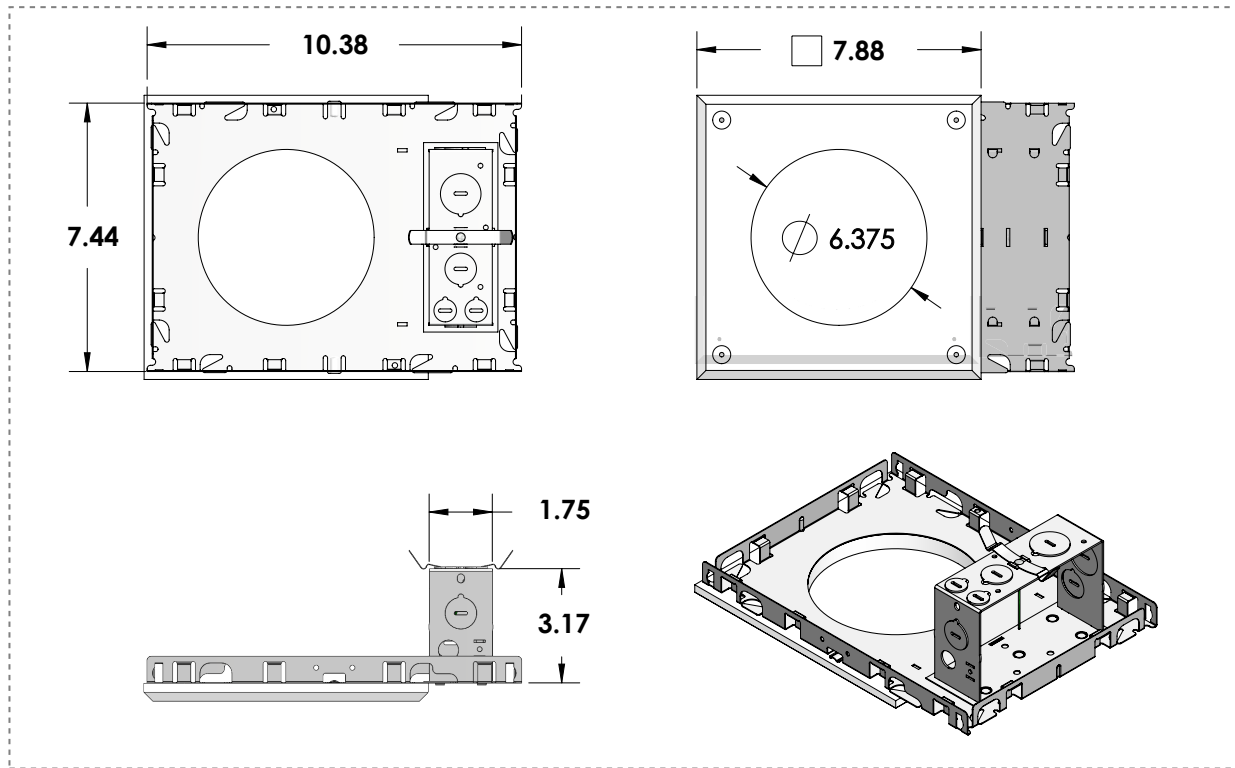

Non-IC plaster frame with pre-installed 5/8" fiber board with cut out for ease of installation in drywall.

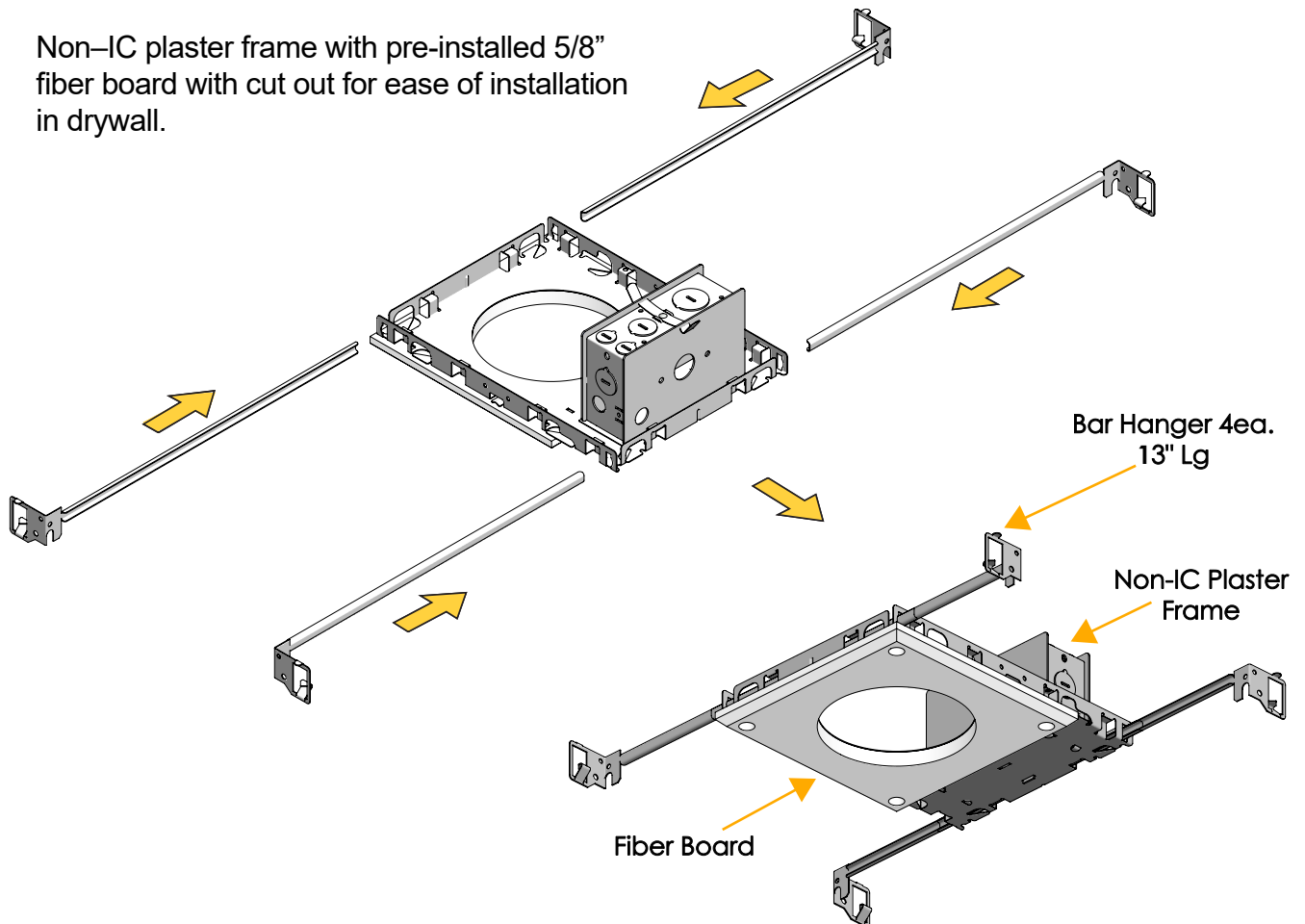

Installation Instructions

IC/Air tight housing with pre-installed 5/8"

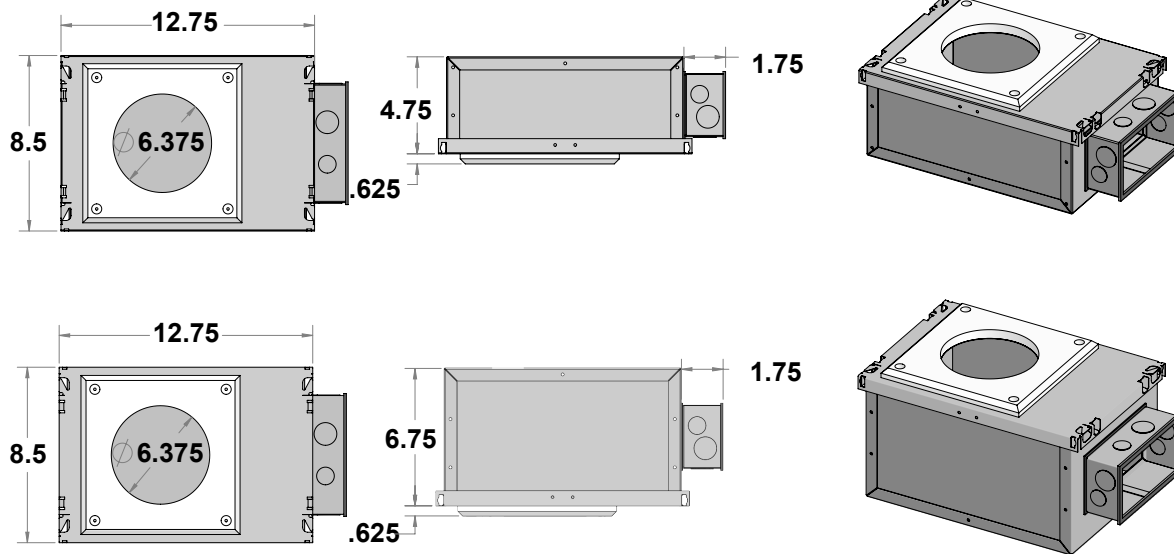

IC Air tight housing with pre-installed 5/8" fiber board with cut out for ease of installation in drywall.

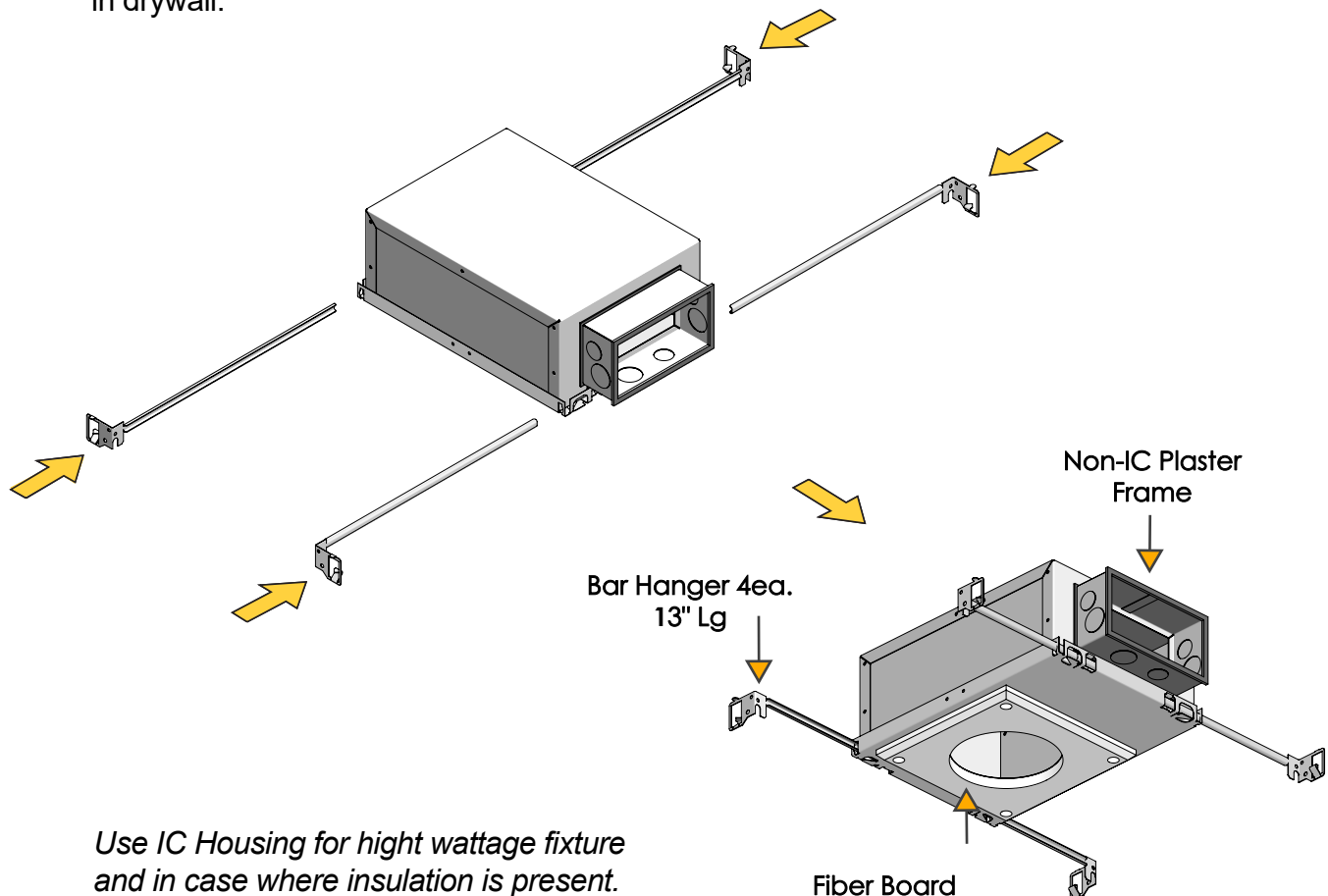

Use IC Housing for high wattage fixture and in case where insulation is present.

Installation Instructions

Install Non-IC plaster frame with pre-installed 5/8" in drop ceiling

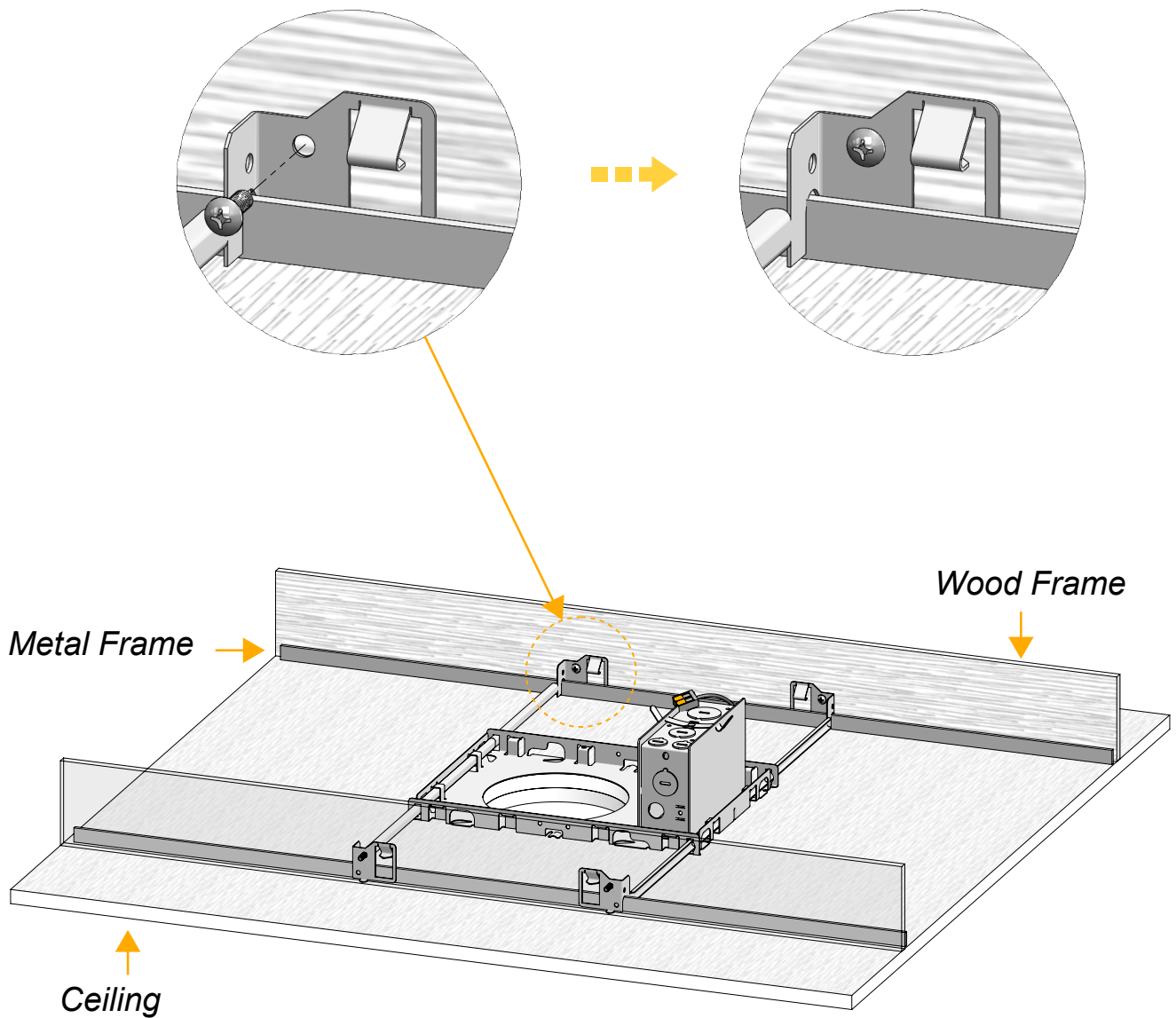

Installation Instructions

Non-IC plaster frame with pre-installed 5/8"

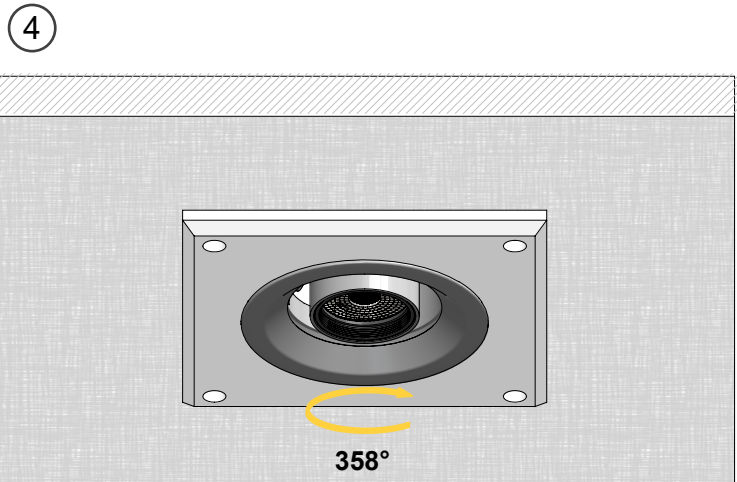
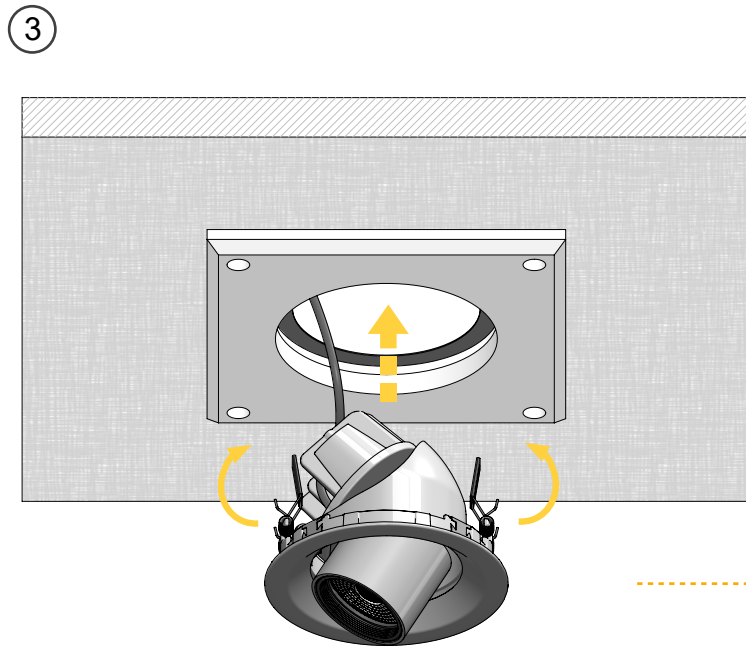
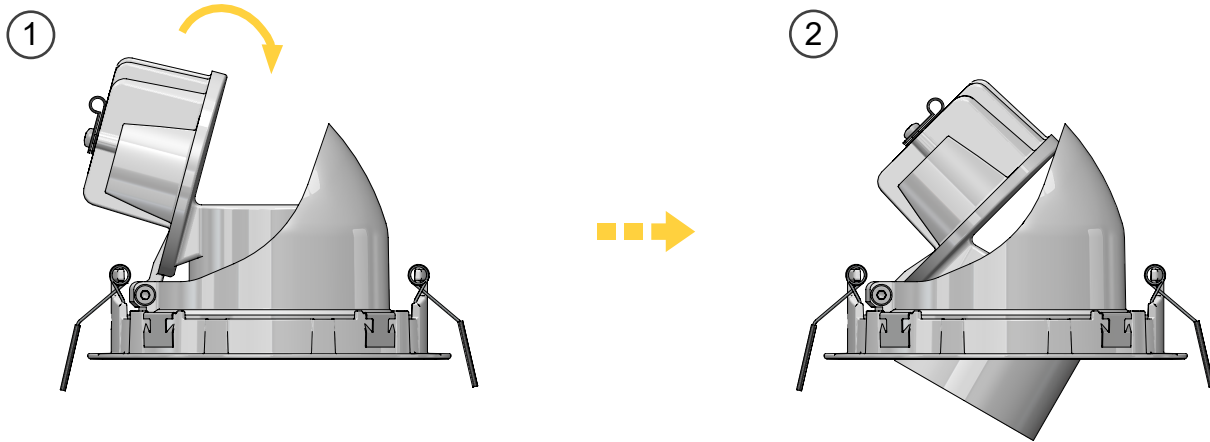

Accessory Assembly

162 Extractable

1

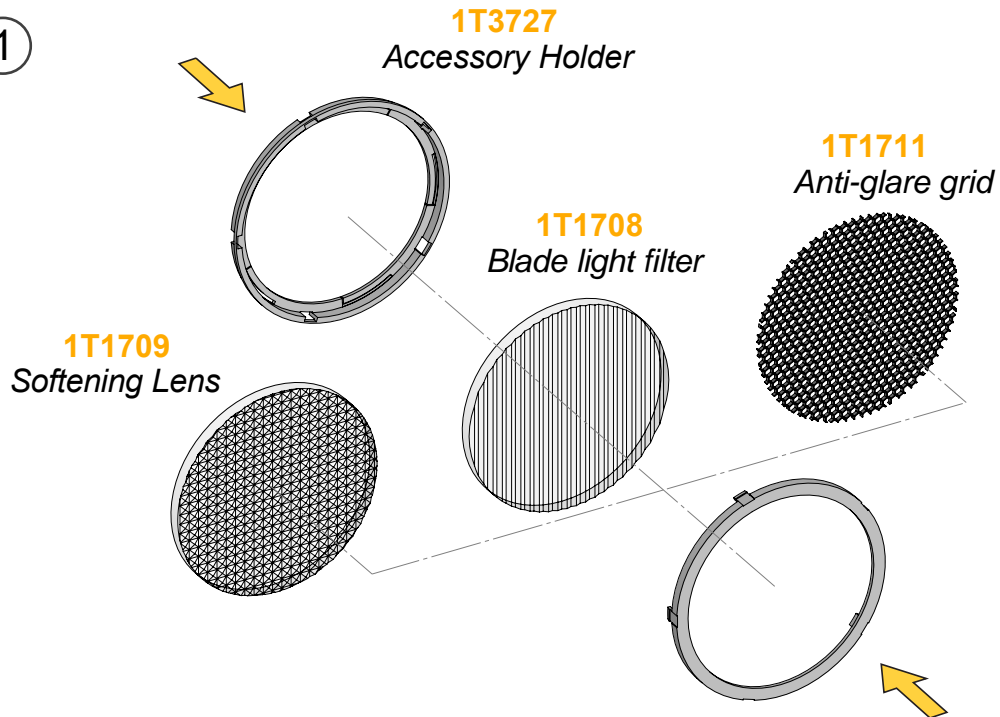

2

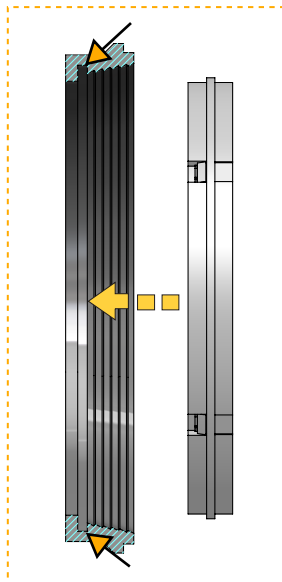

3

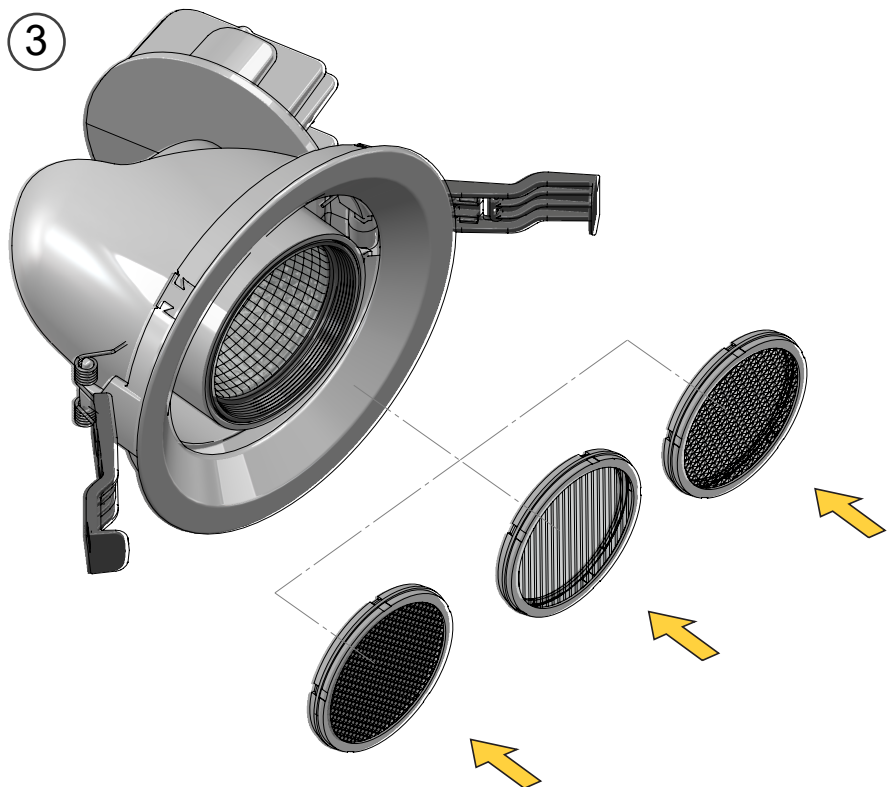

Accessory Assembly

Asymmetric Screen Cut-off

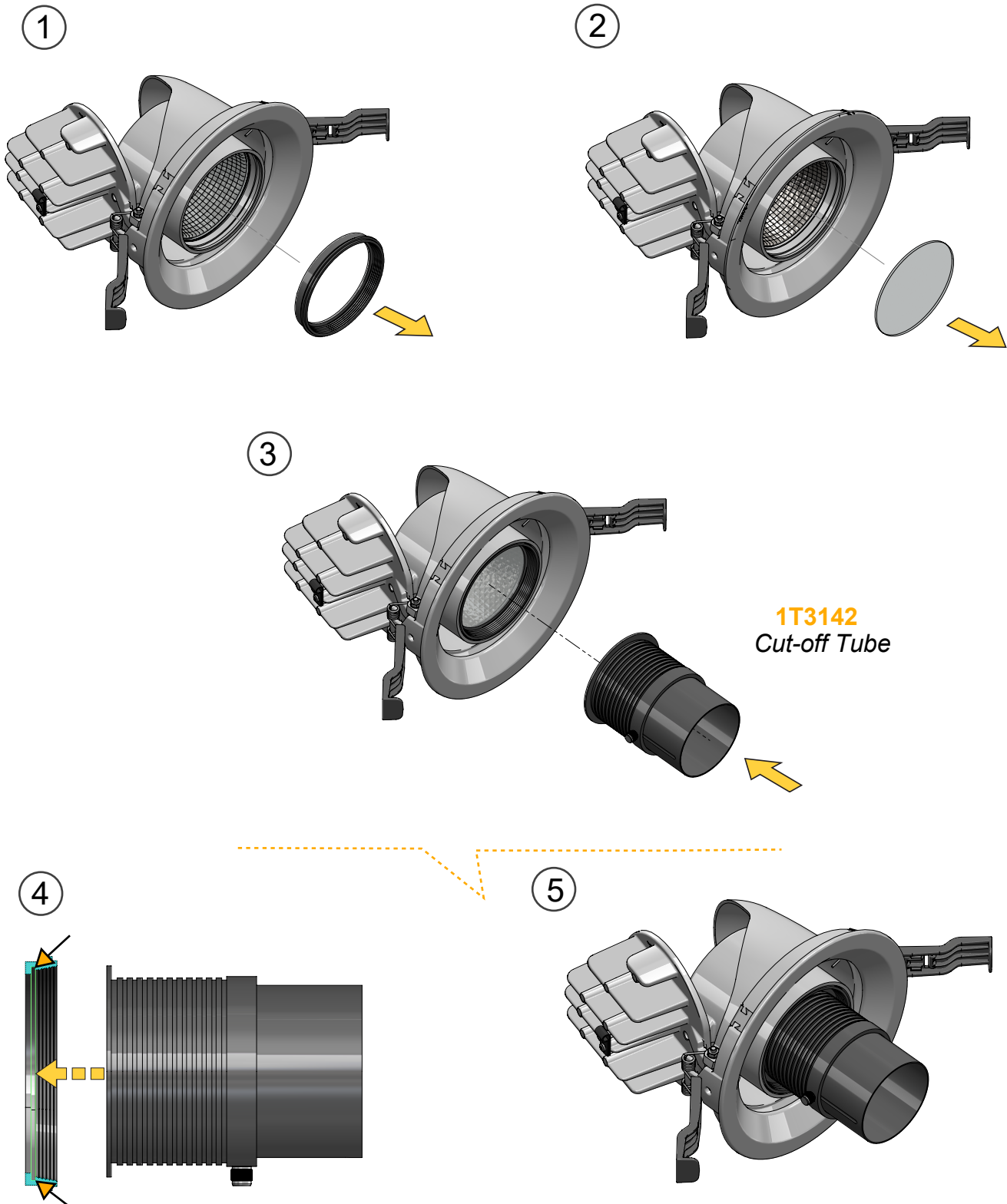

Accessory Assembly

Asymmetric Screen Cut-off

Adjustment Cut-off Tube

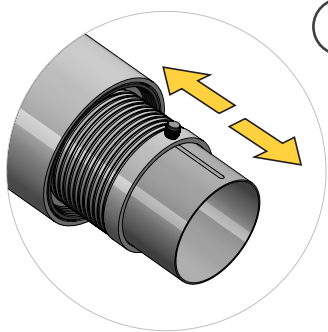

1T3142
Cut-off Tube

①

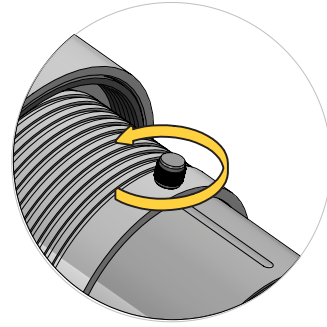

③

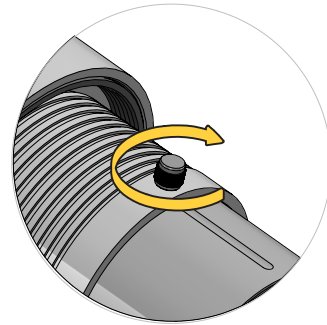

Cut-Allows for the beam to be focused while removing the 'fall-off' light.

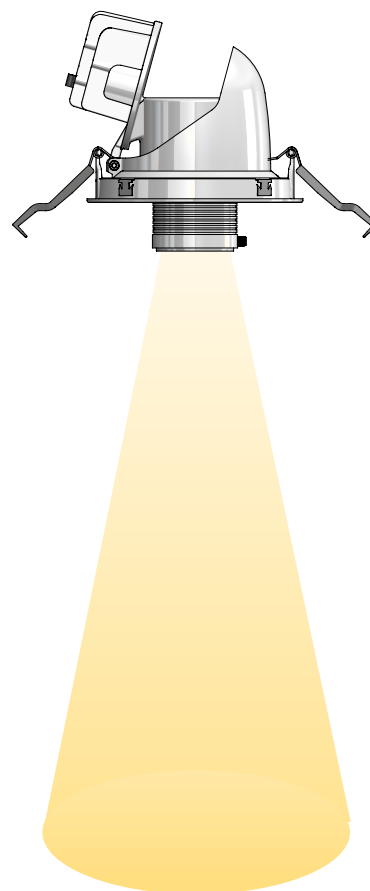
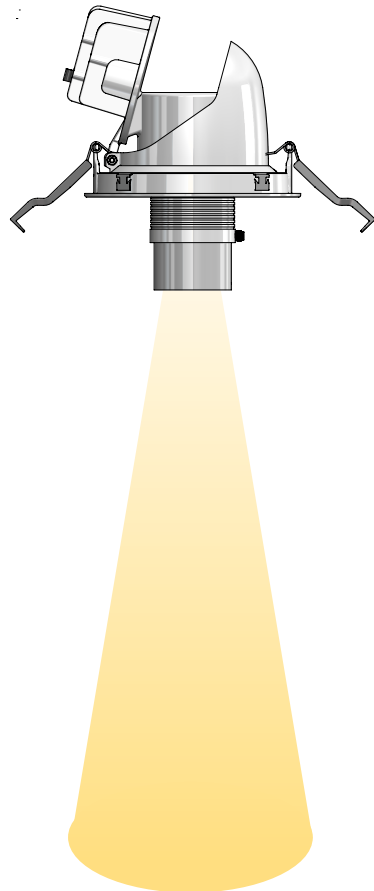

Diagram

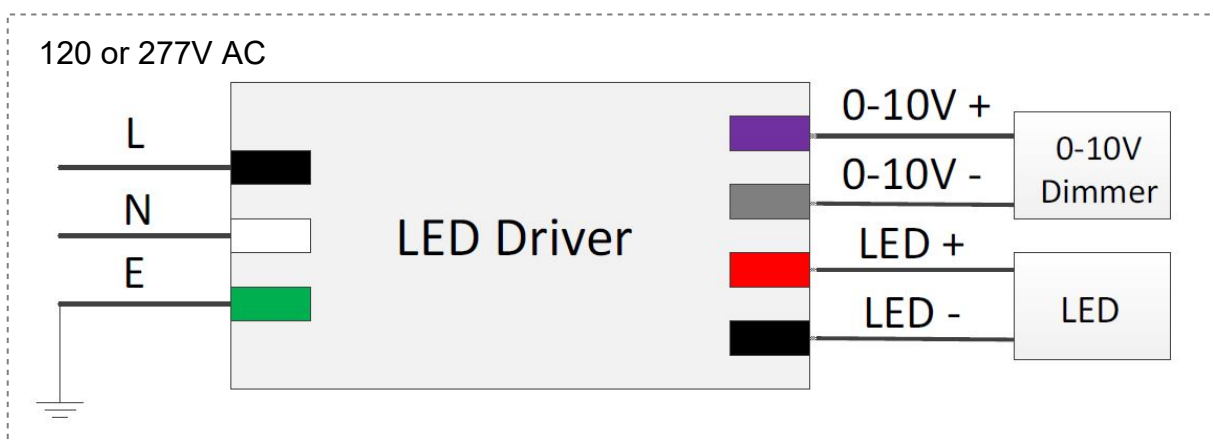
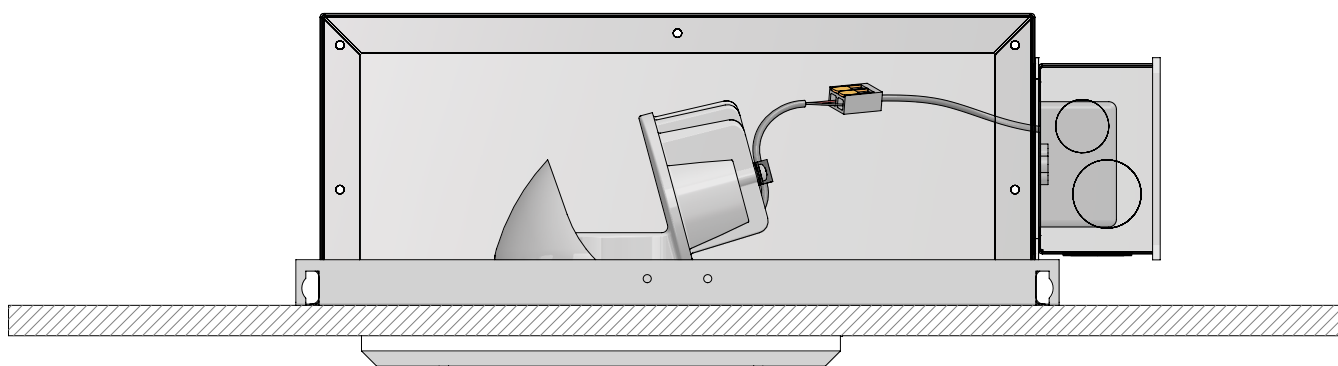
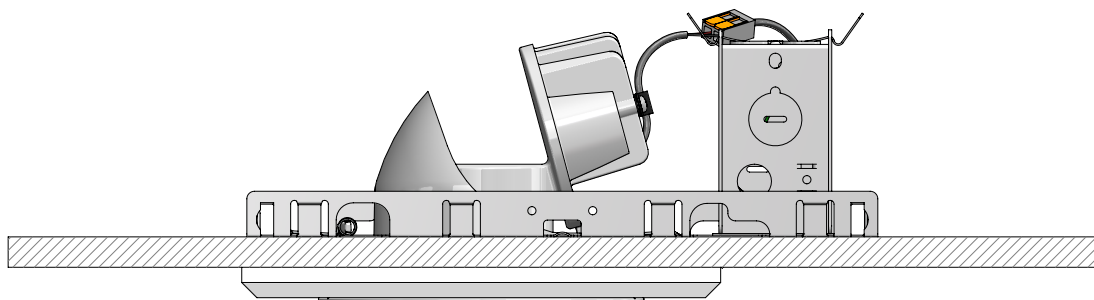

Maintenance

This fixture was designed and manufactured for a durable, long lasting use with minimum care. To ensure the maximum lifespan of this product, we encourage our customers to provide a quality visual inspection of the fixture and installation accessories every six months. If there are any visible signs of issues (i.e moisture or dust) during the inspection, please clean any of the dust or moisture with a soft cloth and check to make sure that any of the fixtures are still operating normally. If there are any issues regarding the fixture please contact us as we will assist the situation at hand.

Support

Any questions, problems, or comments you have please feel free to contact our Customer Service department during our business hours Monday-Friday 8am-5pm via: Email: usaorders@targetti.com
Phone: (714) 513-1991

Visit our website: <http://www.targettiusa.com>