

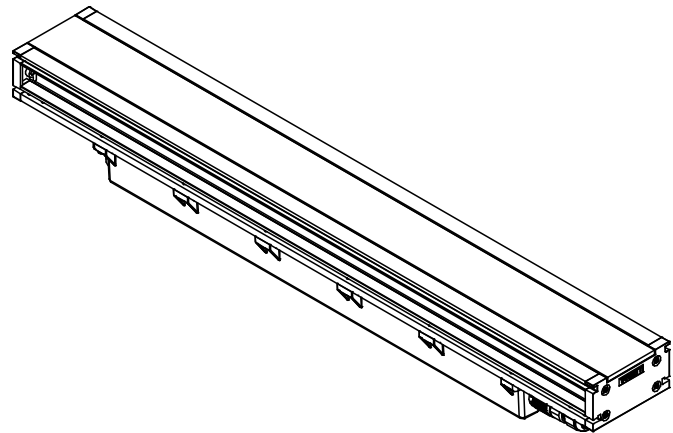

JEDI RECESSED

JER-(WW), (WG), (FL), (DV), (SP)

JEDI RECESSED - (WALL WASH), (WALL GRAZER), (FLOOD), (DIRECT VIEW), (SPOT)



120-277 VAC

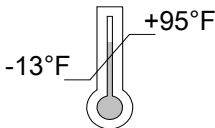

If in doubt about the symbols, please refer to catalog or website.

WARNING

To ensure a maximum efficient use of the product, read the instructions before proceeding with installation.



This fixture must be installed by a licensed and qualified electrician. The installer must comply with NEC and local building codes when installing the fixture.



Electrical current can cause painful shock, serious injury, or even death. Make sure you turn off the power supply, ground fixture(s), and make sure all electrical connections are correct and secured.



For use in IP68, and IP69K installations.



Keep the label of the original packaging if any eventual future claims are needed.

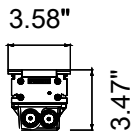
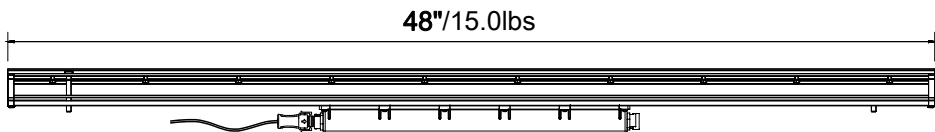
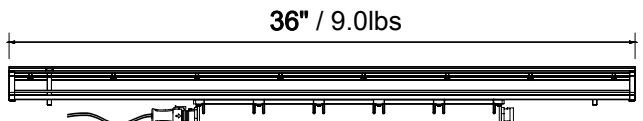
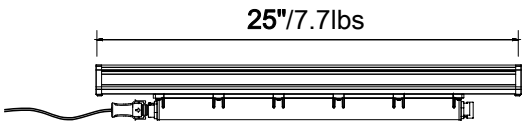

Table of Contents

Packaging Contents	Pg.2
JEDI Recessed Cabling Types	Pg.3
Required Sleeve Sold Separately	Pg.4
Optional Lead and Jumper Cable Sets	Pg.5
Stainless Steel Sleeve Installation	Pg.6-11
Aluminum Sleeve Installation	Pg.12-18
Electrical Rough in	Pg.19
Maintenance / Support	Pg.20

Packaging Contents

24" Fixture in 26"x6"x5" Box @7.7lbs

36" Fixture in 38"x6"x5" Box @9.0lbs

48" Fixture in 50"x6"x5" Box @15.0lbs

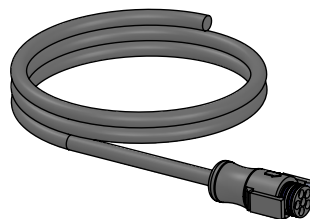
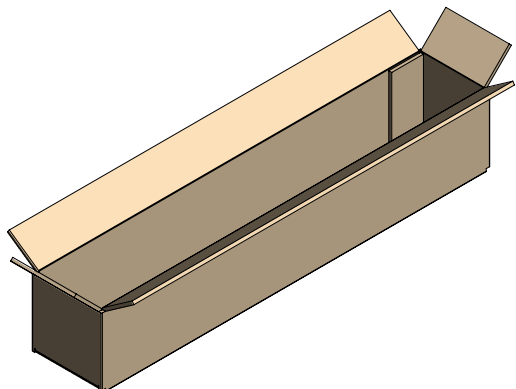

**LEAD AND SOLO FIXTURE INCLUDE 1ea.
10ft POWER / DIMMING CABLE**

Conductor Callout

IP68 DSM&T anti-wicking quick disconnect

Black = line voltage

White = neutral

Green = ground

Red = Do Not Use

Purple = positive 0-10V

Pink = negative 0-10V

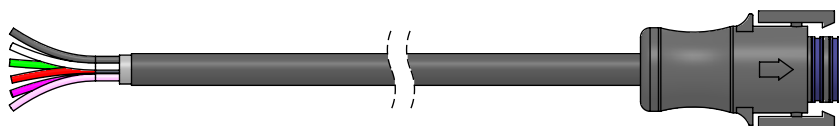

**LEAD / SOLO FIXTURE WITH
INPUT / OUTPUT CONNECTOR AND
10ft POWER / DIMMING CABLE**

**CENTER / END FIXTURE WITH
INPUT / OUTPUT CONNECTOR**

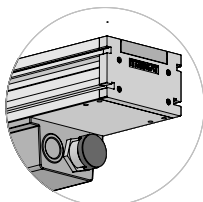
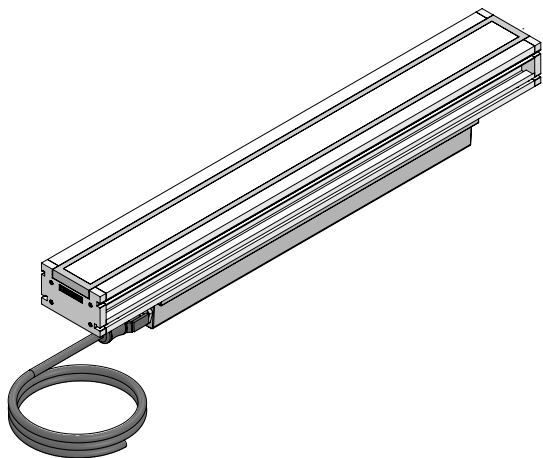

**END CAP
INCLUDED**

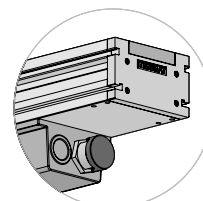
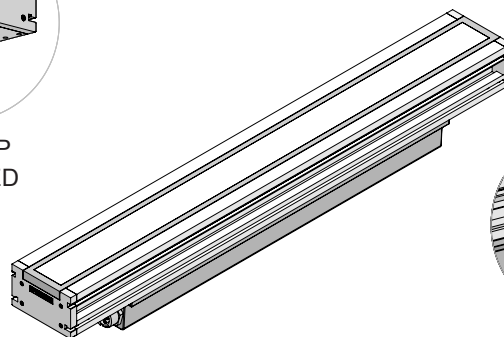

**END CAP
INCLUDED**

10ft LEAD CABLE

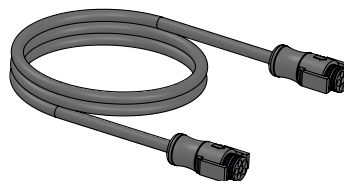

**CENTER / END FIXTURE
INCLUDE 32" JUMPER**

JEDI Recessed Cabling Types

Fixture code: L Lead Fixture Cabling

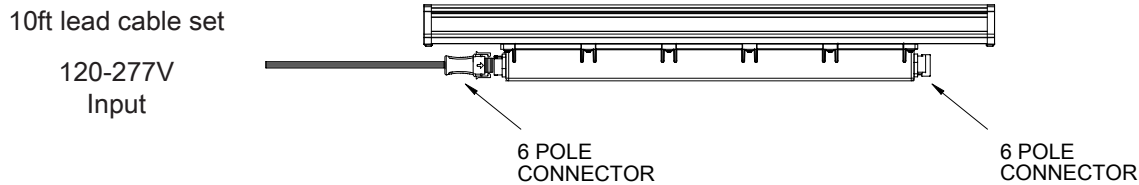

Lead - 10ft 50 MIL PRESSURED TPE JACKET 16-6 cable with DSM&T connector included.

Fixture code: C Center Fixture Cabling

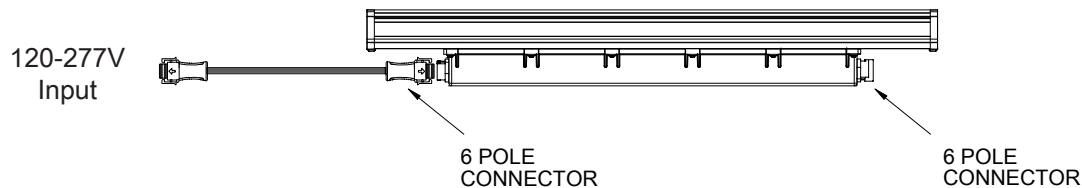

Center- 32" 50 MIL PRESSURED TPE JACKET 16-6 cable with DSM&T connectors.

Fixture code: E End Fixture Cabling

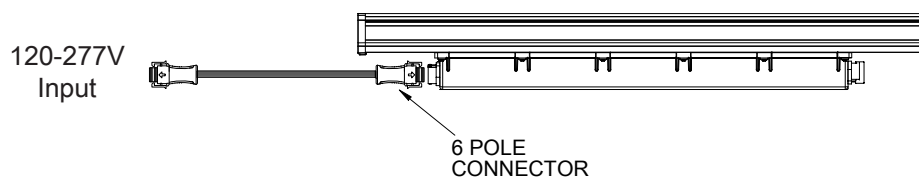

End - 32" 50 MIL PRESSURED TPE JACKET 16-6 cable with DSM&T connectors and additional DSM&T cap for dead end.

Fixture code: S Solo Fixture Cabling

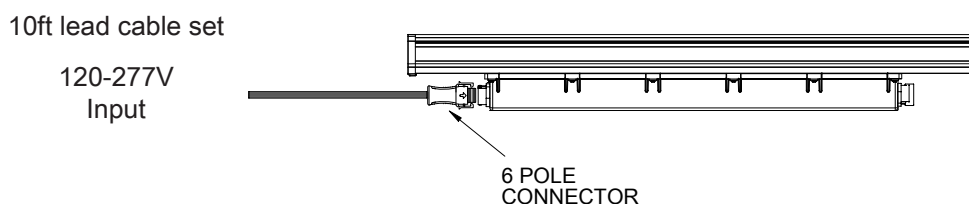

Solo - 10ft 50 MIL PRESSURED TPE JACKET 16-6 cable with DSM&T connector and additional DSM&T cap for dead end.

Required Sleeve Sold Separately

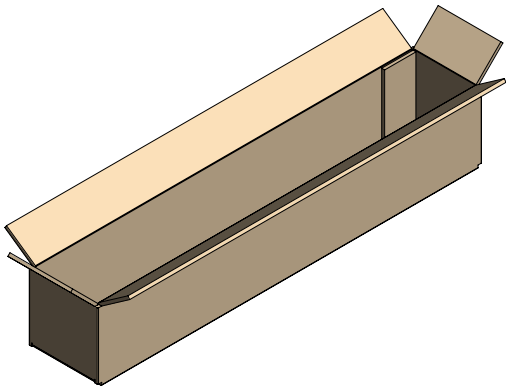

STAINLESS STEEL JEDI SLEEVE

1US2749 Fixture in 26"x6"x5" Box @4.0 lbs
1US2750 Fixture in 38"x6"x5" Box @5.5 lbs
1US2751 Fixture in 50"x6"x5" Box @7.0 lbs

ALUMINUM JEDI SLEEVE

1E3508 Fixture in 38"x6"x5" Box @4.5 lbs
1E3509 Fixture in 50"x6"x5" Box @6.0 lbs

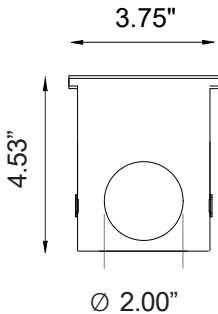
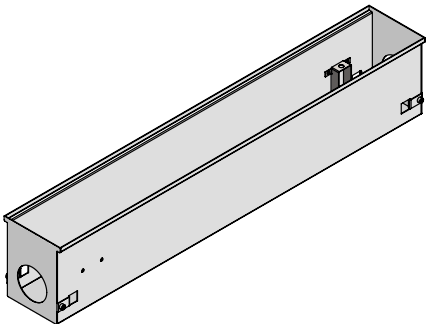

Front View: Fixture with sleeve dimensions

Stainless steel installation sleeve, supplied with 2ea end caps with a 1.5” knock out. **Best used for harsh environments and for solo fixture installations that require more cable slack cable space underneath the fixture. Can also be used for interconnected fixtures or with paver installations.**

Length	24"	36"	48"
Part No.	1US2749	1US2750	1US2751

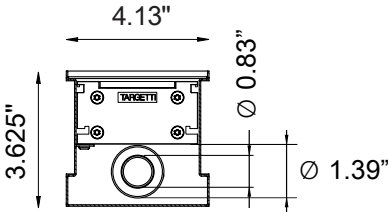
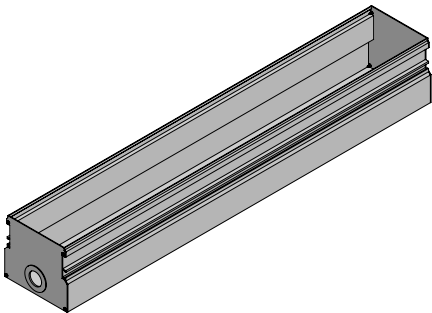

Front View: Fixture with sleeve dimensions

JEDI extruded aluminum low profile installation sleeve. Supplied with 2ea end caps with 3/4” knock out. **Best used for shallow depth interconnected fixture runs, best results obtained with staggered seam layout to ensure straight lines.**

Length	24"	36"	48"
Part No.	Not Compatible	1E3508	1E3509

Optional Lead and Jumper Cable Sets

LONGER LEAD CONNECTION CABLE (OPTIONAL))



JEDI longer lead includes 50 MIL PRESSURED TPE JACKET 16-6 cable with DSM&T quick disconnect.

<i>Length</i>	25ft
---------------	------

<i>Part No.</i>	JEDILEAD-25
-----------------	--------------------

ADDITIONAL JUMPER CONNECTION CABLE (OPTIONAL)



JEDI longer lead includes 50 MIL PRESSURED TPE JACKET 16-6 cable with DSM&T quick disconnect.

<i>Length</i>	10ft	25ft
---------------	------	------

<i>Part No.</i>	JEDIJUMP-10	JEDIJUMP-25
-----------------	--------------------	--------------------

Stainless Steel Sleeve Installation

24" / 36" / 48"

Slots in sleeve for draining

TOP VIEW



SIDE VIEW

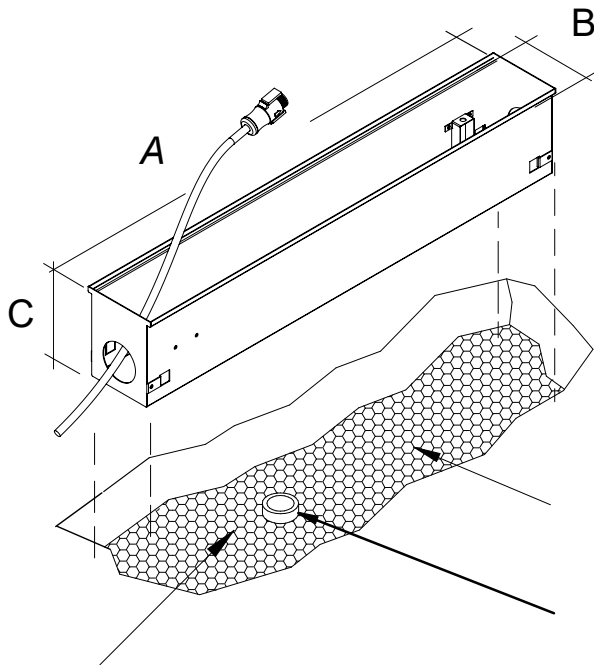

Gravel should be used as drainage material based on local NEC codes for in grade application

or

A Drainage Pipe option if application is not in grade

SLEEVE DIMENSIONS

CODE SS	A in	B in	C in
1US2749	24"	3.66"	4.52"
1US2750	36"	3.66"	4.52"
1US2751	48"	3.66"	4.52"

- In order to check the efficiency of the drainage, the quantity of water equivalent to the volume of the sleeve must completely drain in 45 minutes

- Drainage testing should be performed prior to installation of the sleeve

TEST DRAINAGE

WARNING

Failure to provide adequate draining installation will void warranty

*Install insertion sleeve on the desired area where light fixture will be illuminating. Make sure the sleeve is mounted on a compressed base and leveled. Metal cover plates must be placed into position before pouring concrete.

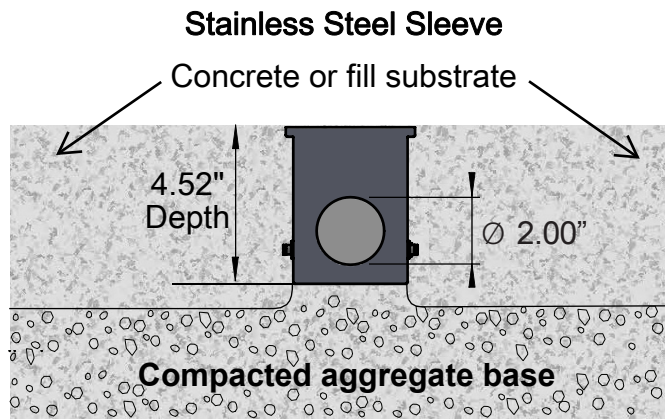

Important:

Make sure Sleeve is level by adjusting mounting surface.

A sloped surface will affect the light distribution of a fixture. Ground level is optimal for a tilt setting for your application.

Stainless Steel Sleeve Installation

Solo Fixture Installation

24" / 36" / 48"

End caps to be installed 1 on each side of sleeve.

Insert 2 screws on each side of sleeve to secure the end caps on to position and tighten screws as shown on image.

TARGETTI SUPPLIED CONNECTIONS INSIDE OF SLEEVE SPACE.

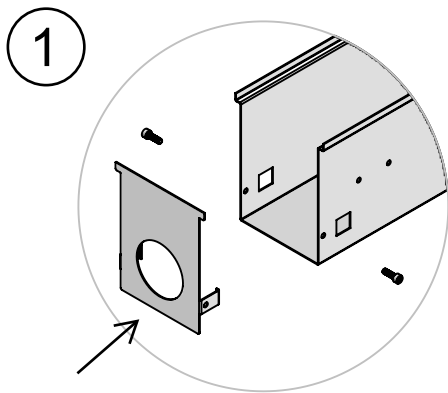
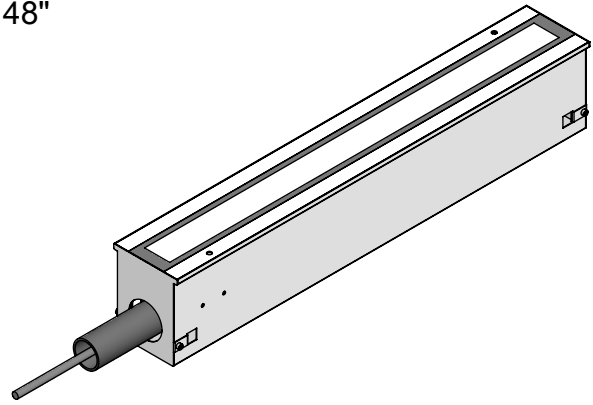

End cap

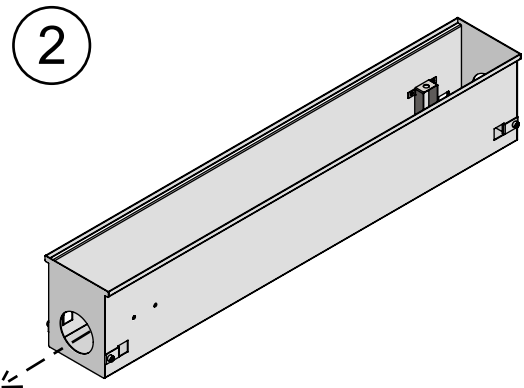

Insert lead cable through

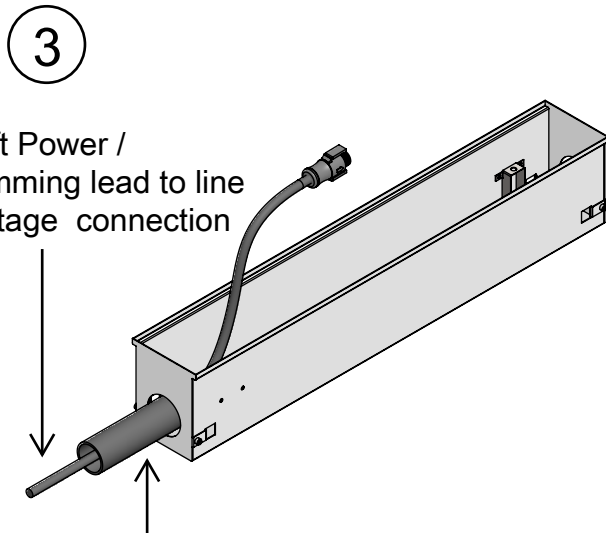

1 1/2" Conduit or
Pipe to connection

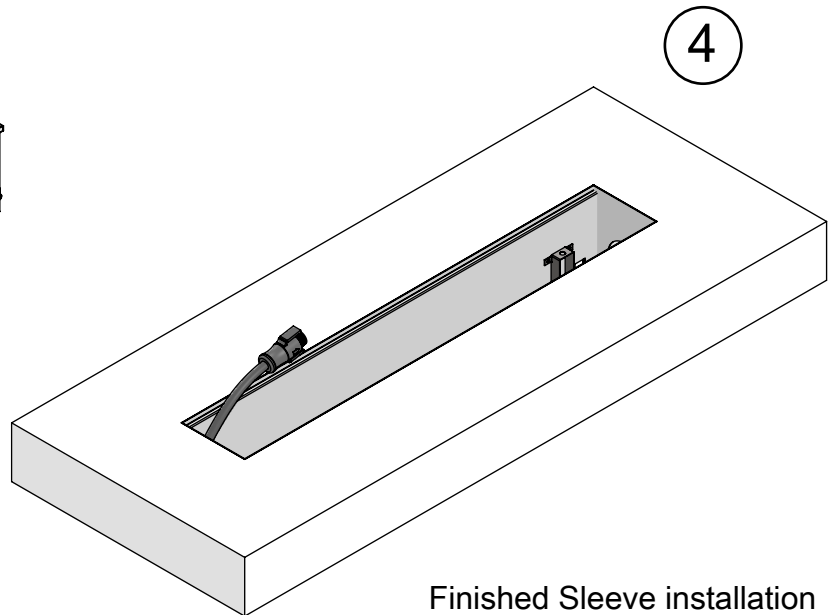

Finished Sleeve installation

Stainless Steel Sleeve Installation

Solo Fixture

24" / 36" / 48"

- Fixture Lead cable is connected to nearest J-Box location for line voltage and dimming connections. IP68 connector is secured to fixture by clicking the two locks on DMS&T connector sides to ensure a sealed connection.
- Once connected, insert the fixture into the fixture's sleeve and tightened both anti-tamper screws until fixture locks inside the sleeve

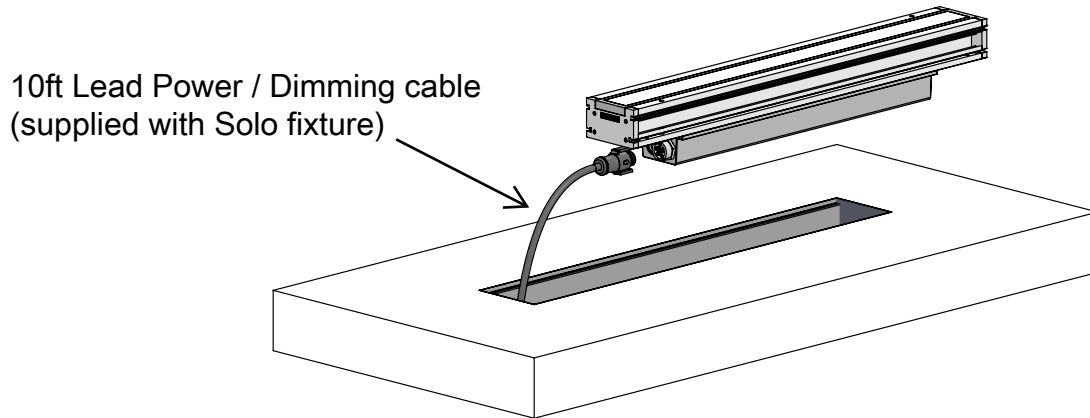

Important note:

Jedi Wall Wash fixtures have a symmetric light output. Be sure to align the fixtures in the correct emission direction. Each fixture is labeled to show direction on illuminating.

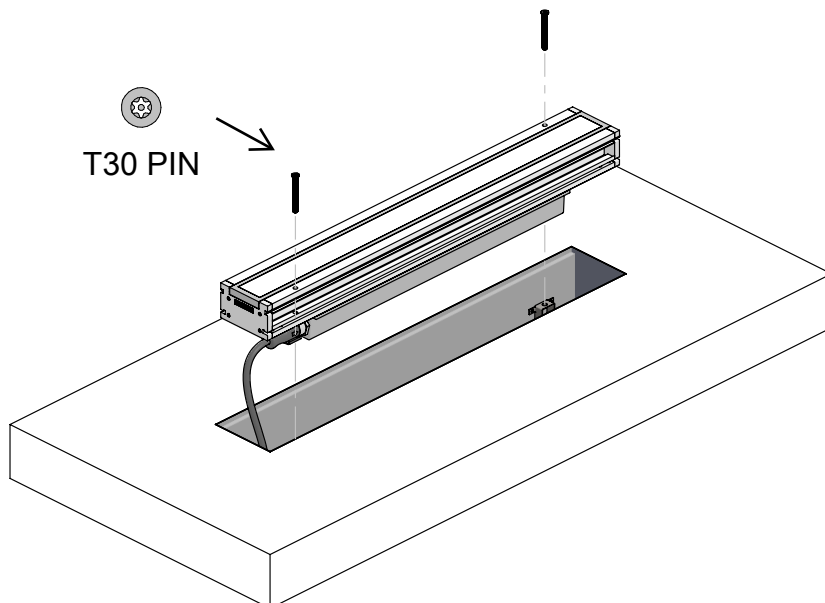

Stainless Steel Sleeve Installation

Interconnected Fixture Installation

Mix of 24" / 36" / 48"

End caps to be installed 1 on the end side of lead sleeve, and one on the end side of end sleeve.

Insert 2 screws on each end cap for lead and end sleeves, to secure end caps on to position and tighten the screws as shown on image.

Insert 2 screws on each side of sleeve to secure the sleeve joiner clips on to position and tighten screws as shown on image.

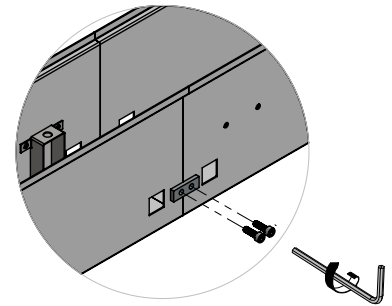
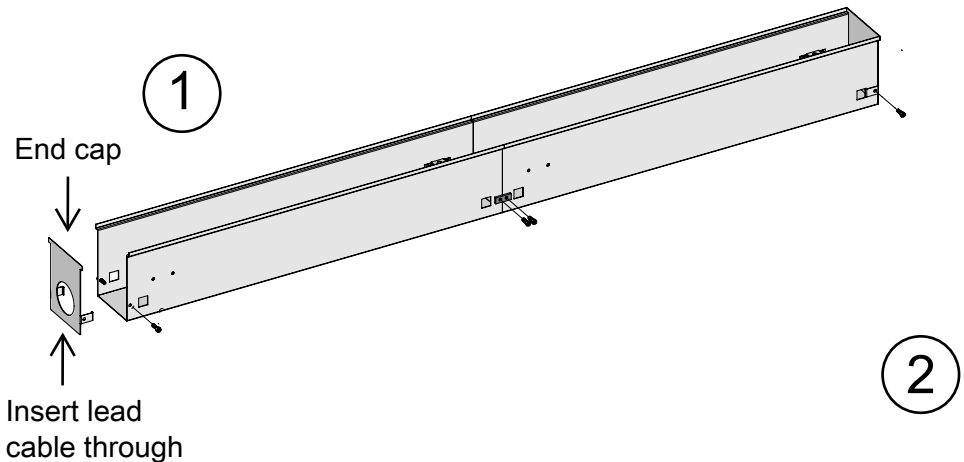
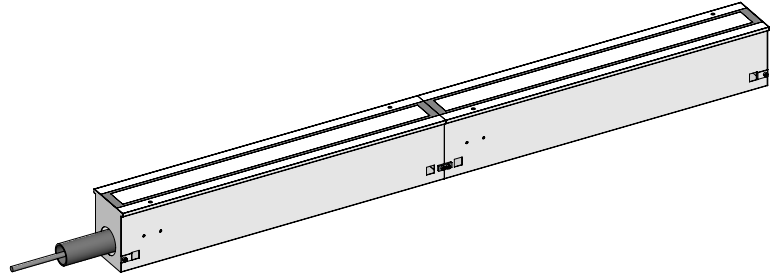

Sleeve joiner clip for
Inline fixture installation

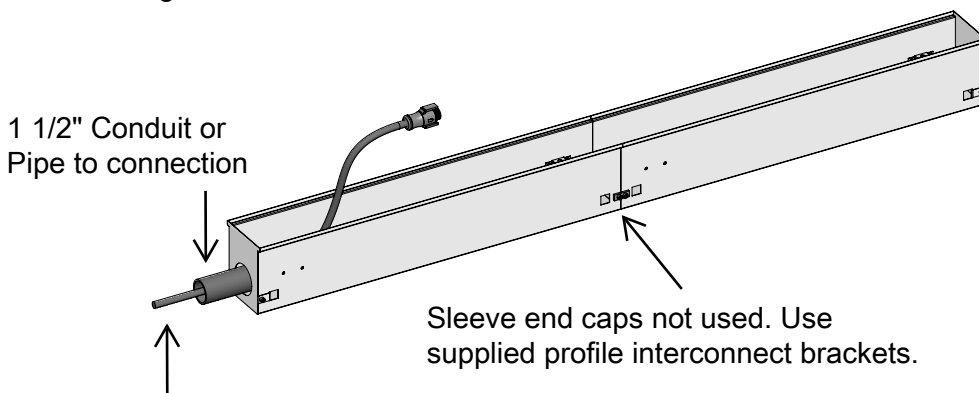

10ft Power /
Dimming lead to line
voltage connection

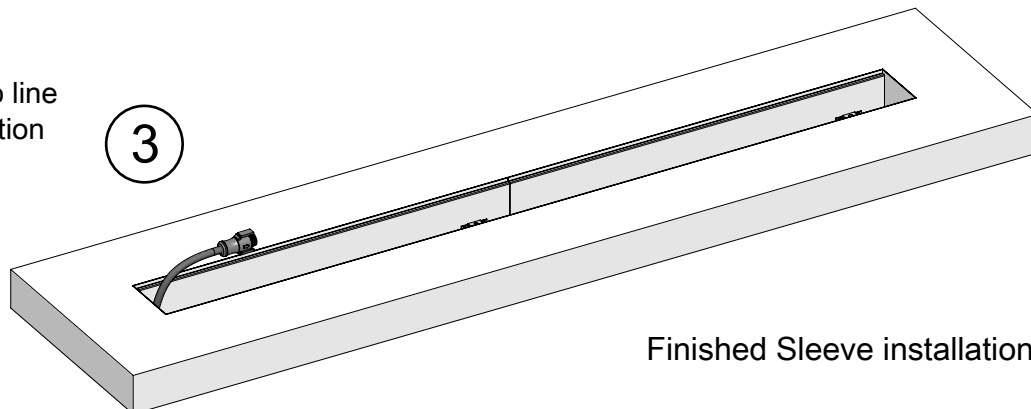

Finished Sleeve installation

Stainless Steel Sleeve Installation

Interconnected Fixture Installation

Mix of 24" / 36" / 48"

- Fixture Lead cable is connected to nearest J-Box location for line voltage and dimming connections. IP68 connector is secured to fixture by clicking the two locks on DMS&T connector sides to ensure a sealed connection.
- For multiple fixtures: be sure to arrange the fixtures in the correct order before connecting. 32" Jumper cables are supplied and used to connect multiple fixtures between each other in a linear connection.
- Maximum power consumption of multiple fixtures on one line is 1500W*.
- Once connected, insert the fixture into the fixture's sleeve and tighten both anti-tamper screws until fixture locks inside the sleeve

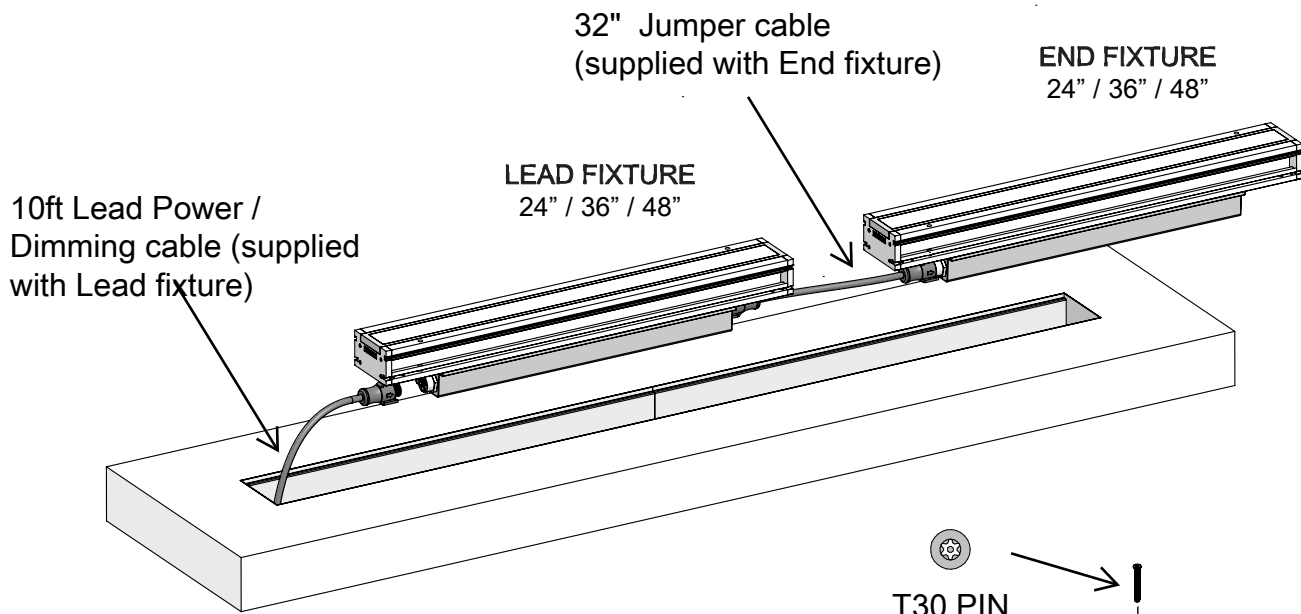

Important note:

Jedi Wall Wash fixtures have an symmetric light output. Be sure to align the fixtures in the correct emission direction. Each fixture is labeled to show direction on illuminating.

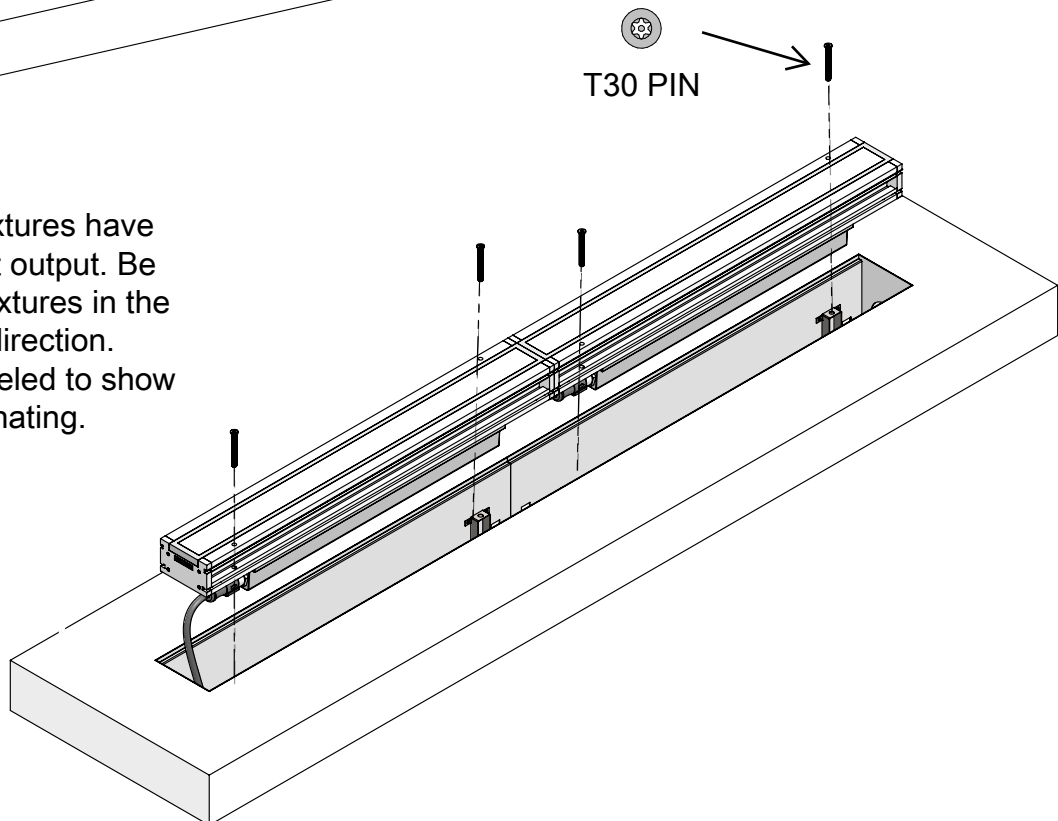

Stainless Steel Sleeve Installation

Separated Connected Fixtures

Mix of 24" / 36" / 48"

End caps to be installed 1 on each side of sleeve. Insert 2 screws on each side of sleeve to secure the end caps on to position and tighten screws as shown on image.

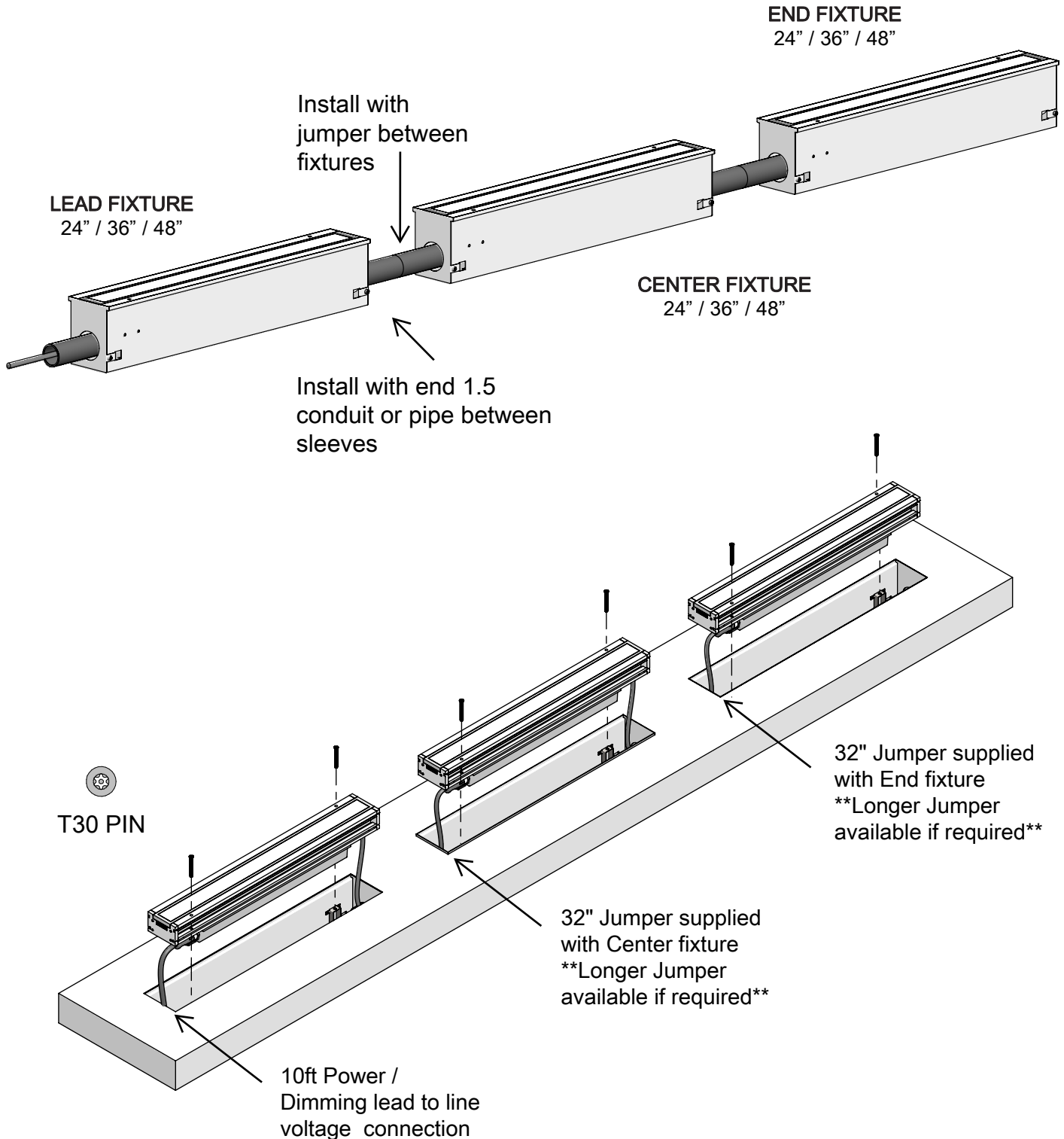

Aluminum Sleeve Installation

36" / 48"

TOP VIEW



SIDE VIEW

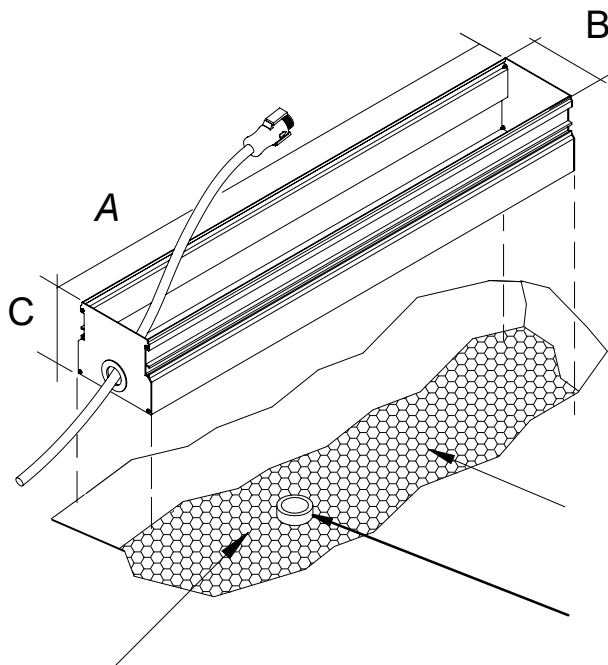

CODE ALUM	A in	B in	C in
1E3508	36"	4.13"	3.63"
1E3509	48"	4.13"	3.63"

Gravel should be used as drainage material based on local NEC codes for in grade application

or

A Drainage Pipe option if application is not in grade

- In order to check the efficiency of the drainage, the quantity of water equivalent to the volume of the sleeve must completely drain in 45 minutes

- Drainage testing should be performed prior to installation of the sleeve

TEST DRAINAGE

WARNING

Failure to provide adequate draining installation will void warranty

*Install insertion sleeve on the desired area where light fixture will be illuminating. Make sure the sleeve is mounted on a compressed base and leveled. Metal plates must be placed on to position before pouring concrete.

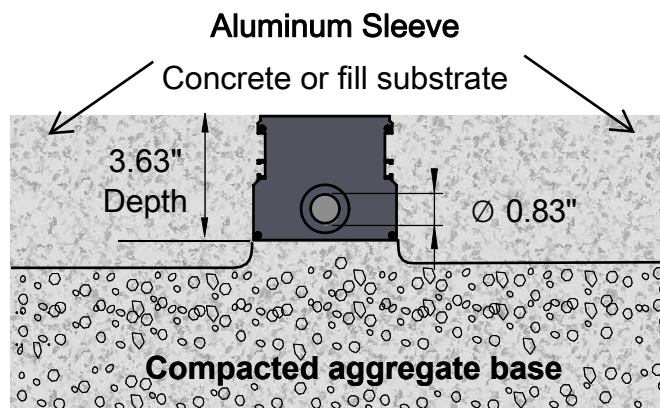

Place Sleeve in correct location.

Make sure Sleeve is level by adjusting mounting surface.

Note: A sloped surface will affect the light distribution of a fixture. Ground level is optimal for a tilt setting for your application.

Aluminum Sleeve Installation

Solo Fixture Installation

36" / 48"

End caps to be installed 1 on each side of sleeve.
Insert 4 screws on each side of sleeve to secure the end caps on to position and tighten screws as shown on image.

TARGETTI SUPPLIED CONNECTIONS
INSIDE OF SLEEVE SPACE.

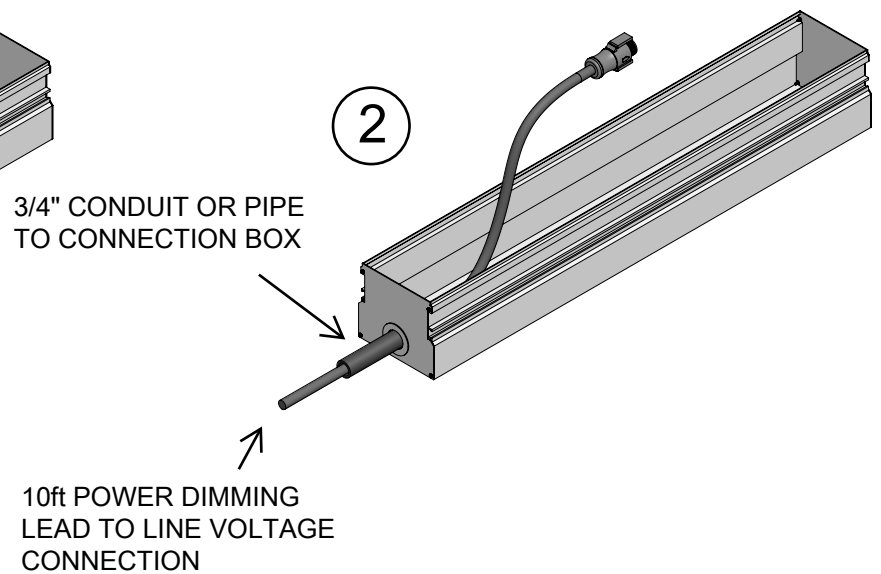
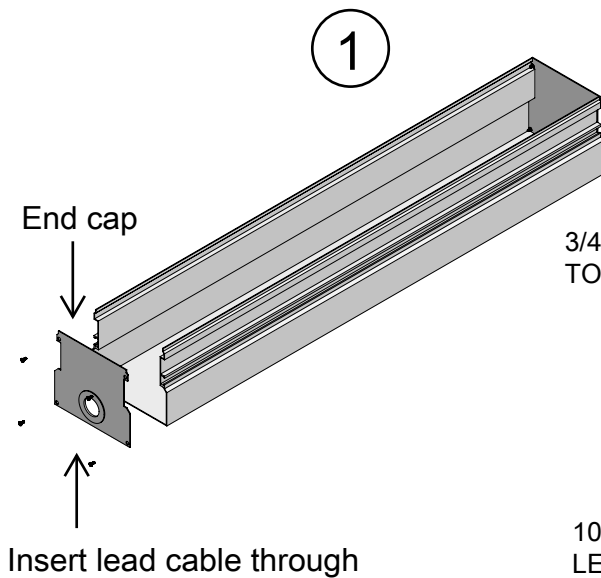
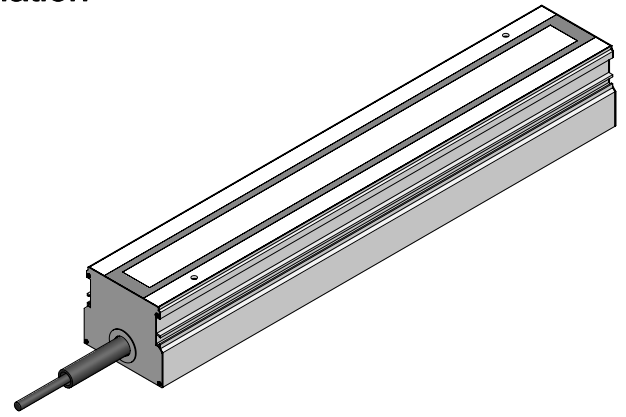

Place sleeve in correct location

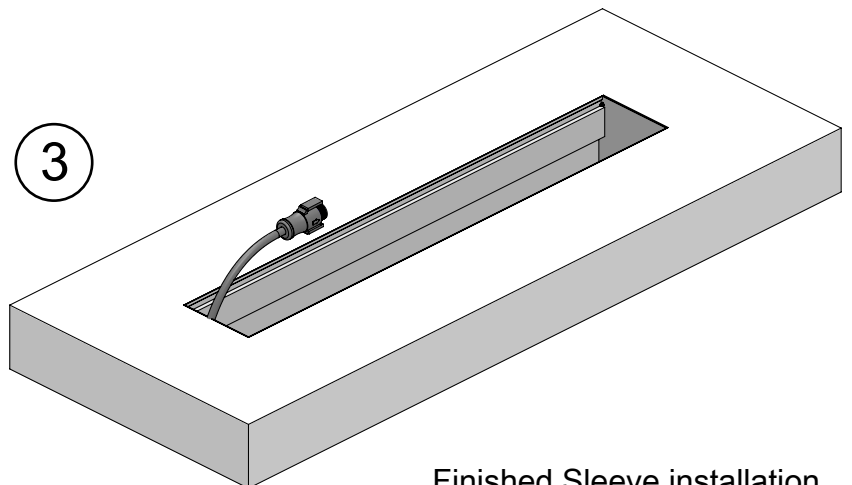

Finished Sleeve installation

Aluminum Sleeve Installation

Solo Fixture

36" / 48"

- Fixture Lead cable is connected to nearest J-Box location for line voltage and dimming connections. IP68 connector is secured to fixture by clicking the two locks on DMS&T connector sides to ensure a sealed connection.
- Once connected, insert the fixture into the fixture's sleeve and tightened both anti-tamper screws until fixture locks inside the sleeve

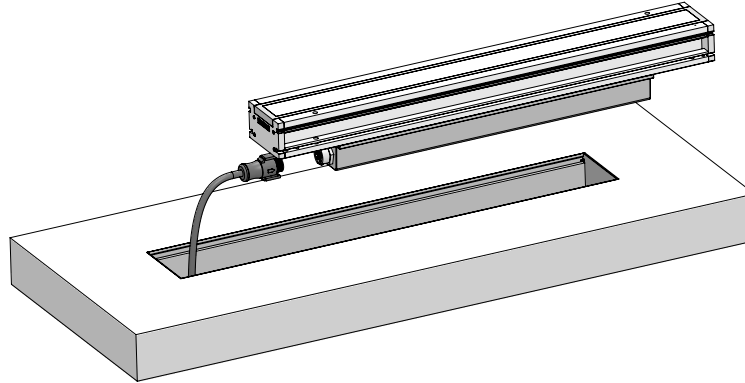

Important note:

Jedi Wall Wash fixtures have a symmetric light output. Be sure to align the fixtures in the correct emission direction. Each fixture is labeled to show direction on illuminating.

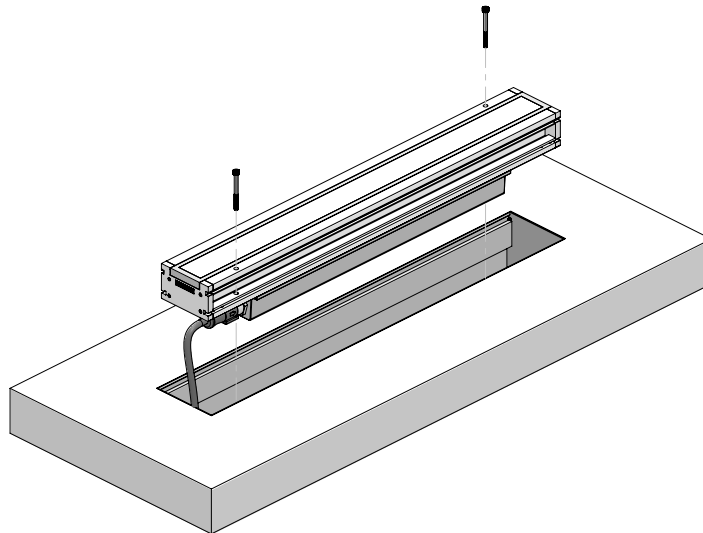

Aluminum Sleeve Installation

Interconnected Fixture Installation

Mix of 36" / 48"

End caps to be installed 1 on the end side of lead sleeve, and one on the end side of end sleeve. Insert 4 screws on each end cap for lead and end sleeves, to secure end caps on to position and tighten the screws as shown on image.

Insert 2 screws on each side of sleeve to secure the sleeve joiner clips on to position and tighten screws as shown on image.

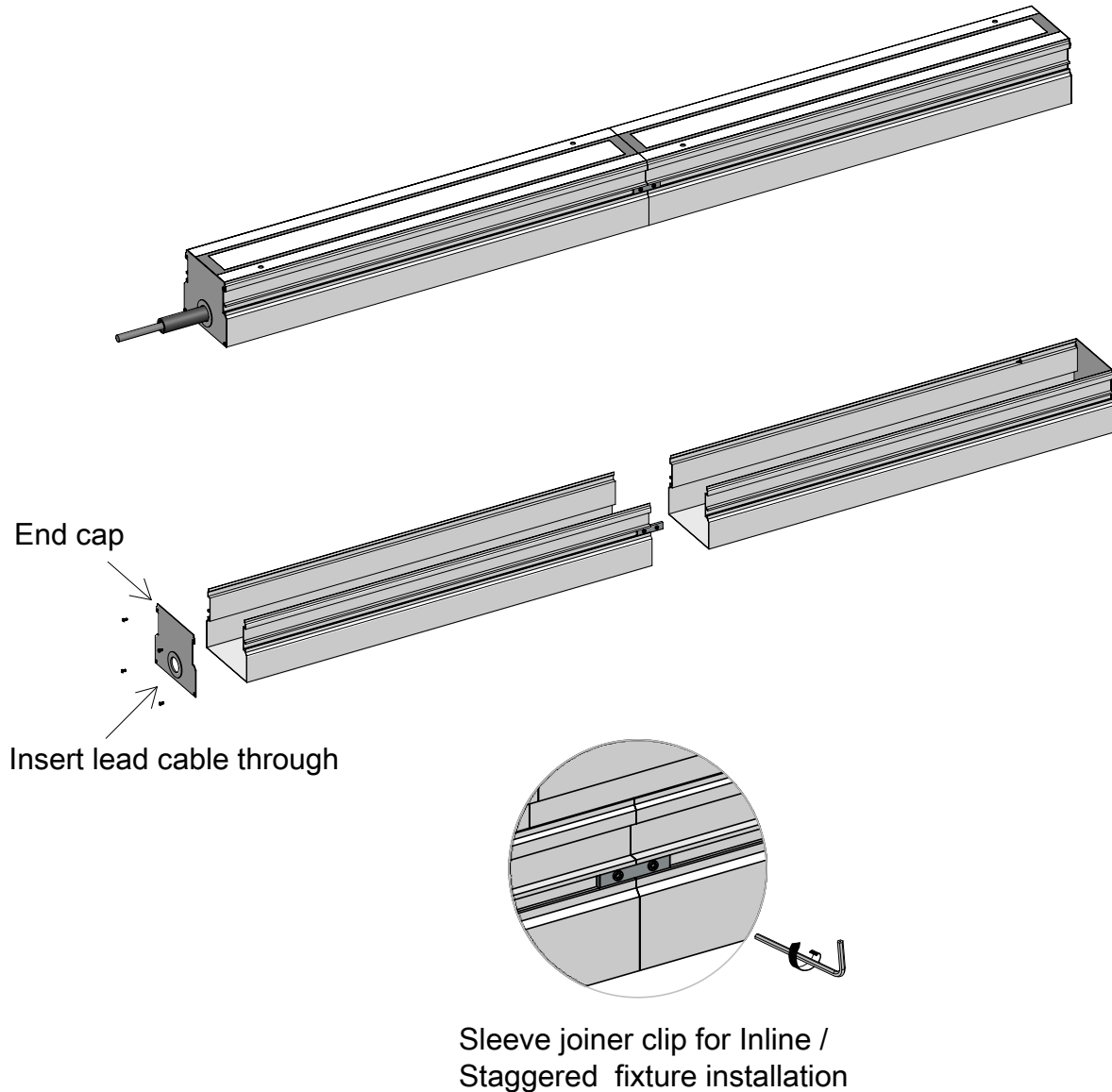

Aluminum Sleeve Installation

Interconnected Fixture Installation

Mix of 36" / 48"

- Fixture Lead cable is connected to nearest J-Box location for line voltage and dimming connections. IP68 connector is secured to fixture by clicking the two locks on DMS&T connector sides to ensure a sealed connection.
- For multiple fixtures: be sure to arrange the fixtures in the correct order before connecting. 32" Jumper cables are supplied and used to connect multiple fixtures between each other in a linear connection.
- Maximum power consumption of multiple fixtures on one line is 1500W*.
- Once connected, insert the fixture into the fixture's sleeve and tightened both anti-tamper screws until fixture locks inside the sleeve

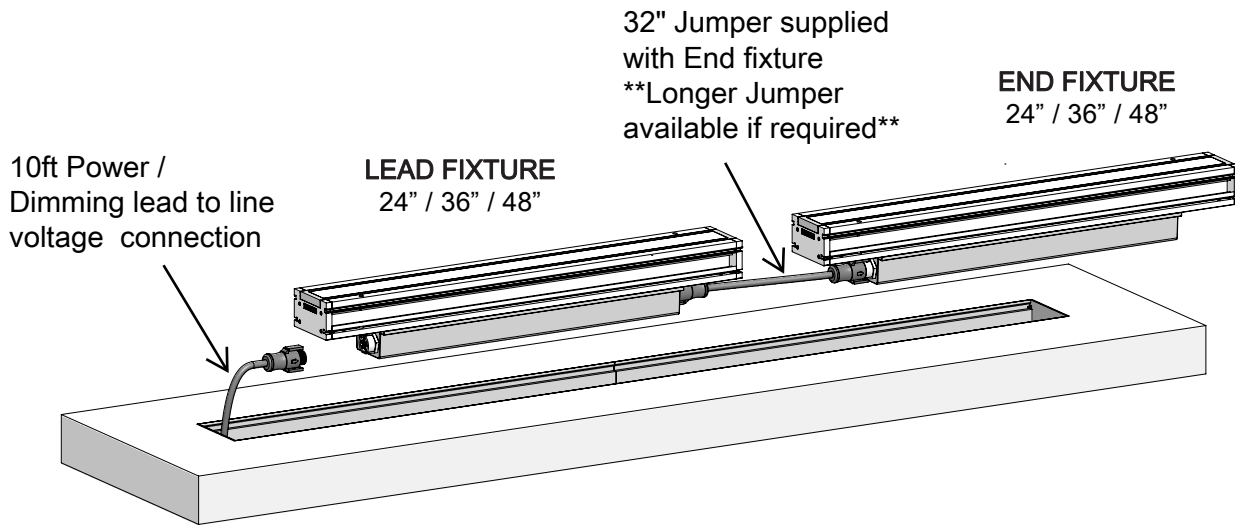

Important note:

Jedi Wall Wash fixtures have a symmetric light output. Be sure to align the fixtures in the correct emission direction. Each fixture is labeled to show direction on illuminating.

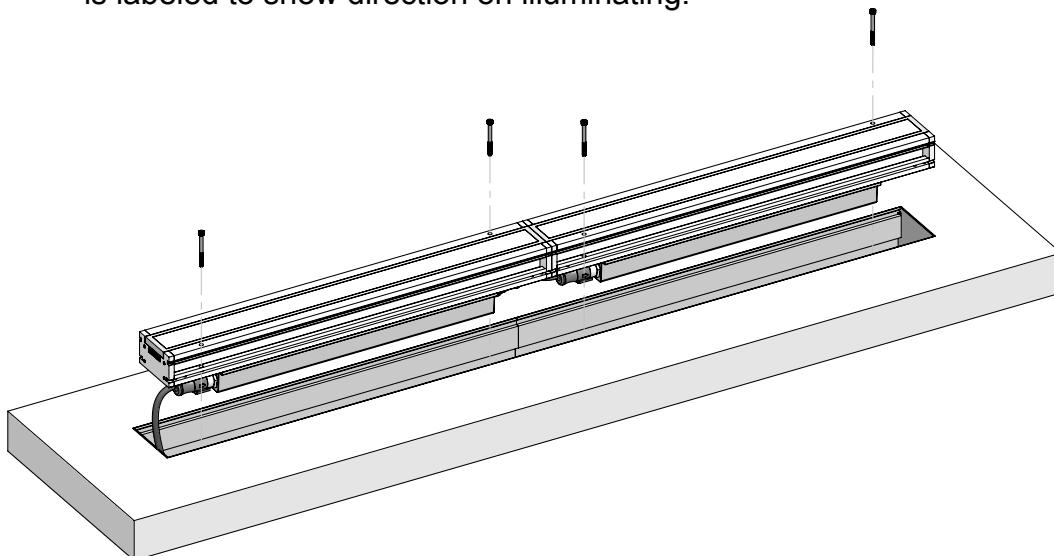

SLEEVE END CAPS NOT USED. USE SUPPLIED PROFILE INTERCONNECT BRACKETS ALUM SLEEVES
NOT FOR USE FOR SEPERATED CONNECTED FIXTURE RUN INSTALLATION

Aluminum Sleeve Installation

Staggered Sleeve Seams Installation

Mix of 24" / 36" / 48"

Using Sleeve in a Staggered Seam installation will promote a straighter fixture installation and visually separate the fixture and sleeve seams to make them less obvious.

9ft Fixture Run

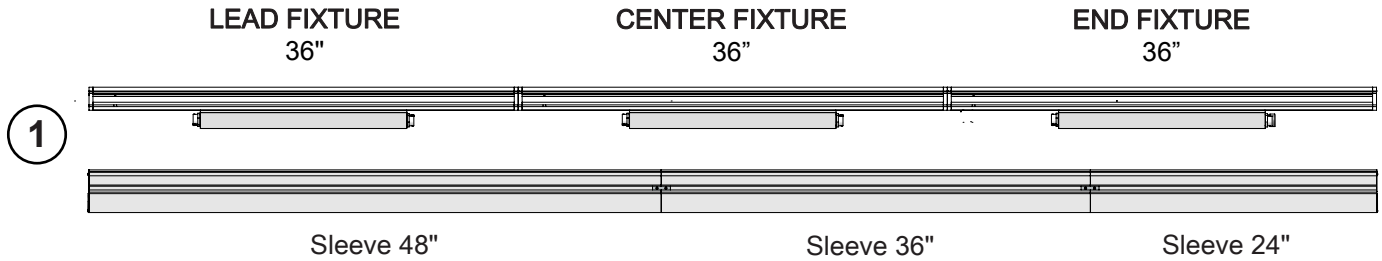

10ft Fixture Run

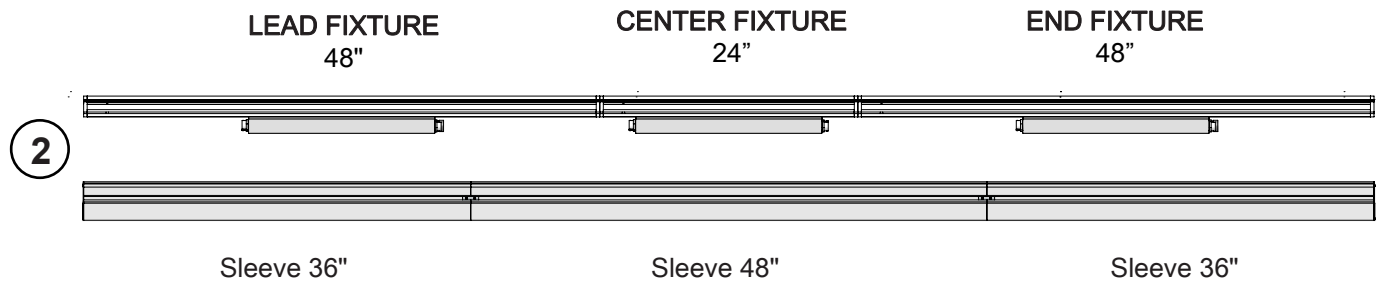

11ft Fixture Run

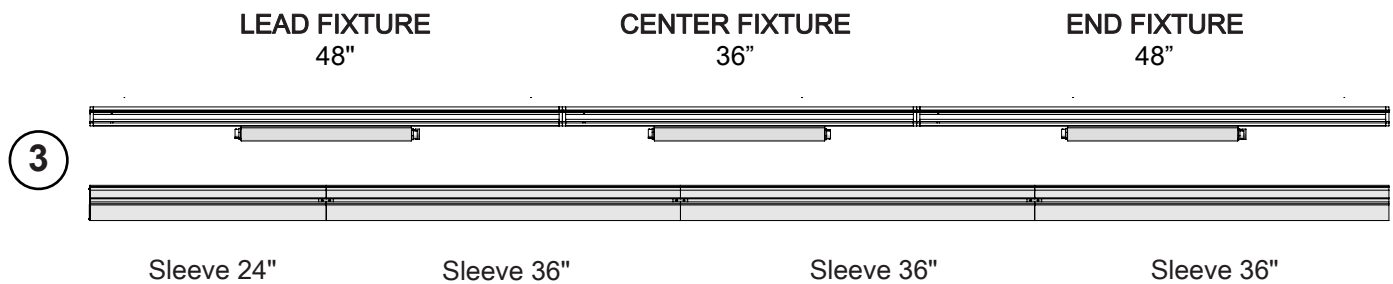

Aluminum Sleeve Installation

Staggered Sleeve Seams Installation

Mix of 24" / 36" / 48"

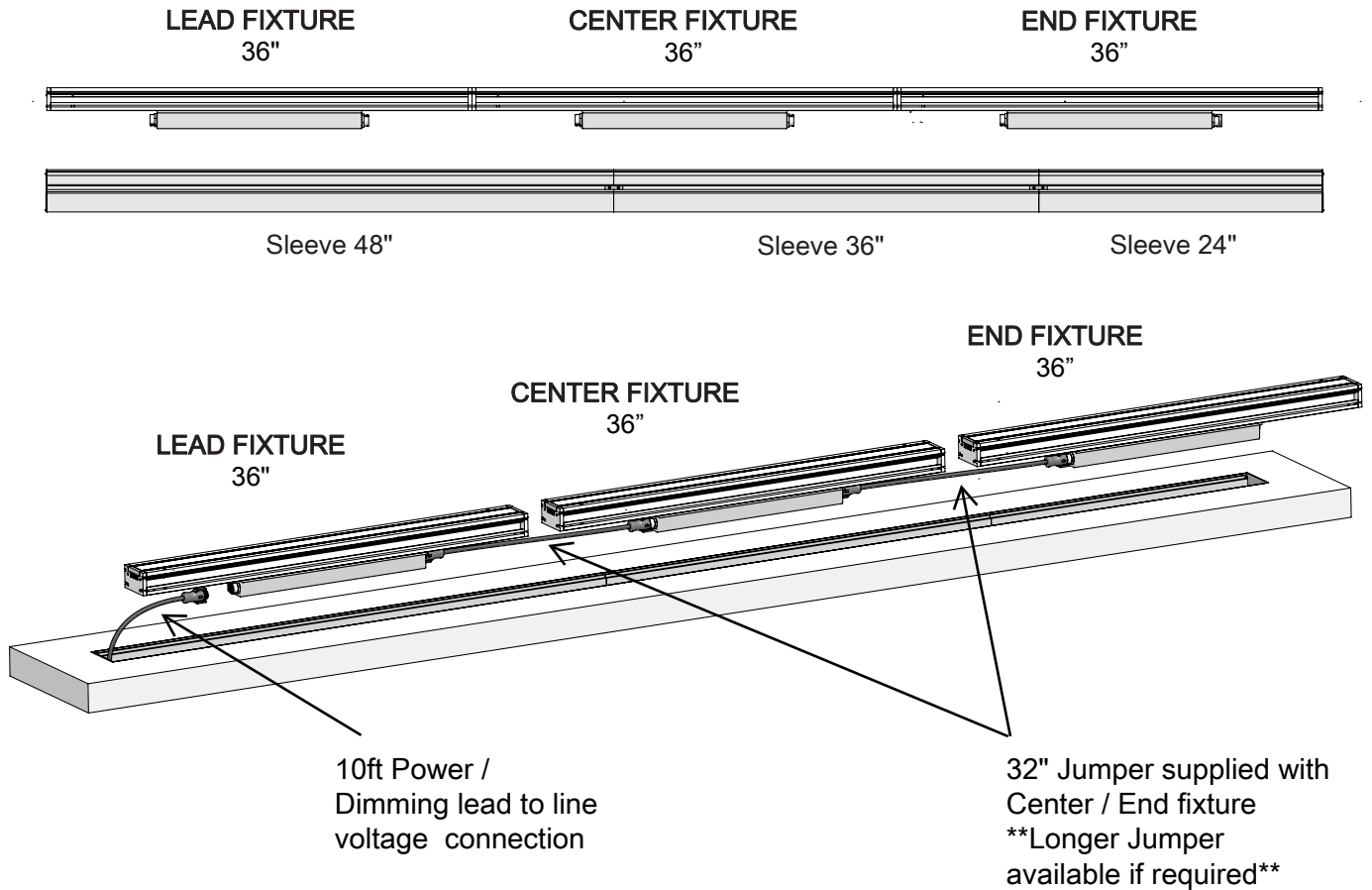

Important note:

Jedi Wall Wash fixtures have an symmetric light output. Be sure to align the fixtures in the correct emission direction. Each fixture is labeled to show direction on illuminating.

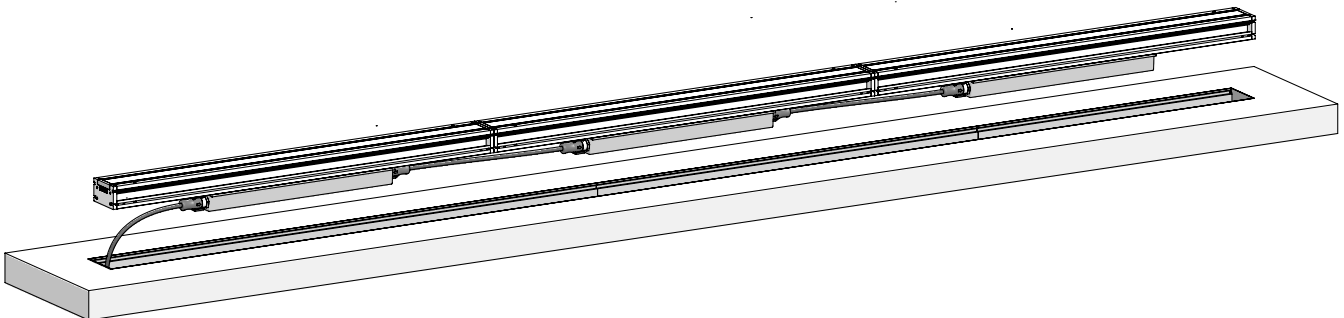

SLEEVE END CAPS NOT USED. USE SUPPLIED PROFILE INTERCONNECT BRACKETS ALUM
SLEEVES NOT FOR USE FOR SEPERATED CONNECTED FIXTURE RUN INSTALLATION

Electrical Roughin

- For each individual run we recommend that the electrical J-Box is positioned within 10ft. away from lead fixture for use with standard 10ft. leads. Each Lead and Solo fixtures are supplied with a 10ft. lead for 120-277V Input and a 10ft. lead for 0-10V Dimming.
- Lead lengths can be ordered longer at 25ft. or 50ft. if connection to main power requires.
- If the source is 120V, max of 14 each 4-foot fixtures (50 feet of fixture illumination) on a single home run allowed.
- If the source is 277V, max of 35 each 4-foot fixtures (140 feet of fixture illumination) on a single home run allowed.
- Please see chart below for detailed information on max run lengths per circuit.

Voltage Drop Table

Voltage drop calculations are based on 10% max drop to last fixture in run for load and distances below

Length in Fixtures	Load	Power
Up to 88ft.	1166W	120V
Up to 208ft.	2756W	277V

Max lengths include lengths of lead and jumper cables.

Example: 3 each 2ft. fixtures and 3 each 3ft. fixtures = 15ft. of fixture illumination.

Consider the following for every individual run:

28W for every 24" / 40W for every 36" / 53W for every 48"

Maintenance

This fixture was designed and manufactured for a durable, long lasting use with minimum care. To ensure the maximum lifespan of this product, we encourage our customer to provide a quality visual inspection of the fixture and installation accessories every six months. If there are any visible signs of issues (i.e moisture or dust) during the inspection, please clean any of the dust or moisture with a soft cloth and check to make sure that any of the fixtures are still operating normally. If there are any issues regarding the fixture please contact us as we will assist the situation at hand.

Support

Any questions, problems, or comments you have please feel free to contact our Customer Service department during our business hours Monday-Friday 8am-5pm via: Email: usaorders@targetti.com Phone: (714) 513-1991
Visit our website: <http://www.targettiusa.com>