

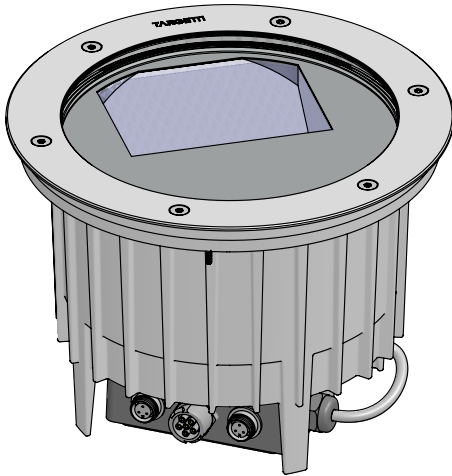

## KEPLERO WALL WASHER RGBW

KPLWWL1RGBWE2

PROFESSIONAL INGROUND LED FIXTURE



If in doubt about the symbols, please refer to catalog or website

120-277 VAC



IK10

-13°F

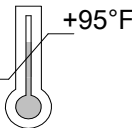

+95°F



**KEPLERO WW RGBW**  
**KPLWWL1RGBWE2**

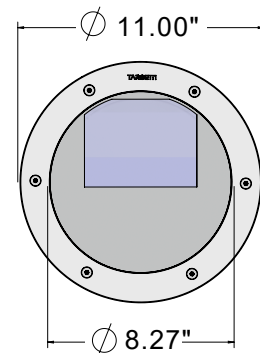
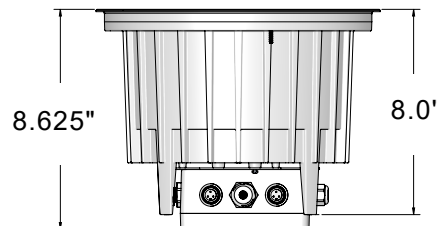

### WARNING

To ensure maximum efficiency of the product, read the following instructions thoroughly prior to installation.

**\*Please make sure the fixture is sealed correctly and the trim ring is properly tightened.**



This fixture must be installed by a licensed and qualified electrician. The installer must comply with NEC and local building codes when installing the fixture



Electrical current can cause painful shock, serious injury, or even death. Make sure you turn off the power supply, ground fixture(s), and make sure all electrical connections are correct and secured



This fixture must not be installed during rain, fog, or high humidity



For use in IP67 installations.



Keep the label of the original packaging if any eventual future claims are needed

### Table of Contents

Packaging Contents  
Required Options Sold Separately Choose  
Installation Instructions  
Finished Installation Example  
Service Options  
Maintenance / Support

Pg.2  
Pg.3-6  
Pg.7-17  
Pg.18-20  
Pg.21  
Pg.22

# Packaging Contents

## Keplero Wall Washer RGBW

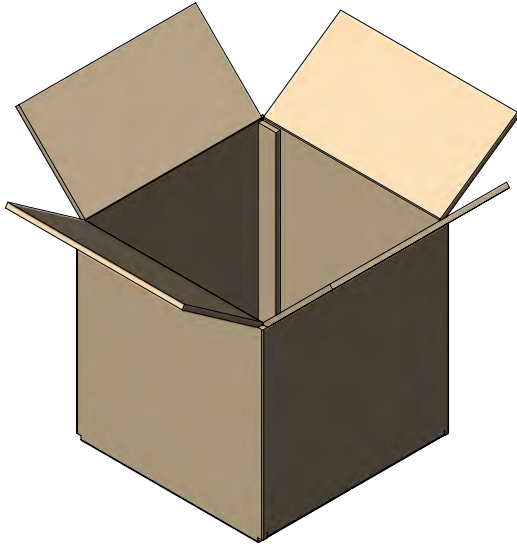

14"x 14"x 10" Box @11 lbs

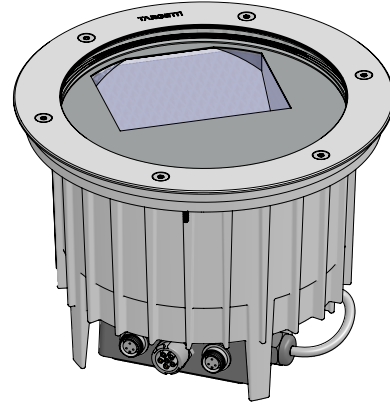

Led Fixture 1 ea.

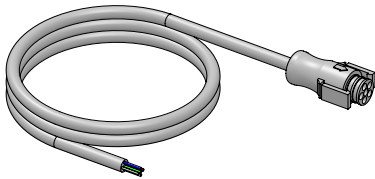

**Standard 4ft Power Lead 1ea.**  
Cable with Belden 16-6 600V cable and female DSMT anti-wicking quick disconnect 4ft lead cable.

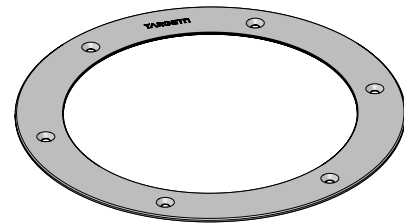

**Stainless Steel Trim Ring 1 ea.**  
**IK10 Glass and Gasket 1ea.**



Trim ring screws 6 ea.



Fastening Screws 3 ea.

Note: SS Trim finish and Glass type to be specified for order (see page 3)

# Required Options Sold Separately Choose

## ROUND TRIM RING

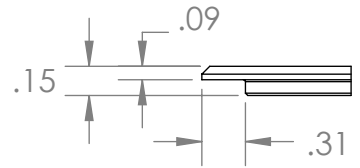
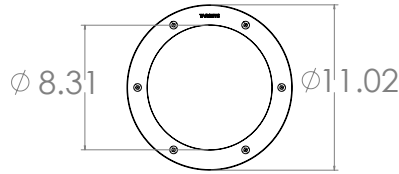
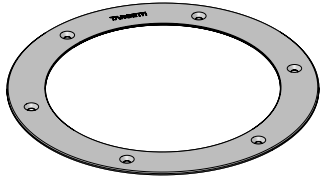

Round stainless steel (AISI316L) decorative ring . 10mm thick extra clear protective glass. Silicone gasket. Tamper proof (AISI316L) Torx screws.

Finish	● Brushed Natural	● Bronze PVD	● Black PVD
Part No.	1DU2325	1DU2325B	1DU2325K

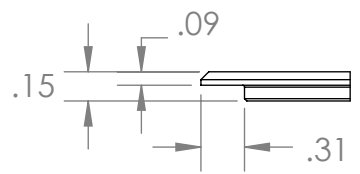
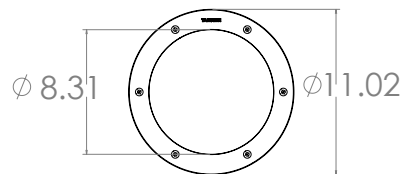
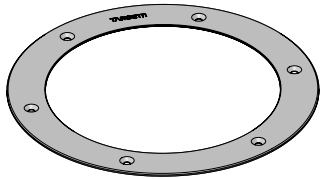

Round stainless steel (AISI316L) decorative ring with anti-slip glass. 10mm thick extra clear protective glass. Silicone gasket. Tamper proof (AISI316L) Torx screws.

Finish	● Brushed Natural	● Bronze PVD	● Black PVD
Part No.	1DU2325A	1DU2325BA	1DU2325KA

## Required Installation Sleeve Options Choose

Installation sleeve

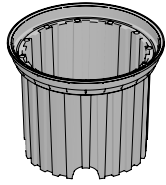

Aluminum J-Box extension sleeve

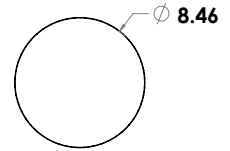
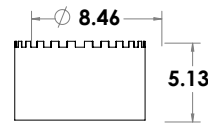
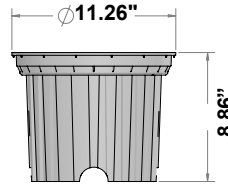
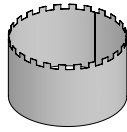

Installation sleeve for concrete pour applications. Grey Nylon 9" sleeve with 4.77" aluminum extension sleeve. Complete with dedicated cover cap for installations in concrete. Round ring for flush or semi-flush installations.

Part No. **1DU2394**

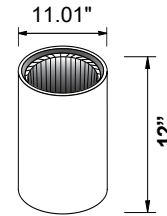

**At grade or raised installation sleeve** for turf or ground cover applications. 12"H stainless steel, includes factory pre-installed inner PVC installation sleeve. **Not suitable for use with 1DU2394.** (Field cuttable. Used for fixture elevations at grade to 3" above grade). **Required for use with 1DU2530 by NEC.**

Finish ● Deep Black

Part No. **1DU434312**

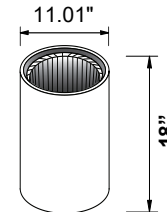

**Raised installation sleeve** for ground cover (succulents and low level planting) applications. 18"H stainless steel, includes factory pre-installed inner PVC sleeve. **Not suitable with 1DU2394.** (Field cuttable. Used for fixture elevation 7" above grade). **Required for use with 1DU2530 by NEC.**

Finish ● Deep Black

Part No. **1DU434318**

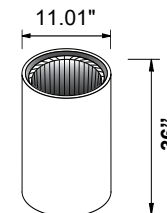

**Raised installation sleeve** for landscape applications. 36"H stainless steel, includes factory pre-installed inner PVC sleeve. **Not suitable with 1DU2394.** (Field cuttable. Used for fixture elevation 7" above grade). **Required for use with 1DU2530 by NEC.**

Finish ● Deep Black

Part No. **1DU4344**



## Installation Accessories (Optional)

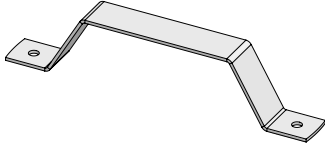

**Fixture metal maintenance removal handle.** Helpful one per 10 fixtures.

*Part No.*    **1E2496**



**Anti-vandal torx head.** Helpful one per 5 fixtures.

*Part No.*    **1E2945**



**Glass suction removal tool.** Helpful one per 20 fixtures.

*Part No.*    **1E0388**

## In Grade J - Box Required

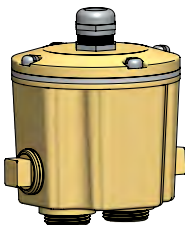

**Direct burial brass ingrade j-box.** Features stainless steel cover screws and strain relief for power cord, (2) 3/4" NPT bottom holes and (2) 3/4" NPT side holes. Includes (4) 3/4" to 1/2" adapters and (2) 1/2" NPT plugs    **(REQUIRED by NEC).**

*Part No.*    **1DU2530**

# Lead Cable (Required)

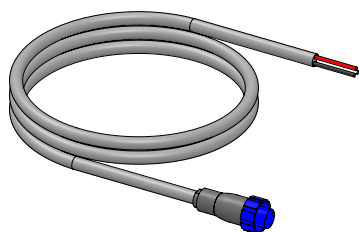

**DMX data lead cable.** DMX data direct burial cable for fixture to controller lead wire connection with IP68 female 3-pin connector (DMX out) bare wire at opposite end for DMX in controller connection.  
**Required for first fixture.**

Length	20ft	30ft	40ft	50ft
Part No.	1DU2533LEAD-20E2	1DU2533LEAD-30E2	1DU2533LEAD-40E2	1DU2533LEAD-50E2

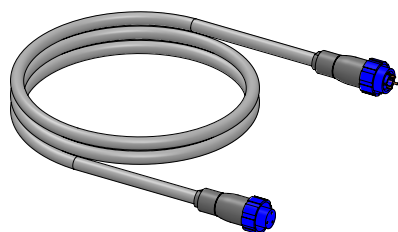

**DMX data jumper cable.** Direct burial cable for fixture to fixture connection with IP68 male 3-pin connector (DMX In) and IP68 female 3-pin connector (DMX out).

Length	10ft	20ft	30ft	40ft	50ft
Part No.	1DU2533-10E2	1DU2533-30E2	1DU2533-30E2	1DU2533-40E2	1DU2533-50E2

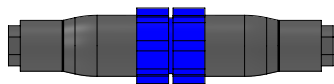

**Connection terminal.** DMX IP68 end terminal 2”L x 0.75” dia. male gold plated 3-pin connector terminal. **Required for last fixture in run only.**

Part No. 1DU2533TERME2

# Keplero Wall Washer RGBW Installation



**KEPLERO WW RGBW  
KPLWWL1RGBWE2**

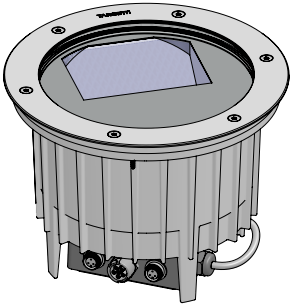

**Installation Sleeve**

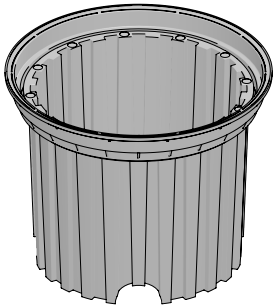

**Extension Sleeve**

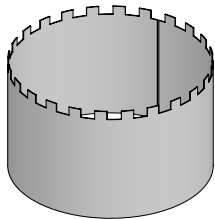

**1DU2394**

**OR**

**Raised Installation Sleeve**

**1DU434312  
1DU434318  
1DU434336**

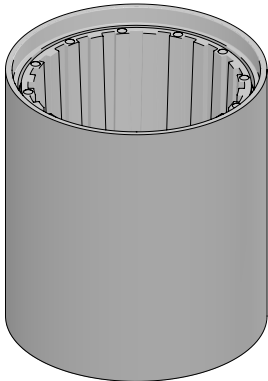

**12" / 18" / 36"  
heights available**



**Stainless Steel Trim Ring**

**In Grade J - Box Required**

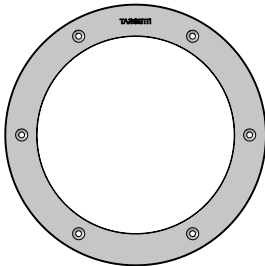

**1DU2530**

**1DU2325      1DU2325A  
1DU2325B   OR   1DU2325BA  
1DU2325K      1DU2325KA**

All the rings can be installed flush or semi-flush by simply removing the insertion collar from the PVC installation sleeve.

# Sleeve Installation Instructions

- Installers will dig out trenches to prep the aluminum extension ring and the PVC sleeve following these steps.
  - Put gravel in the trenches for the J-Box
  - Required by UL for adequate drainage
  - Safety net covers below the J-Box and the conduit pipe to warn diggers what is below
- Position of the J-Box must be at an accessible depth between 8.5-11.5" required for maintenance
- Once J-box and conduits are in position, insert the aluminum extension ring with the installation sleeve in place
  - The gap between the end of the aluminum ring and the middle of the J-Box should have enough room to fix the power cord and the power cord needs to be installed with enough slack to remove the fixture while connected

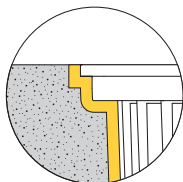

## Flush Mount Sleeve Assembly

\*Power Cord to remote driver to be installed with enough slack to remove fixture while connected. Use 4ft Lead cable as required.

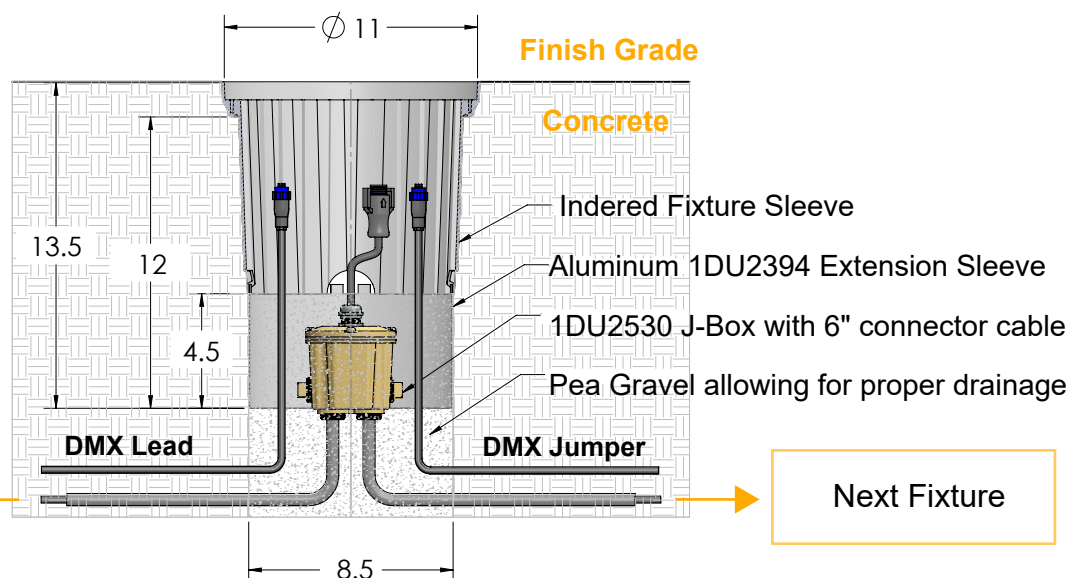

## Semi-Flush Mount Sleeve Assembly

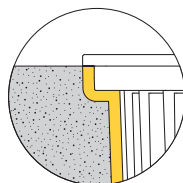

- If installation requires semi-flushed finish
  - Break off outer ring of installation sleeve for 0.15" raise
  - Fixture will rest above the sleeve for a covered look

\*Power Cord to remote driver to be installed with enough slack to remove fixture while connected. Use 4ft Lead cable as required.

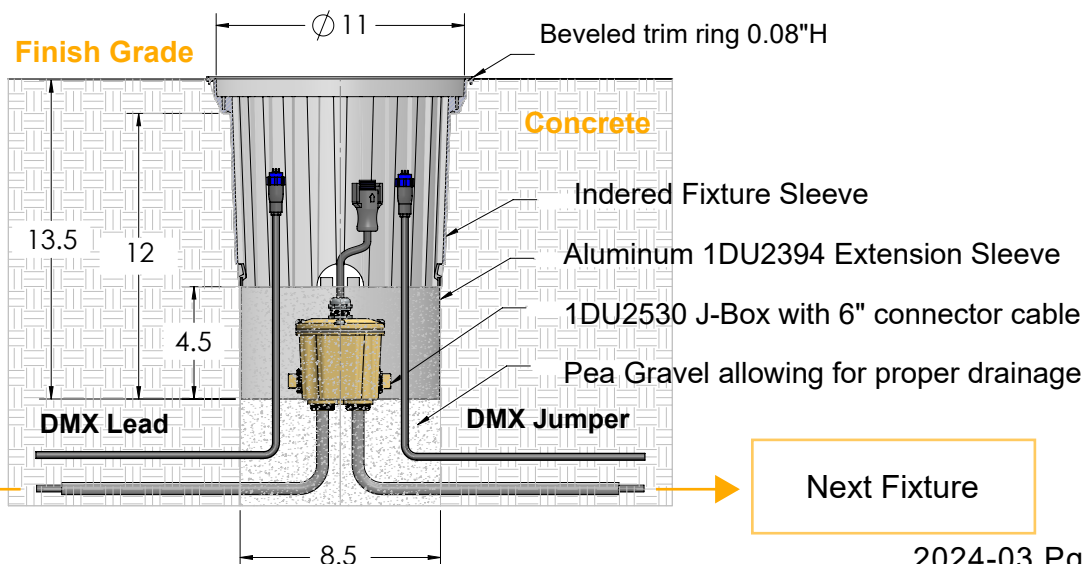

## Sleeve Installation Instructions Cont.

- For DMX Cable
  - Provide a separate PVC conduit through the gravel to provide a run for all fixtures with dimming for parallel circuiting installation

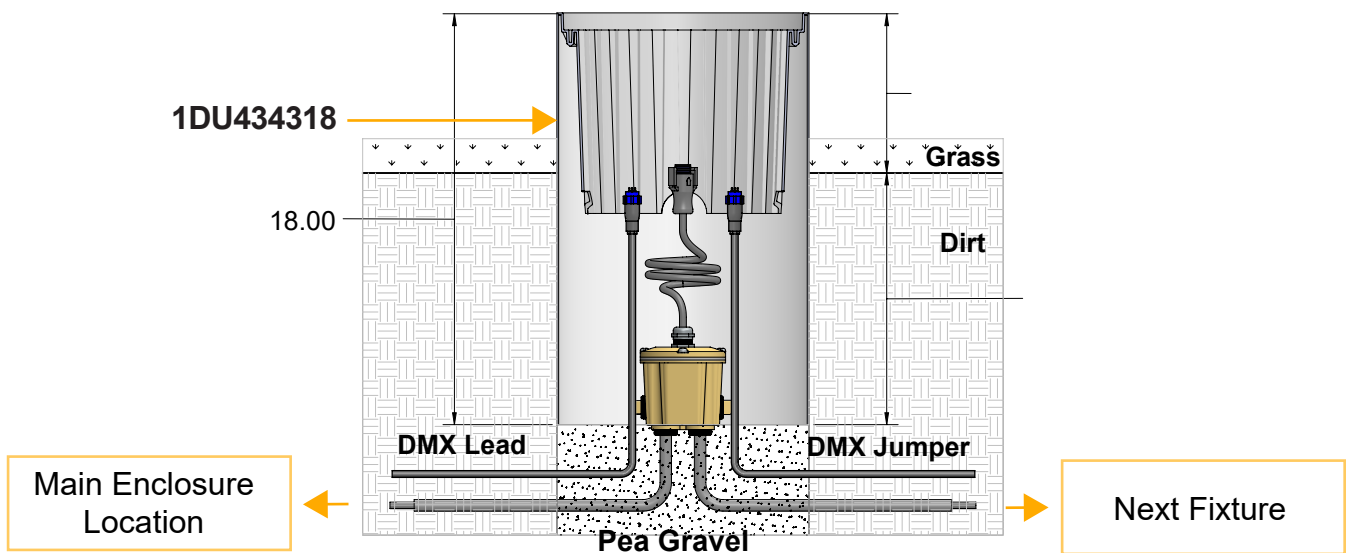
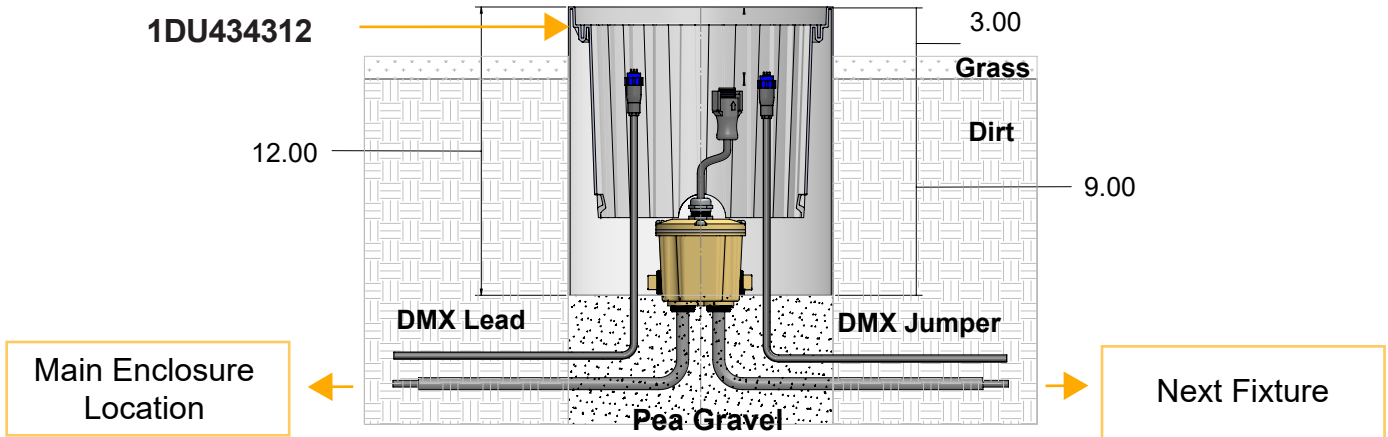

## Sleeve Installation Instructions

- For Raised Installation
  - Installers will dig out trenches to prep the PVC tube
  - Minimum 15" from bottom of raised installation sleeve to ground level Installers will dig out trenches to prep the PVC Insert the PVC pipe with the installation sleeve
  - PVC pipe for raised installation is 36" total This allows the extension PVC tube to be field cut to create an elevated installation with a range of 1" to 21"

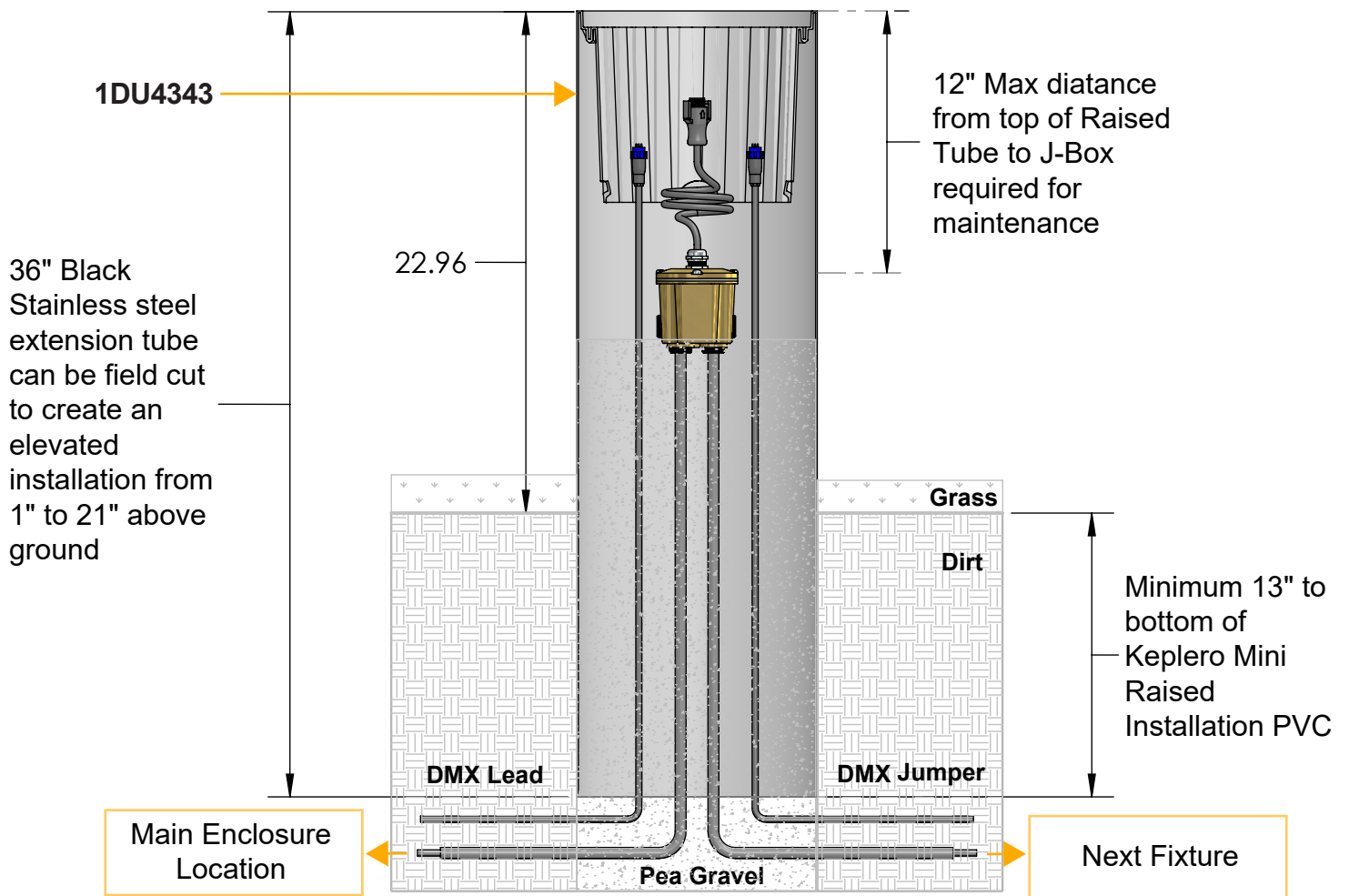

# Sleeve Installation Instructions

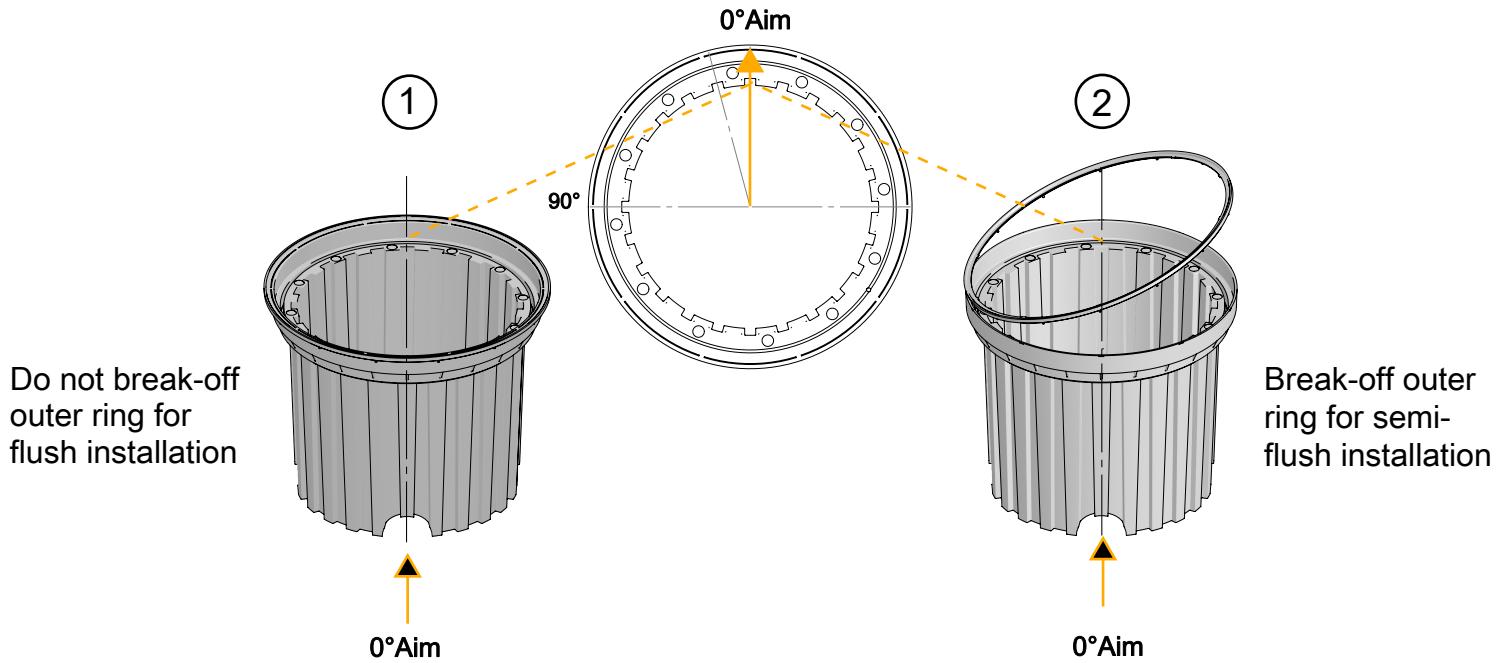

**Important Note:**  
Wall Washer RGBW Fixture aiming is depend on sleeve position.  
Sleeve must be installed in correct 0° position as show above.

- ③ Insert Installation Sleeve with Aluminum J-Box extension sleeve into position keeping power cord safe

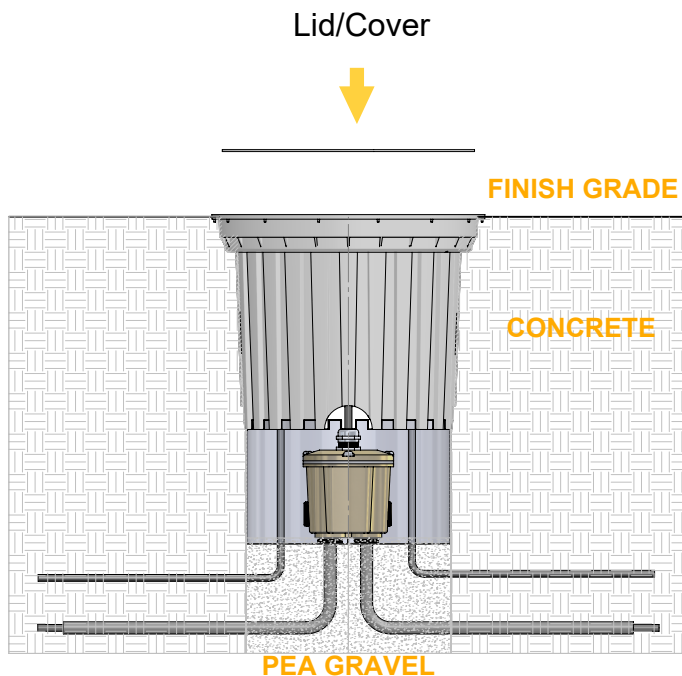

- ④ Keep lid/cover on to prevent debris from entering the sleeve.  
Once dirt has been poured and cured, the sleeve cover can be removed, and LED fixture can be connected and installed

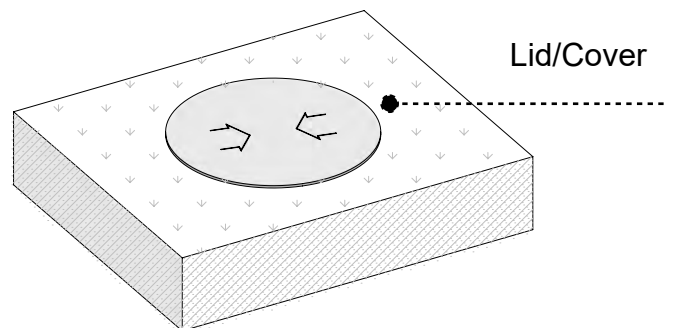

# RGBW Wiring Diagram

Please follow the diagram below for proper DMX signal connections.

each Keplero RGBW is supplied with a 120-277v lead cable to be wired into UL listed waterproof J-Box.

- DMX cables are also supplied at specific lengths depending on the specific project.
- Identify the DMX lead cable and separate it from the DMX jumper cables.
- DMX lead cable delivers signal to first RGBW fixture in that particular group.
- DMX jumper cables transfer DMX data signal in between RGBW fixtures.

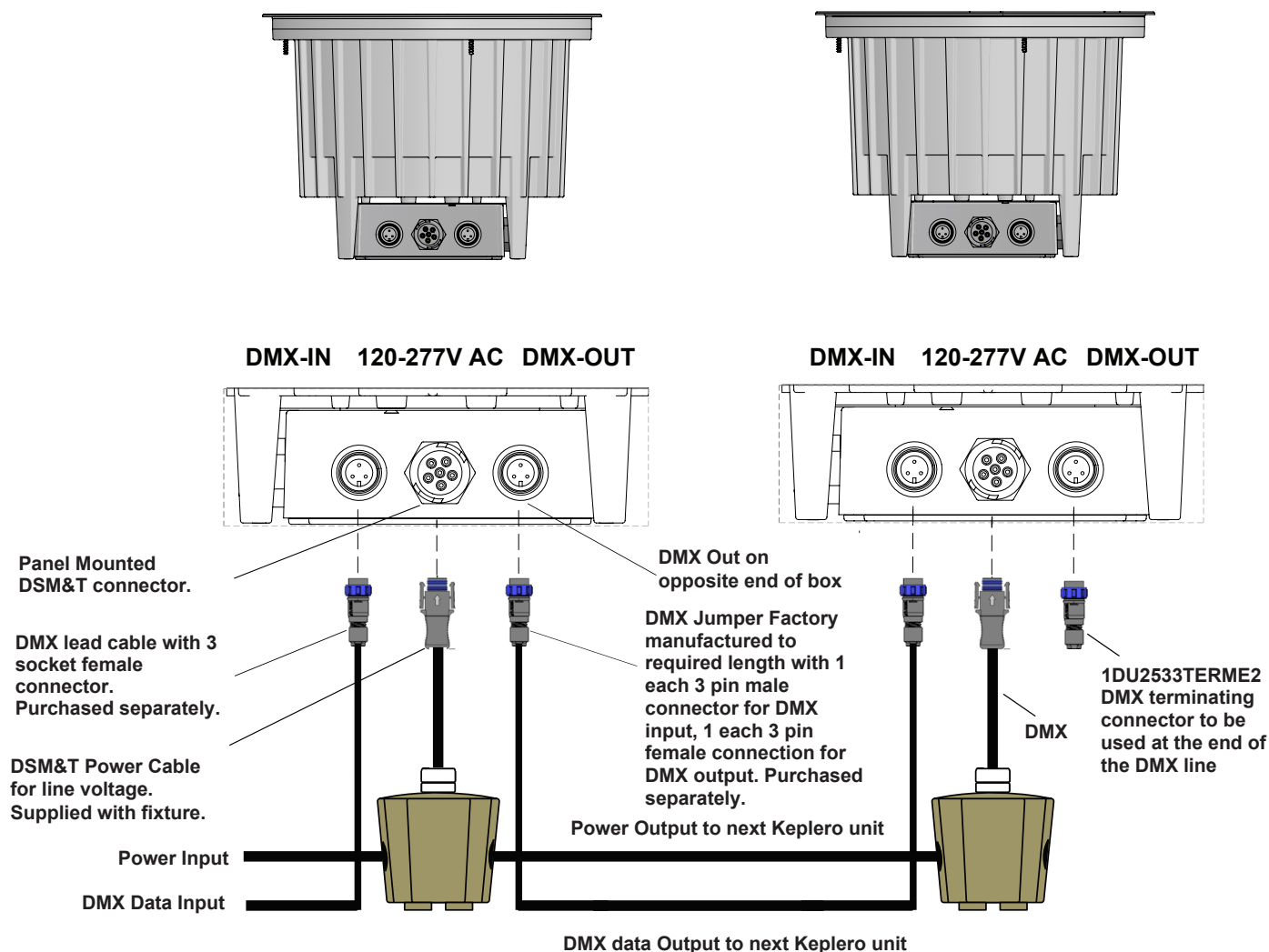

## Power Lead Cable

DSMT anti-wicking quick disconnect  
 Black = Line Voltage Load  
 White = Line Voltage Neutral  
 Green = Ground  
 Red = Optional for long distant runs, (contact factory)  
 Purple = Not used  
 Grey = Not used

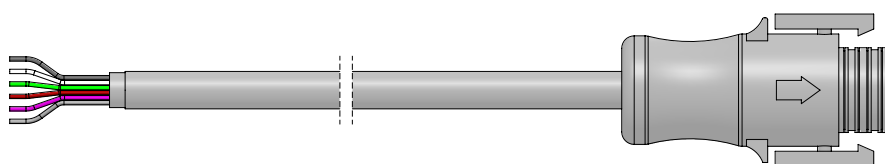



# Fixture Wiring Instructions

①

Connect incoming data cable to DMX input on driver box

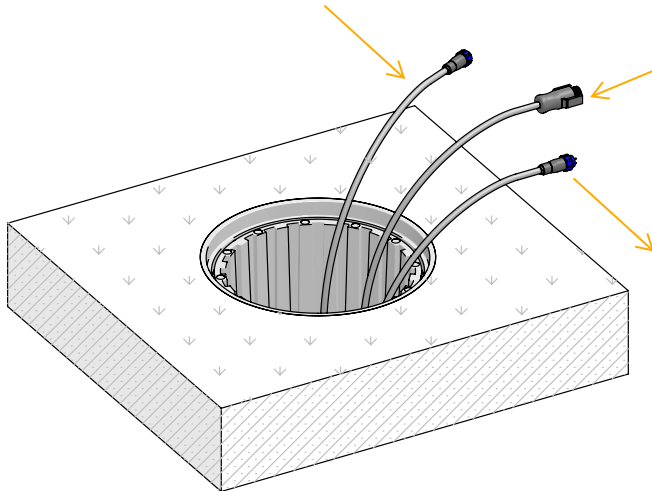

Remove end cap and connect 120-277v IP68 DSMT Lead Cable connector onto fixture's panel mount connector, make sure both locking wings are on lock position before inserting the fixture into the mounting sleeve.

Connect incoming data cable to DMX output on driver box

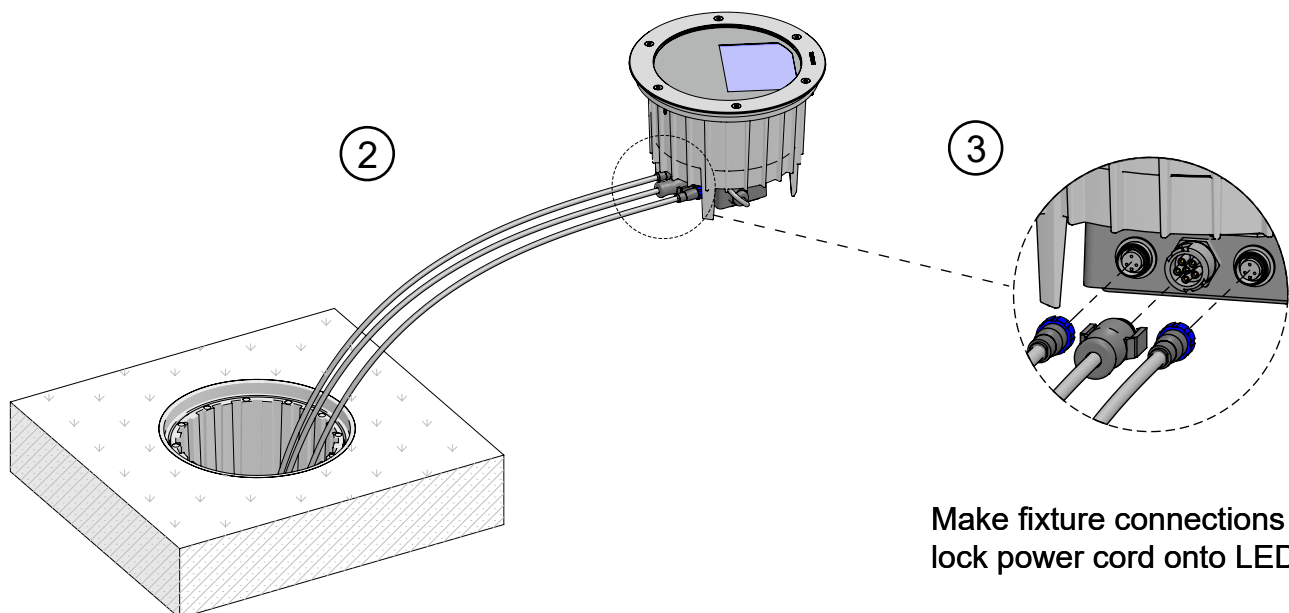

Make fixture connections and lock power cord onto LED fixture

# Fixture Installation Instructions

## Handle Installation Instructions

- Inserting fixture into sleeve
  - Fixture will slide into grooves of the installation sleeve with ease
  - To provide a safe and efficient installation of fixture to the sleeve, use metal handle (optional/not included maintenance accessory)

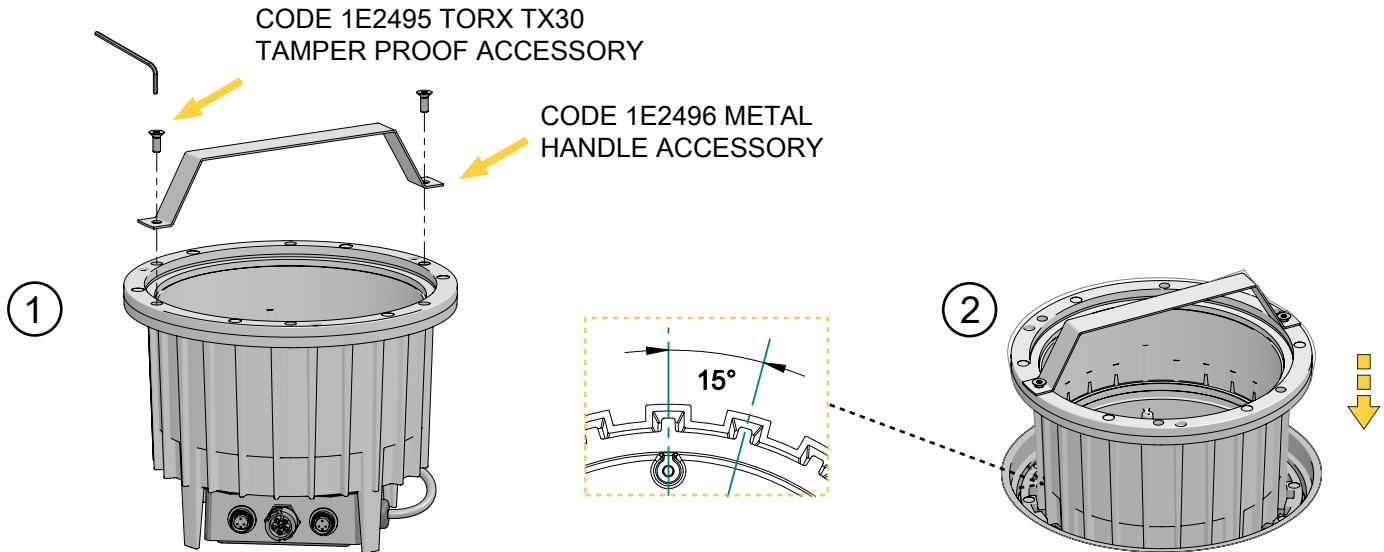

### ③ Insert LED fixture in at the position and angle desired

**A** Once Fixture has been inserted into the PVC sleeve.  
Fasten the fixture onto the sleeve with the 3 screws provided in bag with LED fixture.

**B** Be-sure 0° Aim of Wall Wash reflector matches 0° Aim of sleeve notch to align perpendicular to wall.

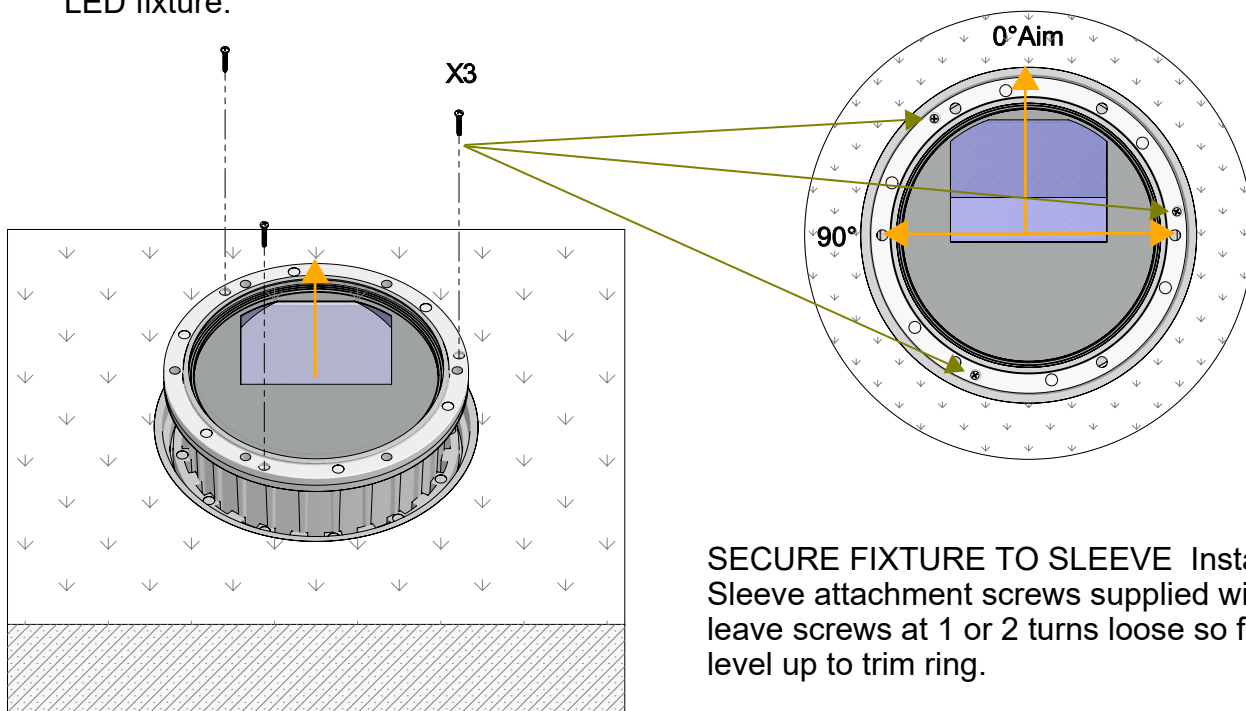

# Fixture Installation Instructions

The **Keplero Wall Washer RGBW** versions provide uniform lighting on vertical surfaces. The hybrid optical system, composed of a lens, a holographic filter and specially designed reflector, not only ensure complete uniformity on vertical surfaces but light that grazes very close to the floor.

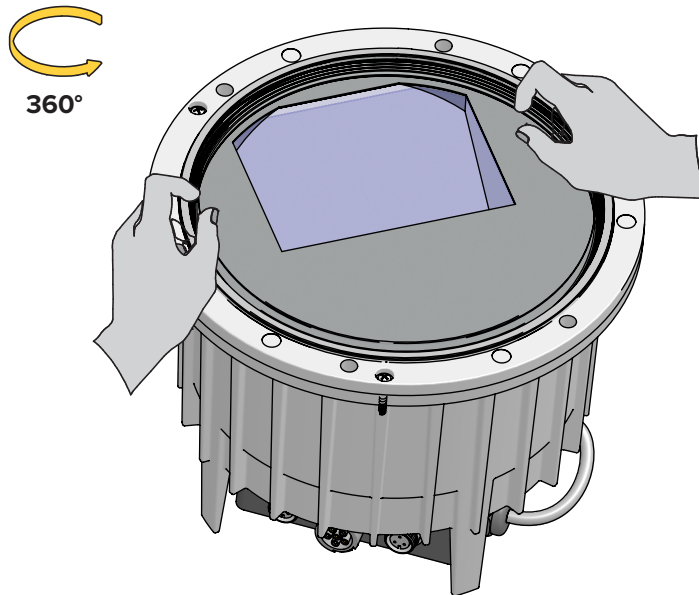

*Light Beam*

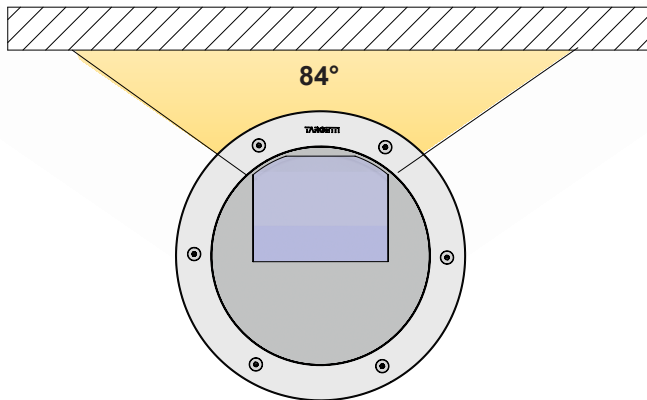

h. 13.12ft | 4m

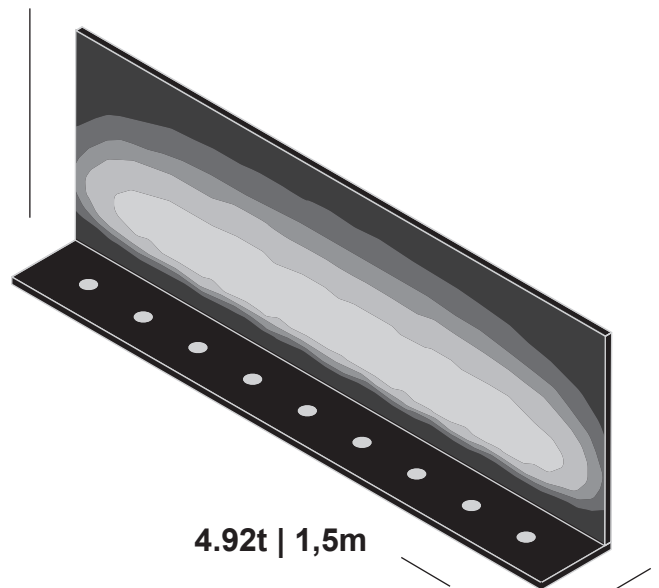

3.28ft | 1m

## OPTICAL PERFORMANCE GUIDE

Illuminance [fc]



0      5fc      7fc      9fc      14fc      19fc

# Trim Installation Instructions

**Fixture** comes with trim ring installed. After trim ring is removed for optics adjustment, follow these next steps to complete a successful trim ring installation:

- Use a tamper-proof torx key (sold separately/optional but recommended) to remove the trim ring, and the glass. Access the optics holder for beam spread angling.
- Once you set position of the optics to the desired lighting angle, **power on fixture and cover with supplied installation sleeve lid and let the fixture operate for 45 minutes before attaching glass and trim ring.**

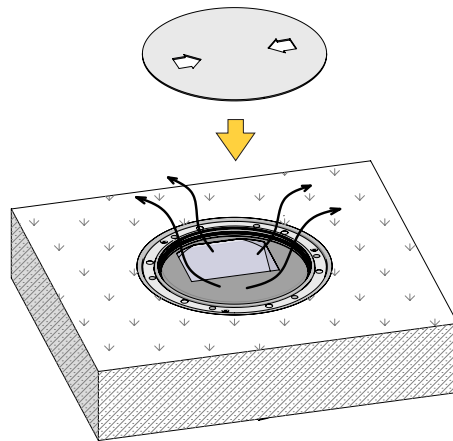

## SS Trim and Glass Installation Instructions

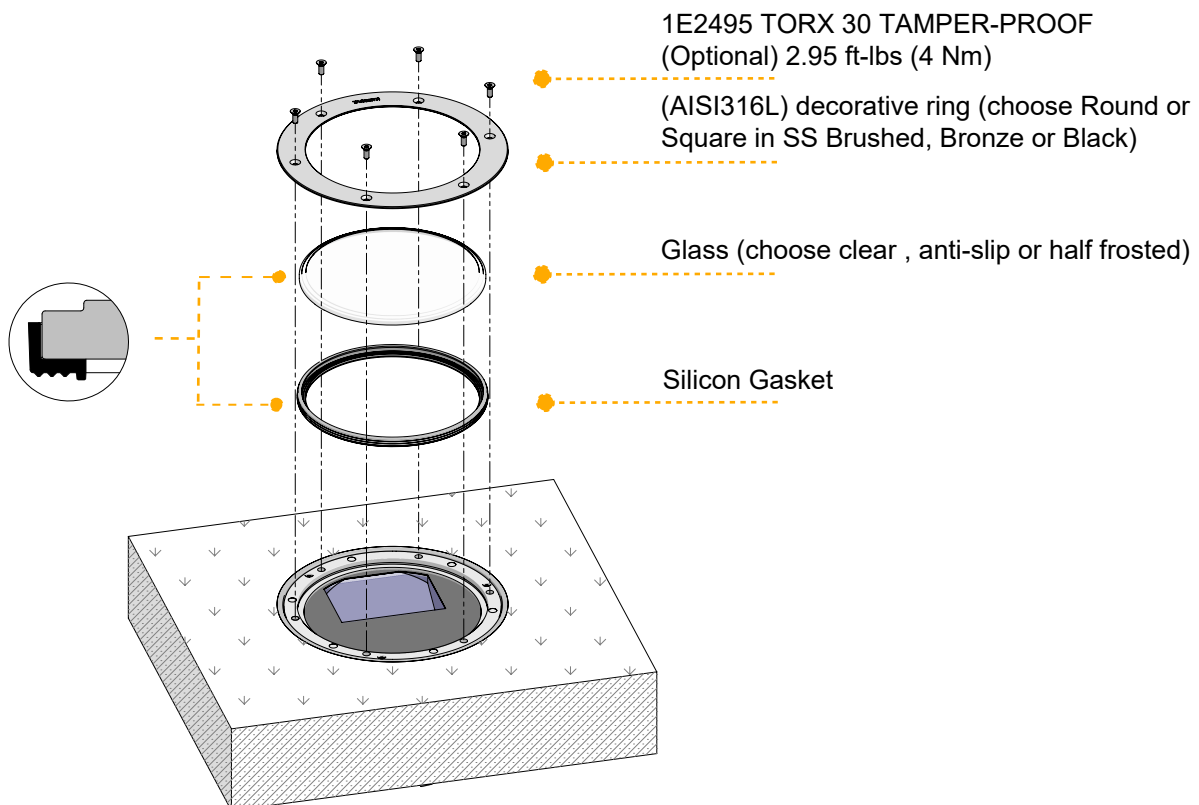

# Trim Installation Instructions

- When securing the tamper-proof torx screws
  - Apply only 2.95ft-lbs (4Nm) of torque to efficiently secure the fixture
  - Torque screws in X-box formation to provide a tight, even, and secure holding for the trim ring

**1E2495 TORX 30 TAMPER-PROOF**  
(Optional) 2.95 ft-lbs (4 Nm)

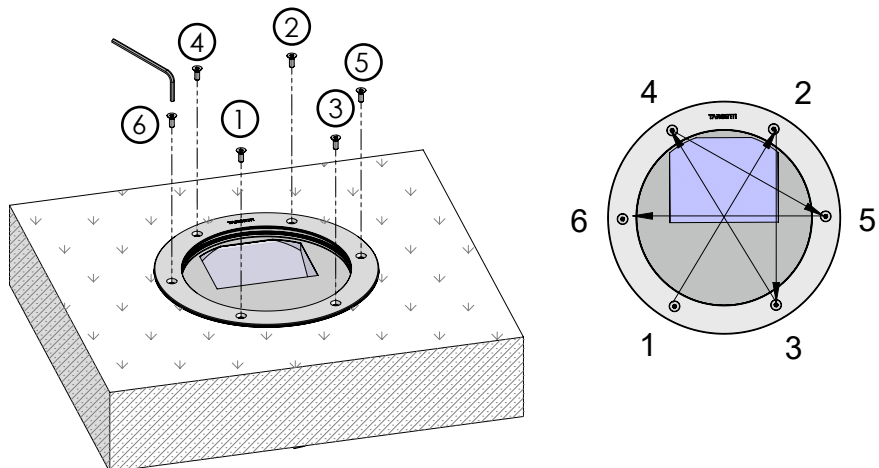

## Step1:

Thread screws down in X pattern to hold trim ring flat



## Step2:

Torque screws down in X pattern to tighten and seal

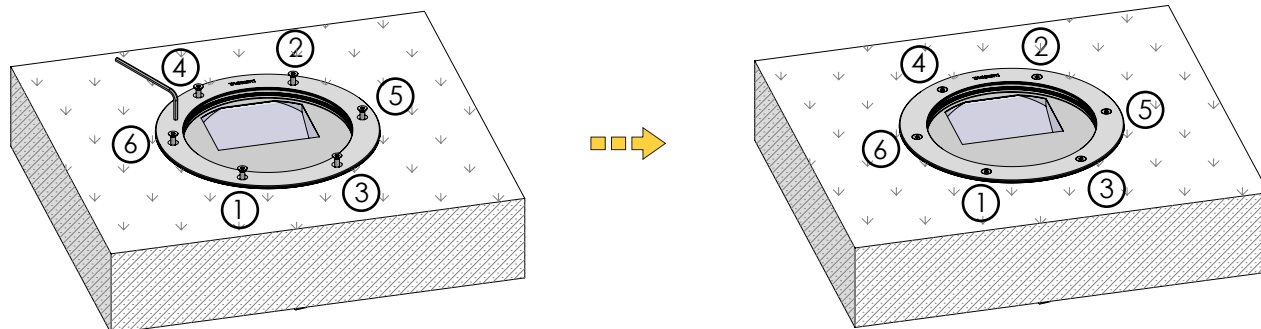

Do not use hand drill to screw each screw to tight one at a time  
This can chip glass or bunch gasket and prevent a proper seal.

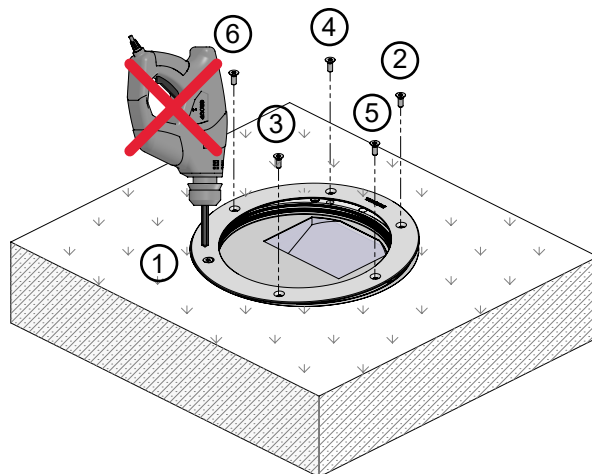

# Finished Installation Examples

**IN GRADE INSTALLATION ASSEMBLY**  
Recommended for Ground Level Installation  
with Extension Sleeve 1DU2394

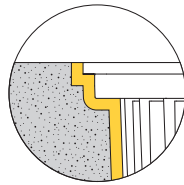

**Flush Mount Sleeve Assembly**

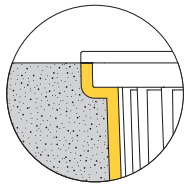
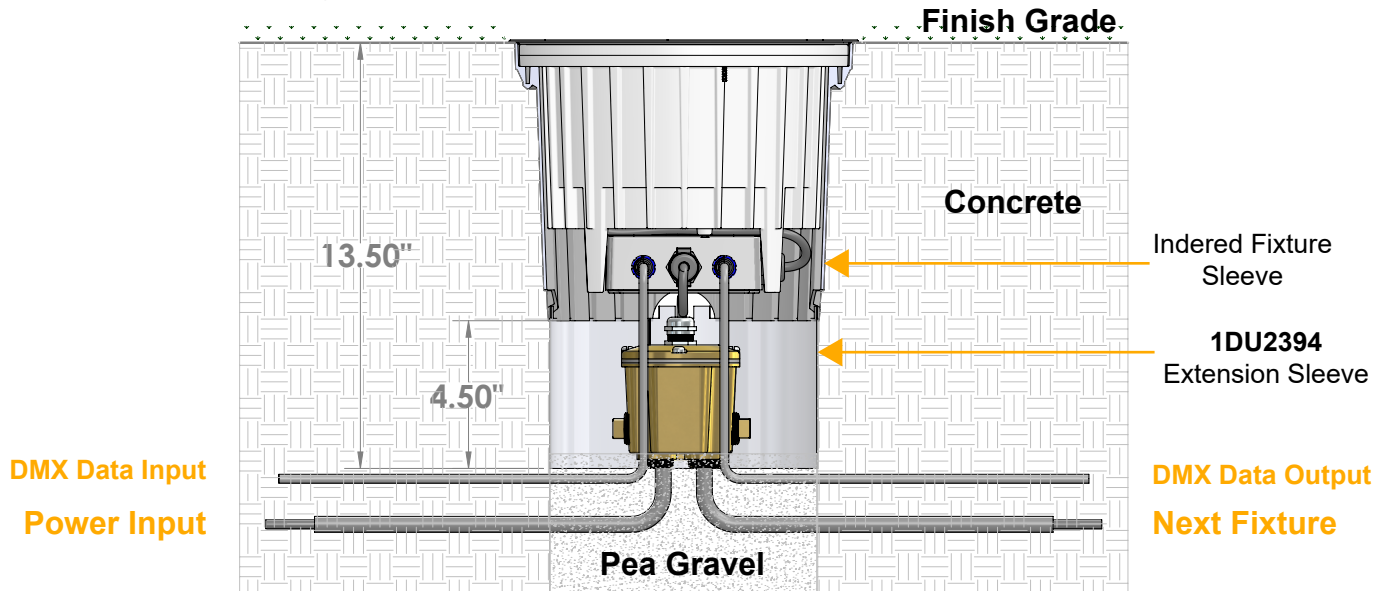

**Semi-Flush Mount Sleeve Assembly**

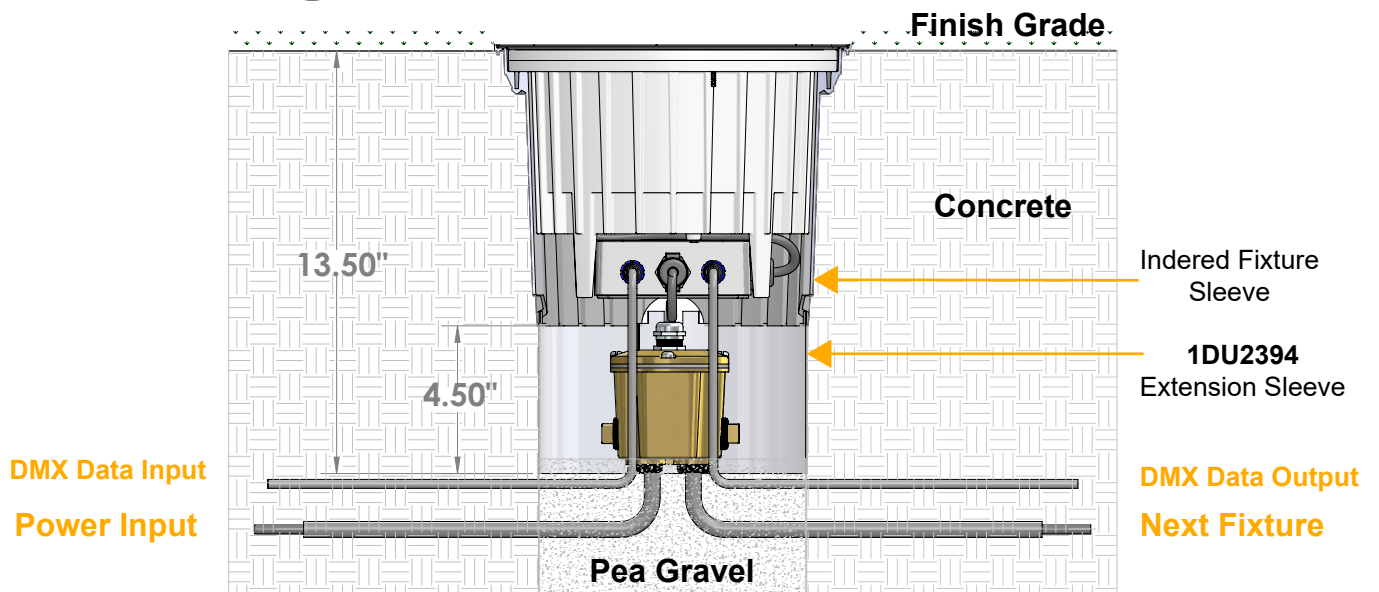

# Finished Installation Examples

## RAISED TUBE INSTALLATION ASSEMBLY

Recommended for Ground Level Installation

1DU4343 with Round Trim ONLY

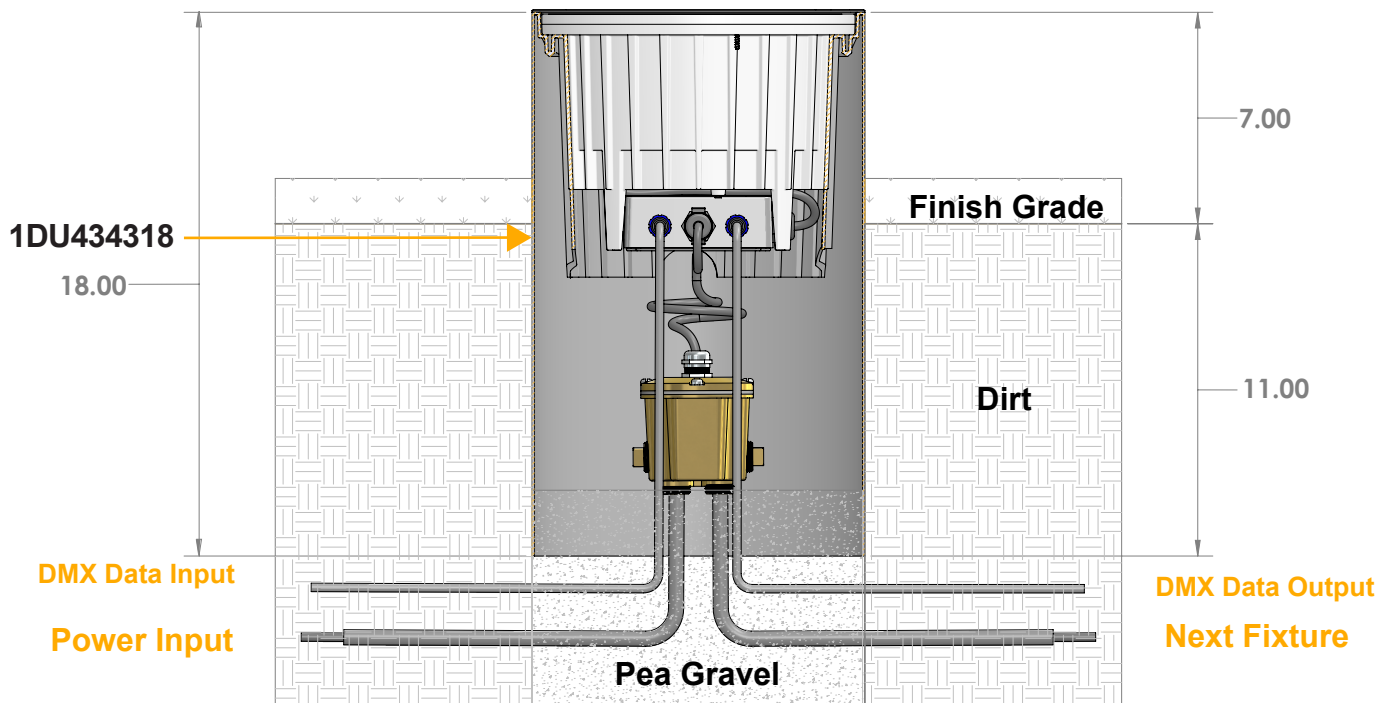
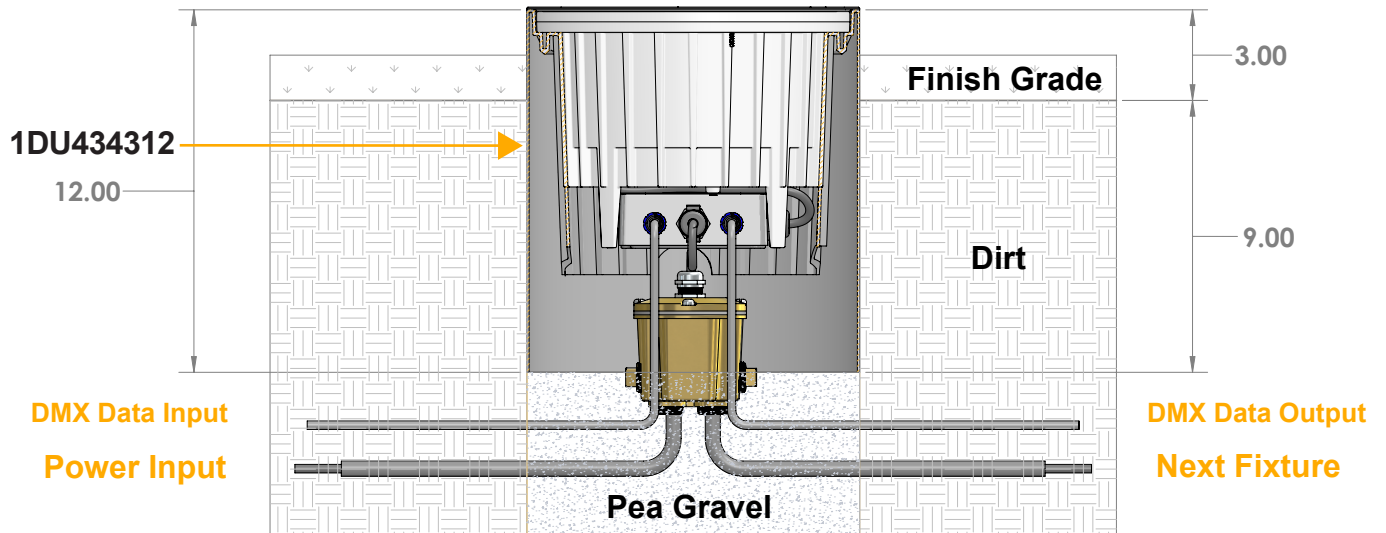

# Finished Installation Examples

## RAISED TUBE INSTALLATION ASSEMBLY

Recommended for Ground Level Installation

1DU4343 with Round Trim ONLY

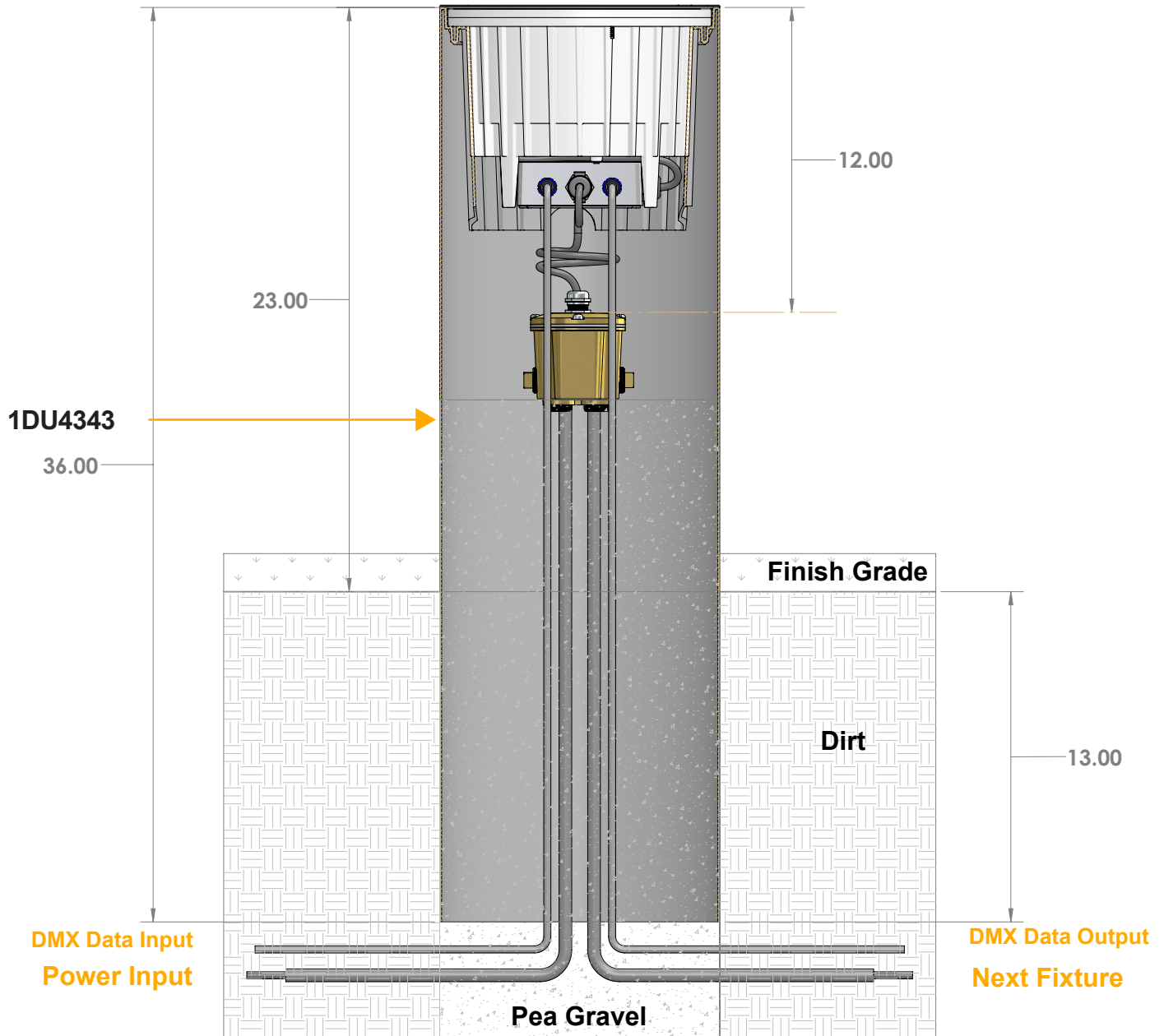



---

# Service Options

## PRE-SHIP ADDRESSING

A Targetti technician shall factory address each fixture per the project addressing chart (provided by customer) prior to shipping. The project addressing chart shall be received prior to fixture shipping. If fixture addressing chart is not received, fixture will be default addressed at 001. Targetti shall not be responsible for delays due to the requested addressing configuration not being provided within the requested time-frame.

## ALTERNATIVE

### PRGM02

Before, during or after fixture rough in installation is completed, a Targetti technician shall travel to the installation site. The project is reviewed and checked for proper wiring, installation and functionality of the primary power and control systems before Control system operation is switched on. Any installation issues are addressed and resolved with the onsite contractors. All fixture addressing is confirmed and can be changed as required, the the Targetti technician will perform this task in accordance to the intended lighting design. For local installations (within 50mi of Costa Mesa, CA), consult factory. Travel expenses excluded and billed separately.

### PRGM03

After fixture installation is complete, a Targetti technician shall travel to the installation site to assist contractor and/or systems integrator to trouble shoot issues that are resulting in non-operation or incorrect function of the system when connector into Control Systems Protocols. The project is reviewed and checked for proper wiring, installation and functionality of the system and proper System data flow from Control, Gateways and Fixtures. Any installation/control issues are addressed and resolved with the onsite contractors. If onsite fixture programming is required, the Targetti technician will perform this task in accordance to the intended lighting design. For local installations (within 50mi of Costa Mesa, CA), consult factory. Travel expenses excluded and billed separately.

### PRGM04

A Targetti technician shall provide overall control training for end users / the facility maintenance team. This training covers overall usability of the lighting control(s), focusing on functionality and programming.

---

## Maintenance

This fixture was designed and manufactured for a durable, long lasting use with minimum care. To ensure the maximum lifespan of this product, we encourage our customer to provide a quality visual inspection of the fixture and installation accessories every six months. If there are any visible signs of issues (i.e moisture or dust) during the inspection, please clean any of the dust or moisture with a soft cloth and check to make sure that any of the fixtures are still operating normally. If there are any issues regarding the fixture please contact us as we will assist the situation at hand.

---

## Support

Any questions, problems, or comments you have please feel free to contact our Customer Service department during our business hours Monday-Friday 8am-5pm via: Email: [usaorders@targetti.com](mailto:usaorders@targetti.com)  
Phone: (714) 513-1991

Visit our website: <http://www.targettiusa.com>