

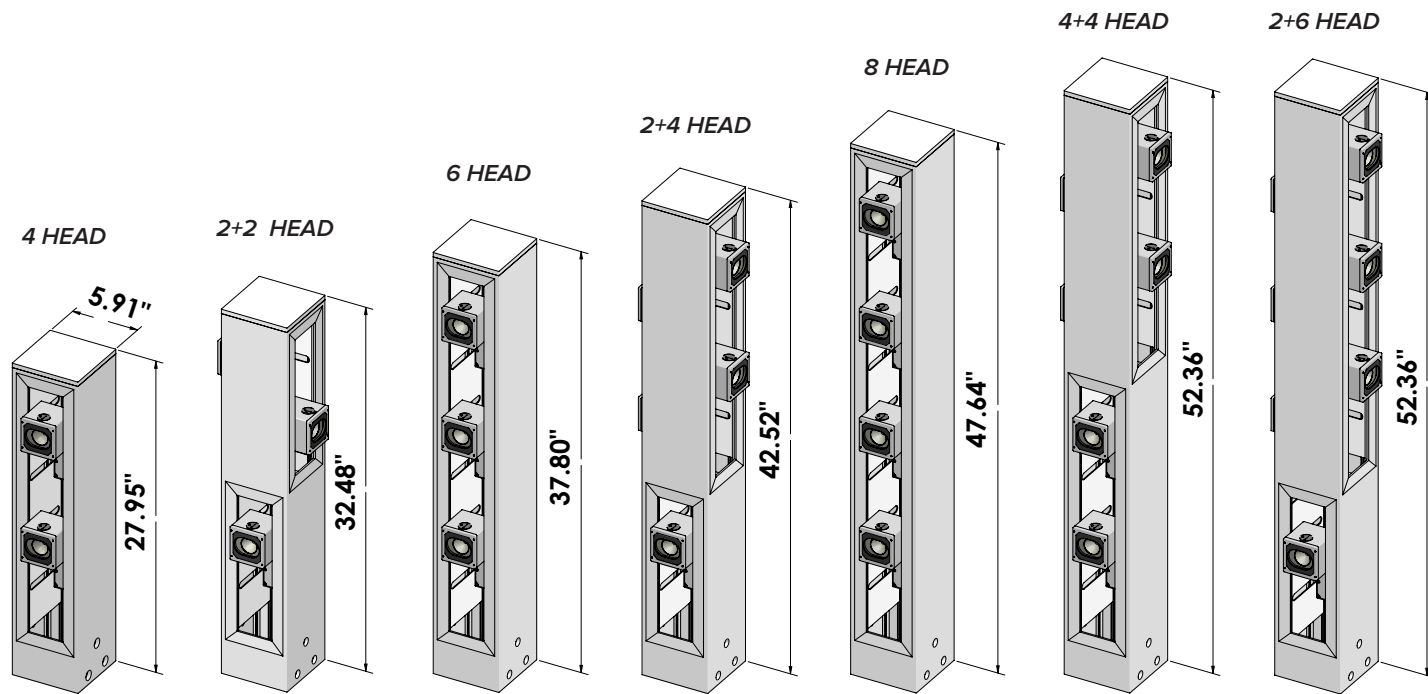

LUCERA LUCA(0/6)-

MULTI-HEAD EVENT WITH PROFESSIONAL ADJUSTABLE FLOODLIGHT PROJECTORS



120-277 VAC

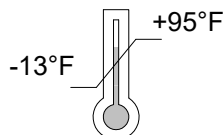

IK 09

If in doubt about the symbols please refer to catalog or website

WARNING

To ensure a maximum efficient use of the product, read the instructions before proceeding installment.



This fixture must be installed by a licensed and qualified electrician. The installer must comply with NEC and local building codes when installing the fixture



Electrical current can cause painful shock, serious injury, or even death. Make sure you turn off the power supply, ground fixture(s), and make sure all electrical connections are correct and secured tightly



For use in IP66 installations.



Keep the label of the original packaging if any eventual future claims are needed

Table of Contents

Packaging Contents
Pole Accessories (Optional)
Pole Accessories Installation
Optical Accessories / Installation
Pole Diagram
Maintenance / Support

Pg.2/5
Pg.6/7
Pg.8/16
Pg.17/20
Pg.21
Pg.22

2024-03 Pg.1

Packaging Contents / Dimensions

ADJUSTABLE VERSION

**LUCA1-
4 HEAD**
27.76" Lg

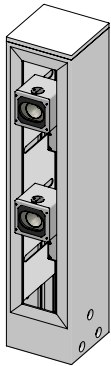

**LUCA0-
2+2 HEAD**
32.48" Lg

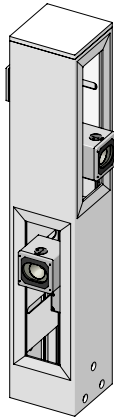

**LUCA3-
6 HEAD**
37.60" Lg

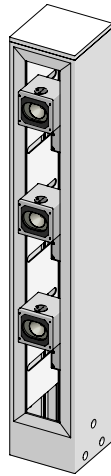

**LUCA2-
2+4 HEAD**
42.32" Lg

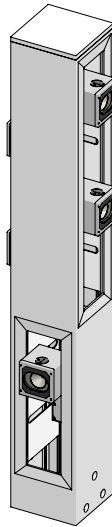

**LUCA4-
8 HEAD**
47.44" Lg

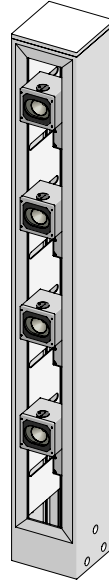

**LUCA6-
4+4 HEAD**
52.17" Lg

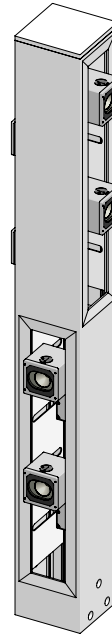

**LUCA5-
2+6 HEAD**
52.17" Lg

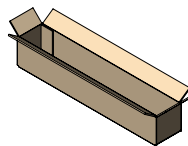
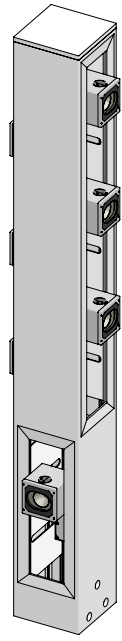

27.76" FIXTURE IN 30"x 8"x 8" BOX@28Lbs
32.48" FIXTURE IN 34"x 8"x 8" BOX@31Lbs
37.60" FIXTURE IN 40"x 8"x 8" BOX@37Lbs
42.32" FIXTURE IN 45"x 8"x 8" BOX@40Lbs
47.44" FIXTURE IN 50"x 8"x 8" BOX@46Lbs
52.17" FIXTURE IN 55"x 8"x 8" BOX@49Lbs

Textured finish.

● Ferrite Dark Grey (Default) ● Heritage Brown (HB)* ● Bronze (BZ)* ● White (WT)* ● Black (BT)* ● Sandstone Grey (SG)* ^B Custom RAL

Packaging Contents / Dimensions Cont.

POLE (REQUIRE)

Part No. **1US002Z (*)**

11.5ft square powder coated aluminum pole.

5.9in x 5.9in profile with integral hatch door for utility power. **An additional 6"H is applied to the overall pole height when used with 1USCLR06 pole accessory collar.**

Weight: 58lbs

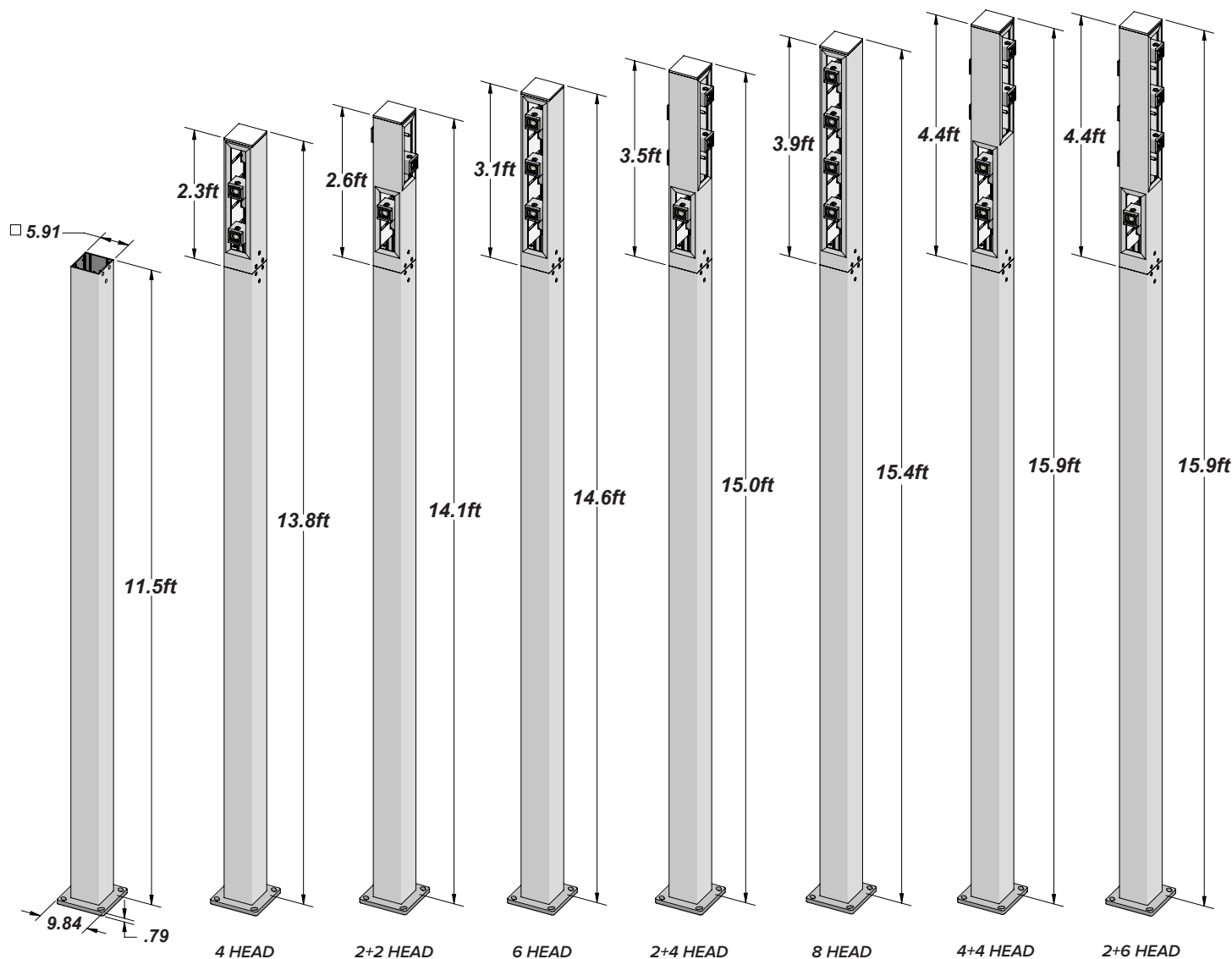

Textured Finish

● Ferrite Dark Grey (Default) ● Heritage Brown (HB)* ● Bronze (BZ)* ● White (WT)* ● Black (BT)* ● Sandstone Grey (SG)* ^B Custom RAL

Packaging Contents / Dimensions Cont.

POLE (REQUIRED)

Part No. **1US002Y (*)**

16.4ft square powder coated aluminum pole.

5.9in x 5.9in profile with integral hatch door for utility power. **An additional 6"H is applied to the overall pole height when used with 1USCLR06 pole accessory collar.**

Weight: 82lbs

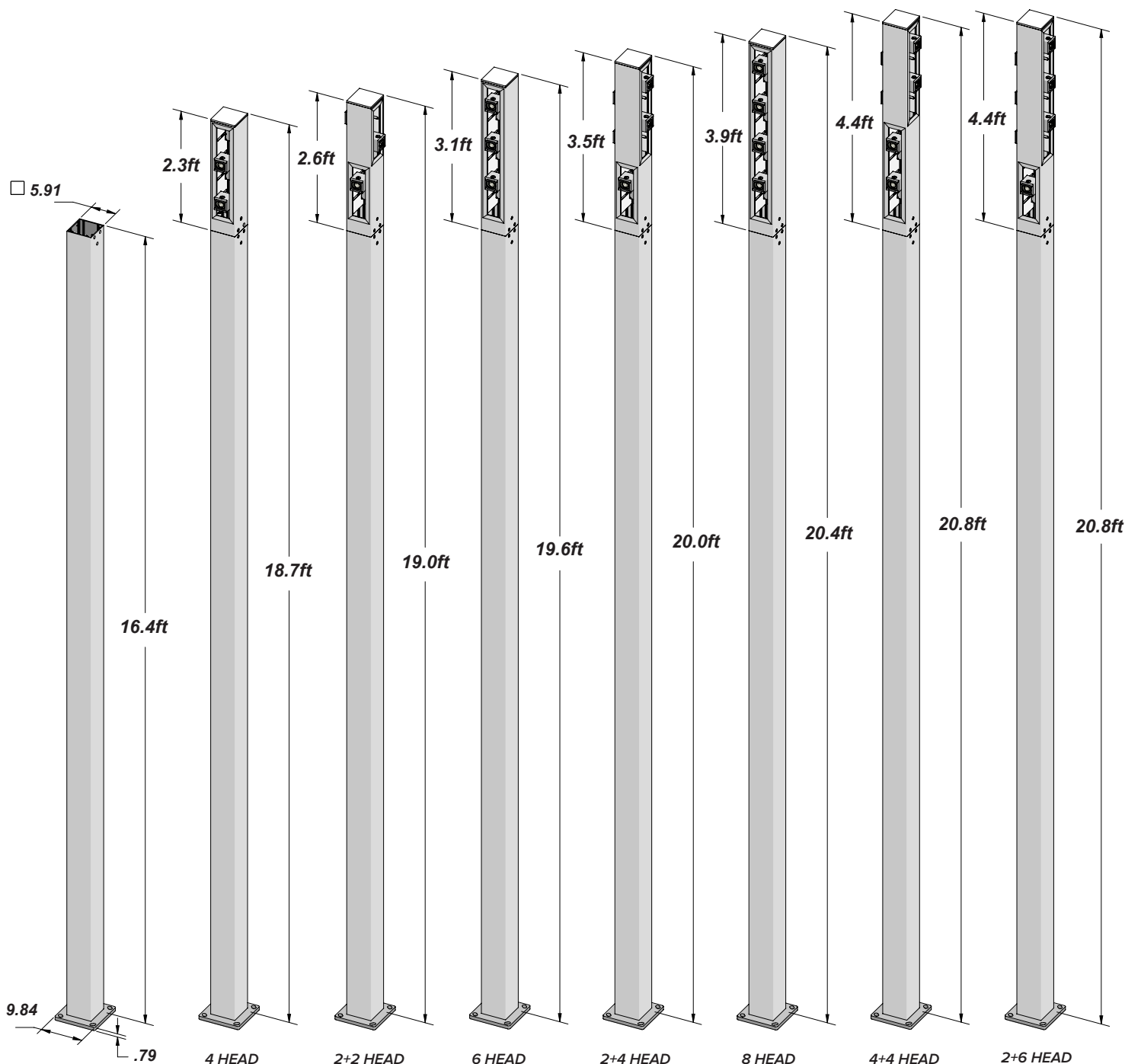

Textured Finish

● Ferrite Dark Grey (Default) ● Heritage Brown (HB)* ● Bronze (BZ)* ● White (WT)* ● Black (BT)* ● Sandstone Grey (SG)* ^B Custom RAL

Packaging Contents / Dimensions Cont.

MOUNTING (REQUIRED)

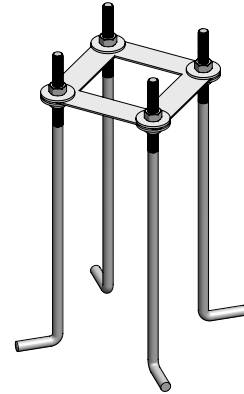
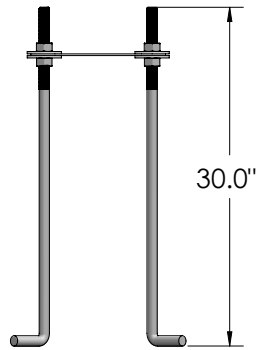
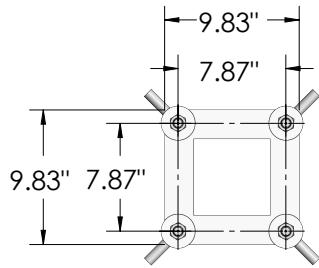

Part No. **1USE001A**

Pole anchor kit. 4ea 3/4"x 30" 'J' anchor bolts, 8ea hex nuts and washers, 1ea template.
(REQUIRED per pole)

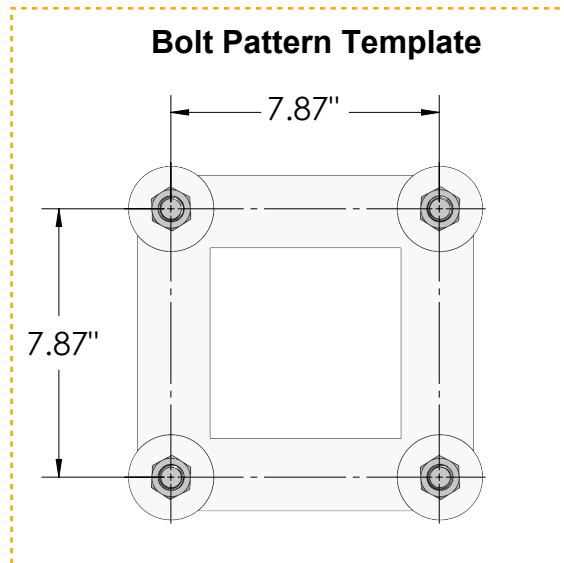

Pole Accessories (Optional)

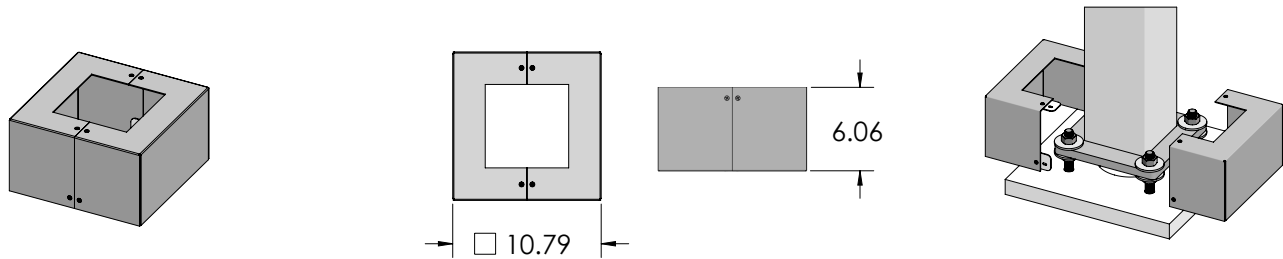

Decorative aluminum pole base cover.

Part No. A010A (*)

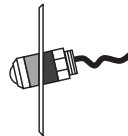

Integral angled IP67 wall plate camera. Analog 1080p 4-in-1 (HD / TVI / CVI / AHD) 155° viewing angle with 2.9mm lens. Equipped with Sony STARVIS that provides high quality color saturation when recording at night. **Required to be used with USCLR06 Accessory Collar.**

Part No. 1USCAM01



2.75"



Integral 2-in-1 motion sensor and photo cell. 270° motion, 70ft range with dusk to dawn setting. **Required to be used with 1USCLR06 Accessory Collar.**

Finish ● **Black** ● **White**

Part No. 1USSNS01BK 1USSNS01WH



4.00"



6.00"

Fusion® XS coaxial speaker. IP65 marine grade aluminum dome, 120W. **Required to be used with 1USCLR06 Accessory Collar.**

Part No. CONSULT FACTORY

Pole Accessories (Optional) Cont.



BannerSaver™ break away banner arms with mounting hardware and stainless steel mounting band, black finish. Sold in sets of two 12"L arms. **Consult factory for additional lengths. Banner not included.**

Part No. **CONSULT FACTORY**

Mounting Bracket

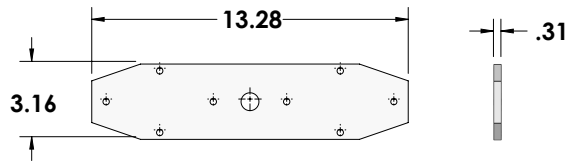
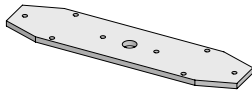

Pole Integrated

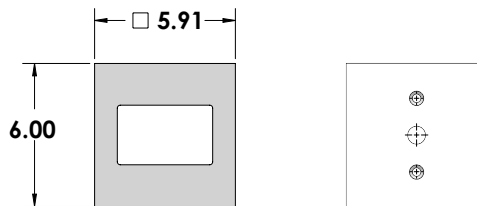
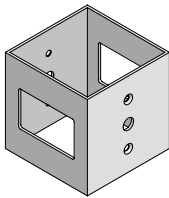

Accessory collar. 6"H pole integrated aluminum, 2pc steel mounting brackets included.

Required for mounting specified accessories as noted.

Weight: 11lbs

Part No. **USCLR06 (*)**

Pole Accessories Installation

US002Z(*)
US002Y(*)

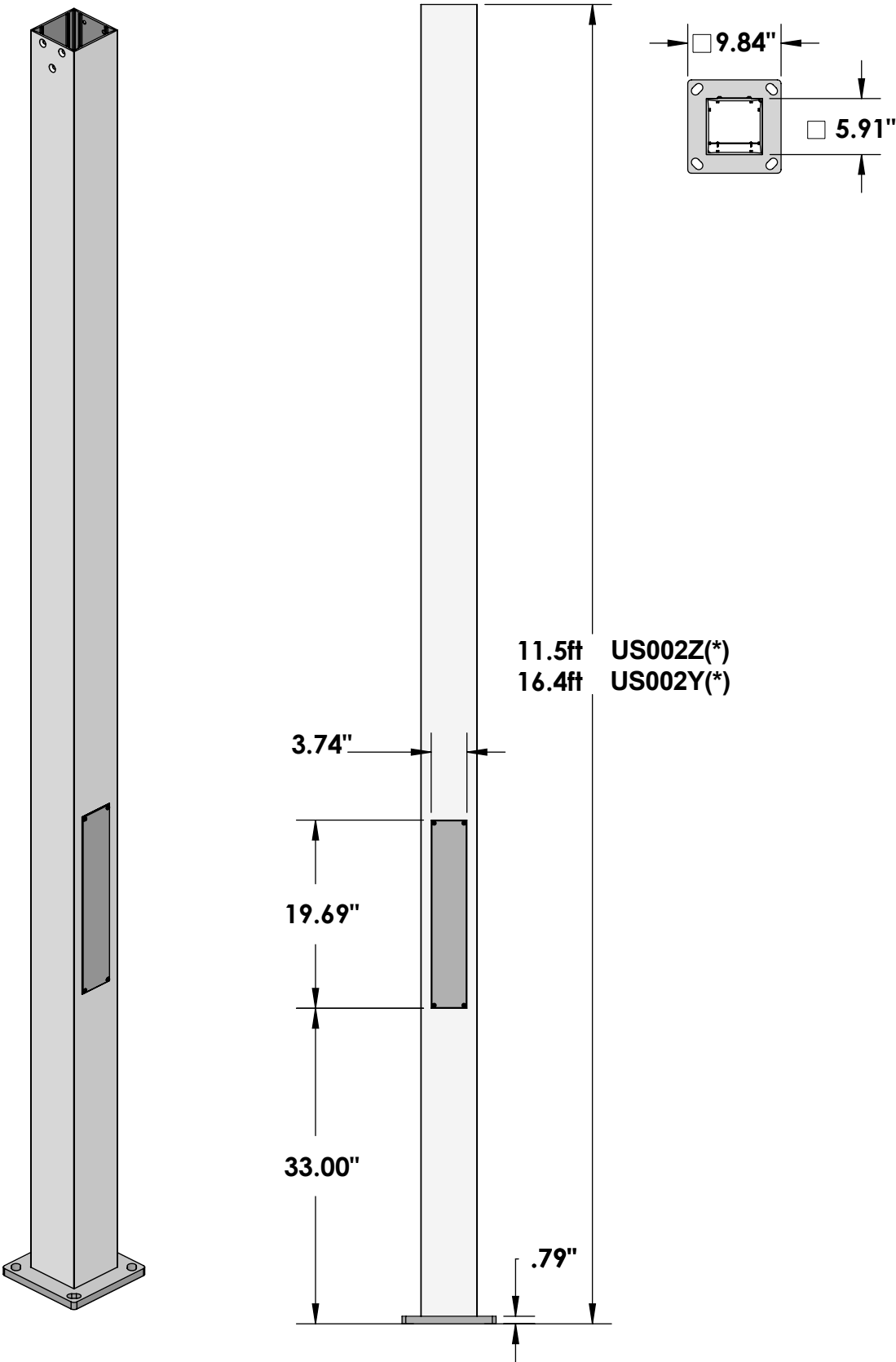

Pole Accessories Installation Cont.

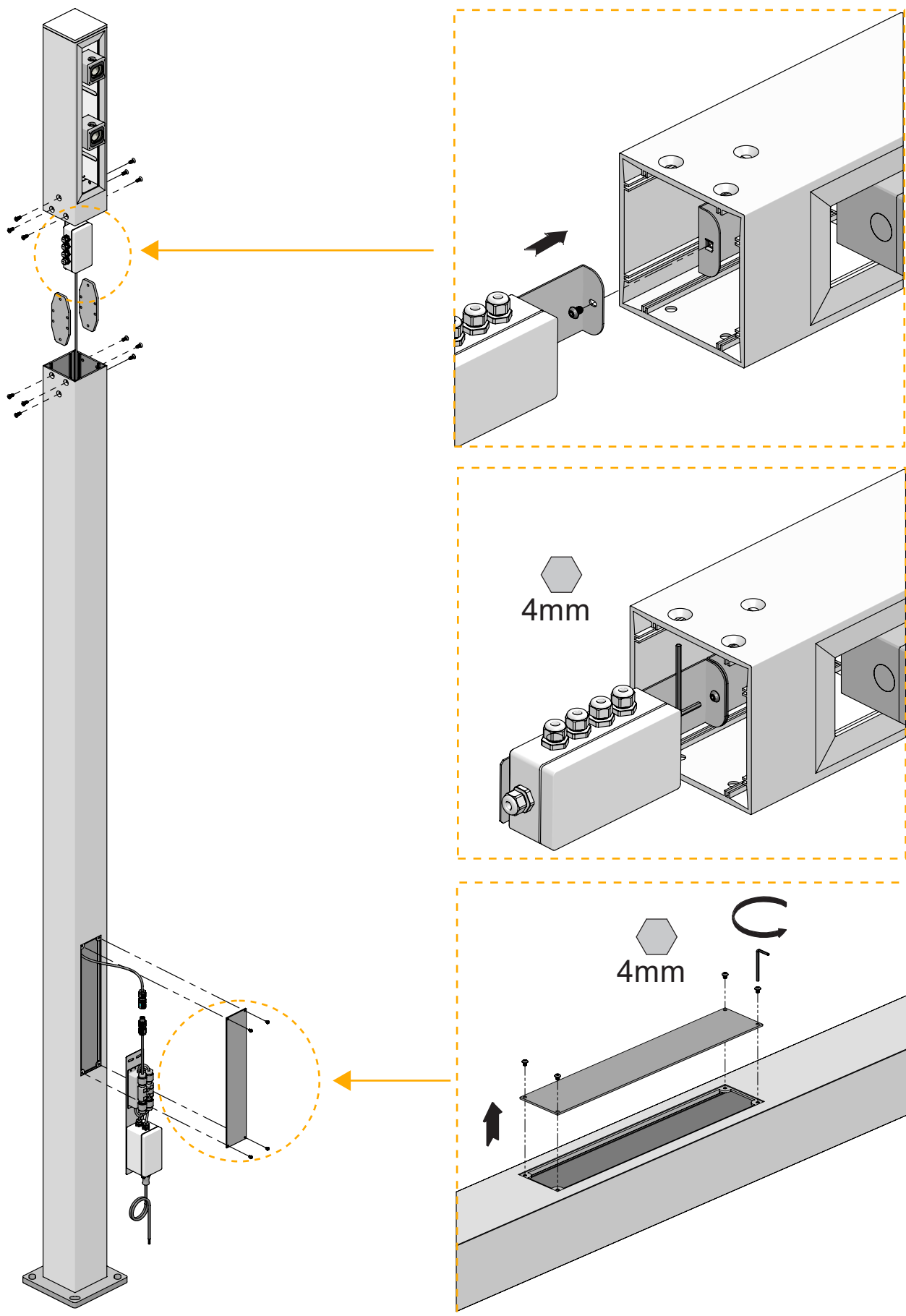

Pole Accessories Installation Cont.

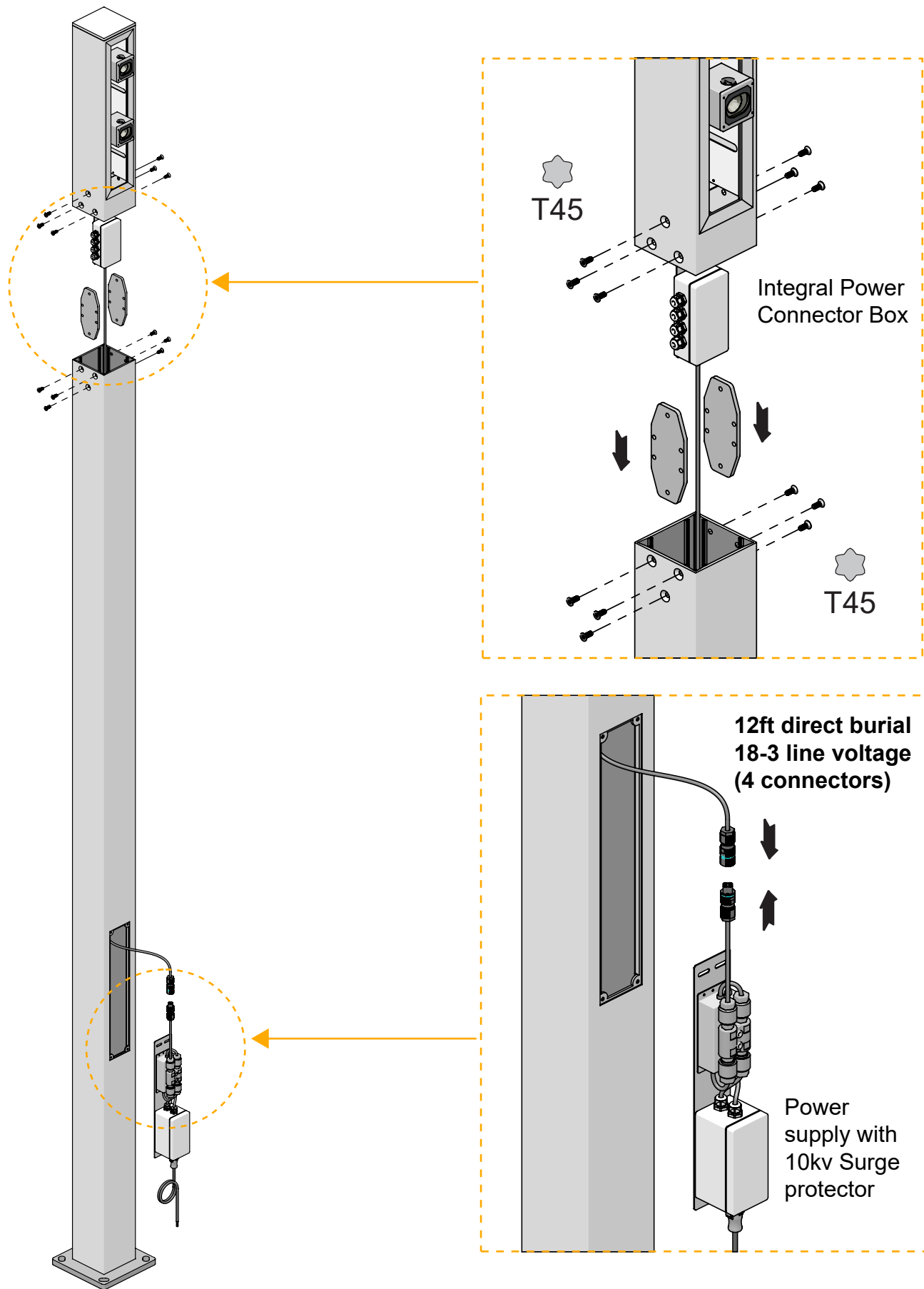

Pole Accessories Installation Cont.

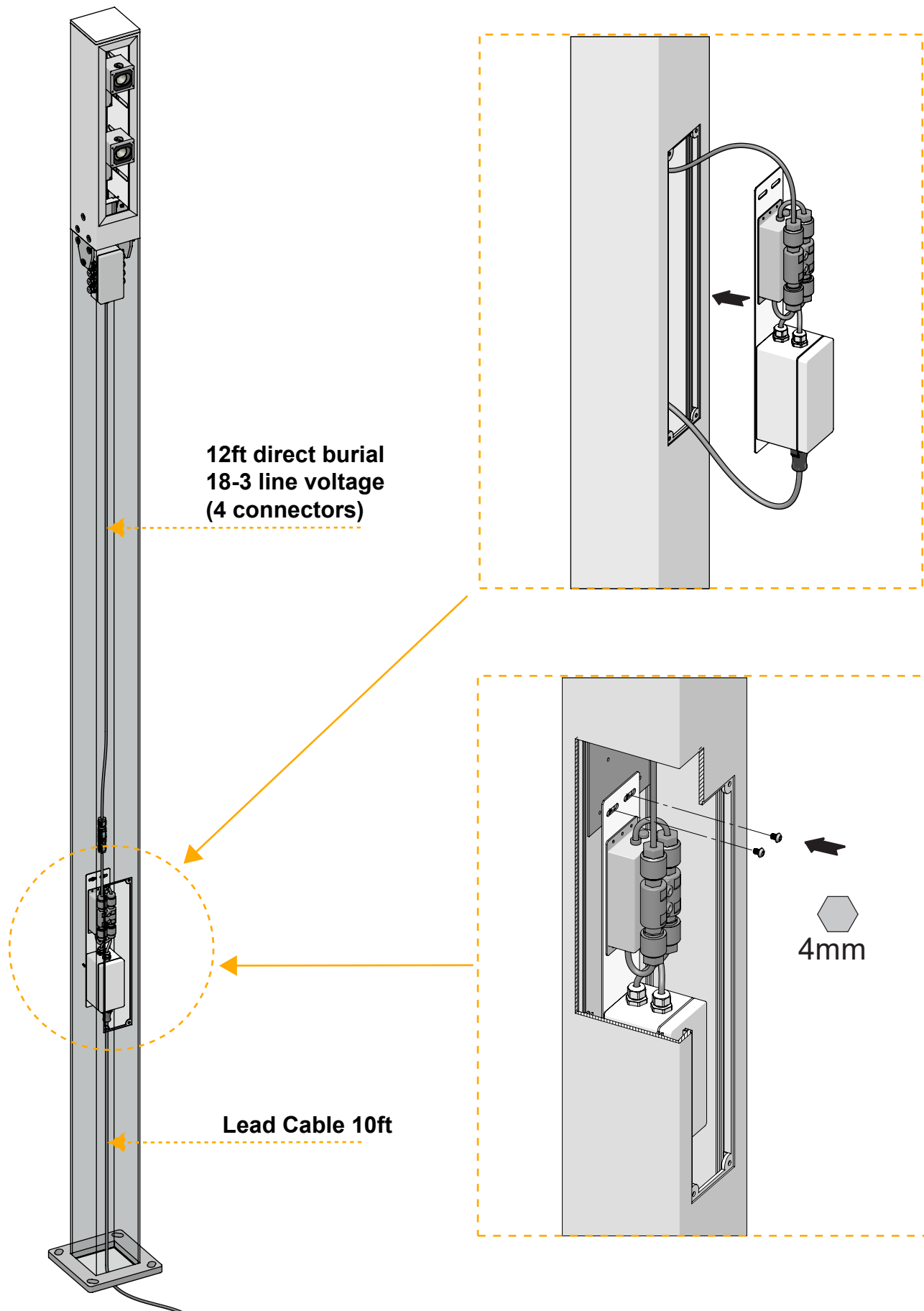

Pole Accessories Installation Cont.

1USE001A

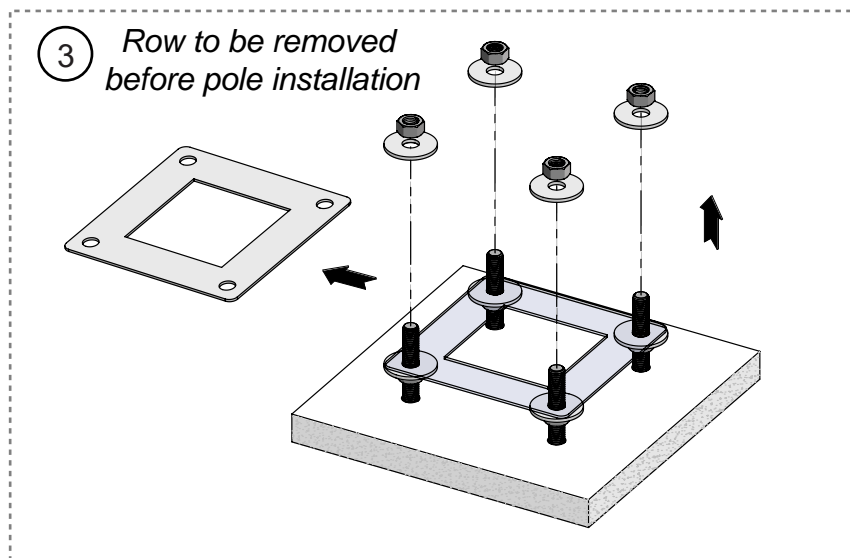
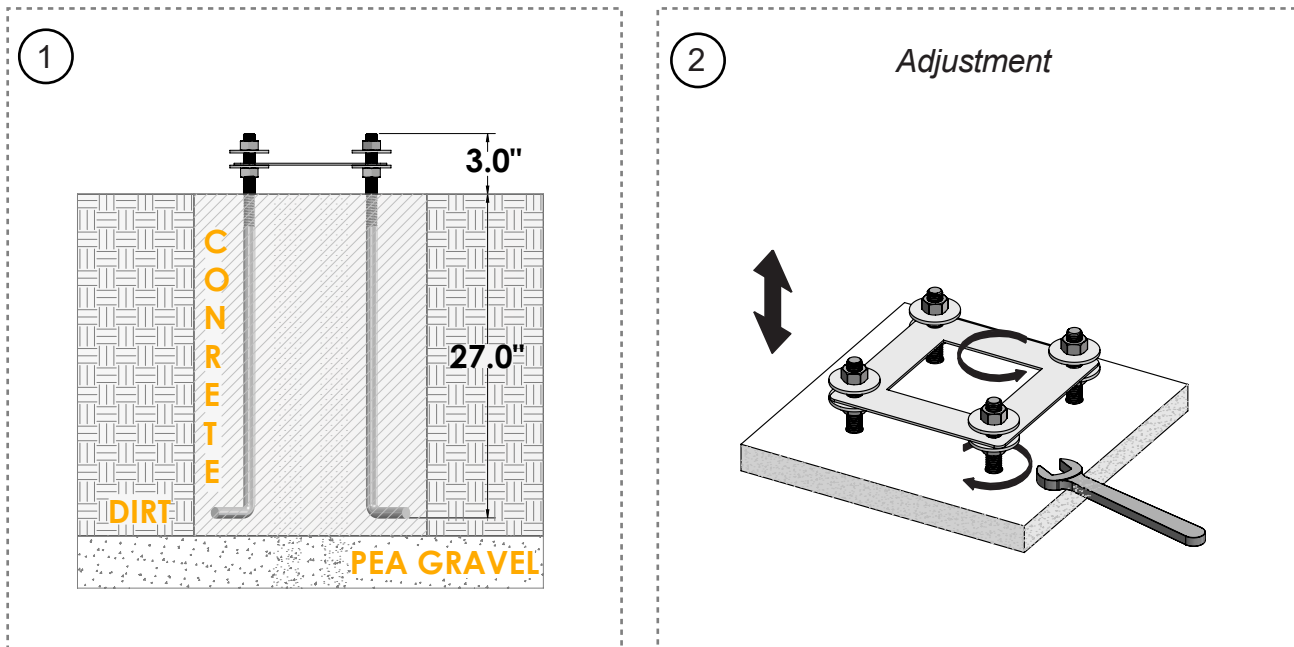
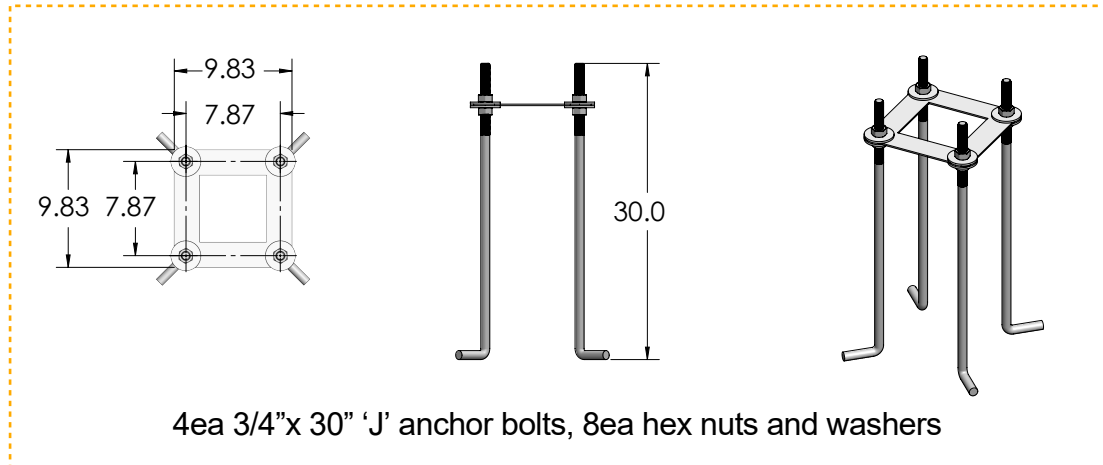

Pole Accessories Installation Cont.

1USE001A

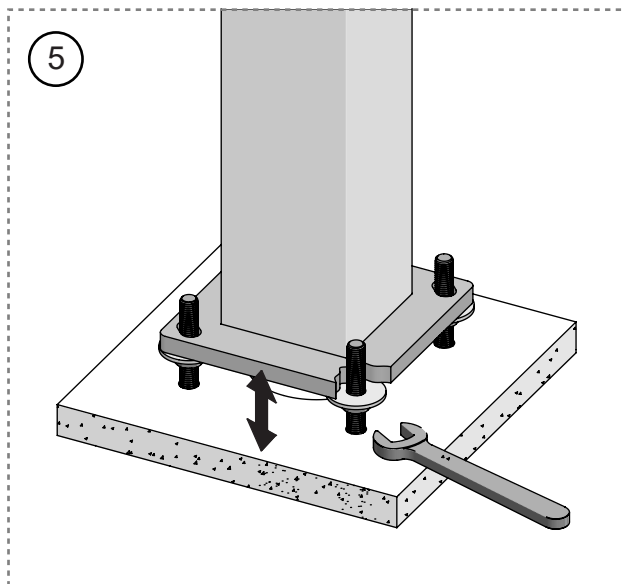
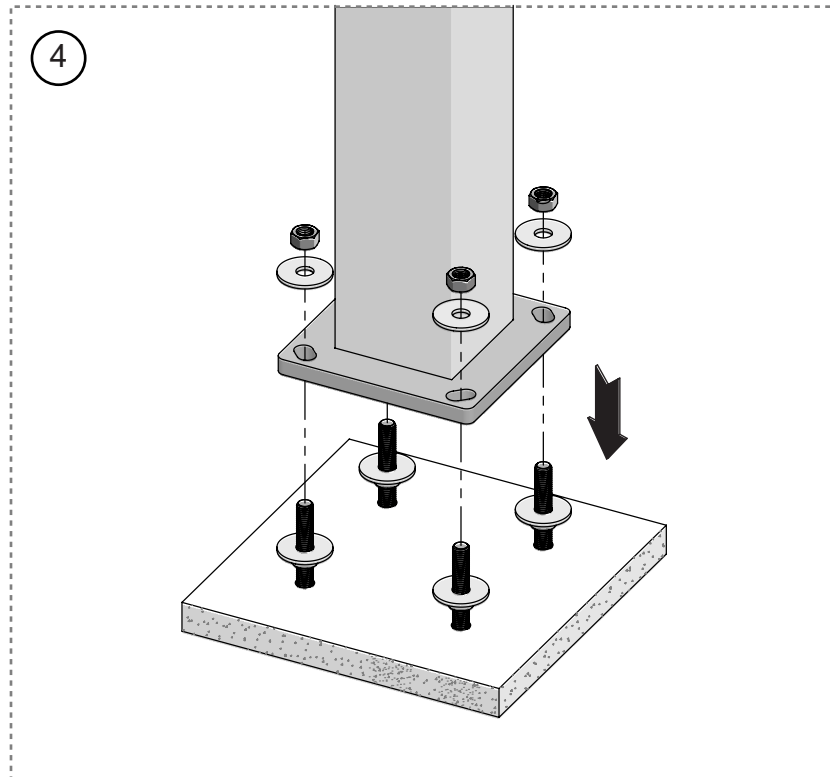

Adjustment

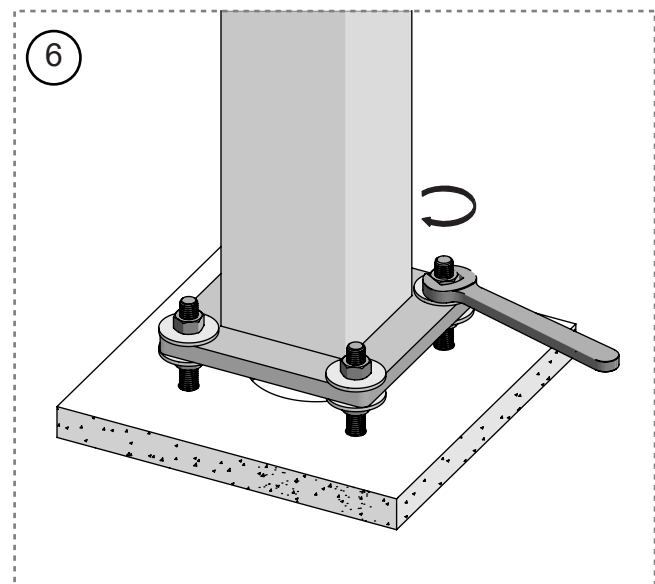

Lock

Cover Accessory Installation

A010A(*)

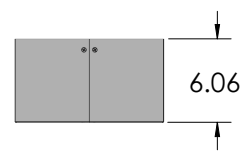
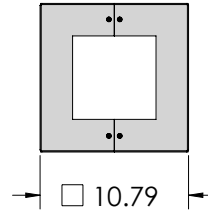
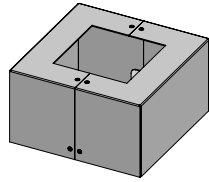

1

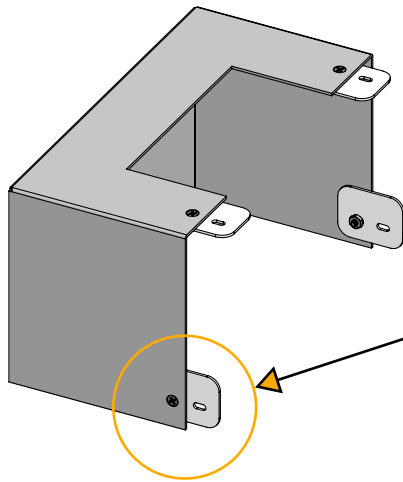

8-32 Hex Nut

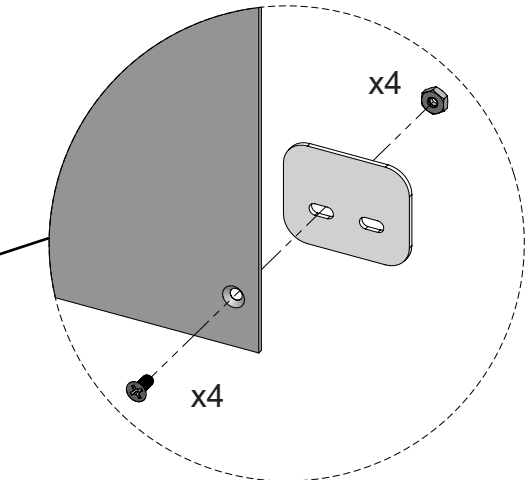

8-32 Screw

2

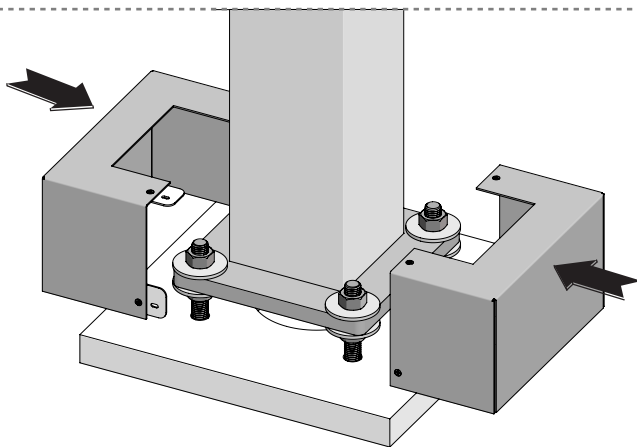

3

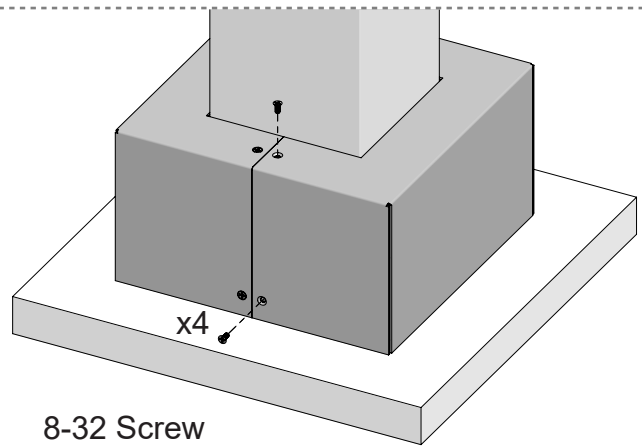

8-32 Screw

Pole Accessories Installation Cont.

Fixture Aiming

Maximum Flexibility

Every luminaire has the ability to be shifted to either side of the pole and rotated by 359° vertical tilt rotation with variable luminaire positions, flush or extracted.

In addition, each luminaire optic can be externally rotated by +/-20° horizontal pan rotation for ultimate flexibility.

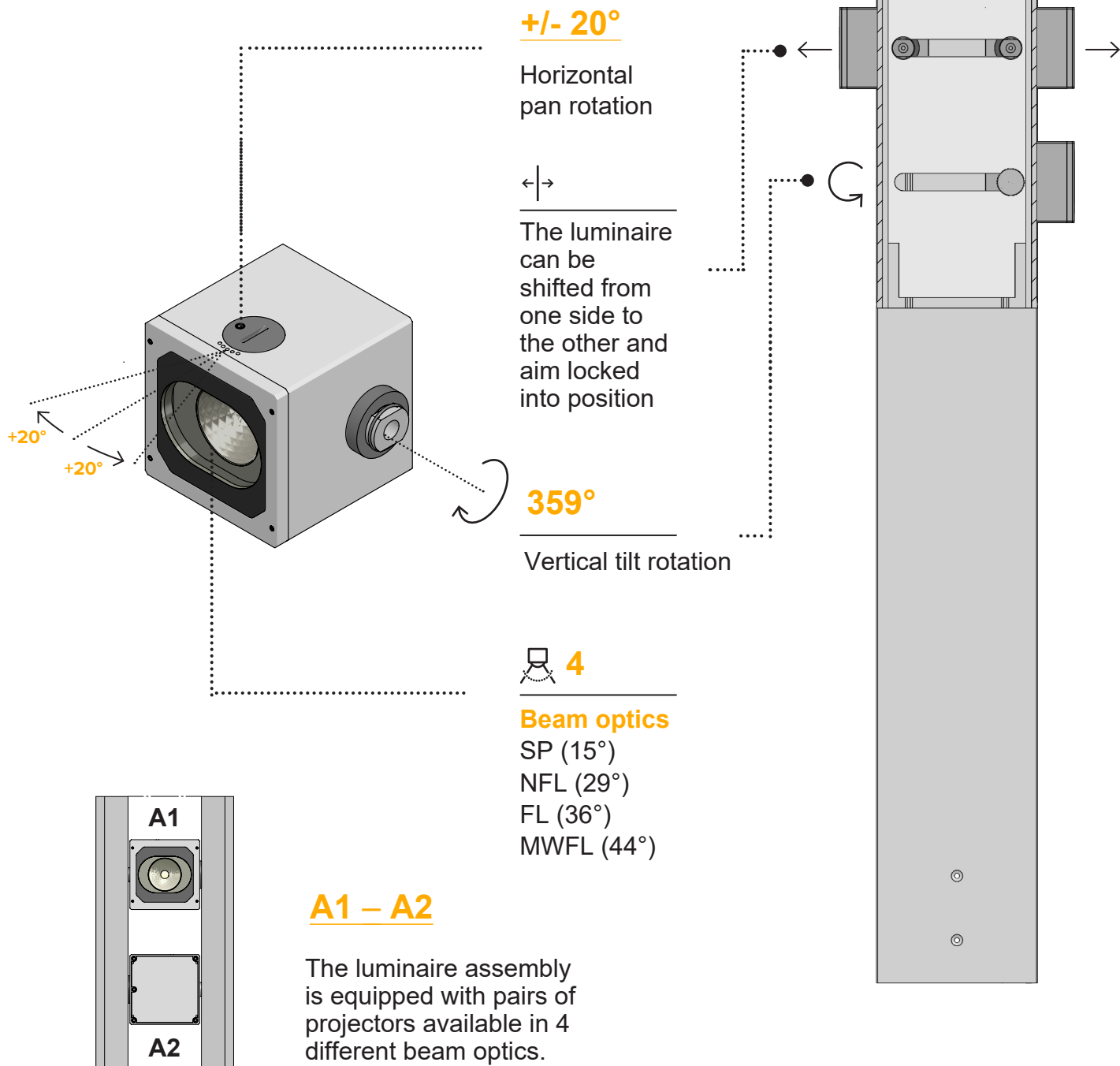

Pole Accessories Installation Cont.

Accessory Collar

USCLR06 (*)

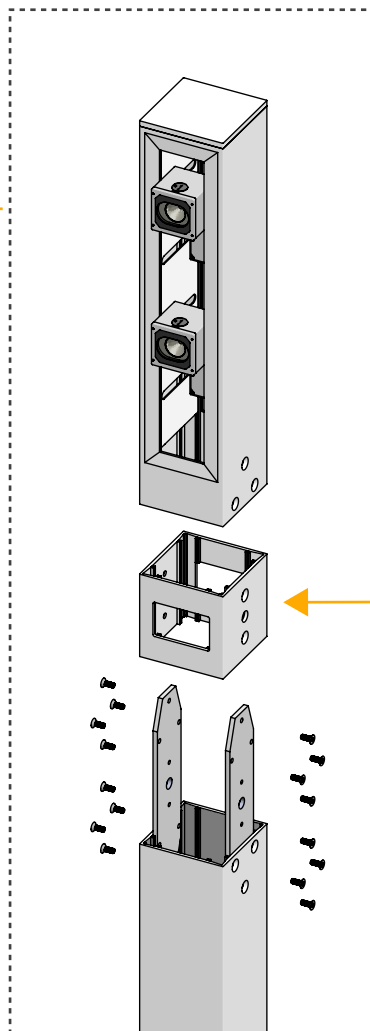
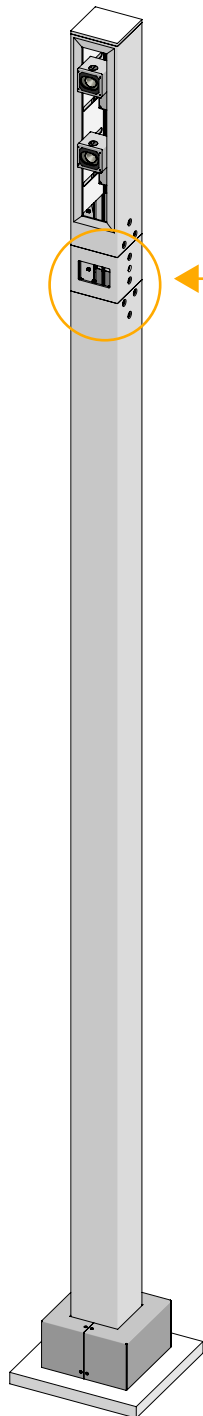
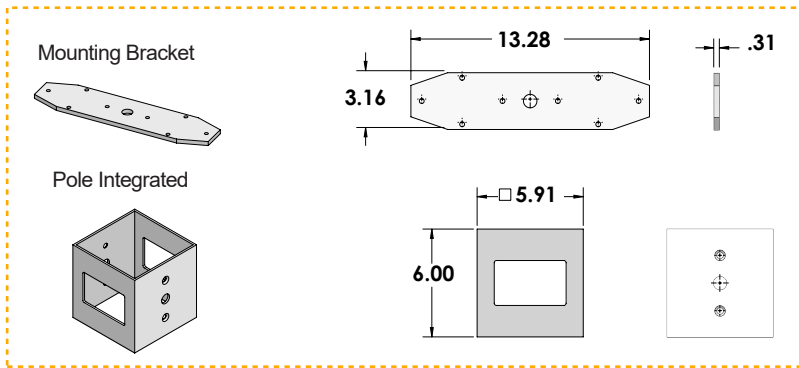

Optional Pole Accessories

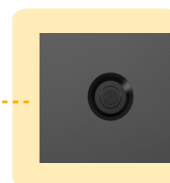

1USCAM01

Integral angled IP67 wall plate camera

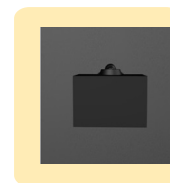

1USSNS01BK 1USSNS01WH

Integral 2-in-1 motion sensor and photo cell

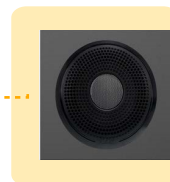

FACTORY CONSULT

Fusion® XS coaxial speaker

CONSULT FACTORY FOR COLLAR
RELATED ACCESSORIES AND
MOUNTING CONFIGURATIONS.

Optical Accessories (Optional)

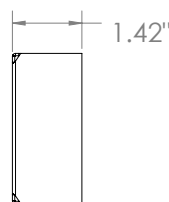
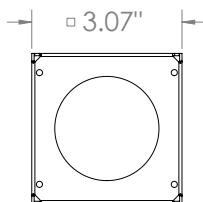
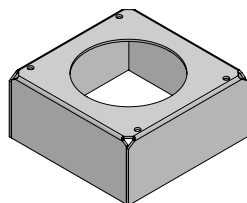

Symmetric snoot. Powder coated stainless steel. **Not compatible with A011B and A011C.**

Part No. **A011A(*)**

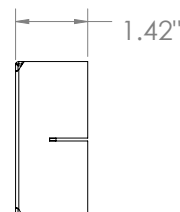
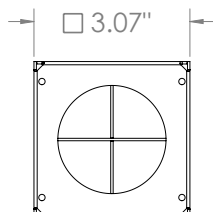
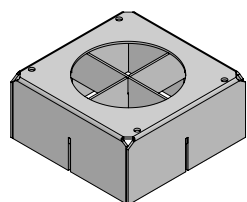

Anti glare louver with removable baffles for different levels of glare control. Powder coat stainless steel. **Not compatible with A011A and A011C.**

Part No. **A011B(*)**

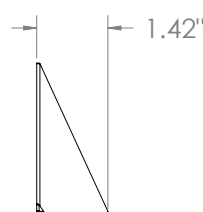
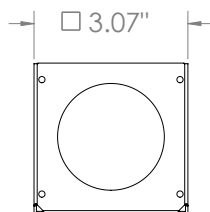
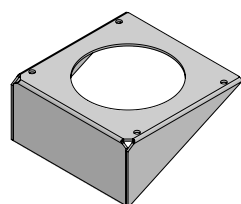

Asymmetric snoot. Powder coated stainless steel. **Not compatible with A011A and A011B.**

Part No. **A011C(*)**

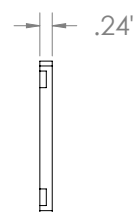
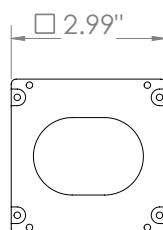
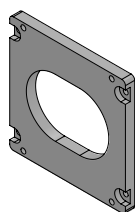

Filter holder ring. CNC machined anodized and powder coated aluminum. **Required for use of all filters.**

Part No. **A011D(*)**

Ferrite Dark Grey (Default)
 Heritage Brown (HB)*
 Bronze (BZ)*
 White (WT)*
 Black (BT)*
 Sandstone Grey (SG)*
 ^B [Custom RAL](#)

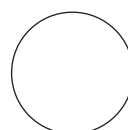
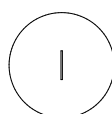

73mm
Ø

'Blade of Light' linear spread lens. PMMA holographic filter. **To be completed with A011D dedicated holder ring. Does not apply toward maximum accessory count.**

Part No. **A011E**

Optical Accessories Installation

Symmetric Snoot A011A(*)

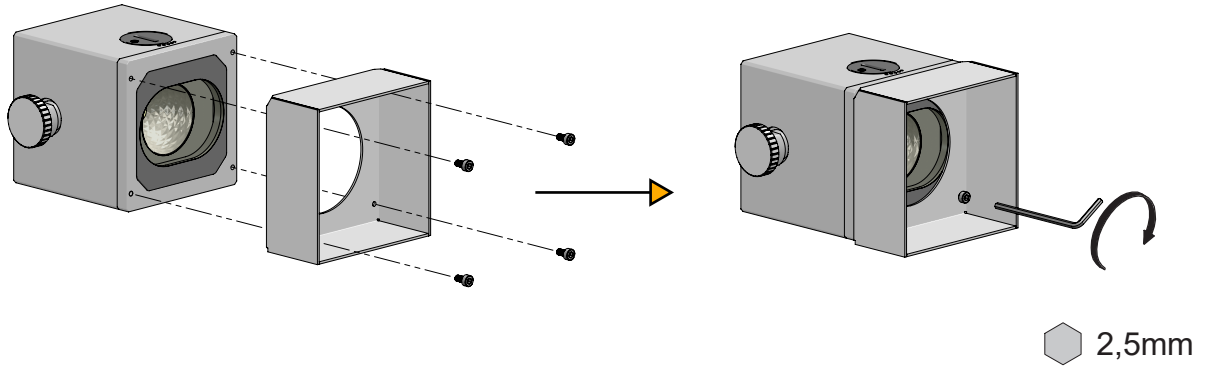

Anti Glare Louver A011B(*)

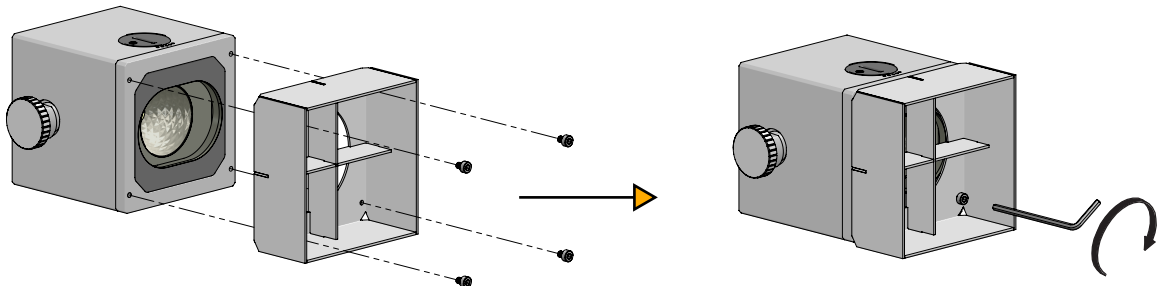

Asymmetric Snoot A011C(*)

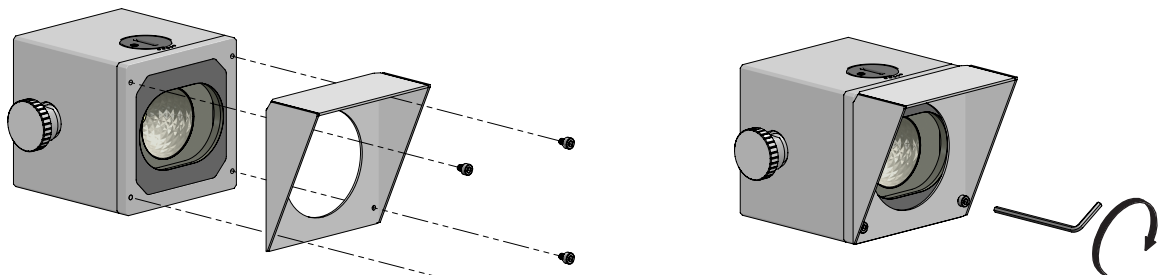

Optical Accessories Installation

Filter Holder Ring Assembly ONLY FOR ADJUSTABLE

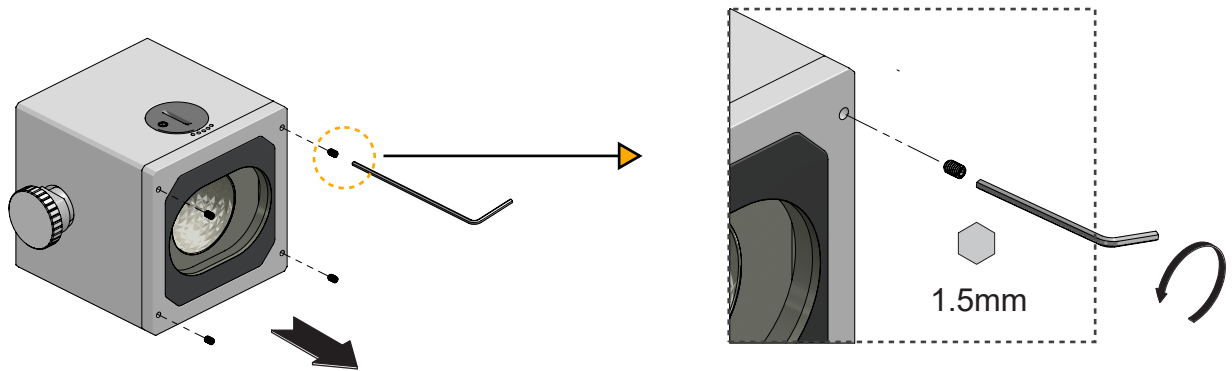

Take the screw off to fix the accessories

Filter Holder Ring A011D(*)

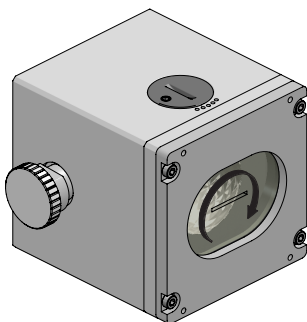
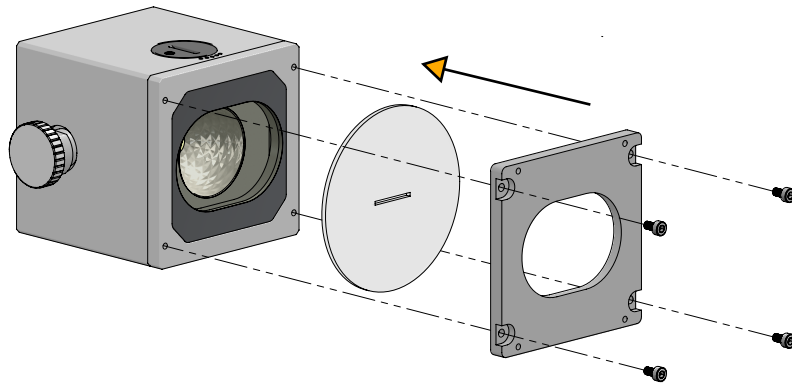

$\pm 360^\circ$

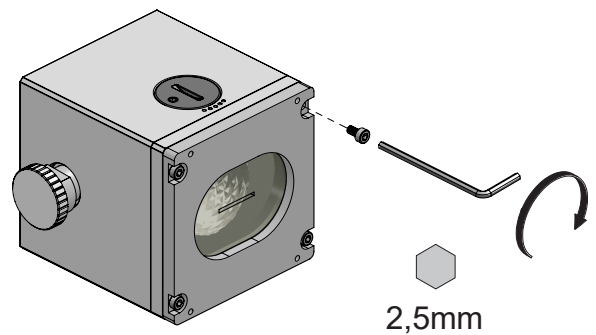

Double Accessories Installation

Only for Adjustable

With Symmetric Snoot

A011A(*)

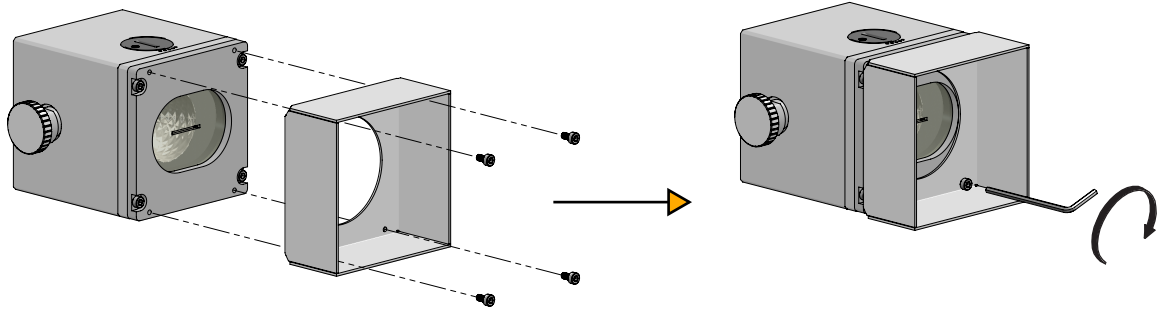

With Anti Glare Louver

A011B(*)

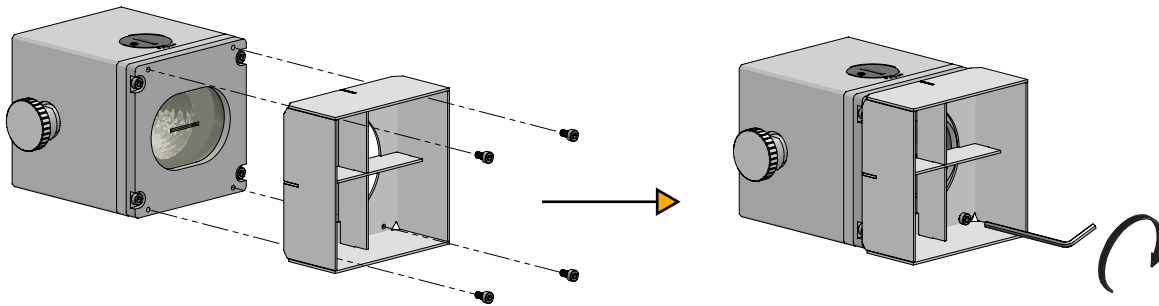

With Asymmetric Snoot

A011C(*)

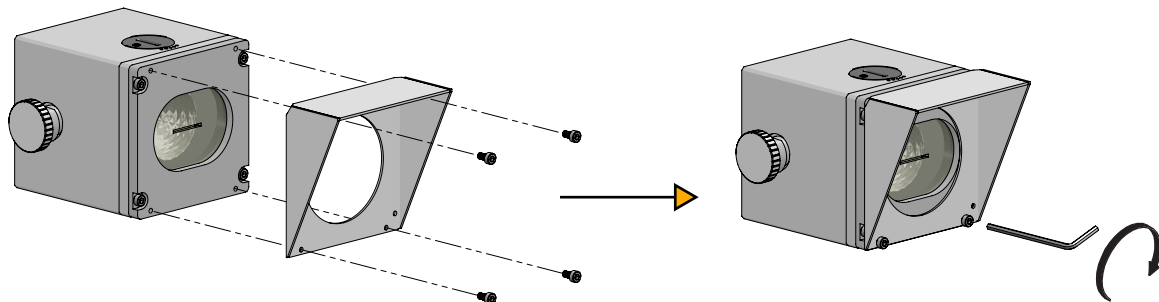

Pole Diagram

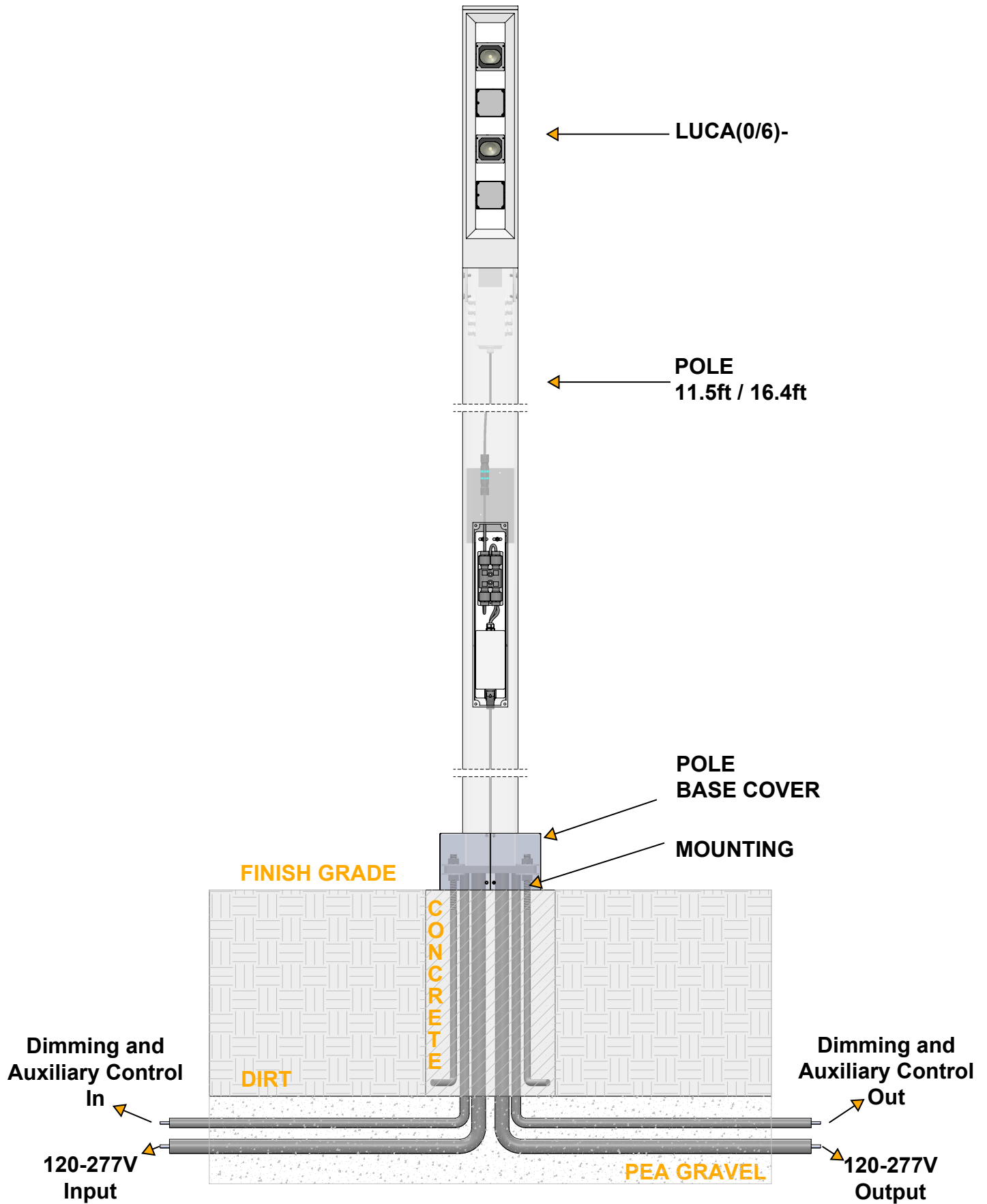

Maintenance

This fixture was designed and manufactured for a durable, long lasting use with minimum care. To ensure the maximum lifespan of this product, we encourage our customers to provide a quality visual inspection of the fixture and installation accessories every six months. If there are any visible signs of issues (i.e moisture or dust) during the inspection, please clean any of the dust or moisture with a soft cloth and check to make sure that all fixtures are still operating normally. If there are any issues regarding the fixture please contact us as we will assist the situation at hand.

Support

Any questions, problems, or comments you have please feel free to contact our Customer Service department during our business hours Monday-Friday 8am-5pm via: Email: usaorders@targetti.com Phone: (714) 513-1991

Visit our website: <http://www.targettiusa.com>