

ROUND STRAIGHT ARCHITECTURAL STEPPED POLE

Pole to be used In Combination with Floodlight Luminaires

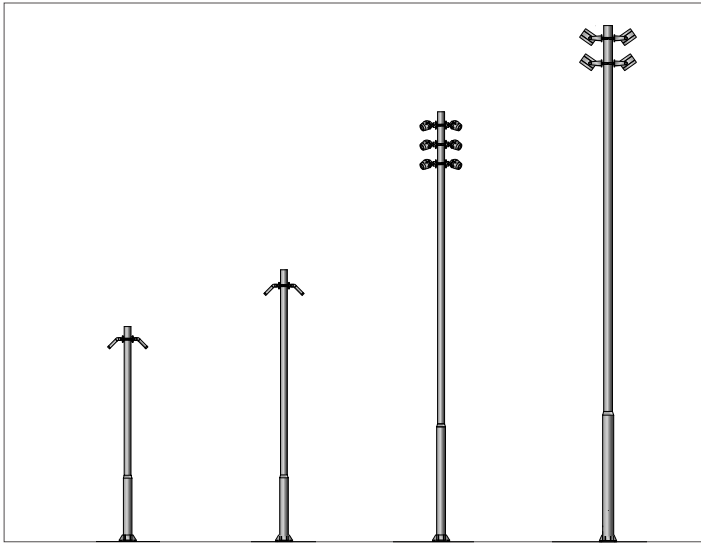

Shown with Targetti flood light luminaires, sold separately.

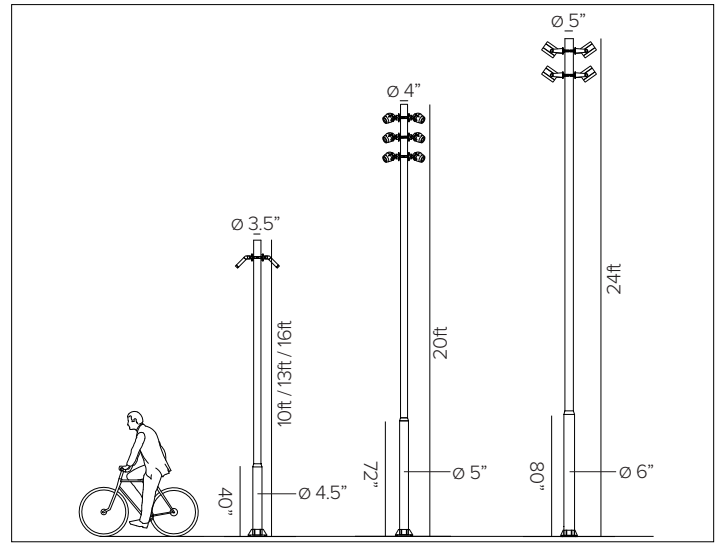

CONCEPT

Round straight architectural stepped pole that can be used with Targetti USA flood light luminaires for event pole mounting configurations.

WARRANTY

5 year limited warranty.

^A Marine grade chromate dipped aluminum suitable for use in marine grade environments. Not to be in direct contact with salt or corrosive agents for extended periods of time.

MECHANICAL CHARACTERISTICS

Materials Extruded aluminum pole, powder coated. Integral hatch door for utility power.

Finish Textured finish.

- Ferrite Dark Grey
- Heritage Brown
- Bronze
- Black
- White
- Sandstone Grey

MAXIMUM EPA MATRIX

HEIGHT	THICKNESS (TOP)	THICKNESS (BOTTOM)	DIA. (TOP)	DIA. (BOTTOM)	120MPH	130MPH	140MPH	150MPH	160MPH	170MPH	180MPH
10FT	0.125"	0.125"	3.5"	4.5"	10.7	9.1	7.8	6.6	5.8	5.1	4.5
13FT	0.125"	0.125"	3.5"	4.5"	7.3	6.2	5.2	4.5	3.9	3.4	3.0
16FT	0.188"	0.237"	3.5"	4.5"	10.9	9.3	7.9	6.8	5.8	5.2	4.5
20FT	0.188"	0.25"	4"	5"	8.0	6.7	5.7	4.8	4.1	3.5	3.1
24FT	0.188"	0.188"	5"	6"	14.1	12.2	10.0	8.6	7.5	6.5	5.6

The poles are designed in accordance with 2023 Florida Building Code with Risk Category II and Exposure C.

The chart indicates maximum EPA of each pole size at the various wind speeds to accommodate floodlight projector.

ROUND STRAIGHT ARCHITECTURAL STEPPED POLE

POLE SPECIFICATION INFORMATION

RSSA									
1	2	3	4	5	6	7	8	9	10
Ex: RSSA13A3545FE / AB4341840 / RSSA45TM / RSA35RBF / 1RSABK4045YFE					OPTIONAL	REQUIRED	OPTIONAL	REQUIRED	

1 - SERIES	2 - POLE HEIGHT	4 - THICKNESS	3 - DIA. (TOP)	4 - DIA. (BOTTOM)	5 - FINISH	6 - POLE ACCESSORIES
RSSA — Round Straight Architectural Stepped Aluminum Pole	10 — 10ft	A — 0.125"	35 — 3.5" O.D.	45 — 4.5" O.D.	FE — Ferrite Dark Grey	R — Receptical
	13 — 13ft	A — 0.125"	35 — 3.5" O.D.	45 — 4.5" O.D.	HB — Heritage Brown	S — Sensor
	16 — 16ft	B — 0.188"	35 — 3.5" O.D.	45 — 4.5" O.D.	BZ — Bronze	B — Eye bolt for catenary
	20 — 20ft	B — 0.188"	40 — 4.0" O.D.	50 — 5.0" O.D.	WT — White	
	24 — 24ft	B — 0.188"	50 — 5.0" O.D.	60 — 6.0" O.D.	BT — Black	
					SG — Sandstone Grey	
					RAL — Custom RAL	
7 - INSTALLATION	8 - POLE BASE COVER	9 - FIXTURE MOUNTING BRACKET	10 - POLE ACCESSORIES			
Anchor Kit See section for details	Pole Base Cover See section for details	Mounting Ring See section for details	Mounting Bracket See section for details			

Consult factory for other heights.

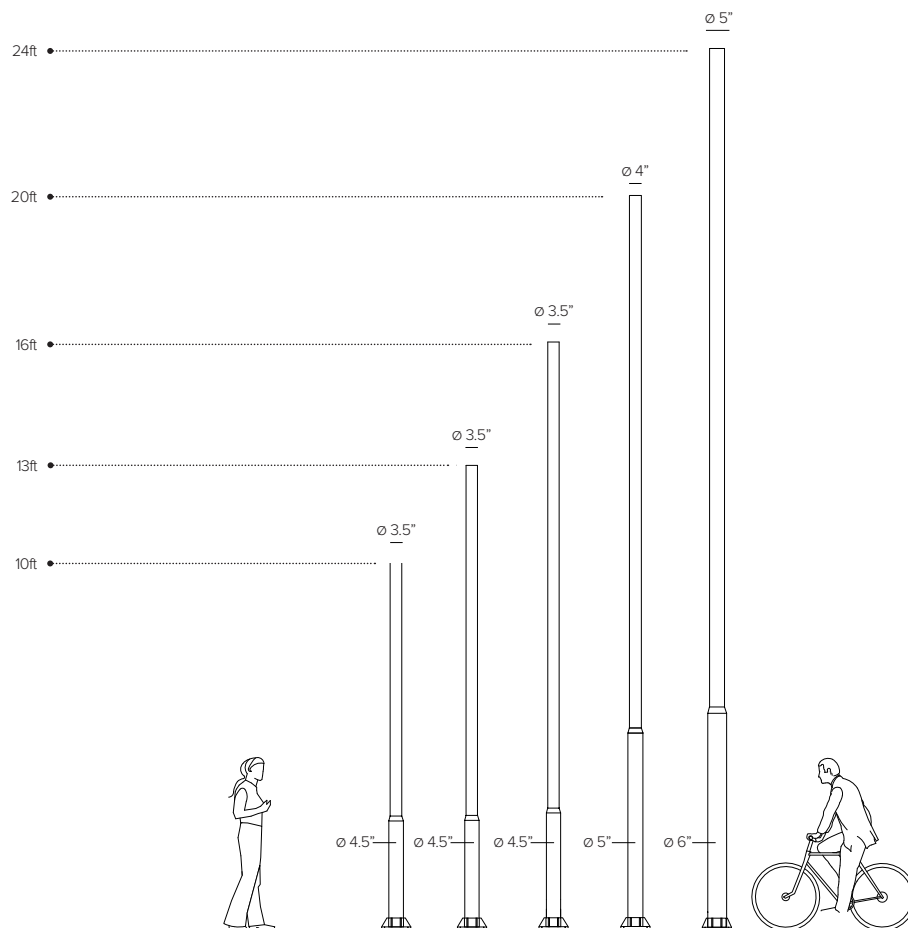

ROUND STRAIGHT ARCHITECTURAL STEPPED POLE

6 – POLE ACCESSORIES (OPTIONAL)

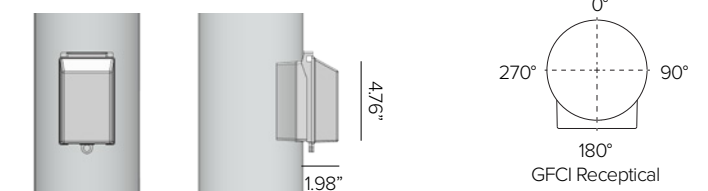

Receptical. Single gang 15A GFCI duplex receptical mounted in UL listed water proof enclosure with aluminum casted in-use outlet cover, powder coated to match pole finish. Mounted as standard at +18" to bottom of enclosure at 180° on poled, consult factory for other mounting configurations.

Part No. **R**



Eye bolt. 3/8" 304 16-thread size stainless steel with 1-1/4" thread. To be used in conjunction with festoon luminaires. Compatible for 50lbs of load. Consult factory for mounting location.

Finish Silver

Part No. **B**

7 – INSTALLATION (REQUIRED)

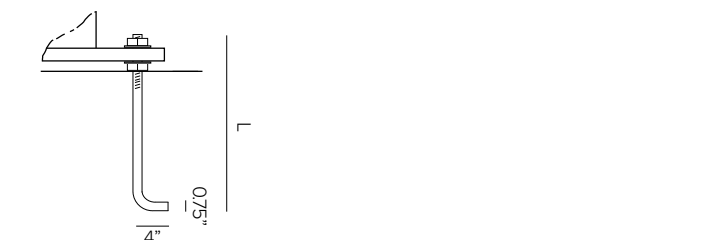

Pole anchor kit, 4ea 'J' anchor bolts per ASTM 1554-55, 8ea hex nuts and washers. **(REQUIRED per pole)**

Pole Heights	10ft / 13ft / 20ft	24ft
Length (L)	18"	36"
Diameter (DIA)	0.75"	1"
Part No.	AB4341840	AB4123640

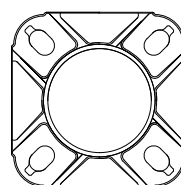

Round Straight Pole template, 1ea. **(1ea REQUIRED per project)**

Pole Dia. (top)	3.5"Dia	4"Dia	5"Dia
Pole Dia. (bottom)	4.5"Dia	5"Dia	6"Dia
Part No.	RSSA45TM	RSSA50TM	RSSA60TM

MOTION SENSOR AND PHOTOCCELL DETAILS

Optional PIR outdoor motion sensor and daylight photocell. Factory preset to 100% motion sensitivity with a hold time of 10 seconds or daylight sensor is 30lux then fixture dims 30% over 60 minutes. Optional field setting of sensitivity, hold-time, light-control, light level, and stand-by time by manual dip switch control settings. See installation instructions for details.

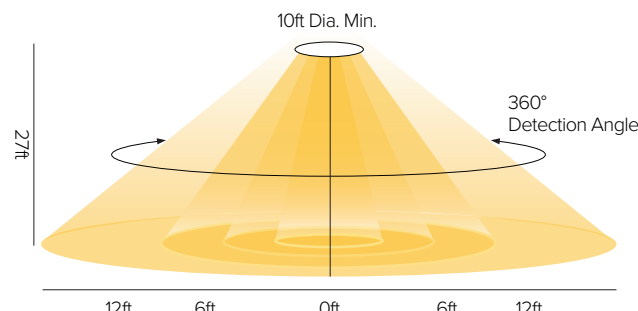
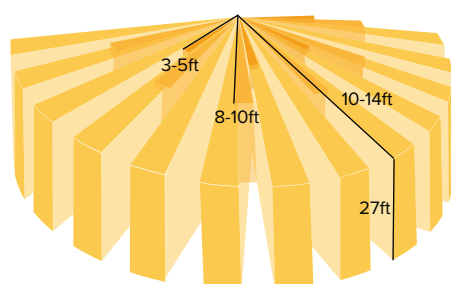

ROUND STRAIGHT ARCHITECTURAL STEPPED POLE

8 - POLE BASED COVER (OPTIONAL)



Decorative cast aluminum pole base cover.

Pole Dia. (top)	3.5"Dia	4"Dia	5"Dia
Pole Dia. (bottom)	4.5"Dia	5"Dia	6"Dia
Cover (Dia)	Ø 12"	Ø 12"	Ø 16"
Height (H)	4"	4"	6"
Part No.	RSA45BC (*)	RSA50BC (*)	RSA60BC (*)

9 - FIXTURE MOUNTING BRACKET (REQUIRED FOR EVENT POLE CONFIGURATIONS)

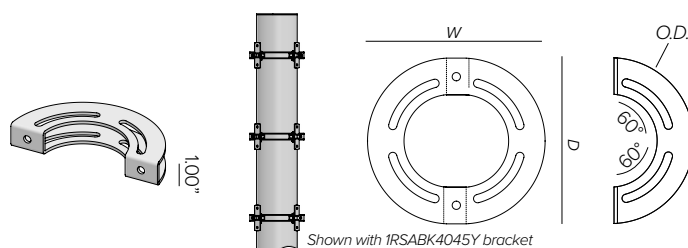

Event pole mounting ring, 1ea. Powder coated stainless steel.

Required for use with 1USPRBK01 mounting bracket.

BULLETO LINE, DART SMALL, DART ROUND SMALL REMOTE, DART ROUND SMALL ranges compatible with up to 4ea fixtures per 4" & 4.5" poles or 6ea fixtures per 5" & 6" poles

DART MEDIUM, DART ROUND MEDIUM, VADER SOLO, VADER TW ranges compatible with up to 4ea fixtures for all pole diameters.

DART MAXI and **DART ROUND MAXI** ranges compatible with up to 3ea fixtures per 4" & 4.5" poles or 4ea fixtures per 5" & 6" poles.

Pole Dia.	3.5"	4"	5"
Width (W)	6.24"	7.19"	8.62"
Depth (D)	6.70"	6.70"	7.75"
Outside Dia. (O.D.)	6.25"	6.75"	7.75"
Part No.	RSA35RB (*)	RSA40RB (*)	RSA50RB (*)

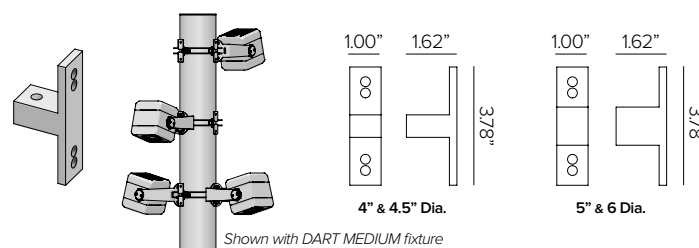

Event pole fixture mounting bracket ring, 1ea. Powder coated aluminum.

Required for use with 1USPR mounting ring, one per fixture.

Compatible with the following fixture families: DART SMALL, DART ROUND SMALL REMOTE, DART ROUND SMALL, DART MEDIUM, DART ROUND MEDIUM, DART MAXI, DART ROUND MAXI.

Pole Dia.	3.5" and 4"	5"
Part No.	1RSABK4045Y (*)	1RSABK5060Y (*)



Single pole fixture bracket, 1ea. Powder coated stainless steel. Consult factory for mounting location.

Compatible with BULLETO LINE, VADER SOLO, and VADER TW fixtures only.

Pole Dia.	3.5"Dia	4"Dia	5"Dia
Part No.	A054 (*)	1USA05440 (*)	1USA05450 (*)

Ferrite Dark Grey (FE)*
 Heritage Brown (HB)*
 Bronze (BZ)*
 White (WT)*
 Black (BT)*
 Sandstone Grey (SG)*

***Add suffix to end of number to identify finish (EX. 1USA05240HB)**

ROUND STRAIGHT ARCHITECTURAL STEPPED POLE

INSTALLATION DETAILS

POLE BASE DETAILS

4.5" / 5" Dia. Versions

9.62"

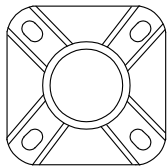

3.68"

6" Dia. Version

10.24"

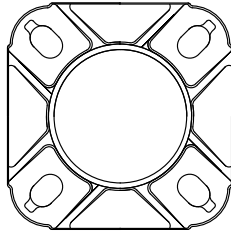

3.50"

HAND HOLE DETAIL

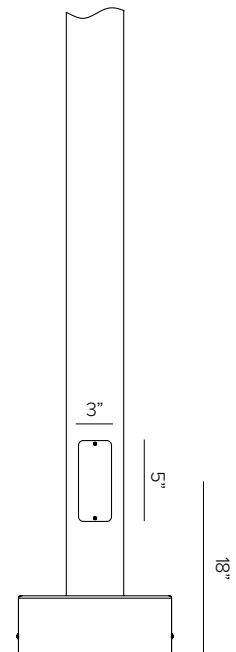
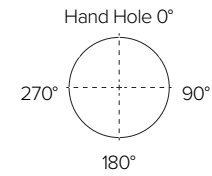

ANCHOR BOLT DETAIL

